

PREPARED BY  
HIGHWAY PLANNING SURVEY  
IN COOPERATION WITH  
U. S. PUBLIC ROADS ADMINISTRATION

STATE OF MINNESOTA  
DEPARTMENT OF HIGHWAYS  
ROAD LIFE STUDIES  
CONSTRUCTION PROJECT LOG RECORD

CONTROL SECTION 5305  
TRUNK HIGHWAY 69  
COUNTY Nobles  
DISTRICT 7B

LIMITS: S. State Line - S. Jct. T.H. 16 in Worthington

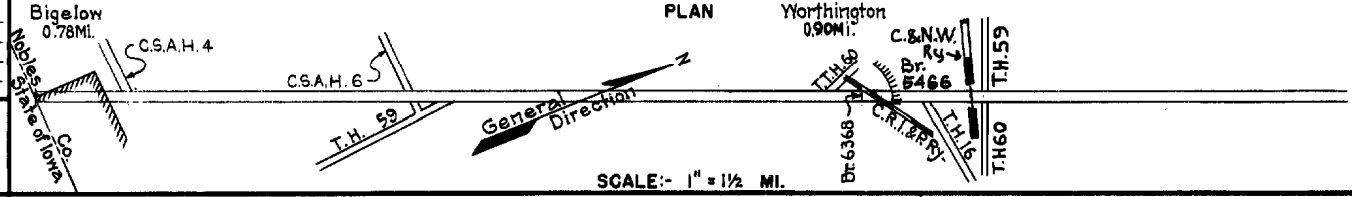

YEAR BUILT	PROJECT N°	DESCRIPTION			CODE N°
		TYPE	WIDTH	THICKNESS	
		Concrete	35'		No Record of Constr. Added in 1934.
		Gravel	20'	2"	No Record of Constr. Added in 1934.
1921		Grading (1)	24'		F.A.P. 45. Added in 1934.
1921		Gravel	20'	3 3/4"	1500 C.Y./Mile. Added in 1934.
1922		Gravel	20'	3 3/4"	1500 C.Y./Mile. Added in 1934.
1937	60-85-21-1	Grading & S. Base Gravel	32'	24"	1400 Tons/Mile
1937	60-85-21-1	Mono. Culverts	28'	1 1/2"	W46X39 & W84X45
1937	60-85-21-1	Seeding			
1940	A.F.E. 37	Mixed Bitum.	24'	1 1/4"	Maint. Dept.
1941	5305-07	42" C.M. Pipe			On new location.
1942	5305-02	Grading	42'		Stab. Grav. only on So. end (1.65 Mi)
1942	5305-04	Grading	68'		1.18 Mi. Divided Highway 2.34 Roadways. W.P.A.
1942	5305-14	Stab. Gravel	26' & 2'-4"		
1942	A.F.E. 7	Seeding			Seed supplied by R.S.D. (S.P. 5305-11 & 12) Maint. Dept.
1942	5305-06	State Line Marker			

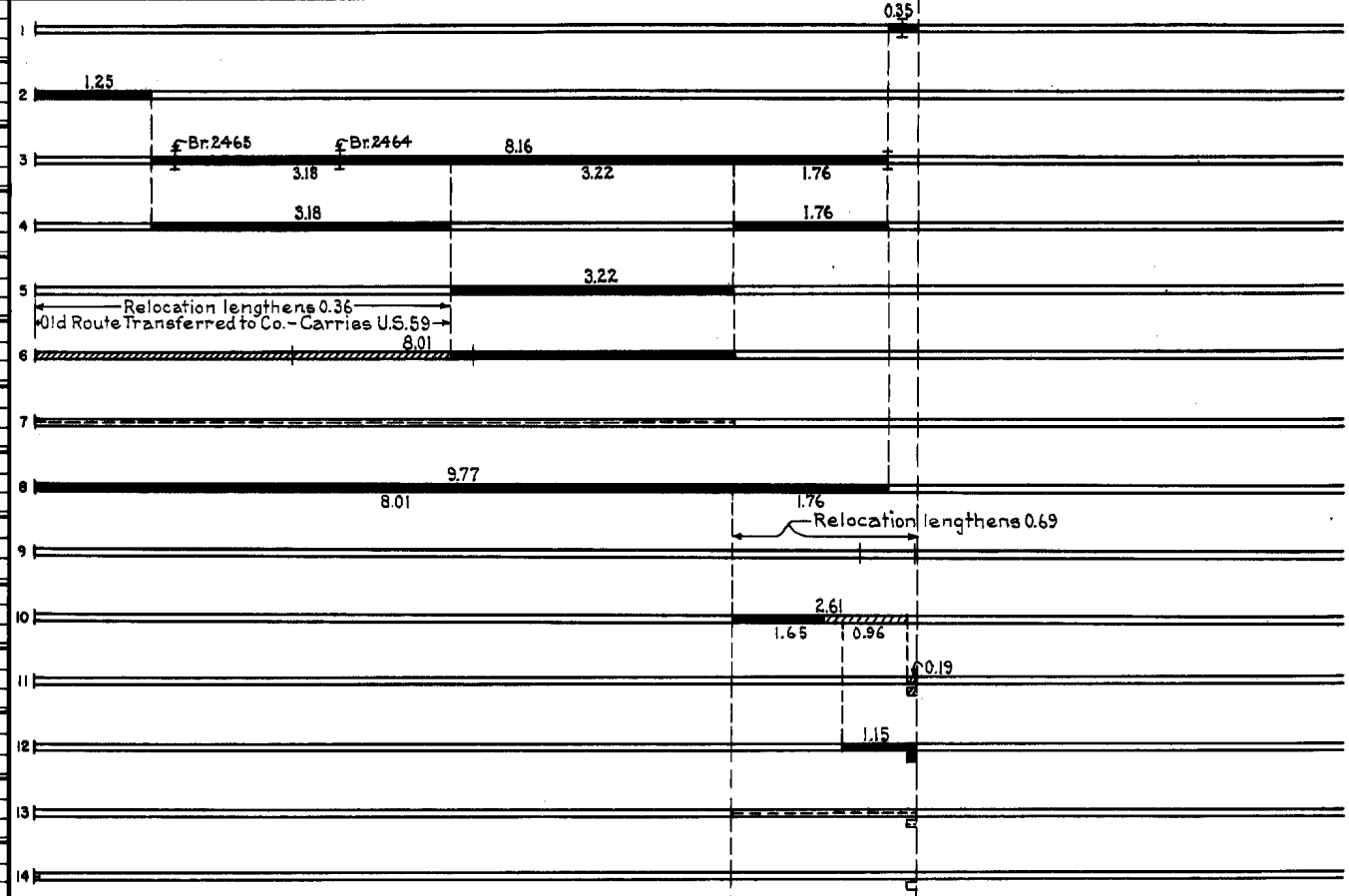

YEARS FROM	TO	TOTAL MILES	UNINCORPORATED		INCORPORATED		RURAL		URBAN	
			RDWY. MI.	BR. MI.	RDWY. MI.	BR. MI.	RDWY. MI.	BR. MI.	RDWY. MI.	BR. MI.
1934	1936	9.76	9.40	0.01	0.35	0.00	9.40	0.01	0.35	0.00
1937	1941	10.12	8.99	0.00	1.13	0.00	9.77	0.00	0.35	0.00
1942	1945	10.81	9.12	0.00	1.69	0.00	9.90	0.00	0.91	0.00
1946	1946	10.81	9.58	0.00	1.23	0.00	10.36	0.00	0.45	0.00
1947		10.14	9.49	0.00	1.25	0.00	10.27	0.00	0.47	0.00

REMARKS: Layout is to scale as of 1937. Plan revised for 1942 relocation  
(1) No record of construction of Br. 2465, 2464 & 6172.

PREPARED BY  
HIGHWAY PLANNING SURVEY  
IN COOPERATION WITH  
U.S. PUBLIC ROADS ADMINISTRATION

STATE OF MINNESOTA  
DEPARTMENT OF HIGHWAYS  
ROAD LIFE STUDIES  
CONSTRUCTION PROJECT LOG RECORD

CONTROL SECTION 5305  
TRUNK. HIGHWAY 60  
COUNTY Nobles  
DISTRICT 7B

LIMITS: S. State Line-N. Jct. T.H. 59 in Worthington

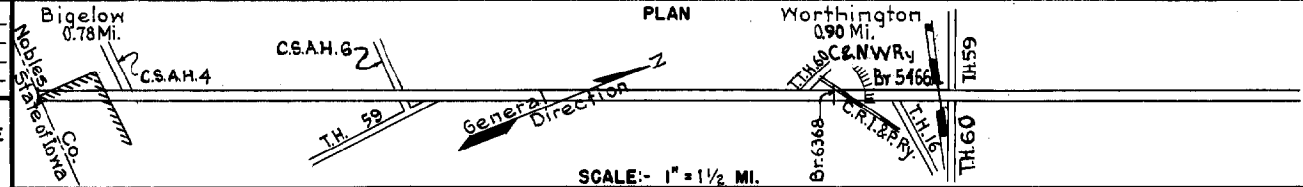

YEAR BUILT	PROJECT N <sup>o</sup>	DESCRIPTION			CODE N <sup>o</sup>
		TYPE	WIDTH	THICKNESS	
M	1947 A.F.E.4	Bit. Retreat	24'		1
C	1943 5305-18	Roadside Develop.			2
M	1943 A.F.E.4	Spot Treat. Bit. Surf. Repair	28'		3
C	1944 A.F.E.18	Bit. Surfacing Mixed Bit.	24' 1"		4
M	1944 A.F.E.4	Bit. Surf. Repair	24'		5
M	1945 A.F.E.4	Bit. Surf. Repair			6
M	1946 A.F.E.4	Bit. Surf. Repair	24'		7
C	1947 5305-08&09	Grading Concrete (2)	28' 9'-7-9		8
C	(1) 5305-21	Grav. Shoulders			
C	1955 5305-22	Grading Gravel Base Concrete	Var. 28'	3" 9'-7-9	9
C	1971 5303-17	Bit. Overlay	22'-2 1/4"		10
M	1978 SF	Bit. Spot Overlay		1 1/2"	11
M	1976 SF	Bit. Spot Overlay		1 1/4"	12
M	1977 SF	Bit. Spot Overlay		1 1/2"	13
M	1977 SF	Bit. Seal Coat			14

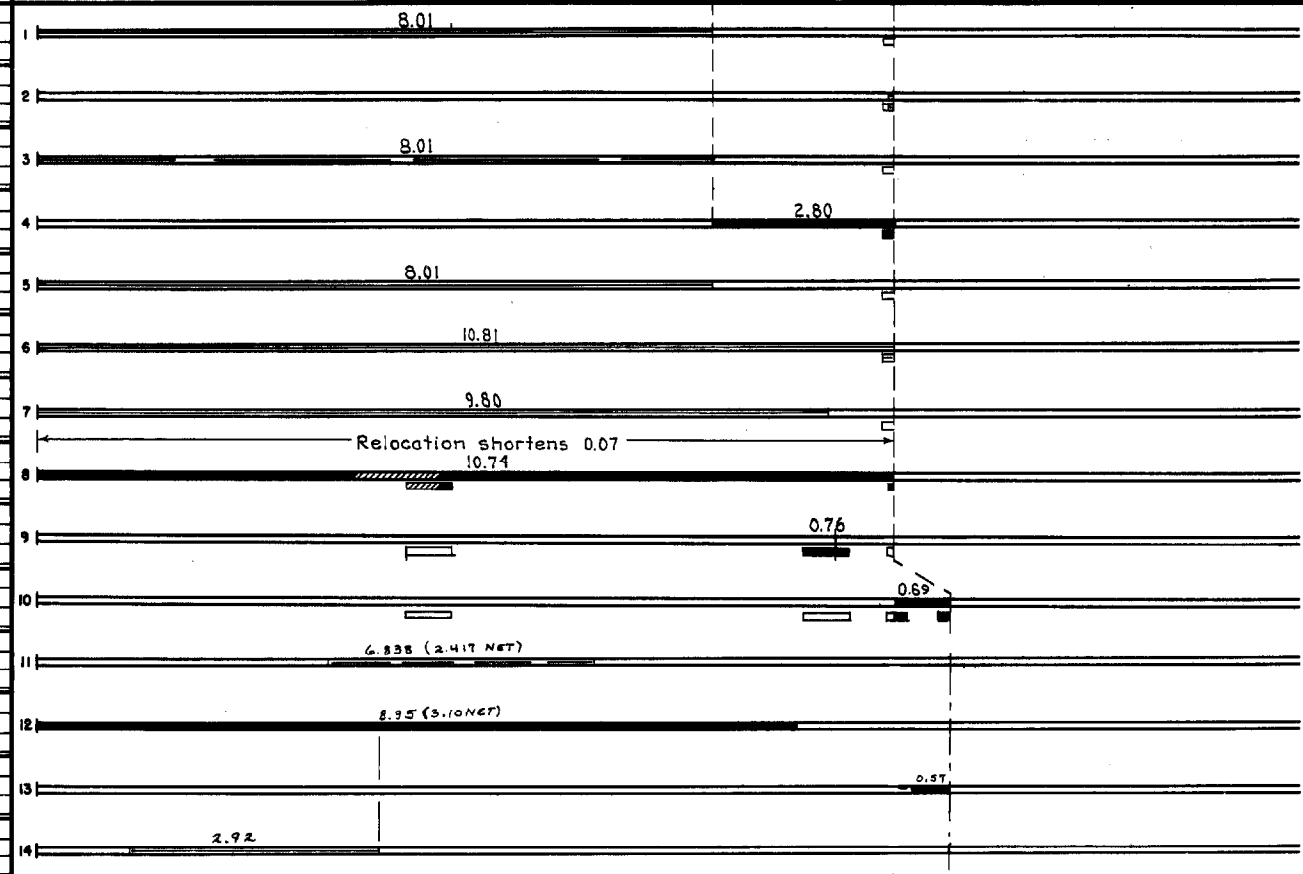

YEARS FROM TO		TOTAL MILES	UNINCORPORATED		INCORPORATED		RURAL		URBAN	
FROM	TO		RDWY. MI.	BR. MI.	RDWY. MI.	BR. MI.	RDWY. MI.	BR. MI.	RDWY. MI.	BR. MI.

REMARKS: See Sheet No. 1 (1) Contract not final but work substantially complete in 1947.  
(2) 2" Mixed Bit. on 6" Gravel Base 14' wide placed on each side of new 22' Conc. slab (50' curb to curb) for .25 mile in Bigelow.

6-74



