

PREPARED BY  
HIGHWAY PLANNING SURVEY  
IN COOPERATION WITH  
U. S. PUBLIC ROADS ADMINISTRATION

STATE OF MINNESOTA  
DEPARTMENT OF HIGHWAYS  
ROAD LIFE STUDIES  
CONSTRUCTION PROJECT LOG RECORD

CONTROL SECTION 4812  
TRUNK HIGHWAY 169  
COUNTY Mills Lake  
DISTRICT 3A-3B

LIMITS: Jct.T.H.23 in Milaca - S.Jct.T.H.27 in Onamia

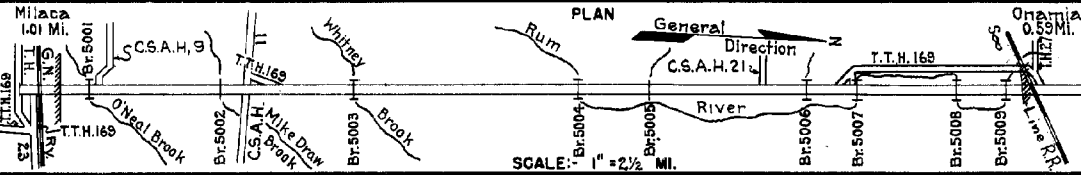

| YEAR BUILT | PROJECT N°     | DESCRIPTION                          |       |            | CODE N°  |
|------------|----------------|--------------------------------------|-------|------------|--|
|            |                | TYPE                                 | WIDTH | THICK-NESS |  |
|            |                | Gravel<br>6 Bridges (1)              | 22'   | 2"         | No Record of Constr.                                       |
| 1921       | 169-18-2A      | Gravel<br>Br.3239                    | 20'   | 3 1/2"     | 1400 C.Y./Mile.<br>70 H.T.                                 |
| 1927       |                | Tar Tr. Gravel                       |       |            | 10457 Gal./Mile.<br>Maint. Dept.                           |
| 1929       | 169-18-2A      | Tar Tr. Gravel                       | 24'   | 1"         | 10215 Gal./Mile.<br>Maint. Dept.                           |
|            |                | Gravel                               |       |            | No Record of Constr.<br>Taken over from City in 1930.      |
| 1931       | 169-18-23-2    | Concrete                             | 20'   | 8-79       |  |
| 1931       | 169-18-23-2    | Grading<br>Concrete<br>6 Bridges (3) | 20'   | 9-79       |  |
| 1930       | 169-18-23-2    | Grading<br>Br.5007, 5008 & 5009      | 40'   | 33'        | Not in use as T.H.<br>until 1932.<br>40' B.S. & 2-30' B.S. |
| 1932       | 169-18-23-2    | Grading                              | 32'   |            |  |
| 1932       | 169-18-23-2    | Concrete                             | 20'   | 9-79       |  |
| 1932       | 169-18-23-2    | Oil Tr. Gravel                       | 28'   | 1 1/2"     | Maint. Dept.   |
| M          | 1941 A.F.E. 20 | Bit. Retreat                         | 26'   |            | 503,4798 Gal./Mi.<br>Grav. 245 C.Y./Mi.<br>Maint. Dept.    |
| M          | 1942 A.F.E. 4  | Spot Treat.<br>Bit. Surf. Repair     | 28'   |            | 503b, 3917 Gal./Mi.<br>Agg. 248 C.Y./Mi.<br>Maint. Dept.   |
| M          | 1942 A.F.E. 5  | Bit. Seal Coat                       | 30'   |            | RT-6, 2495 Gal./Mi.<br>Agg. 119 C.Y./Mi.<br>Maint. Dept.   |

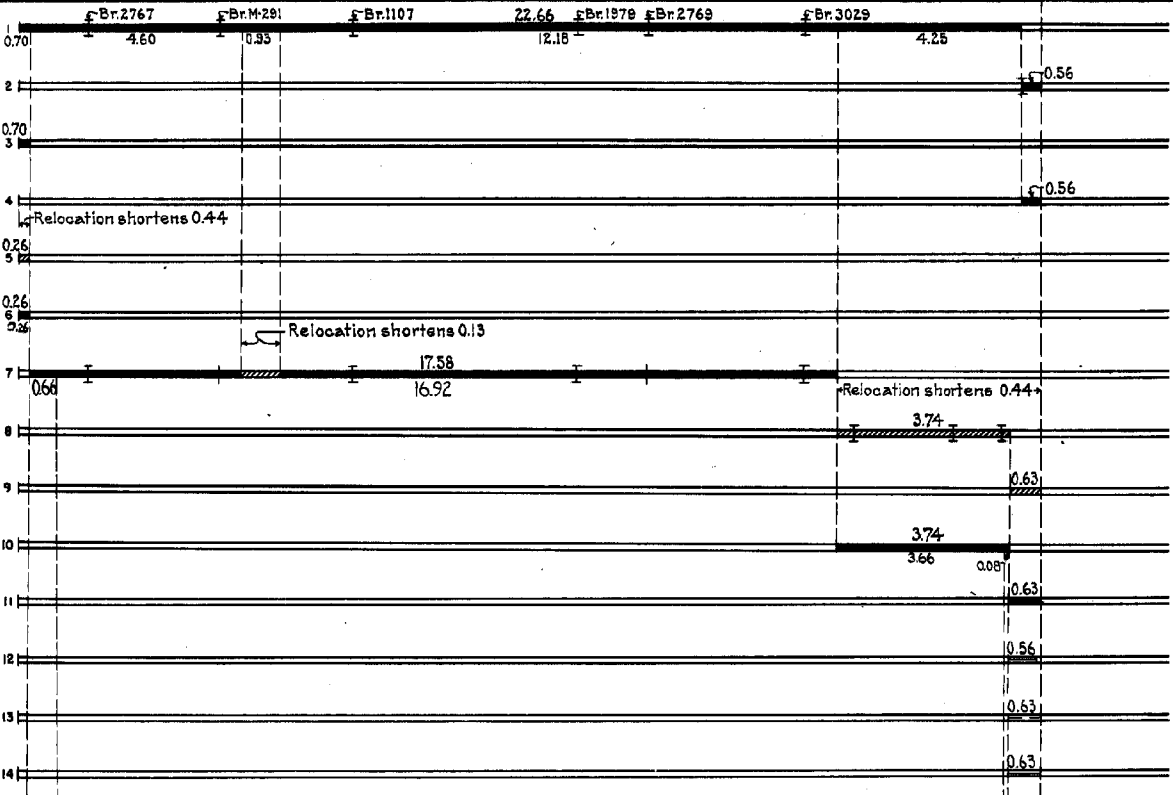

| YEARS FROM | TO   | TOTAL MILES | UNINCORPORATED |         | INCORPORATED |         | RURAL     |         | URBAN     |         |
|------------|------|-------------|----------------|---------|--------------|---------|-----------|---------|-----------|---------|
|            |      |             | RDWY. MI.      | BR. MI. | RDWY. MI.    | BR. MI. | RDWY. MI. | BR. MI. | RDWY. MI. | BR. MI. |
| 1921       | 1929 | 23.22       | 21.27          | 0.05    | 1.85         | 0.01    | 21.82     | 0.06    | 1.34      | 0.00    |
| 1930       | 1930 | 22.98       | 21.27          | 0.05    | 1.45         | 0.01    | 21.82     | 0.06    | 0.90      | 0.00    |
| 1931       | 1931 | 22.65       | 21.16          | 0.03    | 1.45         | 0.01    | 21.71     | 0.04    | 0.80      | 0.00    |
| 1932       | 1947 | 22.21       | 20.86          | 0.05    | 1.30         | 0.00    | 21.26     | 0.05    | 0.90      | 0.00    |
| 1948       | 1958 | 22.39       | 20.85          | 0.05    | 1.49         | 0.00    | 21.44     | 0.05    | 0.90      | 0.00    |
| 1959       |      | 22.39       | 20.74          | 0.05    | 1.60         | 0.00    | 21.33     | 0.05    | 1.01      | 0.00    |

REMARKS: Layout is to scale as of 1932

(1) Br.2767, 30' B.S. built in 1917; Br.M-291, 20' B.S.; Br.1107, 23' B.S.; Br.1979, 116' L.T.&B.S. built in 1917; Br.2769, 20' B.S. built in 1917; Br.3029, 40' Slab Span, built in 1920. (2) This work not done under these project numbers but lies within the limits of these projects.

(3) Br.5001, 30' B.S.; Br.5002, 110'10'; Br.5003, 23' B.S.; Br.5004, 85' D.T.; Br.5005, 110'10' & Br.5006, 40' Conc. Slab.

PREPARED BY  
HIGHWAY PLANNING SURVEY  
IN COOPERATION WITH  
U.S. PUBLIC ROADS ADMINISTRATION

STATE OF MINNESOTA  
DEPARTMENT OF HIGHWAYS  
ROAD LIFE STUDIES  
CONSTRUCTION PROJECT LOG RECORD

CONTROL SECTION 4812  
TRUNK HIGHWAY 169  
COUNTY Miller Lake  
DISTRICT 3A-3B

LIMITS: Jct. T.H. 23 in Milaca — So. Jct. T.H. 27 in Onamia

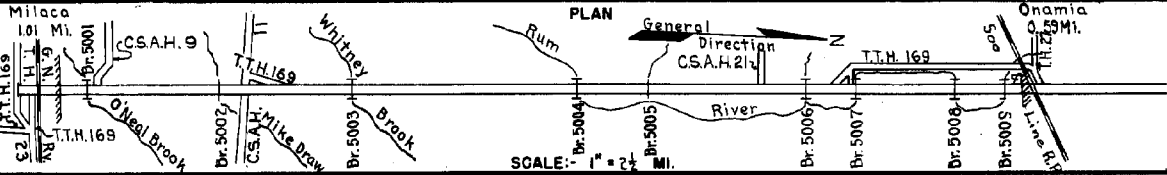

| YEAR BUILT | PROJECT N <sup>o</sup>  | DESCRIPTION   |            |                            | CODE N <sup>o</sup> |
|------------|-------------------------|---|------------|----------------------------|---------------------|
|            |                         | TYPE  | WIDTH      | THICKNESS                  |                     |
| M          | 1943 A.F.E. 4           | Spot Treat<br>Bit. Surf. Repair                                 | 24'        |                            | 1                   |
| M          | 1945 A.F.E. 4           | Bit. Surf. Repair   | 24'        |                            | 2                   |
| M          | 1946 A.F.E. 23          | Spot Treat.<br>Bit. Surf. Repair<br>Spot Grav. Lift             | 34'<br>36' | 1'-12"                     | 3                   |
| M          | 1947 A.F.E. 4           | Spot Treat.<br>Bit. Surf. Repair                                | 24'        |                            | 4                   |
| M          | 1948 A.F.E. 4           | Spot Treat.<br>Bit. Surf. Repair                                | 24'        |                            | 5                   |
| C          | 1948 4812-04            | Grading<br>Bit. Stab. Base<br>(Mixed Bit)                       | 34'<br>32' | 4"                         | 6                   |
| C          | 1949 4812-05            | Plant Mix Bit.  | 24'        | 1 1/2"                     | 7                   |
| C          | 1950 4812-07<br>4812-06 | Traffic Signals<br>R.R. Xing Signal                             |            |                            | 8                   |
| C          | 1953 A.F.E. 829         | Stab. Gravel<br>Shoulders                                       |            |                            | 9                   |
| C          | 1955 4812-09<br>4812-10 | Widening<br>Concrete<br>Traffic Signals                         | 24'        | 8"                         | 10                  |
| M          | 1957 A.F.E. 605         | Bit. Seal Coat  | 25'        |                            | 11                  |
| C          | 1960 4812-12            | Grading Base<br>Plant Mix Bit. Surf.                            |            |                            | 12                  |
| C          | 1962 4812-14<br>(1)     | Grading Sub-base*<br>Gravel & Bit. Base<br>Plant Mix Bit. Surf. | 44'        | 1 1/2"<br>4 1/2"<br>3 1/2" | 13                  |
| C          | 1968 4812-17            | Pl. Mix. Bit. Surf.<br>Gravel Shldrs.                           | 20'        | 1 1/2"                     | 14                  |

|                         |
|-------------------------|
| 0.63                    |
| 0.63                    |
| 0.63 (Net 0.36)         |
| 0.63 (Net 0.13)         |
| 0.63 (Net 0.19)         |
| Relocation lengths 0.18 |
| 0.89                    |
| 0.89                    |
| 0.89                    |
| 0.89                    |
| 0.09                    |
| 0.66                    |
| 0.63                    |
| 20.58                   |

| YEARS FROM | TOTAL TO | UNINCORPORATED |         | INCORPORATED |         | RURAL     |         | URBAN     |         |
|------------|----------|----------------|---------|--------------|---------|-----------|---------|-----------|---------|
|            |          | RDWY. MI.      | BR. MI. | RDWY. MI.    | BR. MI. | RDWY. MI. | BR. MI. | RDWY. MI. | BR. MI. |
|            |          |                |         |              |         |           |         |           |         |
|            |          |                |         |              |         |           |         |           |         |
|            |          |                |         |              |         |           |         |           |         |
|            |          |                |         |              |         |           |         |           |         |

REMARKS: See Sheet #1  
(1) New Base for full width Mi. Pt. 0.26 to 0.33 and right & left of old 20' P.C. Concrete. Mi. Pt. 0.33 to 0.92

PREPARED BY  
TRANSPORTATION PLANNING AND PROGRAMMING DIVISION  
IN COOPERATION WITH  
U.S. DEPARTMENT OF TRANSPORTATION - FEDERAL HIGHWAY ADMINISTRATION

STATE OF MINNESOTA  
DEPARTMENT OF HIGHWAYS  
ROAD LIFE STUDIES  
CONSTRUCTION PROJECT LOG RECORD

CONTROL SECTION 1812  
TRUNK HIGHWAY 169  
COUNTY Milaca  
DISTRICT 5A26

LIMITS: Jct. T.H. 23 in Milaca - S. Jct. T.H. 27 in Onamia  
Ref. Pt. 191+00.591 - 213+00.625

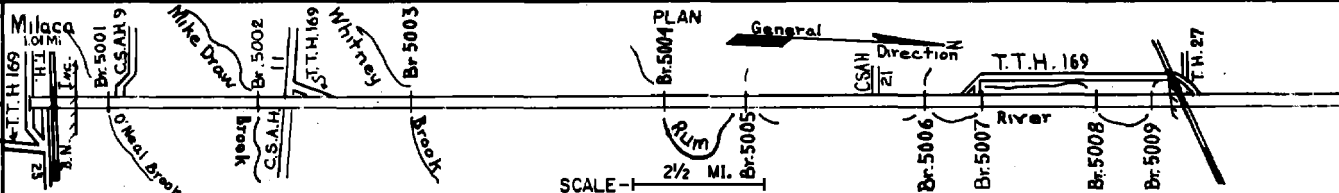

| YEAR BUILT | PROJECT NO         | DESCRIPTION                                  | WIDTH   | THICKNESS     | REMARKS                                  |
|------------|--------------------|--|---------|---------------|--|
|            |                    |  |         |               |  |
| 1974       | -28                | Plant Mix Bit Surf                           | 26'     | 2 1/2"        |  |
| 1975       | -30                | Pl. Mix Btt. Surf.                           | 44'-46' | 1 1/2"        |  |
| 1977       | 4812-35            | Bit Surfacing & Agg. Shoulders               | 20'     | 2" VAR        | BIT-2#2341 9500 Ton<br>Agg Cl-1 9000 Ton |
| 1981       | 4812-38<br>4812-39 | Bit. Surfacing<br>Bit. Shoulders<br>Striping | 20'     | 2 1/2" VAR    | 2.29'                                    |
| 1984       | 4812 SF            | Spot Bit Overlay                             | 12'-24' | 1"            | Sp. 2341 420 Tons                        |
| 1984       | 4812-21            | Grading<br>Br. 48003<br>Br. 23112, 23201     |         |               | S.M. Rdwy                                |
| 1986       | 4812-40            | Bit. Surfacing                               | 24'     | 3 1/2" 1"     | Spec. 2331<br>Spec. 2341                 |
| 1987       | 4812-36            | Grading                                      |         |               |  |
| 1987       | 4812-48            | Bit. Surfacing                               | 24'     | 4" 1"         | Spec. 2331<br>Spec. 2341                 |
| 1991       | 4812-44            | Grading<br>Bit. Surfacing                    | 24'     | 1 1/2" 1"     | Spec. 2331<br>Spec. 2361                 |
| 1991       | M4489              | Bit. Shouldering                             | 4'      | 4"            | Spec. 2331                               |
| 1993       | M93146             | Bit. Sealing                                 |         |               |  |
| 1993       | M93128             | Bit. Overlay                                 | 28'     | 1 1/2"        | Spec. 2341                               |
| 1996       | 4812-69            | Milling<br>Bit. Overlay                      | Var.    | 1 1/2" 1 1/2" | Spec. 2341                               |

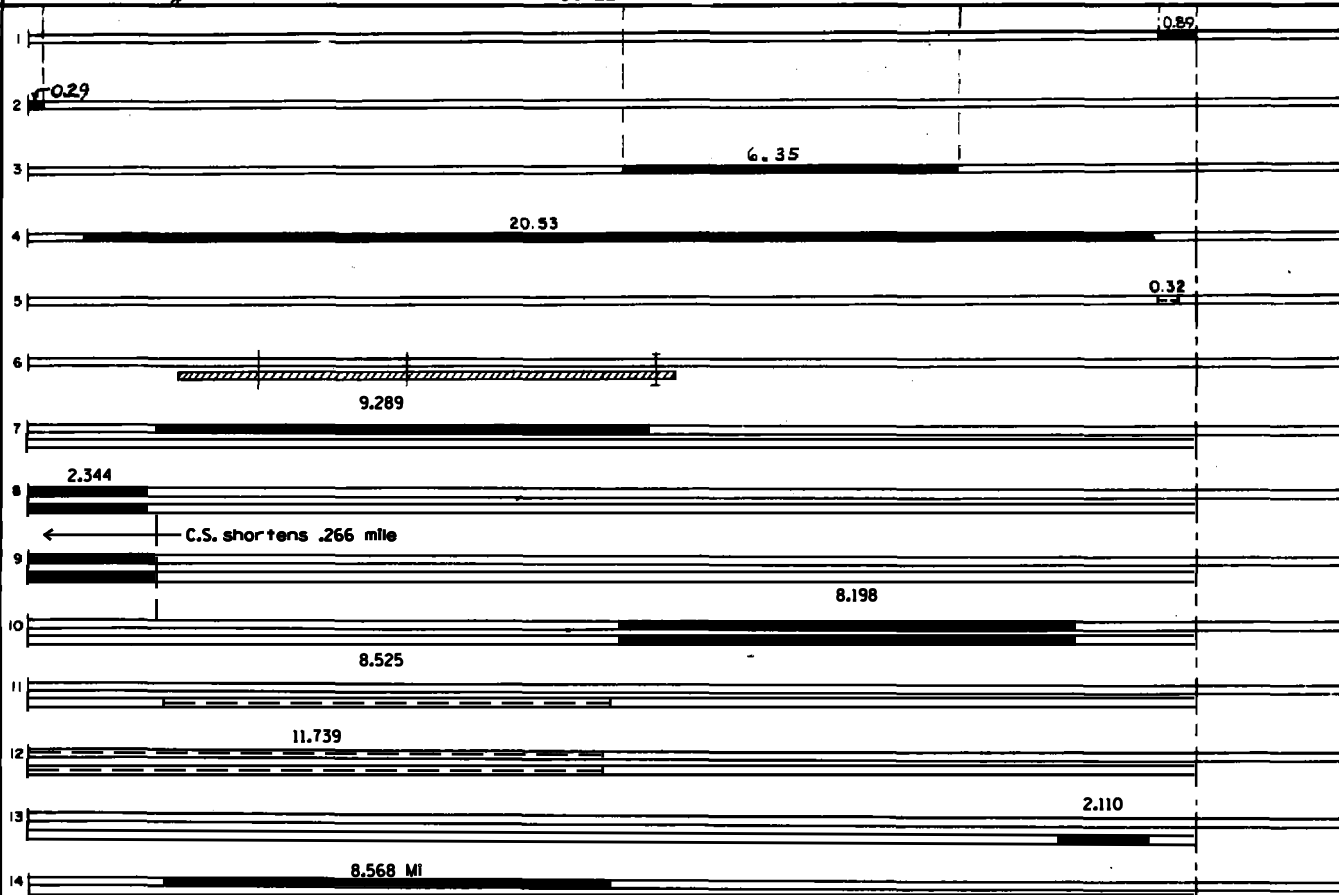

| YEARS FROM | YEARS TO | TOTAL MILES | UNINCORPORATED |         | INCORPORATED |         | RURAL     |         | URBAN     |         |
|------------|----------|-------------|----------------|---------|--------------|---------|-----------|---------|-----------|---------|
|            |          |             | RDWY. MI.      | BR. MI. | RDWY. MI.    | BR. MI. | RDWY. MI. | BR. MI. | RDWY. MI. | BR. MI. |
|            |          |             |                |         |              |         |           |         |           |         |

REMARKS: See Sheet No. 1  
C.S. shortens .266 mile due to Milaca bypass construction in 1987.

