

PREPARED BY
HIGHWAY PLANNING SURVEY
IN COOPERATION WITH
U.S. PUBLIC ROADS ADMINISTRATION

STATE OF MINNESOTA
DEPARTMENT OF HIGHWAYS
ROAD LIFE STUDIES
CONSTRUCTION PROJECT LOG RECORD

CONTROL SECTION 4003
TRUNK HIGHWAY 19
COUNTY LeSueur
DISTRICT 5A

LIMITS: Jct. T.H. 13 in New Prague - E. Co. Line

YEAR BUILT	PROJECT N ^o	DESCRIPTION			CODE N ^o	PLAN
		TYPE	WIDTH	THICKNESS		
		Oil Tr. Gravel	44"	1 1/2"		1
					No Record of Constr. Taken over from City in 1934.	
1923		Gravel	24'	1 1/2"	Scott Co. 2307	2
		Br. 3894	19'		Added in 1934 18' C.S.	
1925	19-13-26	Gravel	50'		1600 C.Y./Mile.	3
1931		Concrete	50'		City Paving. No Record of Constr.	4
1938	A.F.E. 34	Mixed Bitum.	30'	1"	Maint. Dept.	5
M	A.F.E. 28	Bit. Retreat.			MG 3,138.45 Gal./Mi.	6
	A.F.E. 9	Frost Boil Treat.			Grav. 62 C.Y./Mi.	
M	A.F.E. 23	Subgrade Treat.			MG 2,275.9 Gal./Mi.	7
1943	A.F.E. 4	Spot Treat.	27'		Grav. 802 C.Y./Mi.	
		Bit. Surf. Repair			Maint. Dept.	
M		Spot Treat.			MG 2 & RT 6,474.0 G./Mi.	8
1944	A.F.E. 4	Bit. Surf. Repair	24'		Grav. 198 C.Y./Mi.	
					Maint. Div.	
M		Spot Treat.			RT-6, 465.8 Gal./Mi.	9
1945	A.F.E. 4	Bit. Surf. Repair	24'		Grav. 160 C.Y./Mi.	
					Maint. Div.	
M		Spot Treat.			SC 3, 777.7 Gal.	10
1946	A.F.E. 4	Bit. Surf. Repair	24'		Agg. 399 C.Y.	
					2.49 (Net 1.10)	
M		Spot Treat.			MG 3, 151.45 Gal.	11
1948	A.F.E. 4	Bit. Surf. Repair	24'		Agg. 567 C.Y.	
					2.49 (Net 1.65)	
M		Spot Treat.			SC 3, 487.3 Gal.	12
1949	A.F.E. 4	Bit. Surf. Repair	24'		Agg. 225 C.Y.	
					0.40	
C	4003-03	Br. 8529			2' B.S. & 10' x 9' C.S. Culv.	13
		(1)				
C	4003-04	Grading	44' x 44'	19'-7"	Replace W 44 by S.C.	14
1950	(2)	Concrete			Culvert	

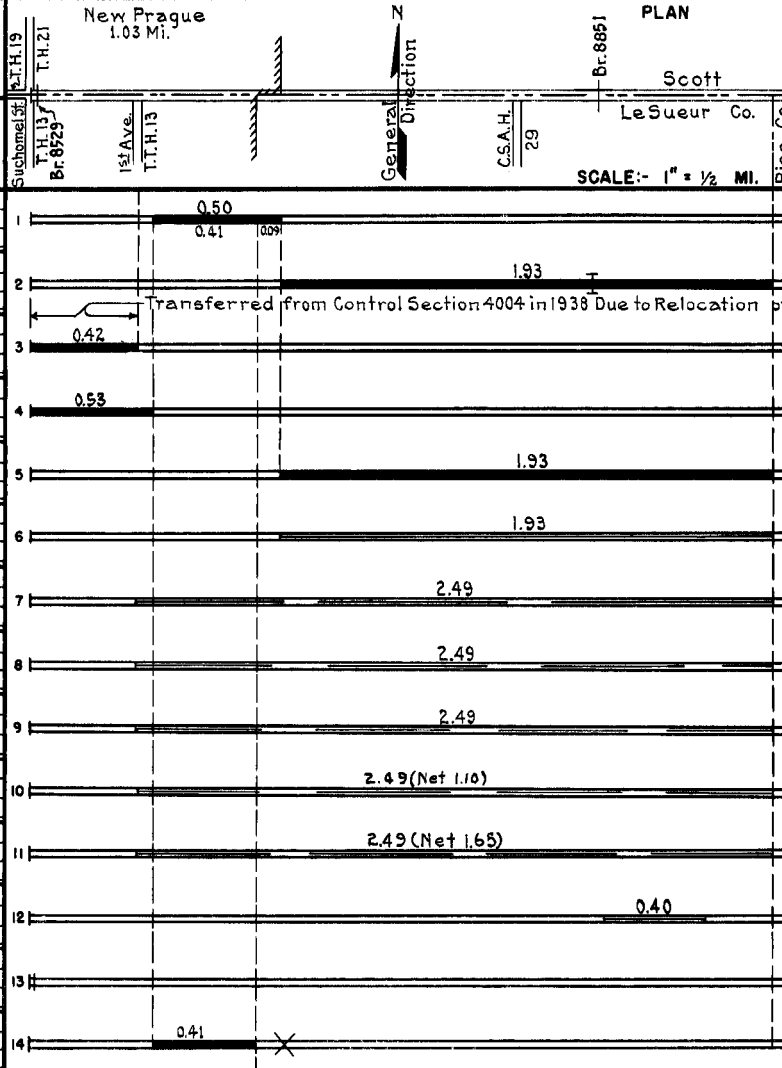

YEARS		TOTAL MILES	UNINCORPORATED		INCORPORATED		RURAL		URBAN	
FROM	TO		RDWY. MI.	BR. MI.	RDWY. MI.	BR. MI.	RDWY. MI.	BR. MI.	RDWY. MI.	BR. MI.
1934	1937	2.49	1.92	0.01	0.56	0.00	1.92	0.01	0.56	0.00
1938	1953	2.96	1.92	0.01	1.03	0.00	1.92	0.01	1.03	0.00
1954		2.95	1.92	0.00	1.03	0.00	1.92	0.00	1.03	0.00

REMARKS: Layout is to scale as of 1938. (1) Br. 8529 also on C.S. 4002
(2) Contract not final, but work substantially complete

PREPARED BY
HIGHWAY PLANNING SURVEY
IN COOPERATION WITH
U.S. PUBLIC ROADS ADMINISTRATION

STATE OF MINNESOTA
DEPARTMENT OF HIGHWAYS
ROAD LIFE STUDIES
CONSTRUCTION PROJECT LOG RECORD

CONTROL SECTION 4003
TRUNK HIGHWAY 19
COUNTY LaSueur
DISTRICT Metro

LIMITS: Jct T.H.13 in New Prague - E. Co. Line
Ref. Pt. 150+00.832 - 153+00.787

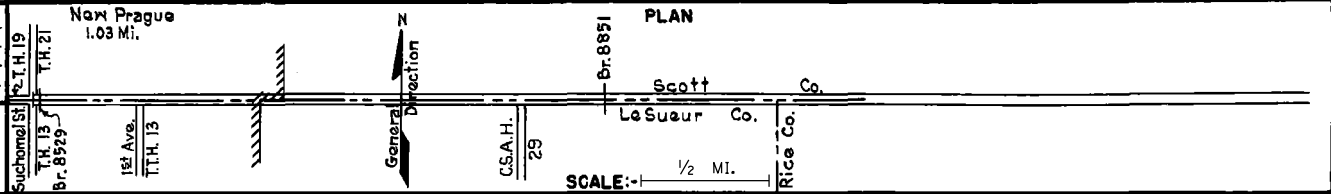

YEAR BUILT	PROJECT N ^o	DESCRIPTION			CODE N ^o	MILES
		TYPE	WIDTH	THICKNESS		
M	1952 A.F.E. 4	Spot Treat.				2.02 (Net Repair 0.50)
	A.F.E. 5	Bit. Surf. Repair	24'			
		Light Bit. Seal (2.02 Mi.)	24'			
C	1953 A.F.E. 824	Bit. Surfacing	24'	1"	SG-3, 15298 Gal. Agg. 1301 tons	2.02
		Road Mix		Added		
C	1954 4003-06	Grading	40'			Shortens 0.01
	(2)	Gravel	32'		1200 C.Y./Mi. C 1010D	2.01
		Br. 8851				
C	1956 4003-07	Sand-Grav. Sub-base	32'	8"		2.01
		Bit. Stab. Grav. Base	32'	4"		
		Plant Mix Bit.	24'	2"		
M	1961	Spot Light Bit. Seal	25'		R5-2, 3489 Gal. Agg. 150 C.Y.	2.01 (Net 1.85)
C	1974 4003-09	Bit. Overlay	50'	1"		0.94
C	1976 4003-11	Pl. Mix Bit. Resurf.	24'	1 1/2"		2.012
		Pl. Mix Bit. Subbase	8'	1 1/2"		
C	1977 4003-12	TRAFFIC CONTROL			TH 19 & 1 st Av. N.E. IN NEW PRAGUE	
	FID-1(2)	SIGNAL SYSTEM				
C	1982 4003-14	Bit. Surfacing	50'	2 1/4"		0.947
M	1986 SF	Spot Overlay			Spec. 2341	0.151 Mi.
C	2000 4003-16	Milling & Bit. Overlay	24'	3.5"	Spec. 2350	2.959 Mi.
S	2003 4003-19	Bituminous crack repair	24'		Spec. 3723, 3725, 3719	2.955 Mi.
S	2007 4003-21	Grading	36'			0.796 Mi.
		Agg. Base	36'	12"	Class 5	
		Bit. Surfacing	24'	8"	Spec. 2360	
S	2017 4003-26	Grading				0.443 Mi.
		Bit. Mill & Overlay	var.	2"	Spec. 2360	
		Bit. Surf. - RTL's	var.	6"	Agg. base 5' Cl. 6	

YEARS		TOTAL MILES	UNINCORPORATED		INCORPORATED		RURAL		URBAN	
FROM	TO		RDWY. MI.	BR. MI.	RDWY. MI.	BR. MI.	RDWY. MI.	BR. MI.	RDWY. MI.	BR. MI.

REMARKS: See Sheet #1
Line 12 - S.P. 4003-19 (S03129) extends into C.S. 7013.