

PREPARED BY
TRAFFIC AND PLANNING DIVISION
IN COOPERATION WITH
U.S. DEPARTMENT OF COMMERCE
BUREAU OF PUBLIC ROADS

STATE OF MINNESOTA
DEPARTMENT OF HIGHWAYS
ROAD LIFE STUDIES
CONSTRUCTION PROJECT LOG RECORD

CONTROL SECTION 3417
TRUNK HIGHWAY 7
COUNTY Kandiyohi
DISTRICT BA

LIMITS: N. Jct. T.H. 23 - Jct. T.H. 9

Ref. Pt. 129+00.204 - 138+00.512

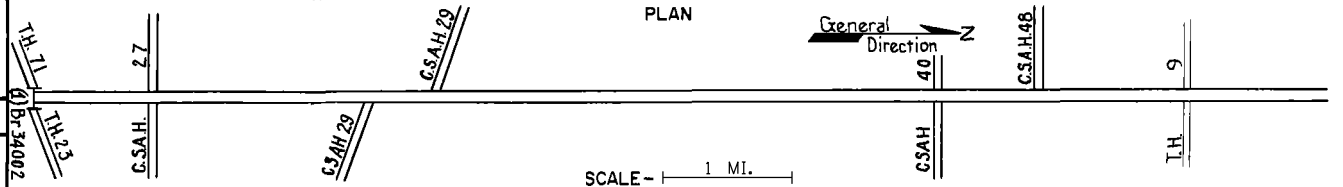

YEAR BUILT	PROJECT NO	DESCRIPTION				REMARKS
		TYPE	WIDTH	THICKNESS		
C 1962	3417-02	Grading Gravel Base Road Mix Bit. (Base)	47' 43' 26'	 4 1/2" 1 1/2"		
C 1963	3417-04 (2)	Grading Base Plant mix Bit.	 24'	 3 1/2"	0.43 mi Divided Highway	
M 1984	4101	Spot Bit. Surfacing	24'	1 1/2"	Sp. 2331 2687 Tons	
M 1985	SF	Spot Overlay				
M 1986	4207	Spot Overlay				
C 1988	3417-12	Bit. Overlay	24'	1 1/2"	Spec. 2341	
M 1991	4446	Bit. Sealing				
M 2003	3417-14	Bit. Overlay	24'	1 1/2"	Spec. 2350	
S 2004	3408-14	Grading Aggregate Bituminous Surf	36' 36' 24'	2' 2' 1/2"	Class 3, Class 6 Spec 2360	
D 2005	D05095 8828-85	Seal Coat Surfacing	24'		Spec. 2356.604	
S 2011	8828-113	Agg. Seal & Fog Seal			Type FA-2	

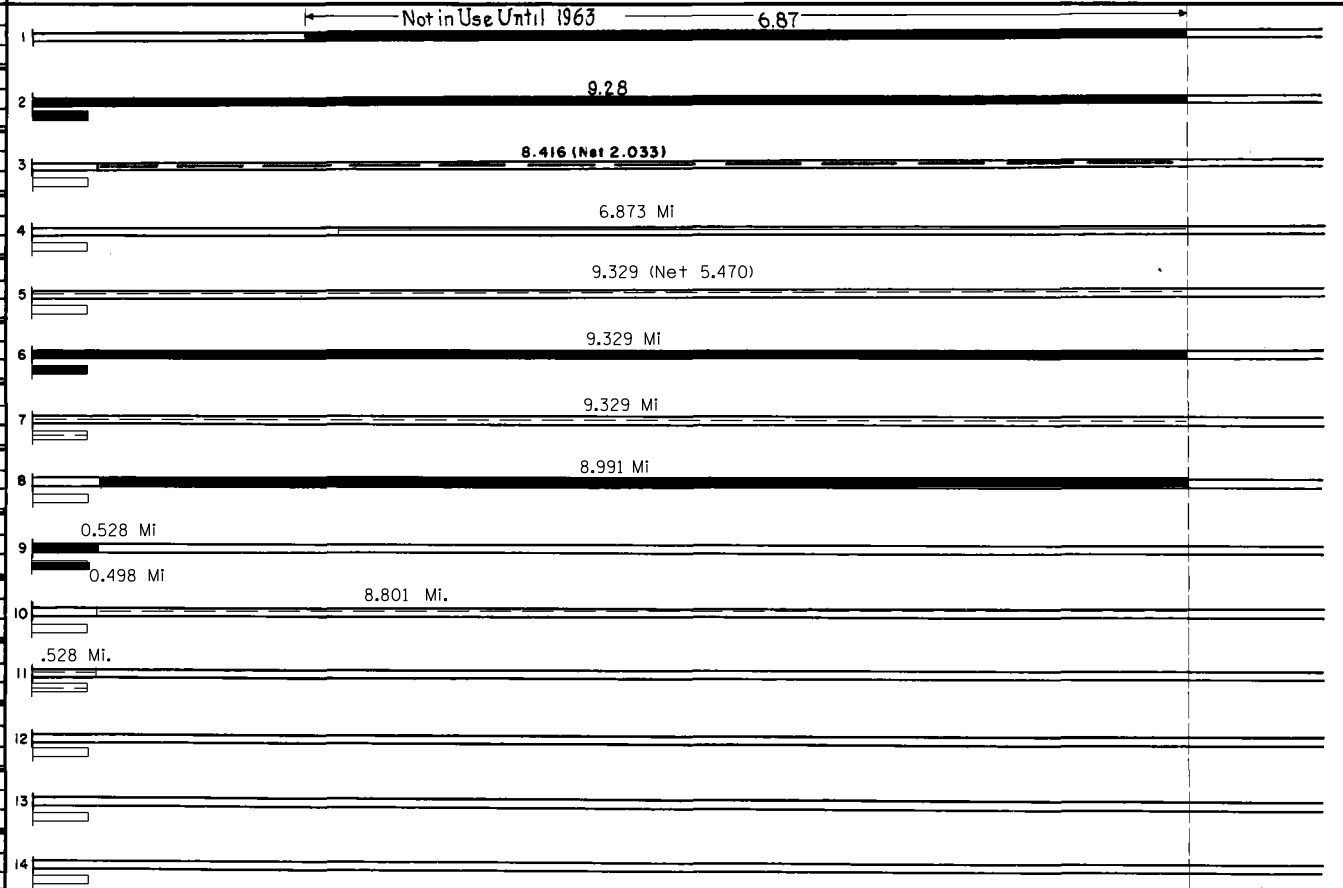

YEARS		TOTAL MILES	UNINCORPORATED		INCORPORATED		RURAL		URBAN		
FROM	TO		RDWY. MI.	BR. MI.	RDWY. MI.	BR. MI.	RDWY. MI.	BR. MI.	RDWY. MI.	BR. MI.	
1963		9.28	9.28	0.00	0.00	0.00	0.00	9.28	0.00	0.00	0.00

REMARKS: Layout is to scale as of 1962
(1) Br 34002 N.B.T.H. 71 under W.B. T.H. 23 see C.S. 3413
(2) Grading, 18" to 6" sub-base & base under 1" bit. base Constructed from m. pt. 0.00 to 2.4)