

PREPARED BY
HIGHWAY PLANNING SURVEY
IN COOPERATION WITH
U. S. PUBLIC ROADS ADMINISTRATION

STATE OF MINNESOTA
DEPARTMENT OF HIGHWAYS
ROAD LIFE STUDIES
CONSTRUCTION PROJECT LOG RECORD

CONTROL SECTION 2808
TRUNK HIGHWAY 76
COUNTY Houston
DISTRICT 6A

LIMITS: Y. Jct. T.H. 16 in Houston - N. Co. Line.

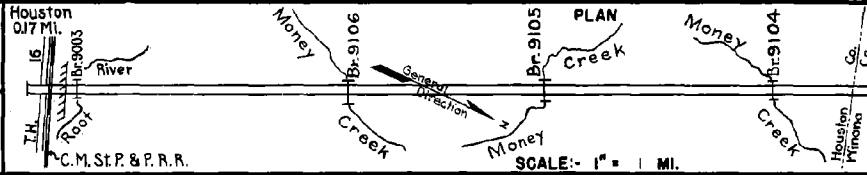

YEAR BUILT	PROJECT N ^o	DESCRIPTION			CODE N ^o
		TYPE	WIDTH	THICKNESS	
1926		Shale Br. 79	18'	1 1/2"	1
1926		Gravel 3 Bridges (1)	18'	1 1/2"	2
1936		Br. 5558	24'		3
		Br. 5559	24'		3
C	A.F.E. 32	Reshaping & Cr. Rock Surf.	28'		4
1941	A.F.E. 33				4
M	1946	A.F.E. 6			5
M	1948	A.F.E. 6			6
C	1948	A.F.E. 33			7
C	1948	A.F.E. 26			8
M	1949	A.F.E. 4			9
M	1950	A.F.E. 4			10
M	1951	A.F.E. 4			11
M	1952	A.F.E. 4, 5, 66			12
M	1953	A.F.E. 604			13
M	1954	A.F.E. 604, 605			14

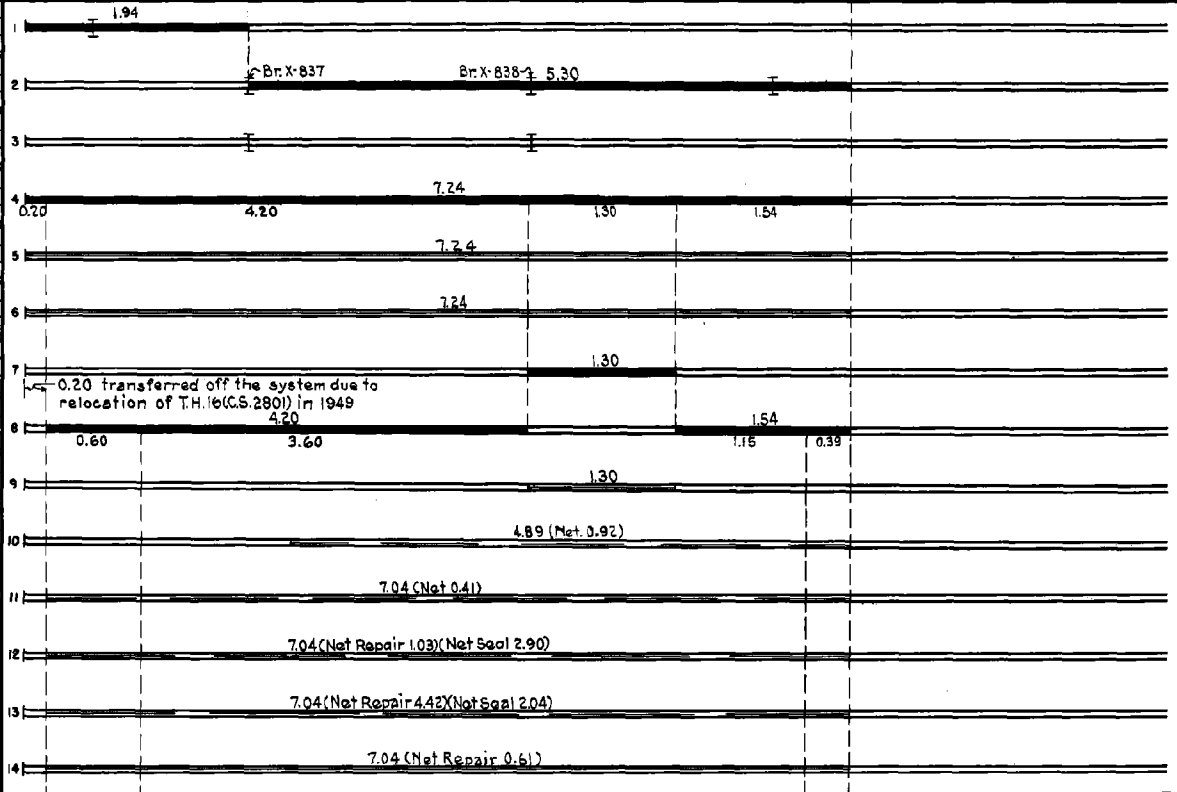

YEARS		TOTAL MILES	UNINCORPORATED		INCORPORATED		RURAL		URBAN	
FROM	TO		RDWY. MI.	BR. MI.	RDWY. MI.	BR. MI.	RDWY. MI.	BR. MI.	RDWY. MI.	BR. MI.
1934	1948	7.24	7.18	0.06	0.00	0.00	7.18	0.06	0.00	0.00
1948	1955	7.04	6.93	0.06	0.00	0.00	6.93	0.06	0.00	0.00
1955	1957	7.94	7.65	0.12	0.17	0.00	7.62	0.12	0.00	0.00
1958	1959	7.46	7.11	0.18	0.17	0.00	7.28	0.18	0.00	0.00
1960		7.46	7.11	0.18	0.17	0.00	7.11	0.18	0.17	0.00

REMARKS: Layout is to scale as of 1934.
(1) Br. X-837, 74' L.T. & B.S.; Br. X-838, 89' W.S. L.T. & B.S.; Br. 4079, 39' C.D.G.

PREPARED BY
HIGHWAY PLANNING SURVEY
IN COOPERATION WITH
U. S. PUBLIC ROADS ADMINISTRATION

STATE OF MINNESOTA
DEPARTMENT OF HIGHWAYS
ROAD LIFE STUDIES
CONSTRUCTION PROJECT LOG RECORD

CONTROL SECTION 2808
TRUNK HIGHWAY 76
COUNTY Houston
DISTRICT 6A

LIMITS: W. Jct. T.H. 16 in Houston - N. Co. Line

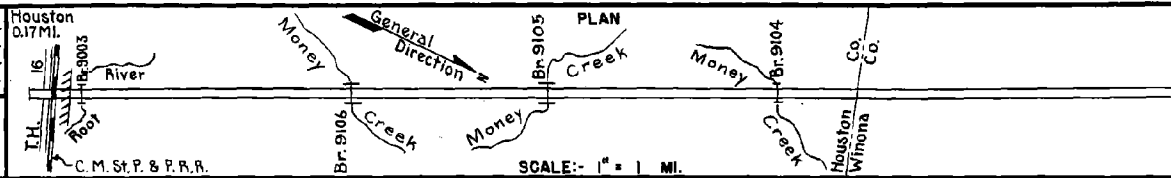

YEAR BUILT	PROJECT NO.	DESCRIPTION			CODE NO.
		TYPE	WIDTH	THICKNESS	
M 1955	A.F.E. 604	Spot Treat. Bit. Surf. Repair	24'		SC-3, 3467 Gal. Agg. 251 Tons
M 1956	A.F.E. 604	Spot Treat. Bit. Surf. Repair	24'		SC-3, 2376 Gal. Agg. 556 Tons
		Mixed Bit.	26'		Transferred in from Village in 1956
C 1956	2808-07*	Grading	40'		*Grading (Dike)
	2808-03	Crushed Rock	28'	2"	1200 C.Y./Mi.
	(2) 2808-04	Br. 9003	30'		400' D.P.G.
C 1956	Built as Temp. Conn. under S.P. 8509-03	Grading Crushed Rock	42' 34'	2"	1200 C.Y./Mi.
M 1957	A.F.E. 604	Spot Treat. Bit. Surf. Repair	24'		SC-3, 6989 Gal. Agg. 531 Tons
C 1958	2808-11	Crushed Rock Base Plant Mix Bit.	34' 24'	6" 2-3"	18 Pit Run Grav. Sub-base from Mi. Pt. 0.00-0.08.
C 1958	2808-05	Grading Crushed Rock	40' 28'	2"	1200 C.Y./Mi.
C 1958	2808-10	Br. 9106	30'		204' P.P.G.
	2808-09	Br. 9105	30'		204' P.P.G.
	2808-08	Br. 9104	30'		159' P.P.G.
M 1959	A.F.E. 604	Bit. Surf. Repair	24'	3/4"	SC-3 3779 Gal. Agg. 273 Tons
M 1960		Crushed Rock Resurfacing	24'		Cr. Rock, 2763 Tons
C 1961	2808-12	Crushed Rock Base Plant Mix Bit.	34' 24'	6-12" 2"	
M 1963		Spot Treat. Bit. Surf. Repair	24'		MC-2+RS-2, 2442 Gal. Road Mix 81 Tons
		Light Bit. Seal	25'		Agg. 88 C.Y.
M 1966	C	Light Bit. Seal	25'		CRS-1 Bit. 15,525 Gal. FA-1 Agg. 442 C.Y.
	SF	Random Rip Rap			1412 C.Y. at Br. 9003

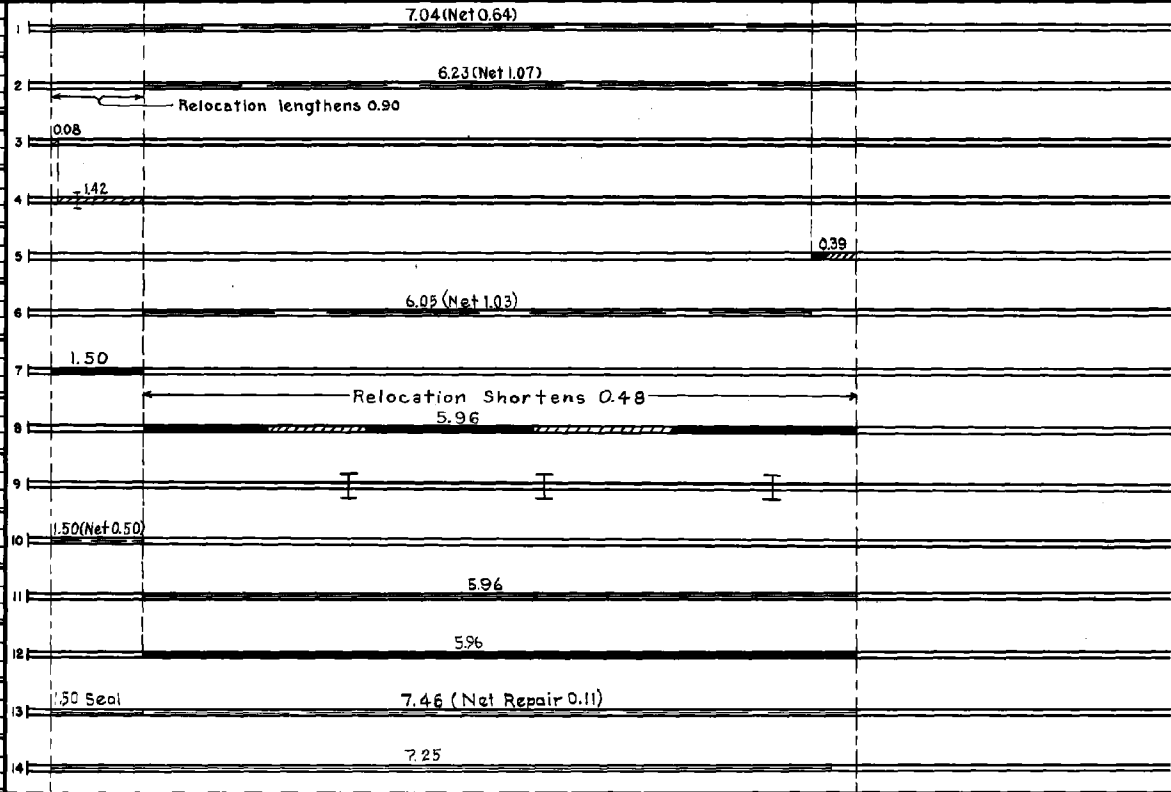

YEARS FROM	TOTAL MILES TO	UNINCORPORATED		INCORPORATED		RURAL		URBAN	
		RDWY. MI.	BR. MI.	RDWY. MI.	BR. MI.	RDWY. MI.	BR. MI.	RDWY. MI.	BR. MI.

REMARKS: See Sheet No. 1
(2) Approaches to Br. 9003 constructed under 1957 A.F.E. 606

