

PREPARED BY
TRAFFIC AND PLANNING DIVISION
IN COOPERATION WITH
U.S. DEPARTMENT OF COMMERCE
BUREAU OF PUBLIC ROADS

STATE OF MINNESOTA
DEPARTMENT OF HIGHWAYS
ROAD LIFE STUDIES
CONSTRUCTION PROJECT LOG RECORD
Maple Grove Edén Prairie 3.59 Mi.
Bloomington 9.14 Mi.

Interstate
CONTROL SECTION 2785
TRUNK HIGHWAY 494
COUNTY Hennepin
DISTRICT 5A

LIMITS: Jct. T.H. 94 - E. end Minnesota River Bridge at
Hennepin-Dakota Co. Line

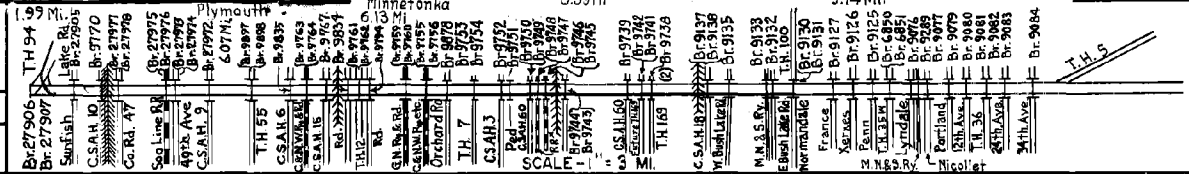

YEAR	PROJECT NO	DESCRIPTION			
		TYPE	WIDTH	THICKNESS	REMARKS
1959	2785-02104	Grade & Sub-Base	76'	12"	Divided Highway
	2785-05	Grav. Base	76'	3"	3 P. 2732-20 covers
	2785-32	Concrete	48'	10"	frontage roads
1959	2785-13	Br. 9127			200' B.S. - U.P.
	2785-14	Br. 9126			192' B.S. - U.P.
	2785-15	Br. 9125			182' B.S. - U.P.
1959	2785-18223	Br. 9077 & 9083			116' C.G. - U.P.
	2785-20121	Br. 9079 & 9080			118' C.G. - U.P.
	2785-22	Br. 9081 & 9082			164' C.G. - U.P.
1959	2785-03	Br. 9084	52' 52"		133' C.G. - O.H.
	2785-16&17	Br. 9076 & 9085			167' C.G. U.P. & 124' P.G. - U.P.
	2785-19	Br. 9078			274' B.S. Ped. U.P.
1956	2732-03	Br. 6850 (W.B. Rdwy)	39'		178' B.S. - O.H.
	2732-12	Br. 6851 (E.B. Rdwy)	39'		178' B.S. - O.H.
					Transferred in 1959
1961	2785-24	Grading & Sub-Base	2-49'	6"	Divided Highway
		Br. 9137 & 9138			both 214' C.G. - U.P.
		Br. 9135			196' C.G. - U.P.
1961	2785-24	Br. 9132			200' C.G. - U.P.
	2785-09	Br. 9130 & 9131 (D)	2-36'		both 174' B.S. - O.H.
		Br. 9133			178' P.G. - U.P.
1961	2785-97	Gravel Base	2-47'	3"	
		Concrete	2-24'	10"	
1963	2785-34235	Grading	2-49'		Divided Highway
		Sub-base	2-47'	3"	
		Gravel Base	2-45'	3"	
1963	2785-85	P.C. Concrete	2-24'	9 1/2"	
	2785-88	Sand Blanket			at Minnesota River
1963	2785-9878	Br. 9778			194 P.C.G. - U.P.
	2785-9731, 54	Br. 9753 & 9754			Both 182' B.S. - U.P.
	2785-9732	Br. 9752			232' B.S. - U.P.
1963	2785-9731	Br. 9751			258' Pedestrian - U.P.
	2785-9750&49	Br. 9750 & 9749	2-30'		Both 251' B.S. - O.H.
	2785-9748&47	Br. 9748 & 9747	2-30'		Both 174' B.S. - O.H.
1963	2785-9746&45	Br. 9746 & 9745	2-30'		Both 150' B.S. - O.H.
	2785-9744&43	Br. 9744 & 9743	2-30'		Both 186' B.S. - O.H.
	2785-9739	Br. 9739			220' P.C.G. - U.P.
1963	2785-9742&41	Br. 9742 & 9741	2-39'		219' & 226' P.C.G. - O.H.
	2785-9738	Br. 9738			203' P.C.G. - U.P.

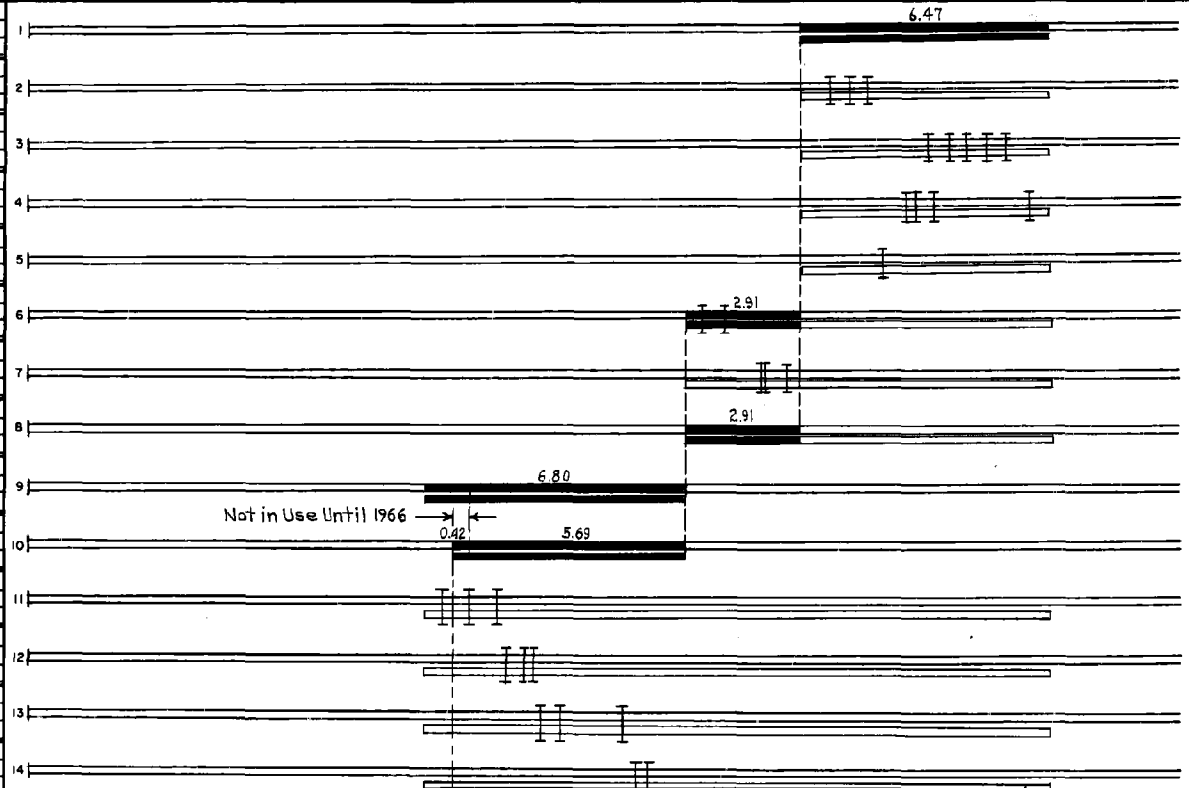

YEARS		TOTAL MILES	UNINCORPORATED		INCORPORATED		RURAL		URBAN	
FROM	TO		RDWY MI.	BR MI.	RDWY MI.	BR MI.	RDWY MI.	BR MI.	RDWY MI.	BR MI.
1939	1960	6.47	0.00	0.00	6.41	0.06	0.00	0.00	6.41	0.06
1961	1962	9.38	0.24	0.00	9.05	0.09	0.24	0.00	9.05	0.09
1963	1965	13.07	0.00	0.00	12.79	0.28	0.00	0.00	12.79	0.28
1966	1967	21.11	0.00	0.00	20.63	0.48	0.00	0.00	20.63	0.48
1968		27.08	0.00	0.00	26.53	0.55	0.00	0.00	26.53	0.55

REMARKS: Layout is to scale as of 1959
 (1) Br. 9130 W.B. rdwy. Br. 9131 E.B. rdwy. over T.H. 100 (Normandale road)
 (2) Br. 9738 at Present T.H. 169 no interchange or intersection at this bridge.

4-74

PREPARED BY
TRAFFIC AND PLANNING DIVISION
IN COOPERATION WITH
U.S. DEPARTMENT OF COMMERCE
BUREAU OF PUBLIC ROADS

STATE OF MINNESOTA Minnetonka Eden Prairie
DEPARTMENT OF HIGHWAYS
ROAD LIFE STUDIES
CONSTRUCTION PROJECT LOG RECORD

INTERSTATE CONTROL SECTION 2785
TRUNK HIGHWAY 494
COUNTY Hennepin
DISTRICT 5A

LIMITS: Jct. T.H. 94 - E end Minnesota River Bridge at
Hennepin-Dakota Co. Line

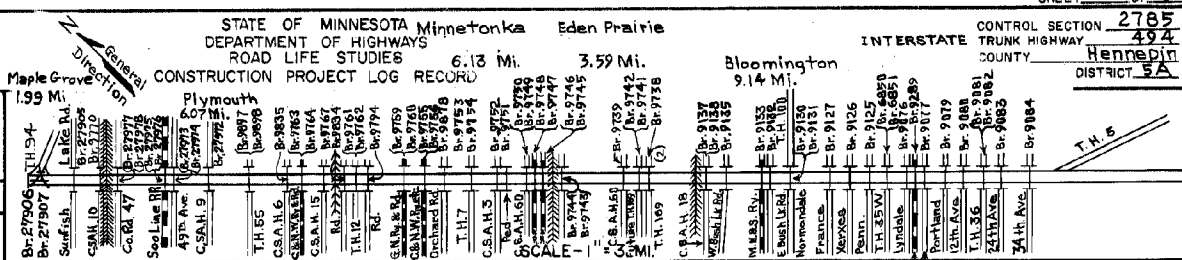

YEAR BUILT	PROJECT NO.	DESCRIPTION				REMARKS
		TYPE	WIDTH	THICKNESS		
1965	2785-11	Grading, Base P.C. Concrete	2@12'	10"	Widening, const. of inside lanes.	
	2785-6850-851	Widen Br's 6850 & 6851			Deck widths 2 @ 5'	
1966	2785-36	Grading	2@48'		Divided Highway	
	2785-9897-98	Br's 9897 & 9898			Both 227' P.P.G. - U.P.	
	2785-9835	Br. 9835			191' P.P.G. - U.P.	
1966	2785-108	Sub-base Gravel Base P.C. Concrete	2@28' 2@24'	3" 2 1/4" 9"	Base in place on portion graded under 2785-35	
1966	2785-9763-64	Br's 9763 & 9764	50' @ 30'		Both 231' B.S. - D.H.	
	2785-9767	Br. 9767			201' P.P.G. - U.P.	
	2785-9834	Br. 9834			182' B.S. - U.P.	
1966	2785-9761 & 62	Br's 9761 & 9762	59' @ 39'		Both 241' B.S. - D.H.	
	2785-9794	Br. 9794			227' B.S. - U.P.	
	2785-9759 & 60	Br's 9759 & 9760	50' @ 30'		Both 221' B.S. - D.H.	
1966	2785-9755 & 56	Br's 9755 & 9756	59' @ 39'		Both 337' B.S. - D.H.	
	(3)					
1968	2785-37	Grading Br. 27972 Br's 27973 & 27974	2@49' 3@83'		Divided Highway 211' B.S. - U.P. Both 112' B.S. - O.H.	
1968	2785-37	Br's 27975 & 27976 Br's 27977 & 27978 Br's 9770 & 27905	3@83' 3@83'		Both 132' B.S. - O.H. Both 139' P.P.G. - O.H. 208 - 239 B.S. - U.P.	
1968	2785-121	Gravel Base P.C. Concrete Pl. Mix. Bit. Shoulders	2@28' 2@24'	6" 9"	Divided Highway 3'in. & 10' out.	
1968	2786-29	Grading & Base Paving	24'	6" 9"	Temp. Conn. To T.H. 94 0.34 divided 0.58 single rdwy.	
1973	2785-172 1494-4(90) 221	Gravel Base P.C. Concrete Pl. Mix. Bit. Shoulders	2@ 24' 36'	10'	0.21 Mi. Widening	
1969	-124 1494-4(77) 238	TRAFFIC SIGNALS			AT FRANCE AVE. RAMP'S AT NO. FRONTAGE RD. + FRANCE AVE.	
1970	-147; -150 1494-4(84) 240	TRAFFIC SIGNALS			AT LYNDALE AVE AT NICOLET AVE	
1978	2785-202	TRAFFIC SIGNALS			AT THURM & THURM SOUTH RAMP'S, THE CANAL	

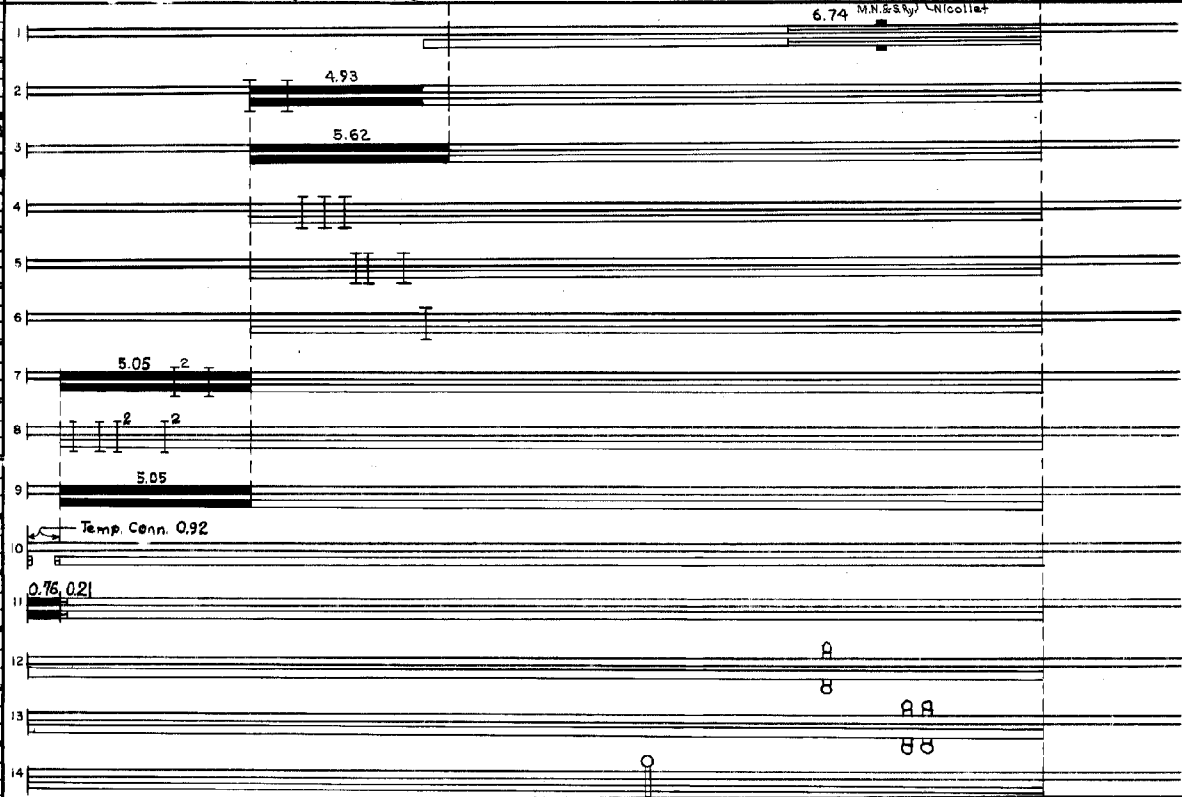

YEARS		TOTAL MILES	UNINCORPORATED		INCORPORATED		RURAL		URBAN	
FROM	TO		RDWY. MI.	BR. MI.	RDWY. MI.	BR. MI.	RDWY. MI.	BR. MI.	RDWY. MI.	BR. MI.

REMARKS See Sheet 1
 (3) S.P. 2785-91051 & 91052 both C10100 box culverts under ramps at C.S.A.H. 5.
 (4) See C.S. 2786 Line 110 for Bridge Information

PREPARED BY
BUREAU OF POLICY & PLANNING
IN COOPERATION WITH
U.S. DEPARTMENT OF TRANSPORTATION-FEDERAL HIGHWAY ADMINISTRATION

STATE OF MINNESOTA
DEPARTMENT OF TRANSPORTATION
CONSTRUCTION PROJECT LOG RECORD

MAPLE GROVE
EDEN PRAIRIE
3.50 MI.
BLOOMINGTON
9.14 MI.

CONTROL SECTION 2785
TRUNK HIGHWAY 494
COUNTY HENNEPIN
DISTRICT 5A

LIMITS: Jct TH 94 E. END MINNESOTA RIVER BRIDGE AT
HENNEPIN-DAKOTA CO. LINE

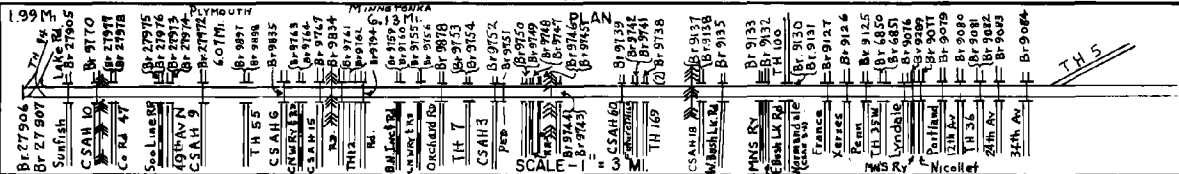

YEAR BUILT	PROJECT NO	DESCRIPTION			
		TYPE	WIDTH	THICKNESS	REMARKS
M 1978	SF	Pavement Relief Joints			From TH 100 To E Jct TH 5
C 1968	2785-123	Traffic Signals			Frontage Rds. & Ramps @ Inx & Penn Av.
C 1972	-148	Traffic Signals			At on/off ramps X-ing 12 th Ave
C 1972	-149	Traffic Signals			At on/off ramps X-ing Portland Av
C 1972	-173	Traffic Signals			At on/off ramps X-ing TH 55
M 1978	-196	Pavement Rehabilitation			0.4 MI. N. OF TH 7 To TH 100
C 1979	-198	Widening, Bit Surf Surveillance Sys Revision Lighting Sys Revision	12'	13 1/2"	0.17 MI. WIDENING ON EBLVD FROM PENN AV TO 35W
C 1979	SF	Grading, Surfacing on NE Ramp	34'	8 1/2"	From TH 100 to 0.5 MI. E
M 1980	2785-9083	Br. No. 9083			Reconst. Br. (Repair) At 24th Ave S.
M 1981	2785	Rolling Repair Br. No. 9081, 9082			
C 1981	2785-193	Signage, Sign Lighting & Traffic Control Signal System			TH-169 & TH-212 Interchange
C 1981	2785-SF 3882	Ramp Widening			N.W. Ramp at TH-55
C 1981	2785-180	Traffic Control Signal System			1-494 Ramps at 24th Ave S.
C 1982	SF	Pavement & Joint Repair			From MNTH-7 to MNTH-55 in Plymouth

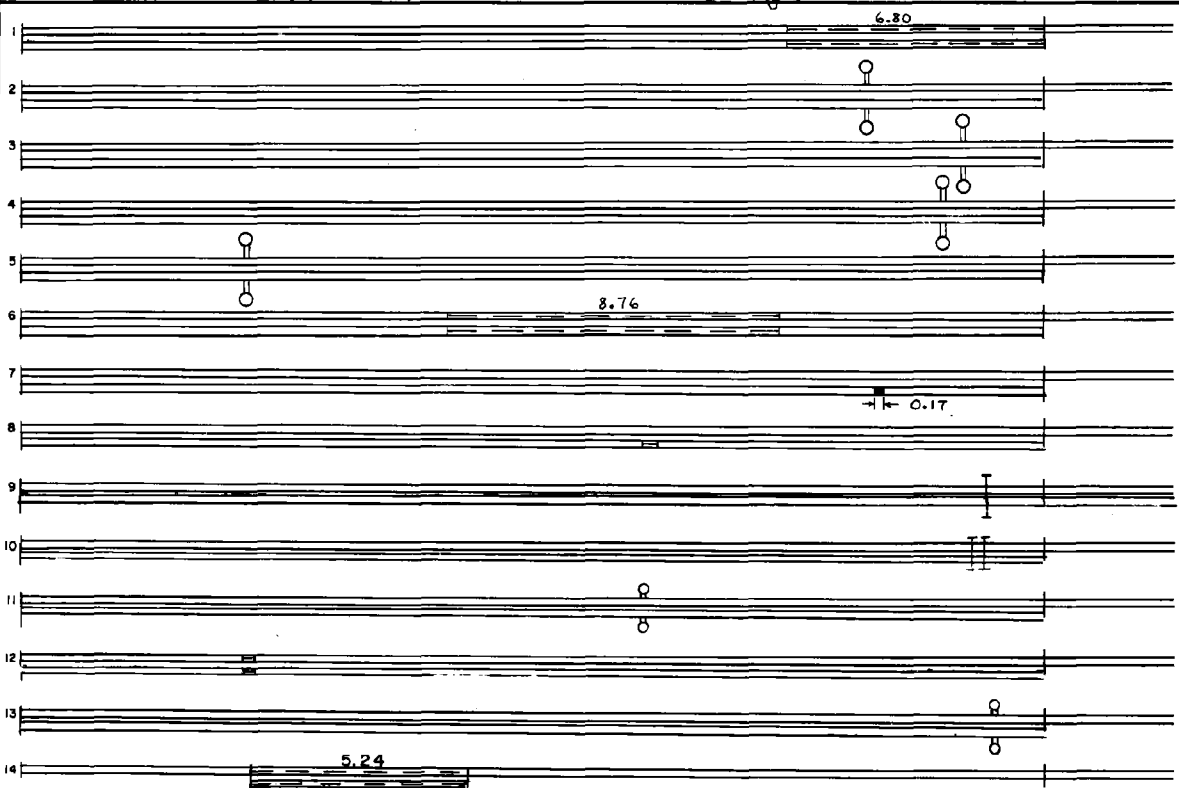

YEARS		TOTAL MILES	UNINCORPORATED		INCORPORATED		RURAL		URBAN	
FROM	TO		RDWY. MI.	BR. MI.	RDWY. MI.	BR. MI.	RDWY. MI.	BR. MI.	RDWY. MI.	BR. MI.

REMARKS:

