

PREPARED BY
TRAFFIC AND PLANNING DIVISION
IN COOPERATION WITH
U.S. DEPARTMENT OF COMMERCE
BUREAU OF PUBLIC ROADS

STATE OF MINNESOTA
DEPARTMENT OF HIGHWAYS
ROAD LIFE STUDIES
CONSTRUCTION PROJECT LOG RECORD

CONTROL SECTION 2763
TRUNK HIGHWAY 169
COUNTY Hennepin
DISTRICT 5A

LIMITS: Jct. T.H.494 in Eden Prairie - S. Jct. T.H.100 in Edina

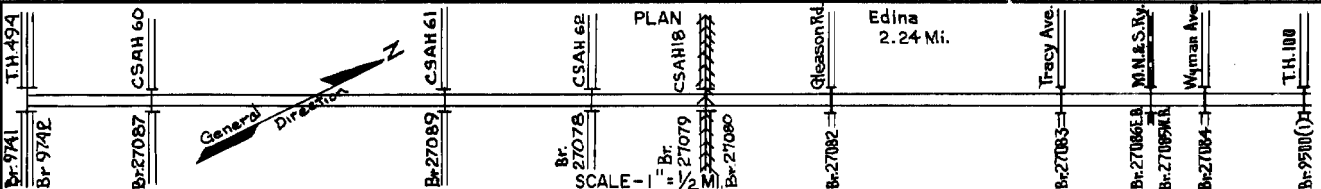

YEAR BUILT	PROJECT NO	DESCRIPTION			
		TYPE	WIDTH	THICKNESS	REMARKS
C					Divided Highway
1967	2763-05	Grading			195' P.P.G. - U.P.
		Br. 27082			
C					Divided Highway
1967	2763-02	Grading			Base & Surf. Const. for 0.26 mi.
		Gravel Sub-base & Base	20'24"	6"	
		P.C. Concrete		8"	
C					216' P.P.G. - U.P.
1967		Br. 27083	38'27"		Both 154' B.S. - O.H.
		Br's 27085 & 27086			183' P.P.G. - U.P.
		Br. 27084			
C					Divided Highway
1967	2763-97&10	Gravel Sub-base	48'-76"	3"	
		Gravel Base		3"	
		P.C. Concrete		8"	
C					Divided Highway
1967	2733-29	Grading, Sub-base**	20'24"	6"	
		Gravel Base		3"	
		P.C. Concrete		9"	
C					Divided Highway
1963	2785-34	Grading			
	I 494-4				
	(53) 227				
C					Divided Highway
1964	2785-85	RC. Concrete	20'24"	9"	
	I 494-4				
	(63) 225				
		Pl. Mix. Bit. Shoulders			
C					Divided Highway
1973	2763-08	Grading			
	I 2785-126				
	(2)				
		Gravel Base	20'24"	9"	
		P.C. Concrete			
C					Divided Highway
1973	2763-08	Br. 27087			291' P.P.G.
C					Divided Highway
1973	2763-11	Grading			
	F005-2				
	(38)				
		Gravel Base	20'24"	9"	
		P.C. Concrete			
C					Divided Highway
1973	2763-11	Br. 27089			291' P.P.G.
C					Divided Highway
1971	2763-06	Grading			
		Gravel Base	20'24"	8"	
		P.C. Concrete			
C					443' Box Grider
1971	2763-06	Br. 27078			293' O.S.
		Br. 27079			293' O.S.
		Br. 27080			
C					Br. 27082
1971	2763	Br. 27082			
		Concrete Overlay			

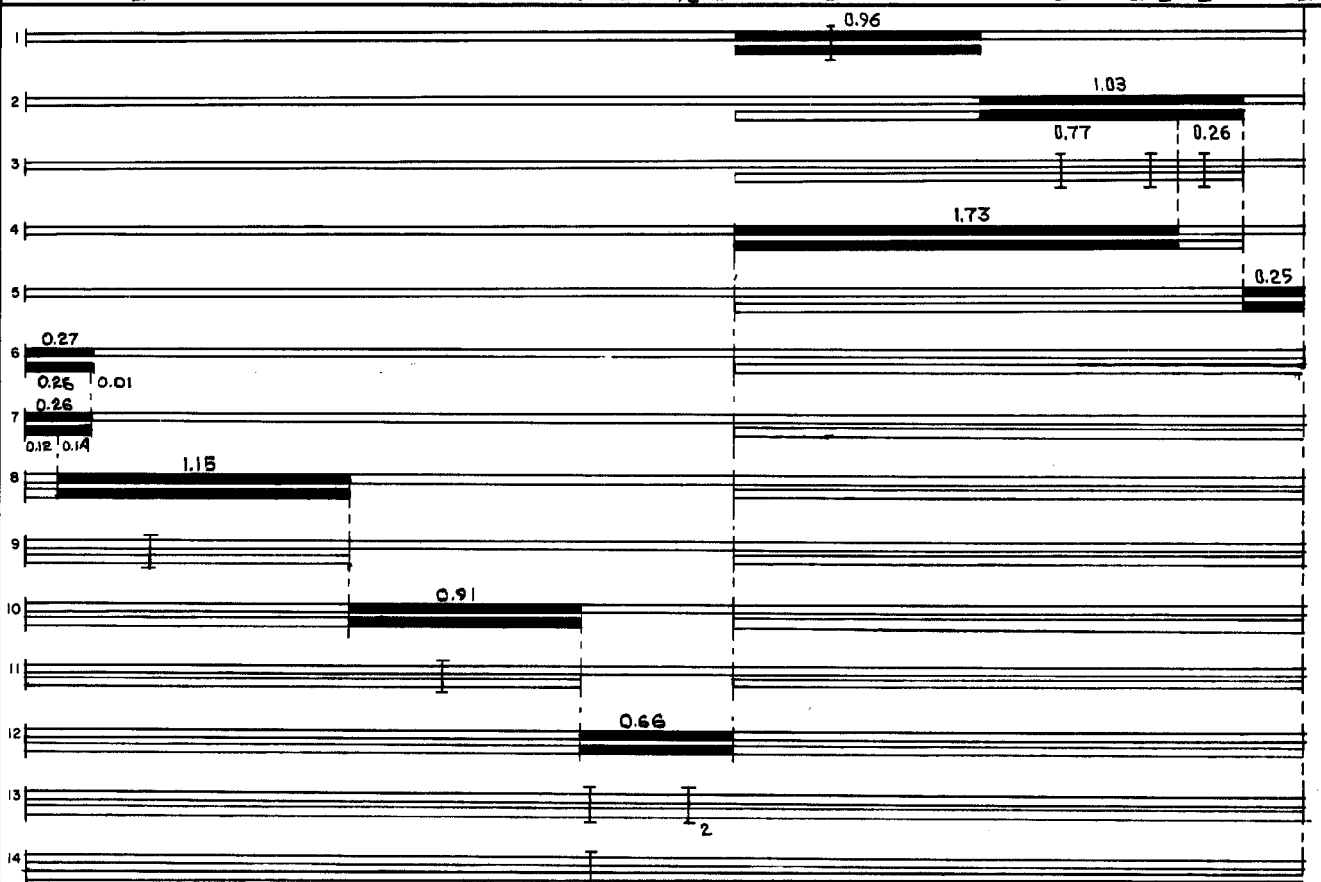

YEARS		TOTAL MILES	UNINCORPORATED		INCORPORATED		RURAL		URBAN	
FROM	TO		RDWY. MI.	BR. MI.	RDWY. MI.	BR. MI.	RDWY. MI.	BR. MI.	RDWY. MI.	BR. MI.
1967		2.24	0.00	0.00	2.21	0.03	0.00	0.00	2.21	0.03
1973		5.10	0.00	0.00	5.07	0.03	0.00	0.00	5.07	0.03

REMARKS: Layout is to scale as of 1967.
(1) Br. 9500 T.H.169 under T.H.100 see C.S.2733. (2) F005-2 (38) & I494 (79) 233 (3) Brs. 9741 & 9742 T.H.212 under T.H.494 See C.S.2785

