

PREPARED BY
HIGHWAY PLANNING SURVEY
IN COOPERATION WITH
U.S. PUBLIC ROADS ADMINISTRATION

STATE OF MINNESOTA
DEPARTMENT OF HIGHWAYS
ROAD LIFE STUDIES
CONSTRUCTION PROJECT LOG RECORD

CONTROL SECTION 2512
TRUNK HIGHWAY 60
COUNTY Goodhue
DISTRICT 6B

LIMITS: S. Jct. T.H. 52 S.E. of Zumbrota - E. Co. Line

YEAR BUILT	PROJECT N ^o	DESCRIPTION			CODE N ^o	T.H.	PLAN
		TYPE	WIDTH	THICKNESS			
		Gravel	22'	2"		5.12	
						No Record of Constr.	
						Added in 1984.	
M	1940	A.F.E. 12	Spot Graveling			292 C.Y./Mi. Maint. Dept.	
M	1942	A.F.E. 6	Spot Graveling			192 C.Y./Mi. Maint. Dept.	
M	1944	A.F.E. 6	Grav. Resurfacing (Spots)			491 C.Y./Mi. Maint. Div.	
M	1945	A.F.E. 6	Grav. Resurfacing (Spots)	22'		94 C.Y./Mi. Maint. Div.	
C	1946	2512-03	Grading Stab Gravel Culverts (1)	36' 32'	2"	1200 C.Y./Mi.	
C	1949	A.F.E. 27	Bit. Surfacing Mixed Bit.	24'	1 1/2"	MC-18563, 54380 Gal. Agg. 2532 Tons	
M	1950	A.F.E. 4	Spot Treat. Bit. Surface Repair	24'		5C-7, 20057 Gal. Agg. 696 C.Y.	
M	1951	A.F.E. 4	Spot Treat. Bit. Surf. Repair	24'		5C3, 18808 Gal. Agg. 1076 C.Y.	
M	1952	A.F.E. 4	Spot Treat. Bit. Surf. Repairs	24'			
M	1952	A.F.E. 4	Bit. Surfacing Mixed Bit.	24'	1"		
C	1953	2512-05	Sand/Grav. Subbase Gravel Base Plant Mix Bit.	32' 32' 24'	9" 3" 1 1/2"		
C	1961	2505-20	Gravel & Bit. Base Plant Mix Bit. Light Bit. Seal	* 25'	3"	*varies 44'-24' RS-2, 9014 Gal.	
M	1967	C	Bit. Seal Coat	25'		CRS-2 Bit. 17,717 Gal. FA-2 Agg. 602 C.Y.	

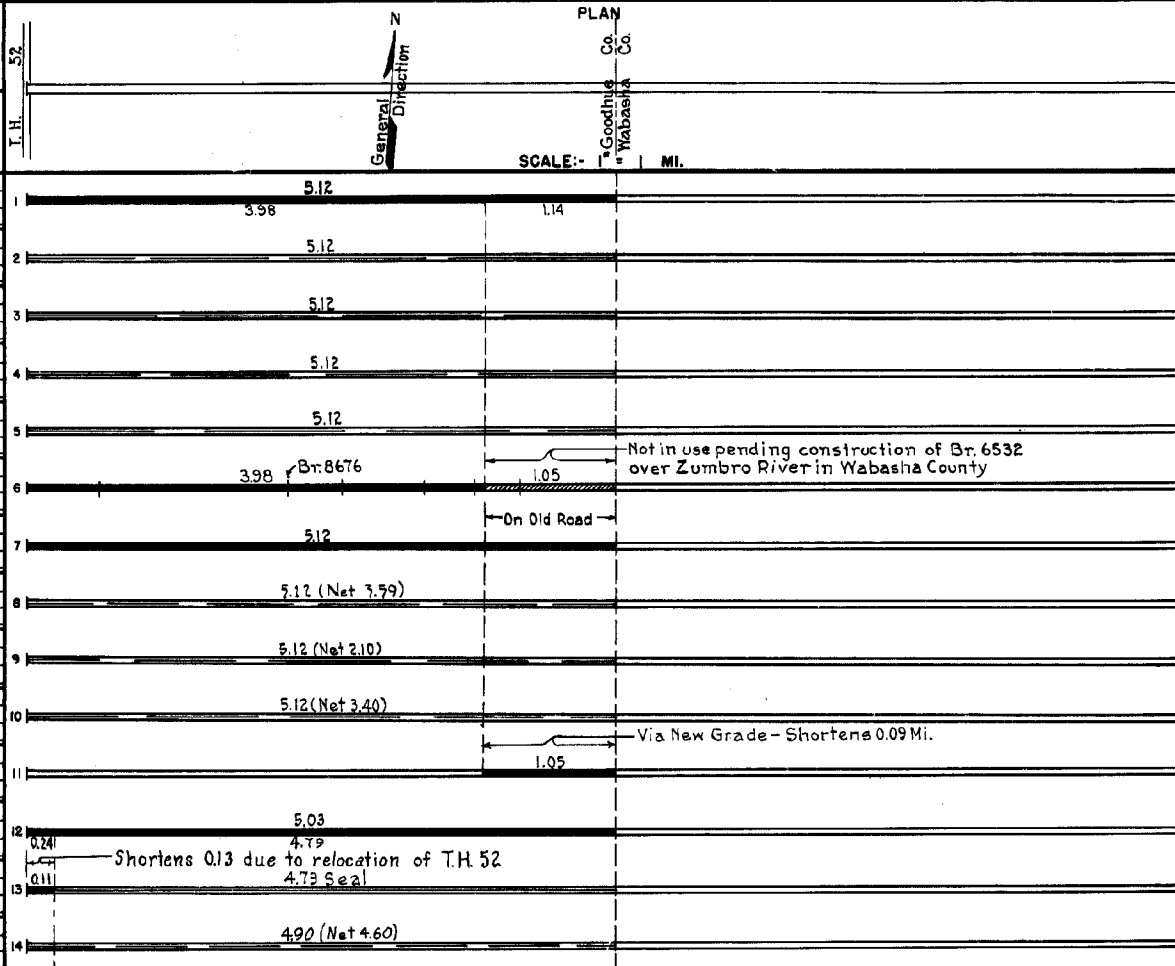

YEARS		TOTAL MILES	UNINCORPORATED		INCORPORATED		RURAL		URBAN		REMARKS: Layout is to scale as of 1934 (1) W 108 H (Br. 8676), 2-W 66 H, 3-4x6 Timber Box Culv., & extend Y33, Y64, Y66 & Y81
FROM	TO		RDWY. MI.	BR. MI.	RDWY. MI.	BR. MI.	RDWY. MI.	BR. MI.	RDWY. MI.	BR. MI.	
1934	1951	5.12	5.12	0.00	0.00	0.00	5.12	0.00	0.00	0.00	
1952	1960	5.03	5.03	0.00	0.00	0.00	5.03	0.00	0.00	0.00	
1961		4.90	4.90	0.00	0.00	0.00	4.90	0.00	0.00	0.00	

