

PREPARED BY
HIGHWAY PLANNING SURVEY
IN COOPERATION WITH
U.S. PUBLIC ROADS ADMINISTRATION

STATE OF MINNESOTA
DEPARTMENT OF HIGHWAYS
ROAD LIFE STUDIES
CONSTRUCTION PROJECT LOG RECORD

CONTROL SECTION 1911
TRUNK HIGHWAY 56
COUNTY Dakota
DISTRICT 9A

LIMITS: N. End of Bridge over Cannon River - Jct. T.H. 50 at Hampton

PLAN

0.00 Mi Hampton



YEAR BUILT	PROJECT N°	DESCRIPTION			CODE N°
		TYPE	WIDTH	THICKNESS	
		Gravel	22'	1"	No Record of Constr. Added in 1934. 58 S.S. & 18 B.S.
		Gravel	20'	1"	No Record of Constr. Added in 1934.
1935		Br. 1316	23'		Widening. 58 S.S.
		Br. 1315	27'		18 B.S.
1941	A.F.E. 22	Mixed Bit.	20'	2"	Maint. Dept.
		Bit. Seal Coat	22'		RC-3, 2469 Gal./Mi. Sand, 67 C.Y./Mi. Maint. Dept.
1945	A.F.E. 6	Grav. Resurfacing	24'		303 C.Y./Mi. Maint. Div.
1946	A.F.E. 5	Bit. Seal Coat	Var.		RT-10, 2509 Gal. Agg. 69 C.Y.
1947	1911-02	Grading	34-42'		2.3 Mi. Divided Highway
		Stab. Gravel	35-4	2"	1200 C.Y./Mi.
		7 Mono. Culverts			
1949	1911-05	Channel Diversion			At Chub Creek
	A.F.E. 7	Seeding			
1949	1906-07	Gravel Base	62'	10"	Divided Highway
		Plant Mix Bit.	48'	1 1/2"	
1950	1911-04	Stab. Gravel Base	37-40	3-8"	1.5 Mi. Divided Highway
		Mixed Bit.	38-41	1"	
1950	A.F.E. 33	Bit. Stab. Base	26'	1"	MC-3, 8526 Gal.
		Mixed Bit.	26'	1"	Agg. 400 C.Y.
1951	A.F.E. 4	Light Bit. Seal			RT-6, 8934 Gal. Agg. 172 C.Y.
1952	1911-06	Gravel Base	32'	0-9"	
		Plant Mix Bit.	24'	1 1/2"	

YEARS FROM	TO	TOTAL MILES	UNINCORPORATED		INCORPORATED		RURAL		URBAN	
			RDWY. MI.	BR. MI.	RDWY. MI.	BR. MI.	RDWY. MI.	BR. MI.	RDWY. MI.	BR. MI.
1934	1946	7.08	5.22	0.01	1.84	0.01	7.06	0.02	0.00	0.00
1947	1952	6.11	5.58	0.00	0.73	0.00	6.11	0.00	0.00	0.00
1953		6.16	5.63	0.00	0.53	0.00	6.16	0.00	0.00	0.00

REMARKS: Layout is to scale as of 1934. Plan revised for 1947 relocation.
(1) Old road in use thru Randolph until Cannon River bridge is built.

PREPARED BY BUREAU OF POLICY & PLANNING IN COOPERATION WITH U.S. DEPARTMENT OF TRANSPORTATION - FEDERAL HIGHWAY ADMINISTRATION

STATE OF MINNESOTA DEPARTMENT OF TRANSPORTATION CONSTRUCTION PROJECT LOG RECORD

CONTROL SECTION 1911 TRUNK HIGHWAY 56 COUNTY Dakota DISTRICT Metro

LIMITS: N. end of Br. 6525 (over Cannon River) Goodhue/Dakota Co. Line - Jct. of MNTH 50 Ref. Pt. 092+00.632 - 098+00.789

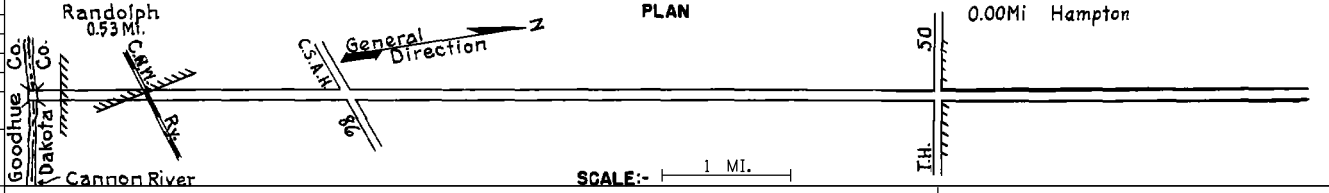

Table with columns: YEAR BUILT, PROJECT No, DESCRIPTION (TYPE, WIDTH, THICKNESS), REMARKS. Includes entries for 2013 projects 8825-470 and 1911-23.

Summary table with columns: YEARS FROM, YEARS TO, TOTAL MILES, UNINCORPORATED RDWY. MI., BR. MI., INCORPORATED RDWY. MI., BR. MI., RURAL RDWY. MI., BR. MI., URBAN RDWY. MI., BR. MI., REMARKS: