

PREPARED BY
HIGHWAY PLANNING SURVEY
IN COOPERATION WITH
U.S. PUBLIC ROADS ADMINISTRATION

STATE OF MINNESOTA
DEPARTMENT OF HIGHWAYS
ROAD LIFE STUDIES
CONSTRUCTION PROJECT LOG RECORD

CONTROL SECTION 1003
TRUNK HIGHWAY 7
COUNTY Carver
DISTRICT 5A

LIMITS: West Co. Line - East Co. Line

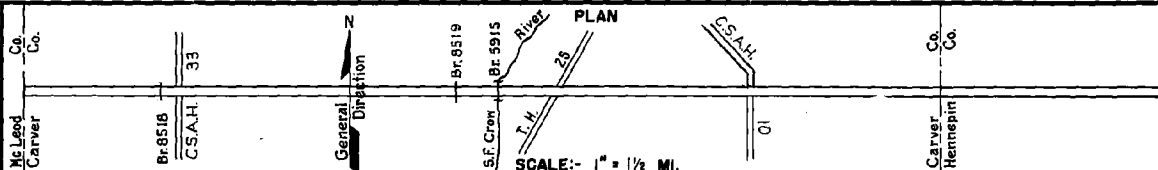

YEAR BUILT	PROJECT N°	DESCRIPTION			CODE N°
		TYPE	WIDTH	THICKNESS	
		Gravel	28'	3/4" - 1"	
		Br. #3569 & 3961	820'		
1940	1003-03	Br. 5915	30'		
1940	1003-05	8 Mong Culverts Br. 8518 & 8519			
1941	1003-02	Grading	34'		
1941	1003-07	Stab. Gray Base Mixed Bit.	32' 2" - 10"		
1941	A.F.E. 36	Seeding			
1943	A.F.E. 19	Bit. Fog Seal	27'		
1946	A.F.E. 18	Bit. Resurfacing Mixed Bit.	26'	1" added	
1947	A.F.E. 4	Bit. Fog Seal	27'		
1949	A.F.E. 26	Spot Subgr. Corr. Restore Bit. Surface			
1950	A.F.E. 4	Light Bit. Seal			
1951	1003-09	Remove Bridge & Const. Arch Culvert			
1952	A.F.E. 4 A.F.E. 5	Spot Treat. Bit. Surf. Repair Light Bit. Seal (17.03 MI)	26'		
1953	1003-11	Base * Plant Mix Bit. Bit. Seal	32' 6" - 18" 24' 2"		
1957	A.F.E. 605	Bit. Seal Coat	24'		
1963	1003-13	Plant Mix Bit Gravel Shoulders	24'	1 1/2"	

1	12.00	
2		Relocation lengthens 0.03
3	12.03	
4		
5	12.03	
6	12.03	
7	12.03	
8		4.60 (Net 0.13)
9	12.03	
10		
11	12.03	
12	12.03	
13	12.03	
14	12.03	

YEARS FROM	TO	TOTAL MILES	UNINCORPORATED		INCORPORATED		RURAL		URBAN	
			ROWY. MI.	BR. MI.	ROWY. MI.	BR. MI.	ROWY. MI.	BR. MI.	ROWY. MI.	BR. MI.
1934	1940	12.00	11.98	0.02	0.00	0.00	11.98	0.02	0.00	0.00
1941		12.03	12.01	0.02	0.00	0.00	12.01	0.02	0.00	0.00

REMARKS: Layout is to scale as of 1934

(1) W46X44, W46X45, 16' Ext. to W99DX34.5, 22' Ext. to W99DX30, 25' Ext. to W46X32, 26' Ext. to W46X32, 18' Ext. to W46X35 & W46X45.

PREPARED BY
TRAFFIC AND PLANNING DIVISION
IN COOPERATION WITH
U.S. DEPARTMENT OF COMMERCE
BUREAU OF PUBLIC ROADS

STATE OF MINNESOTA
DEPARTMENT OF HIGHWAYS
ROAD LIFE STUDIES
CONSTRUCTION PROJECT LOG RECORD

CONTROL SECTION 1003
TRUNK HIGHWAY 7
COUNTY Carver
DISTRICT Metco

LIMITS: West Co. Line - East Co. Line
Ref. Pt. 159+00.955 - 171+00.991

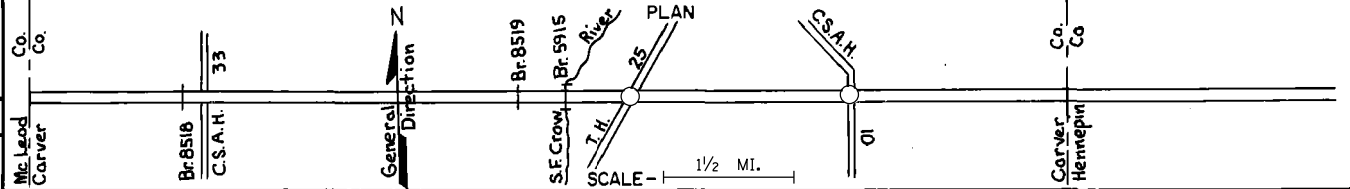

YEAR BUILT	PROJECT NO.	DESCRIPTION			
		TYPE	WIDTH	THICKNESS	REMARKS
M 1968	SF	Bit. Overlay	24'	1 1/2"	RC-250 tack, 450 Gals. Agg. 1241 Tons
C 1973	1003-18	Asph. Conc. Surf. Gravel Shldr. Also Some Re-grad	24'	3 1/2"	
C 1975	1003-20	Bit. Base Asph. Conc. Surf. Bit. Shldr. Br 10023	30' 24'	1 1/2" 2 3/4"	EXCER: M.P. 6.23 - 6.29
C 1976	1003-21	Bit. Base Asph. Conc. Surf. Bit. Shldr. Br 10023	30' 24'	1 1/2" 10"	199' P.P.G. - O.H.
C 1976	1003-22	FLASHER SIG. SYS.			AT T.H. 7 & T.H. 25
C 1980	SF	Br. 10023 Deck Repair Concrete Overlay	46.5'	2 1/2"	Low Slump Concrete Mix No. 3U17A
C 1985	1003-23	Bit. Milling Bit. Surfacing Bit. Shldr. Br 10023	24'	5" 7 1/8" 8"	Remove Impl. Bit.
M 1991	M4449	Fog Seal			Shldr.
C 1998	1003-25	Bit. Milling Bit. Overlay	46'	Var.	Type LV3 SP 9.5 Type LV4
M 2001	8825-103	Rout & Seal of Bituminous Cracks			3725
S 2008	1003-30	Grading Bit. Surfacing Const. Roundabouts	var.	var.	Spec. 2360 At TH-25 & CSAH-10
S 2008	1003-28	Bit. Overlay Widening	var. 24-48'	var.	Spec. 2360
2011	8825-410	Rout & Seal			

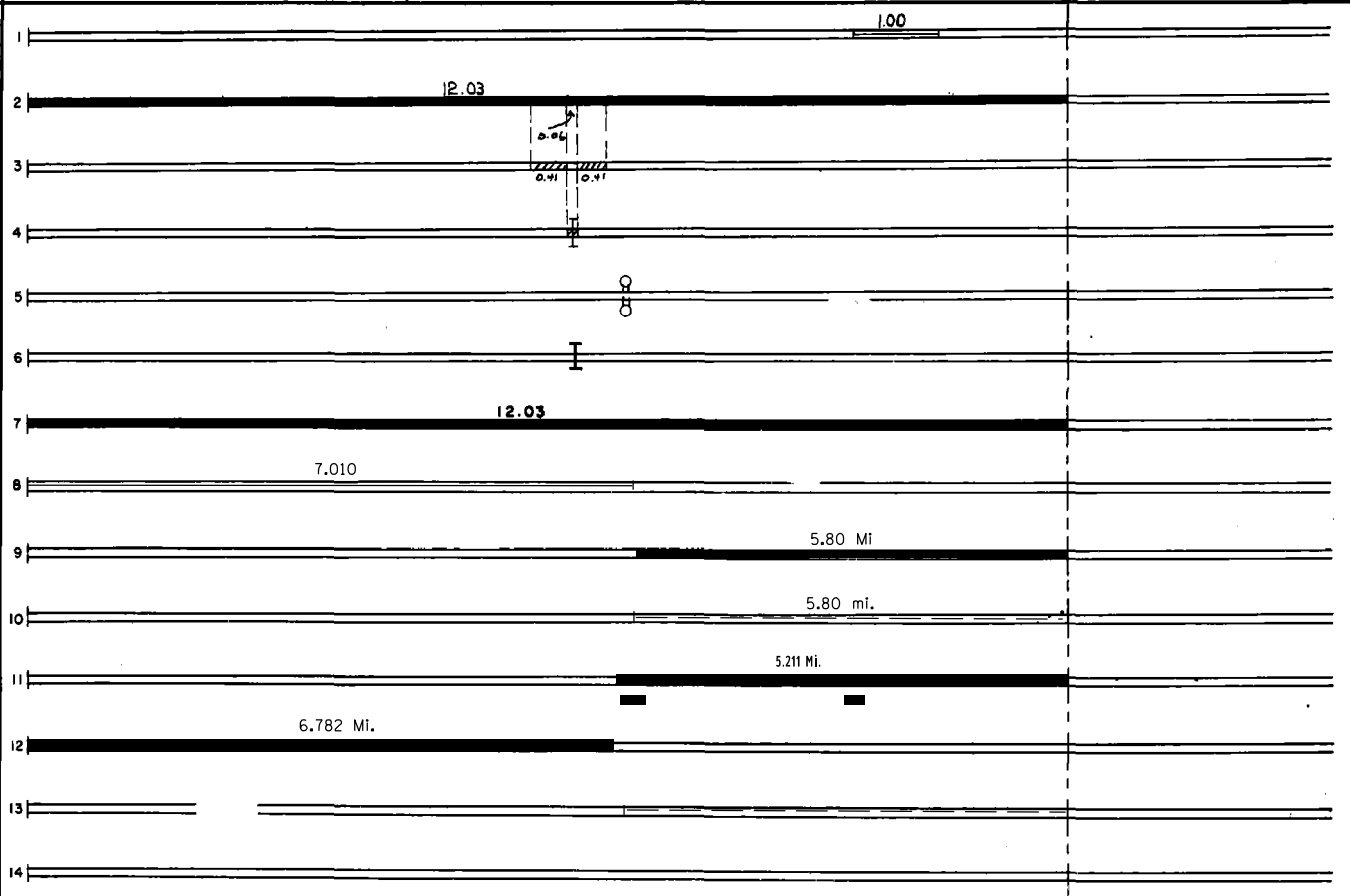

YEARS FROM TO		TOTAL MILES	UNINCORPORATED		INCORPORATED		RURAL		URBAN	
FROM	TO		RDWY. MI.	BR. MI.	RDWY. MI.	BR. MI.	RDWY. MI.	BR. MI.	RDWY. MI.	BR. MI.

REMARKS: See Sheet No. 1