

PREPARED BY  
TRAFFIC AND PLANNING DIVISION  
IN COOPERATION WITH  
U.S. DEPARTMENT OF COMMERCE  
BUREAU OF PUBLIC ROADS

STATE OF MINNESOTA  
DEPARTMENT OF HIGHWAYS  
ROAD LIFE STUDIES  
CONSTRUCTION PROJECT LOG RECORD

CONTROL SECTION 0980A  
TRUNK HIGHWAY 35  
COUNTY Carlton  
MAINTENANCE DISTRICT 1A

LIMITS: S.Co. Line - C.S.A.H. 4

Ref. Pt. 213+00.334 - 227+00.314

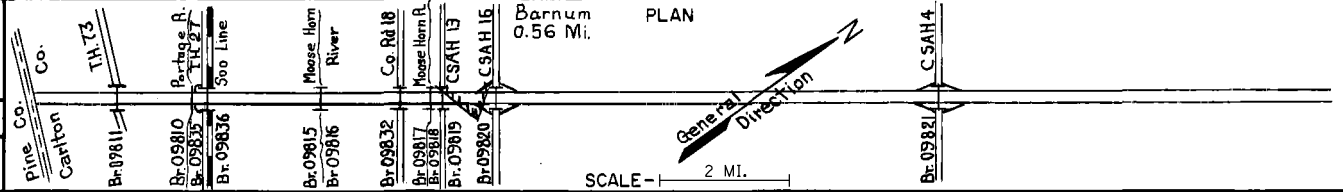

YEAR BUILT	PROJECT NO	DESCRIPTION	WIDTH	THICKNESS	REMARKS
C	0980-31	Grading 1.70 mi.			Divided Highway
1966	0980-39	Gravel, Sub-base & Base P.C. Concrete 1.60 mi.	2@24'	5 1/4" 9"	
C	0980-09811	Br. 09811			231' P.P.G. - U.P.
1966					
C	0980-32	Grading Br. 09810			Divided Highway C1212 D
1970		Br. 09835 & 09836			Both 264' B.S.
C	0980-32	Br. 09815 & 09816			Both 141' B.S.
1970	0980-30	Grading Br. 09832			Divided Highway 220' P.P.G. - U.P.
C	0980-30	Br. 09817 & 09818			Both 107' B.S.
1970	0980-30	Br. 09819			282' B.S. - U.P.
C	0980-30	Br. 09820			220' P.P.G. - U.P.
1970	0980-48	Gravel & P.M. Bit Base P.C. & Asphalt Concrete	2@24'	5" 8 1/2" 9" 13 1/2"	195' P.P.G. - U.P. 9.68 MI. P.C. 2.60 MI. Asp. P.M. Mix Bit Shoulders
C	0980-44	Grading, Base P.M. Mix. Bit. Surface for Interchange Ramps			
1976	0980-77	CONCRETE PAVEMENT JOINT REPAIR			
C	0980-87	SURFACING OF MISS RAMP, ACCEL. & DECEL LANE AND SHOULDERS			
1981	0980-100	Traffic Barrier HES 000S(147)			Construction
C	0980-108	Pavement Crack and Joint Repair			
1984	SF		1-2'	0-4"	Sp. 2361 410 Tons With C.S. 5880
M	1985	Wedge Paving	3'	1"	Left Shldr.
C	0980-114	Mill & Bit. Overlay	24'	1"	Spec. 2341 Spec. 2361

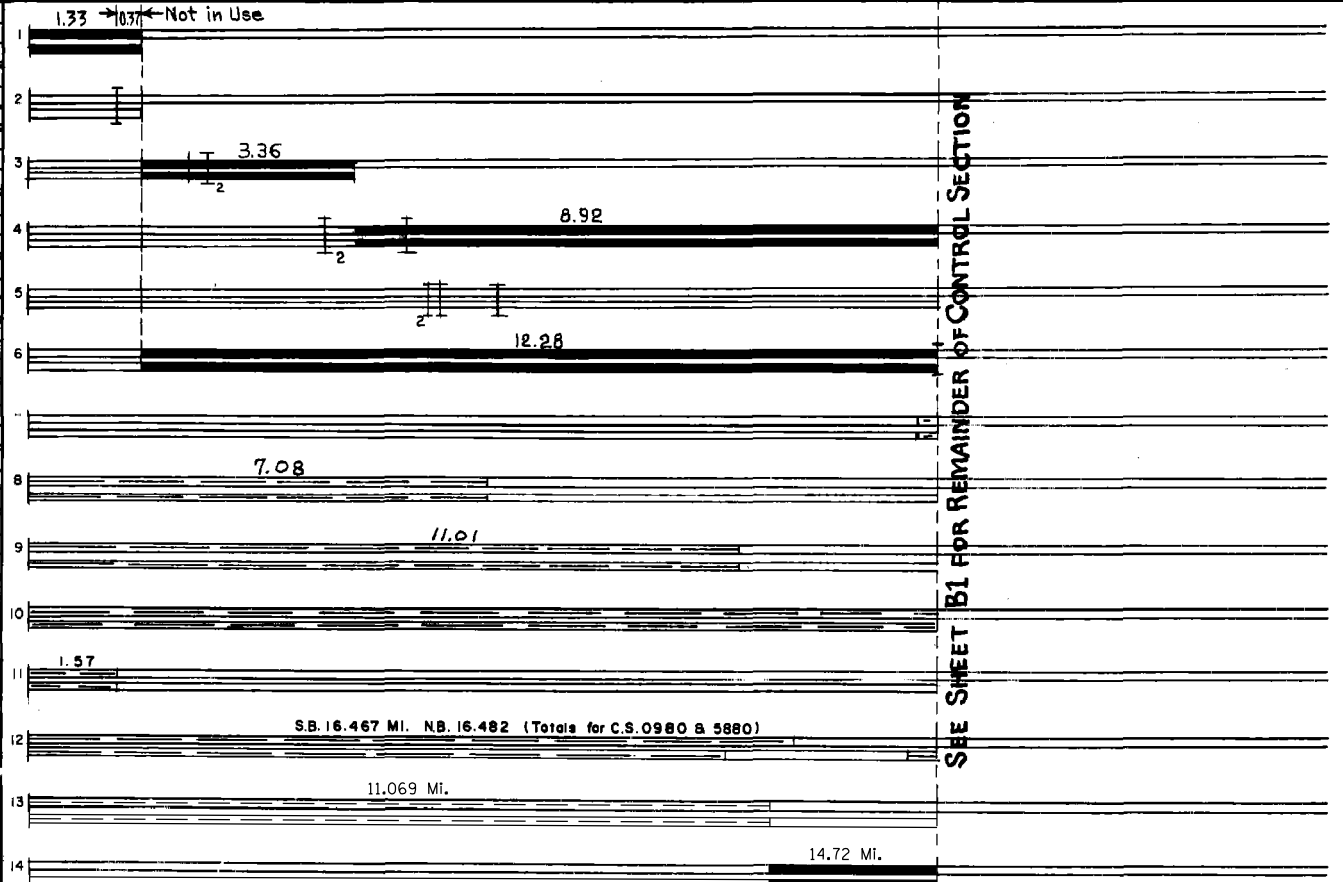

YEARS		TOTAL MILES	UNINCORPORATED		INCORPORATED		RURAL		URBAN	
FROM	TO		RDWY. MI.	BR. MI.	RDWY. MI.	BR. MI.	RDWY. MI.	BR. MI.	RDWY. MI.	BR. MI.
1966	1969	1.33	1.33	0.00	0.00	1.33	0.00	0.00	0.00	
1970		13.98	13.32	0.00	0.56	13.88	0.10	0.00	0.00	

REMARKS: Layout is to scale as of 1966.

