

PREPARED BY  
HIGHWAY PLANNING SURVEY  
IN COOPERATION WITH  
U.S. PUBLIC ROADS ADMINISTRATION

STATE OF MINNESOTA  
DEPARTMENT OF HIGHWAYS  
ROAD LIFE STUDIES  
CONSTRUCTION PROJECT LOG RECORD

CONTROL SECTION 0507  
TRUNK HIGHWAY 25  
COUNTY Benton  
DISTRICT 3B

LIMITS: Jct. T.H. 95 - E. Jct. T.H. 23

Ref. Pt. 093+00.873 - 099+00.312

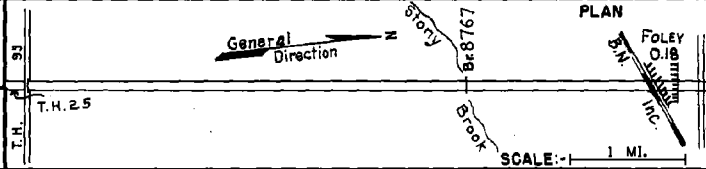

YEAR BUILT	PROJECT N <sup>o</sup>	DESCRIPTION				CODE N <sup>o</sup>
		TYPE	WIDTH	THICK-NESS	REMARKS	
		Gravel	24'	3"	No Record of Constr. Added in 1934.	
		Br. N <sup>o</sup> 2812	17'		20' B.S.	
M		Culv. Inst.				
1942	A.F.E. 23	Reshaping (Spots)			1700 C.Y./Mi.	
	A.F.E. 6	Regrav. & Lifts			Maint. Dept.	
C	(1)	Grading &				
1947	0508-01	Stab. Gravel	36'		1200 C.Y./Mi.	
M		Grav. Resurfacing	26'		3200 C.Y.	
1947	A.F.E. 6					
		Mixed Bit.	26'	1 1/2"	Transferred from C.S. 0505 (T.H. 23) in 1946	
C	(2)	Bit Surfacing			5C-3, 932 Gal.	
1948	A.F.E. 16	Bit Surf. Treated (Mixed Prime)	26'			
C		Bit Surfacing			5C-3 & MC-3, 28500 Gal.	
1948	A.F.E. 31	Bit Surf. Treated (Mixed Prime)	25'	3 1/4"		
C		Grading	34-4'		C 46 + 39'	
1950	0507-02	Gravel	34-4'	1 1/2"	C 106 D + 40'	
(3)		Br. 8767				
C		Stab. Grav. Base	24'	3-12"		
1951	0507-03	Plant Mix Bit.	24'	1 1/2"		
M		Light Bit. Seal	25'		RC-2, 9263 Gal.	
1957	A.F.E. 605				Agg. 313 C.Y.	
M		Light Bit. Seal	25'		RS-2K, 8874 Gal.	
1963	C				Agg. 345 C.Y.	
C		Grade, Grav. Base		17"		
1969	0507-07	Pl. Mix. Bit. Base	24'	1 1/2"		
C		Pl. Mix Bit.	24'	1 1/2"		
1977	0507-10					
C		Bit. Overlay	24'	Var.	Spec. 2331	
1994	0507-11	Shoulder Work				
		Extend Br. 8767				

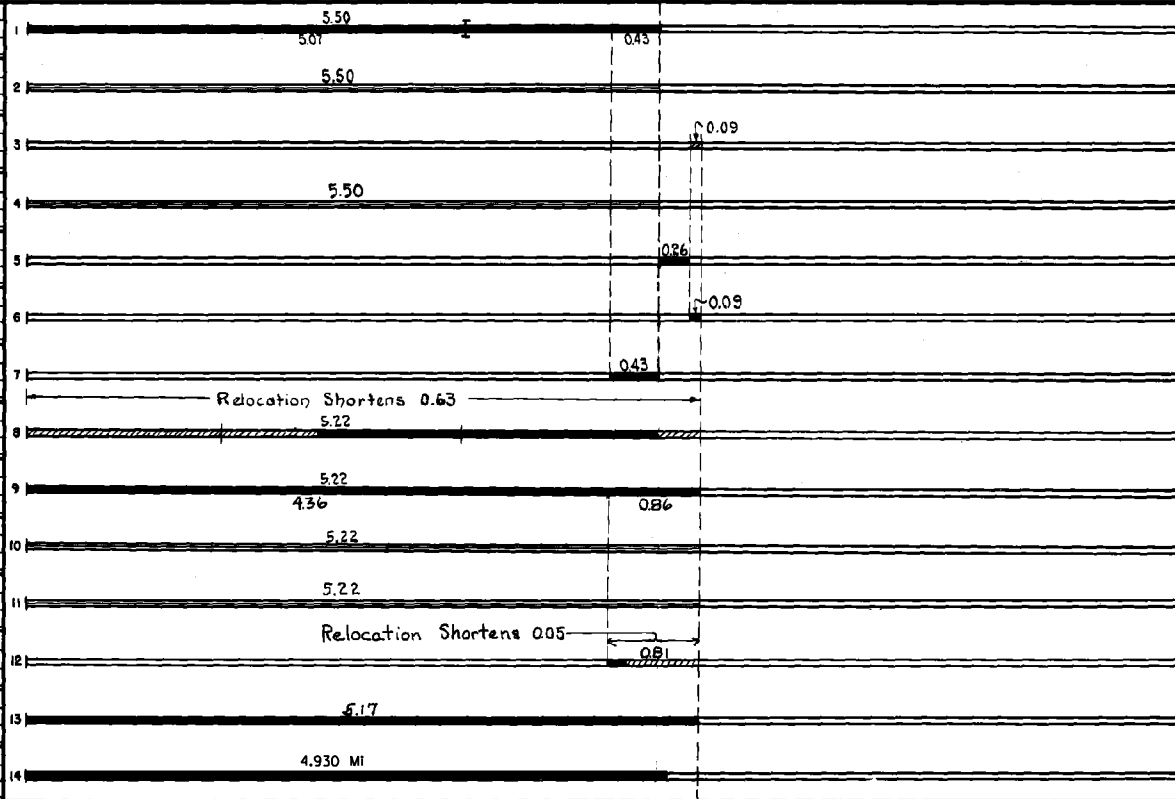

YEARS FROM	TO	TOTAL MILES	UNINCORPORATED		INCORPORATED		RURAL		URBAN	
			RDWY. MI.	BR. MI.	RDWY. MI.	BR. MI.	RDWY. MI.	BR. MI.	RDWY. MI.	BR. MI.
1934	1947	5.50	3.43	0.01	0.06	0.00	5.49	0.01	0.00	0.00
1948	1949	5.85	5.64	0.01	0.20	0.00	5.64	0.01	0.00	0.00
1950	1950	5.22	5.02	0.00	0.20	0.00	5.22	0.00	0.00	0.00
1951	1968	5.22	5.02	0.00	0.20	0.00	5.02	0.00	0.20	0.00
1969	1974	5.17	5.17	0.00	0.00	0.00	5.17	0.00	0.00	0.00
1975		5.17	4.99	—	0.18	—	4.99	—	0.18	0.00

REMARKS: Layout is to scale as of 1934. Plan revised for 1948 extension and for 1950 Relocation.

(1) Connection built under 0508-01 between new and old location of T.H. 23.

(2) Surfaced in connection with C.S. 0508.

(3) Contract not final but work substantially complete in 1950.

