

PREPARED BY
HIGHWAY PLANNING SURVEY
IN COOPERATION WITH
U.S. PUBLIC ROADS ADMINISTRATION

STATE OF MINNESOTA
DEPARTMENT OF HIGHWAYS
ROAD LIFE STUDIES
CONSTRUCTION PROJECT LOG RECORD

CONTROL SECTION 0415
TRUNK HIGHWAY 89
COUNTY Beltrami
DISTRICT 2A

LIMITS: North Jct. T.H. 1 - West Co. Line

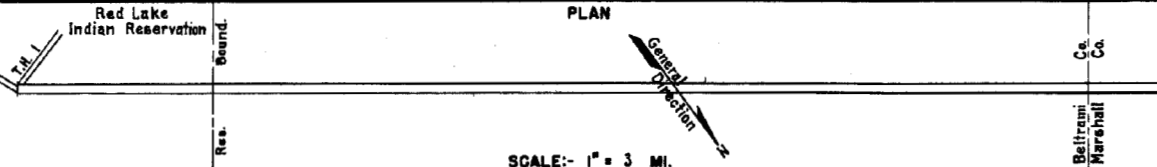

YEAR BUILT	PROJECT NO.	DESCRIPTION			CODE NO. DIST.
		TYPE	WIDTH	THICKNESS	
		Gravel	24'	2"	No Record of Constr.
		Grading	24'	2"	Added in 1934.
1927		Gravel	24'	2"	Co. Job No 2706.
		Regrading	30'		Added in 1934.
1938	A.F.E. 28	Gravel	24'	1/4"	Maint. Dept.
M					
1940	1940 A.F.E. 33	Regraveling			484 C.Y./Mi. Maint. Dept.
M					
1941	A.F.E. 31	Spot Graveling	20'		137 C.Y./Mi. Maint. Dept.
M					
1945	A.F.E. 6	Grav. Resurfacing			492 C.Y./Mi. Maint. Div.
M					
1950	A.F.E. 6	Gravel Resurfacing			2498 Tons
C					
1950	0415-02	Grading	28'		
(1)		Gravel	24'		700 C.Y./Mi. 250
C					
1951	1950 A.F.E. 22	Heavy Reshaping	28'		
(1)		Gravel	24'		9279 C.Y. 3451
C					
1954	0415-05	Grading	38'		
(1)		Gravel	24'	2 1/2"	1200 C.Y./Mi. 153
M					
1955	A.F.E. 824	Shaping & Compacting Sub-base			
C					
1956	0415-07	Select Granular Mat'l	30'	9"	
(1)		Gravel Base	30'	3"	556
M					
1958	A.F.E. 822	Sand-Grav. Sub-base	28'	6"	5032 MC. 131300 Gal.
(1)		Gravel Base	28'	3"	Agg. 5475 Tons
		Mixed Bit.	24'	1"	
C					
1959	A.F.E. 821	Grav Base (M.P. 13.02-17.81)	27'	3"	Bit Stab. Base (M.P. 740-800)
(1)		Road Mix Bit. (0.04) Mi.	24'	1"	SC-3, 91797 Gal.
		Grading & Gravel	24'		* 0.64 Mi.

YEARS FROM	TO	TOTAL MILES	UNINCORPORATED			INCORPORATED			RURAL		URBAN	
			RDWY. MI.	BR. MI.	0.00	RDWY. MI.	BR. MI.	0.00	RDWY. MI.	BR. MI.	RDWY. MI.	BR. MI.
1934	1949	28.02	28.02	0.00	0.00	0.00	0.00	28.02	0.00	0.00	0.00	
1950	1953	27.82	27.82	0.00	0.00	0.00	0.00	27.82	0.00	0.00	0.00	
1954		25.71	25.71	0.00	0.00	0.00	0.00	25.71	0.00	0.00	0.00	

REMARKS: Layout is to scale as of 1934
(1) Contract not final but work substantially complete in 1950.

PREPARED BY
TRAFFIC AND PLANNING DIVISION
IN COOPERATION WITH
U.S. DEPARTMENT OF COMMERCE
BUREAU OF PUBLIC ROADS

STATE OF MINNESOTA
DEPARTMENT OF HIGHWAYS
ROAD LIFE STUDIES
CONSTRUCTION PROJECT LOG RECORD

CONTROL SECTION 0415
TRUNK HIGHWAY 89
COUNTY Beltrami
DISTRICT 2A

LIMITS: N.Jct.T.H.1 - W.Co.Line

Ref. Pt. 053+00.975 - 079+00.680

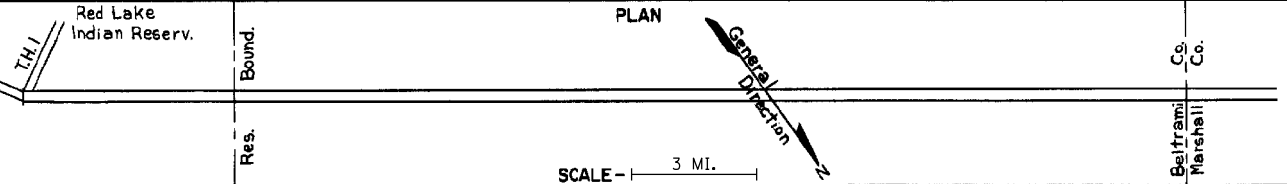

YEAR	PROJECT NO.	DESCRIPTION	WIDTH	THICKNESS	REMARKS
1960		Grading Bit. Stabilized Base	30' 25'	2"	By Maint. Dist.
1961		Light Bit. Seal	25'-26'		RS-2 45637 Gal. Agg. 1600 C.Y.
1966	SF	Bit. Surf. Repair	20'		MC-250 84430 Gal. Agg. 6839 C.Y.
1967	C	Light Bit. Seal	25'		RC-250 Bit. 45025 Gal. FA-1 Agg. 1578 Ton
1970	SF	Pl. Mix Bit.	24'	1 1/4"	MC-800 71286 Gal. Agg. 7247 tons
1977	0415-09	Pl. Mix Bit. Agg. Shoulders	24' 34'	3"	
1983	0415-10	Bituminous Overlay B Agg. Shoulders	24' 4'	1 1/2"	11,088 Ton 12,514 Ton
1998	0415-13	Bit. Overlay Gravel shoulders	24' 3'	1" 1"	
2001	0415-12	Remove Bituminous Bituminous Layer	24' 24'	9" 4"	Spec. 2350
2004	0415-16	Bit. Overlay Aggregate Shoulders	24'	1.5"	Spec. 2360
2006	0418-18	Bit. Overlay Aggregate Shoulders	24'	1.5"	Spec. 2360 Class 1
2007	0415-15	Widening Bit. Overlay Aggregate Shoulders	28'	1 1/2"	Spec. 2360 Class 1
2011	0415-19	Milling Bit. Overlay	24' 24'	1" 2"	Spec. 2360
2013	8822-151	Micro-milling Bit. Seal Coat	24' 24'	.37" 2"	Spec. 2232 Type F2

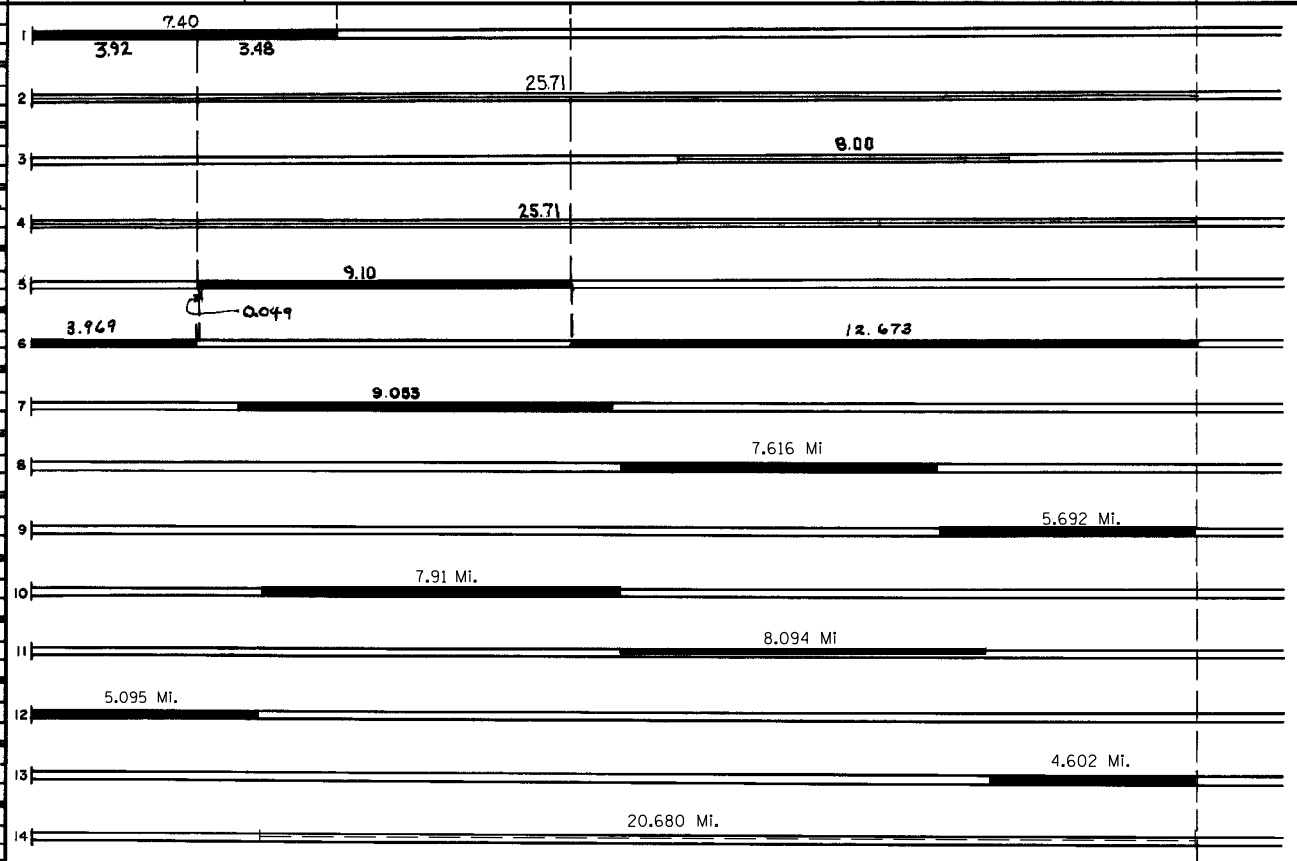

YEARS		TOTAL	UNINCORPORATED		INCORPORATED		RURAL		URBAN	
FROM	TO	MILES	ROWY. MI.	BR. MI.	ROWY. MI.	BR. MI.	ROWY. MI.	BR. MI.	ROWY. MI.	BR. MI.

REMARKS: See Sheet 1
For Other Projects See Dist. No. 681