

PREPARED BY
HIGHWAY PLANNING SURVEY
IN COOPERATION WITH
U.S. PUBLIC ROADS ADMINISTRATION

STATE OF MINNESOTA
DEPARTMENT OF HIGHWAYS
ROAD LIFE STUDIES
CONSTRUCTION PROJECT LOG RECORD

CONTROL SECTION 0107
TRUNK HIGHWAY 200
COUNTY Atkin
DISTRICT 1A

LIMITS: N. Jct. T.H. 65 - Jct. T.H. 2
Ref. Pt. 191+00.949 - 201+00.318

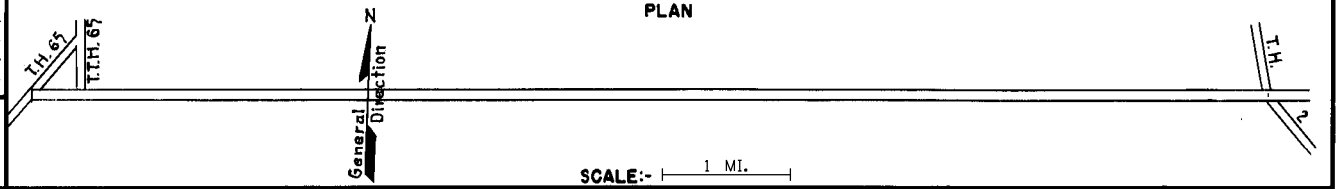

YEAR BUILT	PROJECT N ^o	DESCRIPTION			CODE N ^o
		TYPE	WIDTH	THICKNESS	
1929		Grading Gravel	24'	2"	1
M					
1940	A.F.E. 38	Regraveling			2
M					
1941	A.F.E. 37	Regraveling	20'		3
M					
1948	A.F.E. 6	Grav. Resurfacing			4
					5
1928		Gravel	30'	4"	
M					
1950	A.F.E. 6	Gravel Resurfacing			6
M					
1952	A.F.E. 12	Grav. Resurfacing (Spots)			7
M					
1953	A.F.E. 606	Grav. Resurfacing (Spots)			8
C					
1957	0107-02	Grading Gravel	40' 32'	2"	9
C					
1958	0107-03	Sand-Grav. Subbase Gravel Base Plant Mix Bit.	32' 32' 24'	6" 4" 1 1/2"	10
M					
1961		Light Bit. Seal	25'		11
C					
1978	0107-05	Bit. Resurfacing Pl. Mix Bit. Shoulders	24' 4'	2 1/2" 1 1/2"	12
C					
1999	0107-06	Bit. Surfacing	32'	1 1/2"	13
2012	0107-07	Grading Milling Bituminous Overlay		2" 3.5"	14

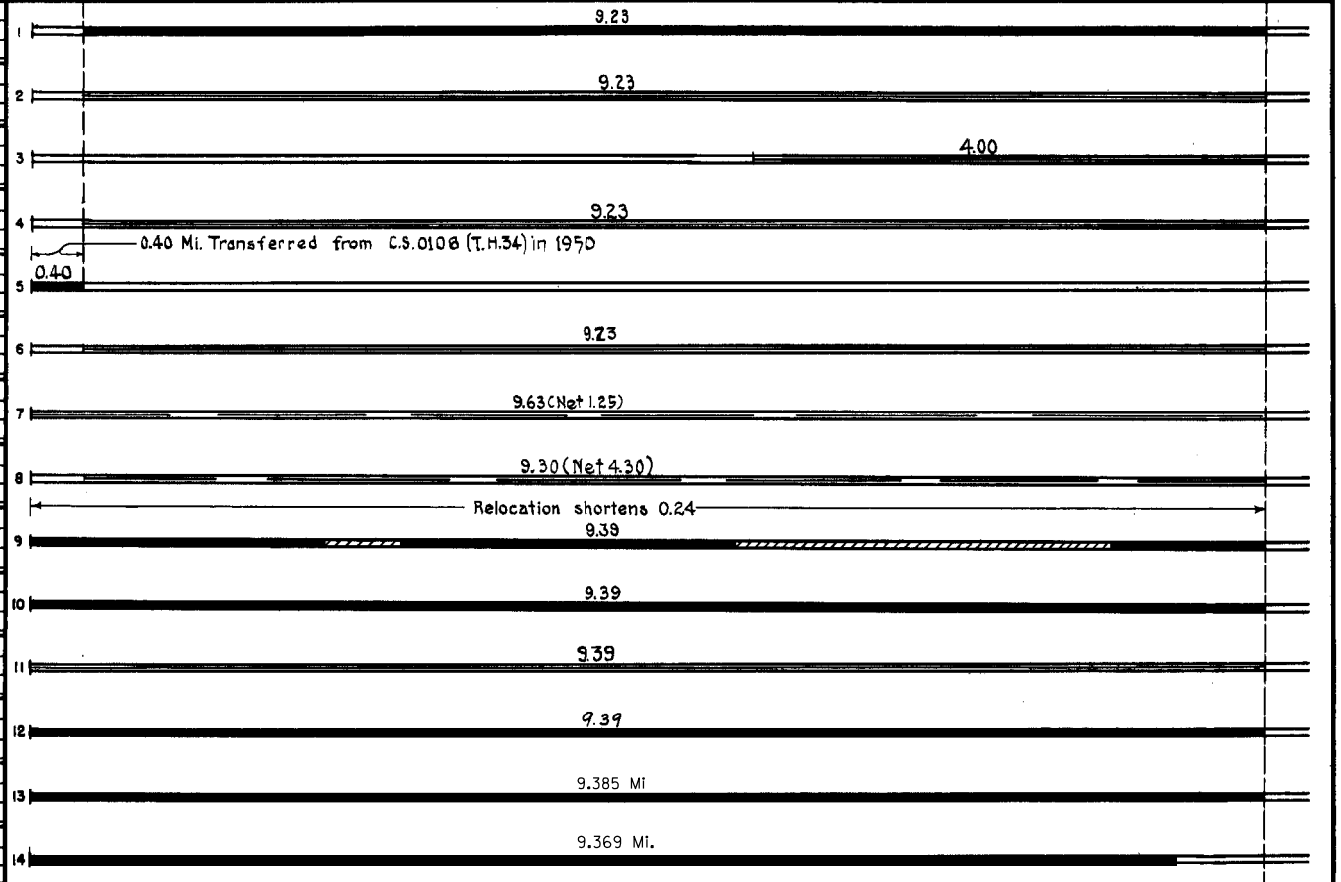

YEARS		TOTAL MILES	UNINCORPORATED			INCORPORATED			RURAL		URBAN	
FROM	TO		RDWY. MI.	BR. MI.	ROWY. MI.	BR. MI.	RDWY. MI.	BR. MI.	RDWY. MI.	BR. MI.		
1934	1949	9.23	9.23	0.00	0.00	0.00	9.23	0.00	0.00	0.00		
1950	1956	9.63	9.63	0.00	0.00	0.00	9.63	0.00	0.00	0.00		
1957		9.39	9.39	0.00	0.00	0.00	9.39	0.00	0.00	0.00		

REMARKS: Layout is to scale as of 1934