



MINNESOTA DEPARTMENT OF TRANSPORTATION

MEMO

Transportation Data and Analysis
395 John Ireland Boulevard - MS 450
St. Paul, Minnesota 55155

Phone: (651) 366-3888
Fax: (651) 366-3886

May 30, 2008

To: GENE HICKS
SECTION DIRECTOR
TRAFFIC FORECASTING AND ANALYSIS -MS 450

From: Gerry Buscher
traffic forecaster
District 3 materials-MS 030

Subject: TRAFFIC FORECAST

Beg Pt 195.263
End Pt 195.649
SP# 8680-142
Forecast # F-3-0805
County: Wright
District: Three
Miles: 0.386

Route: I-94

Letting Date: march 27 2009

Program Category: BR

Project Manager: Terry Humbert

SOILS ENGINEER: Tony Hughes

Project Limits: Replace Br # 86813 and BR # 86814 with new bridges # 86819 and # 86820 East of Monticello

Enclosures (check those that apply):

- Project map
Least squares analysis
Cumulative ESAL worksheet, Segment A
Cumulative ESAL worksheet, Segment B
AADT and/or DHV traffic schematic diagram
VCL expansion worksheet
Cumulative ESAL Report
Other (describe)
Other (describe)

REMARKS:

WIM/ATR Sites: NO
Timber Route: NO
Prev. Forecast: F-3-9709
Current VCC Map 20 Yr (2007) ESALs for site 8106 = 36,406,000

Design Criteria:

It is my understanding that your office will copy Dave Janisch on all forecasts.
Any questions or comments, let me know.

CC: DAVE JANISCH
FILE

CUMULATIVE ESAL REPORT - A

DATE: 05/30/08

ROUTE #: I-94 DISTRICT: Three
 FORECAST #: F-3-0805 COUNTY: Wright
 DESCRIPTION: CSAH 75 to CSAH 19
 AUTHOR'S DISTRICT: ---> Three AUTHOR: Gerry Buscher

TRAFFIC SUMMARY

BASE YEAR NUMBER OF LANES (two way): 4

	BASE YEAR --->	2009	DESIGN YEAR ---->	2029	GROWTH / YR (SIMPLE %)
AADT: two-way		68300		108100	2.9%
design-lane		30740		48,650	2.9%
HCADT: two-way		7,180		11,370	2.9%
SINGLE UNITS:two-way		1340		2,130	2.9%
TST'S: two-way		5,516		8,735	2.9%

ESAL SUMMARY

ANNUAL DESIGN LANE ESAL

FLEXIBLE: 1,146,349 1,815,292 +
 RIGID: 1,833,247 2,903,014 +

CUMULATIVE DESIGN-LANE ESALS (10 TON)

Design-lane factor: 0.45

DESIGN YEAR	DESIGN-LANE TST'S	ESALS	
		FLEXIBLE	RIGID
2019	3206	16,183,000	25,880,000
2024	3569	25,038,000	40,041,000
2029	3931	34,829,000	55,698,000
** OR ** DESIGN YEAR		^^^^^^^^^^^^^^^^	^^^^^^^^^^^^^^^^
2030	4003	35,616,000	56,956,000
2031	4076	36,402,000	58,215,000
2032	4148	37,189,000	59,473,000
2033	4220	37,976,000	60,731,000
2034	4293	38,762,000	61,989,000

35 YEAR CUMULATIVE ESAL USING--> 2009 AS THE BASE YEAR
 2044 69,821,000 111,658,000
 ^^^^^^^^^^^^^^^^^ ^^^^^^^^^^^^^^^^^

APPROVED BY:  DATE: 6-10-08

(FOR PROJECT AADTS AND DESIGN HOUR VOLUMES PLEASE REFER TO PREVIOUSLY APPROVED FORECASTS OR ATTACHED TRAFFIC FLOW DIAGRAMS.)

CUMULATIVE ESALS WORKSHEET

SEGMENT A

SP#: 8680-142
 ROUTE: I-94 # LANES: 4 DATE: 05/30/08
 LOCATION: CSAH 75 to CSAH 19
 VCL SITE #: 8106

	YEAR	AADT	INIT CALC HCADT	CONSTRN HCADT	INIT CALC 5AX TST	CONSTRAIN 5AX TST
VEH.CLASS YR.:	2007	62000	6520	0.0%	---	---
BASE YEAR:	2009	68300	7180		5342	
FORECAST YEAR:	2029	108100	11370		8455	

BASE YEAR PROPORTIONS		BASE YR. VOLUME	% TREND	FUTURE %	FUTURE VOL.
2AX-6TIRE SU	1.4%	986	1	1.4%	1561
3AX+ SU	0.5%	357	1	0.5%	565
3AX TST	0.1%	37	1	0.1%	59
4AX TST	0.2%	139	1	0.2%	220
5AX+ TST	7.8%	5340	1	7.8%	8456
(5AX+ TST MAX)	0	0	1	0.0%	0
(5AX+ TST OTH)	0	0	1	0.0%	0
TR TR, BUSES	0.3%	225	1	0.3%	357
TWIN TRAILERS	0.1%	96	1	0.1%	152

SUMMARIES:		AADT	HCADT	HCADT %	20 YR DESIGN LANE CUMULATIVE ESAL	
2007	COUNT:	62000	6520	10.5%		
2009	FORECAST:	68300	7180	10.5%		
2029	FORECAST:	108100	11370	10.5%	*****	*****
					FLEXIBLE	RIGID
DESIGN LANE FACTOR:	0.45				34,829,000	55,698,000
					*****	*****

ADDITIONAL OUTPUTS:	BASE %		FORECAST %		ESAL FACTORS	
					FLEXIBLE	RIGID
2AX-6TIRE SU	1.4%	1.4%	1.4%	1.4%	0.25	0.24
3AX+ SU	0.5%	0.5%	0.5%	0.5%	0.58	0.85
3AX TST	0.1%	0.1%	0.1%	0.1%	0.39	0.37
4AX TST	0.2%	0.2%	0.2%	0.2%	0.51	0.53
5AX+ TST	7.8%	7.8%	7.8%	7.8%	1.13	1.89
(5AX+ TST MAX)	0.0%	0.0%	0.0%	0.0%	2.40	4.07
(5AX+ TST OTH)	0.0%	0.0%	0.0%	0.0%	0.87	1.44
TR TR, BUSES	0.3%	0.3%	0.3%	0.3%	0.57	0.74
TWIN TRAILERS	0.1%	0.1%	0.1%	0.1%	2.40	2.33

Notes:

CUMULATIVE ESAL REPORT - B

DATE: 05/30/08

ROUTE #: I-94 DISTRICT: Three
 FORECAST #: F-3-0805 COUNTY: Wright SP#: 8680-142
 DESCRIPTION: TH 25 to CSAH 75 MILES: 1.95
 AUTHOR'S DISTRICT: ---> Three AUTHOR: Gerry Buscher

TRAFFIC SUMMARY

BASE YEAR NUMBER OF LANES (two way): 4

	BASE YEAR --->	2009	DESIGN YEAR ---->	2029	GROWTH / YR (SIMPLE %)
AADT: two-way		61800		98100	2.9%
design-lane		27810		44,150	2.9%
HCADT: two-way		6,920		10,980	2.9%
SINGLE UNITS:two-way		1200		1,910	3.0%
TST'S: two-way		5,437		8,615	2.9%

ESAL SUMMARY

ANNUAL DESIGN LANE ESAL

FLEXIBLE: 1,121,694 1,777,653 +
 RIGID: 1,798,244 2,849,510 +

CUMULATIVE DESIGN-LANE ESALS (10 TON)

Design-lane factor: 0.45

DESIGN YEAR	DESIGN-LANE TST'S	ESALS	
		FLEXIBLE	RIGID
2019	3162	15,840,000	25,392,000
2024	3519	24,509,000	39,289,000
2029	3877	34,096,000	54,658,000
** OR ** DESIGN YEAR		^^^^^^^^^^^^^^^^	^^^^^^^^^^^^^^^^
2030	3948	34,868,000	55,894,000
2031	4020	35,639,000	57,130,000
2032	4091	36,411,000	58,366,000
2033	4163	37,182,000	59,603,000
2034	4234	37,953,000	60,839,000

35 YEAR CUMULATIVE ESAL USING-->
 2044

2009

AS THE BASE YEAR

68,369,000 109,594,000
 ^^^^^^^^^^^^^^^^^ ^^^^^^^^^^^^^^^^^

APPROVED BY: 

DATE: 6-10-08

(FOR PROJECT AADTS AND DESIGN HOUR VOLUMES PLEASE REFER TO PREVIOUSLY APPROVED FORECASTS OR ATTACHED TRAFFIC FLOW DIAGRAMS.)

CUMULATIVE ESAL WORKSHEET

SEGMENT B

SP#: 8680-142

ROUTE: I-94

LANES: 4

DATE: 05/30/08

LOCATION: TH 25 to CSAH 75

	YEAR	AADT			CALCULATE D HCADT	CONSTRAIN HCADT
BASE YEAR:	2009	61800	-6500	DIFFERENCE	6930	0
FORECAST YEAR:	2029	98100	-10000	DIFFERENCE	10980	0

INCREMENTAL HCADT ON SEGMENT B (2000-2004 Local Road Studies)

BASE YEAR PROPORTIONS		BASE YR. VOLUME	% TREND	FUTURE %	FUTURE VOL.
2AX-6TIRE SU	1.7%	-111	1	1.7%	-170
3AX+ SU	0.5%	-33	1	0.5%	-50
3AX TST	0.1%	-7	1	0.1%	-10
4AX TST	0.1%	-7	1	0.1%	-10
5AX+ TST	1.0%	-65	1	1.0%	-100
(5AX+ TST MAX)	0.0%	0	1	0.0%	0
(5AX+ TST OTH)	0.0%	0	1	0.0%	0
TR TR, BUSES	0.5%	-33	1	0.5%	-50
TWIN TRAILERS	0.0%	0	1	0.0%	0

SUMMARIES:	0	ADDED	COMBINED	20 YR DESIGN	
	AADT	HCADT %	HCADT %	LANE CUMULATIVE ESAL	
BASE YEAR:	2009	-6500	3.9%	11.2%	
FORECAST YEAR:	2029	-10000	3.9%	11.2%	*****
DESIGN LANE FACTOR:	0.45			FLEXIBLE	RIGID
		SEGMENT B INCREMENT ONLY:		-733,000	-1,041,000
		SEGMENT A + SEGMENT B:		34,096,000	54,657,000
				*****	*****

ADDITIONAL OUTPUTS:

	ESAL FACTORS		FLEXIBLE	RIGID
	BASE %	FORECAST %		
2AX-6TIRE SU	1.7%	1.7%	0.25	0.24
3AX+ SU	0.5%	0.5%	0.58	0.85
3AX TST	0.1%	0.1%	0.39	0.37
4AX TST	0.1%	0.1%	0.51	0.53
5AX+ TST	1.0%	1.0%	1.13	1.89
(5AX+ TST MAX)	0.0%	0.0%	2.40	4.07
(5AX+ TST OTH)	0.0%	0.0%	0.87	1.44
TR TR, BUSES	0.5%	0.5%	0.57	0.74
TWIN TRAILERS	0.0%	0.0%	2.40	2.33
BSEgment				
Difference OK?	OK	OK		

Notes:

Vehicle Class Count Averages Worksheet

VCC Site Num. 8106
 TH I-94
 Description On I-94 S. of Jct TH 25

Type	16-24 Vehicle C.C.1		16-24 Vehicle C.C.2		16-24 Vehicle C.C.3		16-24 Vehicle C.C.4	
	Year	Pct	Year	Pct	Year	Pct	Year	Pct
	2007 Manual		2000 Manual		1992 tube		1986 tube	
1 Cars	54892	88.54%	43990	87.98%	31942	94.50%	20208	86.92%
2 2ASU	1110	1.79%	851	1.70%	266	0.79%	348	1.50%
3 3+ASU	269	0.43%	283	0.57%	69	0.20%	206	0.89%
4 3ASemi	21	0.03%	15	0.03%	23	0.07%	20	0.09%
5 4ASemi	66	0.11%	108	0.22%	31	0.09%	93	0.40%
6 5+ASemi	5419	8.74%	4358	8.72%	1405	4.16%	2249	9.67%
7 TT/BUS	161	0.26%	300	0.60%	64	0.19%	63	0.27%
8 Twins	62	0.10%	95	0.19%	0	0.00%	63	0.27%
Total	62000	11.46%	50000	12.02%	33800	5.50%	23250	13.08%
Total Heavy Comm	7108		6010		1858		3042	
Heavy 5+ Ax Semi*		2.7%		2.2%		5.5%		3.0%
Axle Corr Factor		0.88		0.87		0.94		0.86

Heavy 5 Axle Semi Split
Max 0.26%
Others 7.56%
DON'T SPLIT

* Heavy 5+ Ax Semi = Tank, Dump, Grain (and Stake if on Timber route-Dist 1,2, or 3)
 When the Tank, Dumps, & Grains and sometimes stakes are 30% or more of the
 5 axle semis, then split into max and other categories (AUTOMATICALLY DONE) ----->
 Check out tube counts prior to 1996 carefully, body types are N/A prior to 1982, don't use tube
 collected previous to 1990.

NOTE: IF LESS THAN 4 ENTRIES, BE SURE
 TO DELETE YEAR AND PCT COLUMN
 DO NOT USE 0, LEAVE BLANK.
 USER MUST THEN COPY THE FORMULA IN THE
 PCT COLUMNS BACK TO THE APPROPRIATE COLUMN
 FOR HELP CALL MARK LEVENSON - 651 -296-8535 OR TOM NELSON - 651-297-1197.

16 HR. OR 24 HR. VEHICLE CLASS COUNT EXPANSION WORKSHEET 1

SITE NUMBER: 8106
 SITE DESCRIPTION: On I-94 S. of Jct TH 25
 PROJECT SP#: 8680-142
 MONTH NUMBER OF COUNT: 6
 16 or 24 HR 16

COUNTY: Wright
 YEAR OF COUNT ->: 2007
 CONSTRAIN AADT ->: 62000

VEHICLE TYPE	RAW COUNT	AADT ADJ FACTOR	ADJUSTED RAW	VEH. TYPE PERCENTS	A.C.F.
CARS AND PICKUPS	49597	#N/A	54892		0.88
2 AXLE 6 TIRE	1454	0.76	1110	1.8%	
3+ AXLE SINGLE UNIT	427	0.63	269	0.4%	
3 AXLE SEMI (TST)	29	0.71	21	0.0%	
4 AXLE SEMI (TST)	89	0.75	66	0.1%	
5+ AXLE SEMI (TST)	6600	0.82	5419	8.7%	
TR TR, BUSES	211	0.76	161	0.3%	
TWIN TRAILERS	75	0.82	62	0.1%	
TOTALS ----->	58482 ----->	1.1	62000	11.5%	(%HC)

8106
 On I-94 S. of Jct TH 25

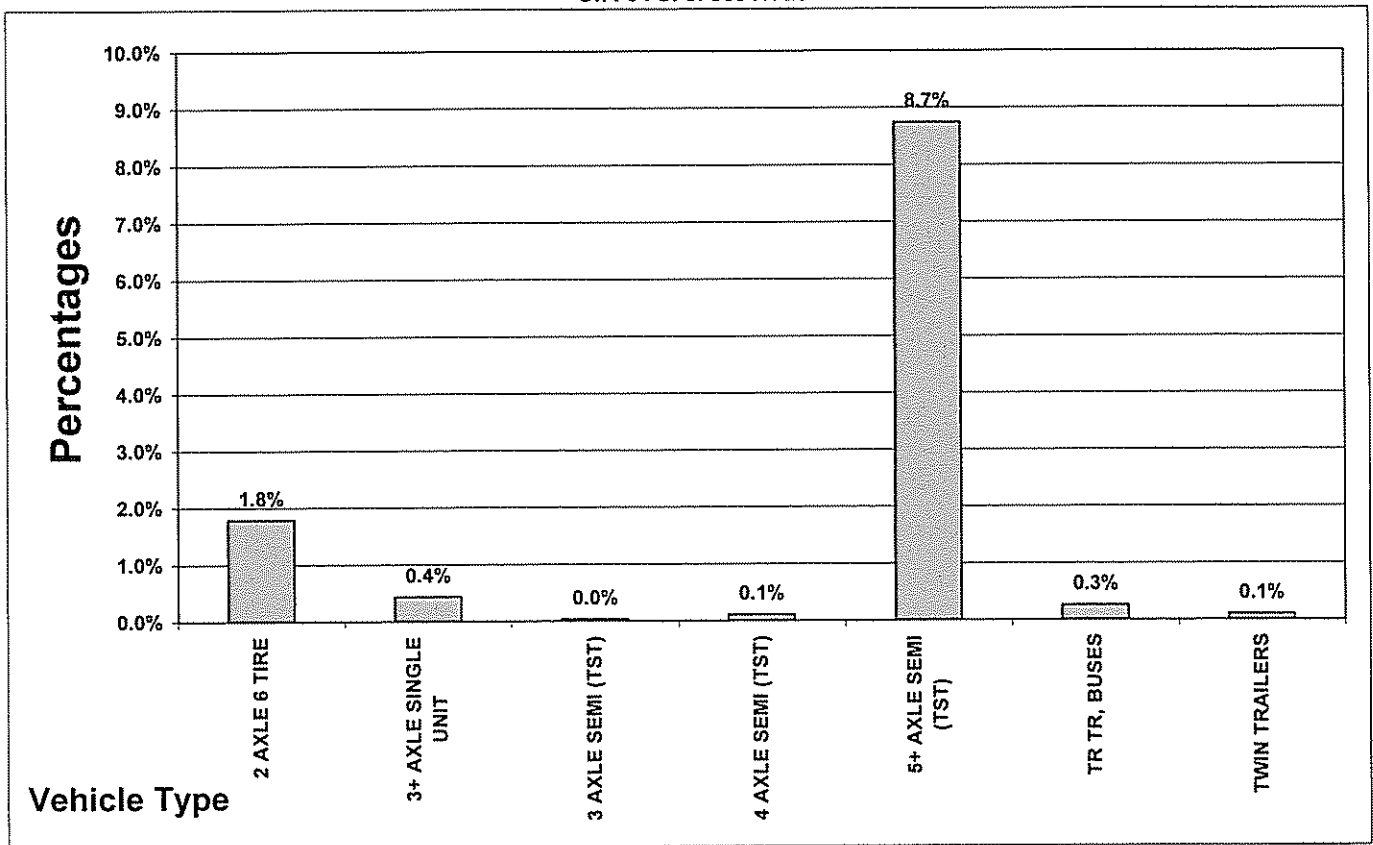

BODY TYPE REPORT BASED ON PRELIMINARY ADJUSTED VEHICLE CLASSIFICATION COUNT

4/8/2008

SITE: 8106 ROUTE: 1-94

DESCRIPTION 2.5 MI S OF JCT TH25

RECORDER: RMH

COUNTY: WRIGHT

DIST: 3

		Semis																
		Single Units					Heavies											
Begin Hour	Date	Pass Vehicle	2ax	3ax plus	3ax	4ax	5ax (dump)	5ax tank	5ax grain	5ax silo	5ax stun	5ax other	6ax+	Bus	Heavy Truck w/Trlr	Twin Trl 5ax+	Total Vehicles	
East	9:00	6/26/2007	1473	95	21	1	1	9	14	9	22	13	134	32	4	3	2	1833
	10:00	6/26/2007	1430	47	30	0	3	15	16	11	26	18	155	25	2	5	4	1787
	11:00	6/26/2007	1431	45	22	2	4	16	17	9	20	17	140	32	1	3	3	1762
	12:00	6/26/2007	1501	58	24	1	4	11	10	7	15	19	159	22	2	4	2	1839
Directional Totals:			5835	245	97	4	12	51	57	36	83	67	588	111	9	15	11	7221
West	9:00	6/20/2007	1202	51	11	2	1	33	13	19	32	4	164	16	4	5	0	1557
	10:00	6/20/2007	1370	44	17	2	7	30	22	15	48	8	156	18	5	4	5	1751
	11:00	6/20/2007	1361	44	14	0	4	13	17	17	52	8	160	22	12	3	3	1730
	12:00	6/20/2007	1504	41	13	1	4	31	16	15	27	7	150	30	10	0	0	1849
Directional Totals:			5437	180	55	5	16	107	68	66	159	27	630	86	31	12	8	6887
Site Totals:			11272	425	152	9	28	158	125	102	242	94	1218	197	40	27	19	14108
16 Hour Totals for Calculating ESALS by Month:		Pass. Vehicles	2 Axle SU	3+ Axle SU	3 Axle Semi	4 Axle Semi	5+ Axle Semi	Trk Trl/Bus	Twins	Total Veh								
		49597	1454	427	29	89	6600	211	75	58482								

$$8,885 / 58,482 = 15.19\%$$

$$385 / 14108 = 2.7\%$$

16 HR. OR 24 HR. VEHICLE CLASS COUNT EXPANSION WORKSHEET 2

SITE NUMBER: 8106
 SITE DESCRIPTION: On I-94 S. of Jct TH 25
 PROJECT SP#: 8680-142
 MONTH NUMBER OF COUNT: 5 2000
 16 or 24 HR 16

COUNTY: Wright
 YEAR OF COUNT ->: 2000
 CONSTRAIN AADT ->: 50000

VEHICLE TYPE	RAW COUNT	AADT ADJ FACTOR	ADJUSTED RAW	VEH. TYPE PERCENTS	A.C.F.
CARS AND PICKUPS	35110	#N/A	43990		0.87
2 AXLE 6 TIRE	1085	0.78	851	1.7%	
3+ AXLE SINGLE UNIT	374	0.76	283	0.6%	
3 AXLE SEMI (TST)	22	0.69	15	0.0%	
4 AXLE SEMI (TST)	135	0.80	108	0.2%	
5+ AXLE SEMI (TST)	4883	0.89	4358	8.7%	
TR TR, BUSES	383	0.78	300	0.6%	
TWIN TRAILERS	107	0.89	95	0.2%	
TOTALS ----->	42099 ----->	1.2	50000	12.0%	(%HC)

8106
 On I-94 S. of Jct TH 25

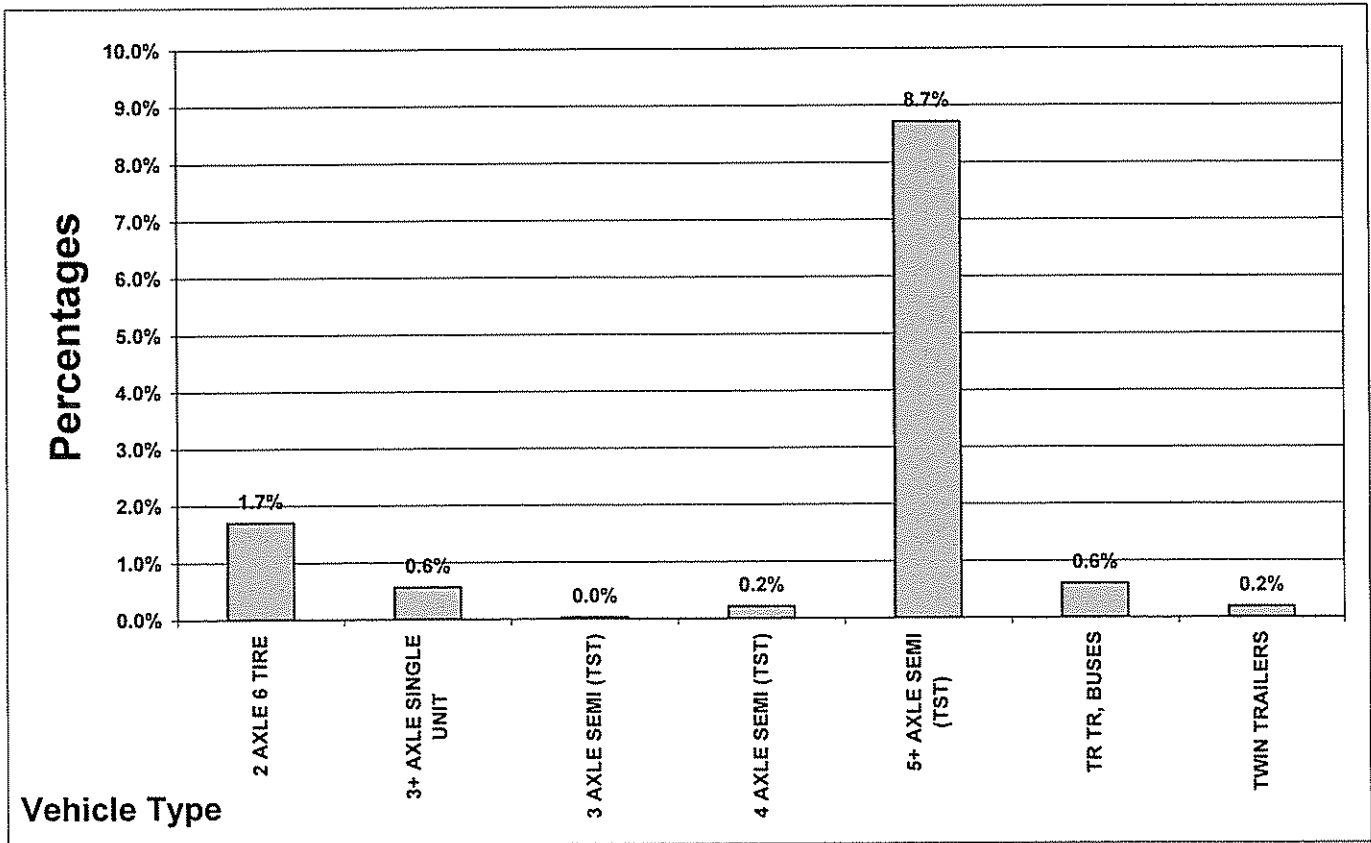

Route Description I-94 2.5 MI S OF JCT TH25 County WRIGHT

++++ Single Units +++++
 ++++++Heavy+
 ++ Truck ++
 Trailers Twins

Direction	Reghour	Date	Passenger	2ax	2ax	3ax+	3ax+	3ax	3ax	4ax	4ax	5ax	5ax	5ax	5ax	5ax	5ax	5ax	6ax+	6ax+	Bus	HTWT	HTWT	5ax+
			Vehicle	tank	tank	tank	tank	tank	tank	tank	tank	dump	dump	grain	stlo	stlo	stun	other						
-----	-----	-----	-----	-----	-----	-----	-----	-----	-----	-----	-----	-----	-----	-----	-----	-----	-----	-----	-----	-----	-----	-----	-----	-----
Southeast	700	5/25/00	966	32	0	5	0	0	0	6	0	5	9	12	13	5	47	20	3	9	0	1		
Southeast	800	5/25/00	822	106	2	6	1	0	0	3	0	4	14	21	25	10	89	23	14	5	0	1		
Southeast	900	5/25/00	779	48	0	14	1	1	0	5	0	1	16	16	15	6	103	7	35	6	0	2		
Southeast	1000	5/25/00	733	34	0	4	1	0	0	5	0	6	15	17	17	8	105	19	21	3	0	5		
Southeast	1100	5/25/00	754	48	0	10	0	1	0	5	0	2	22	18	17	8	106	4	2	5	0	2		
Southeast	1200	5/25/00	773	37	1	14	0	0	0	5	0	5	13	12	16	12	130	14	0	11	0	3		
Southeast	1300	5/25/00	875	31	2	12	1	1	0	6	0	5	12	7	17	12	117	20	0	6	0	2		
Southeast	1400	5/18/00	1255	46	0	26	0	3	0	8	0	1	12	4	16	7	115	14	5	3	0	4		
Southeast	1500	5/18/00	1353	34	0	11	1	1	0	6	0	4	7	7	17	10	101	6	6	3	0	1		
Southeast	1600	5/18/00	1504	22	1	6	1	0	0	2	0	1	7	6	14	13	87	11	2	2	0	1		
Southeast	1700	5/18/00	1633	34	0	4	0	1	0	6	0	4	8	9	13	8	83	8	4	5	0	3		
Southeast	1800	5/18/00	1218	13	0	3	0	1	0	2	0	1	3	19	16	7	90	7	5	2	0	5		
Southeast	1900	5/18/00	843	17	0	2	0	0	0	2	0	2	4	12	20	3	80	2	4	0	0	5		
Southeast	2000	5/18/00	814	18	0	5	0	0	0	1	0	1	7	14	16	10	64	6	2	0	0	7		
Southeast	2100	5/18/00	712	6	0	1	0	1	0	1	0	0	10	15	13	5	86	3	0	0	0	15		
DIRECTIONAL TOTALS			15034	526	6	123	6	10	0	63	0	42	159	189	245	124	1403	164	103	60	0	57		

16 HR. OR 24 HR. VEHICLE CLASS COUNT EXPANSION WORKSHEET 3

SITE NUMBER: 8106
 SITE DESCRIPTION: On I-94 S. of Jct TH 25
 PROJECT SP#: 8680-142
 MONTH NUMBER OF COUNT: 24
 16 or 24 HR

COUNTY: Wright
 YEAR OF COUNT ->: 1992
 CONSTRAIN AADT ->: 33800

VEHICLE TYPE	RAW COUNT	AA DT ADJ FACTOR	ADJUSTED RAW	VEH. TYPE PERCENTS	A.C.F.
CARS AND PICKUPS	31942	#N/A	31942		0.94
2 AXLE 6 TIRE	266	1.00	266	0.8%	
3+ AXLE SINGLE UNIT	69	1.00	69	0.2%	
3 AXLE SEMI (TST)	23	1.00	23	0.1%	
4 AXLE SEMI (TST)	31	1.00	31	0.1%	
5+ AXLE SEMI (TST)	1405	1.00	1405	4.2%	
TR TR, BUSES	64	1.00	64	0.2%	
TWIN TRAILERS	0	1.00	0	0.0%	
TOTALS ----->	33800 ----->	1.0	33800	5.5%	(%HC)

8106
 On I-94 S. of Jct TH 25

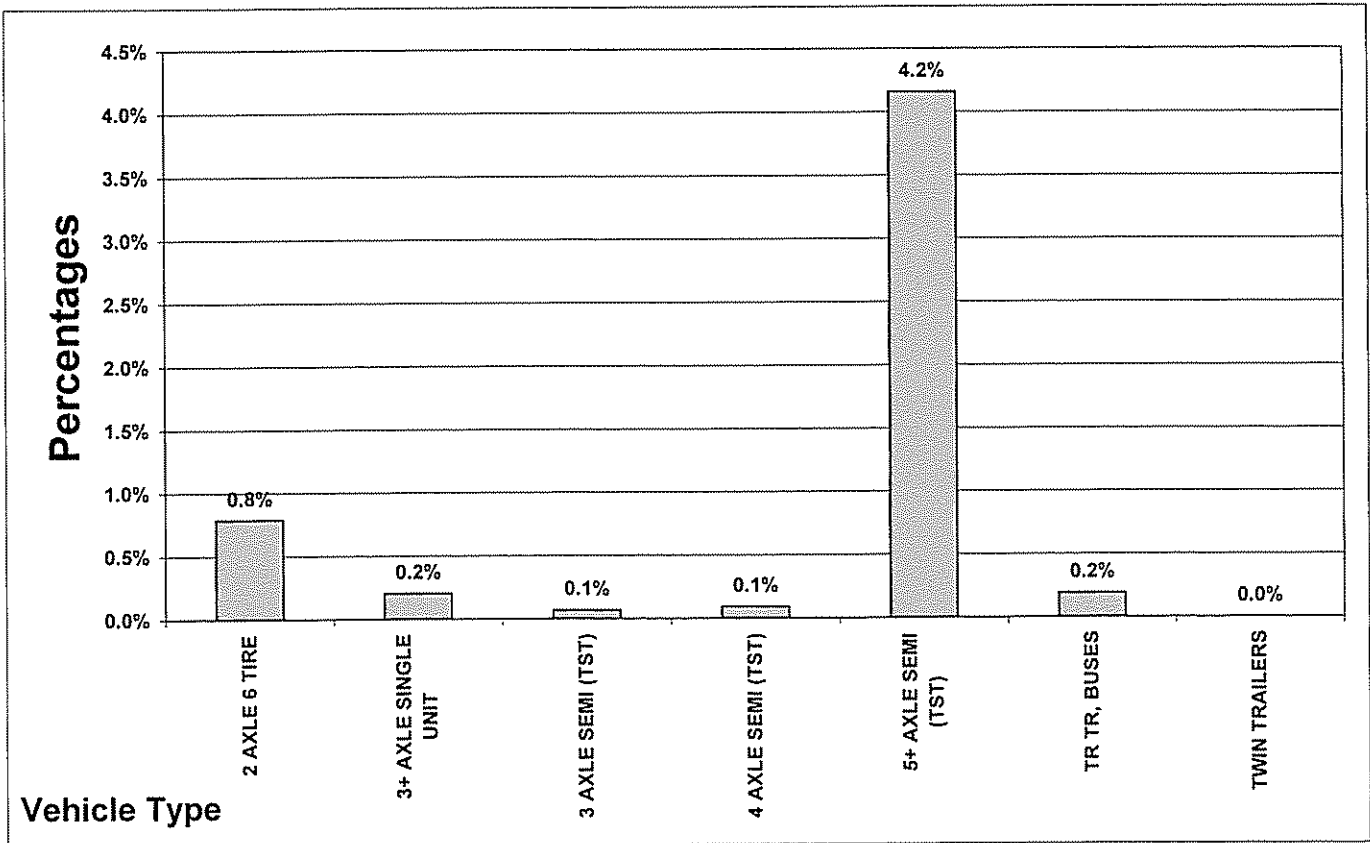

16 HR. OR 24 HR. VEHICLE CLASS COUNT EXPANSION WORKSHEET 3

SITE NUMBER: 8106
 SITE DESCRIPTION: On I-94 S. of Jct TH 25
 PROJECT SP#: 8680-142
 MONTH NUMBER OF COUNT: 24
 16 or 24 HR

COUNTY: Wright
 YEAR OF COUNT ->: 1992
 CONSTRAIN AADT ->: 33800

VEHICLE TYPE	RAW COUNT	AA DT ADJ FACTOR	ADJUSTED RAW	VEH. TYPE PERCENTS	A.C.F.
CARS AND PICKUPS	31942	#N/A	31942		0.94
2 AXLE 6 TIRE	266	1.00	266	0.8%	
3+ AXLE SINGLE UNIT	69	1.00	69	0.2%	
3 AXLE SEMI (TST)	23	1.00	23	0.1%	
4 AXLE SEMI (TST)	31	1.00	31	0.1%	
5+ AXLE SEMI (TST)	1405	1.00	1405	4.2%	
TR TR, BUSES	64	1.00	64	0.2%	
TWIN TRAILERS	0	1.00	0	0.0%	
TOTALS ----->	33800 ----->	1.0	33800	5.5%	(%HC)

8106
 On I-94 S. of Jct TH 25

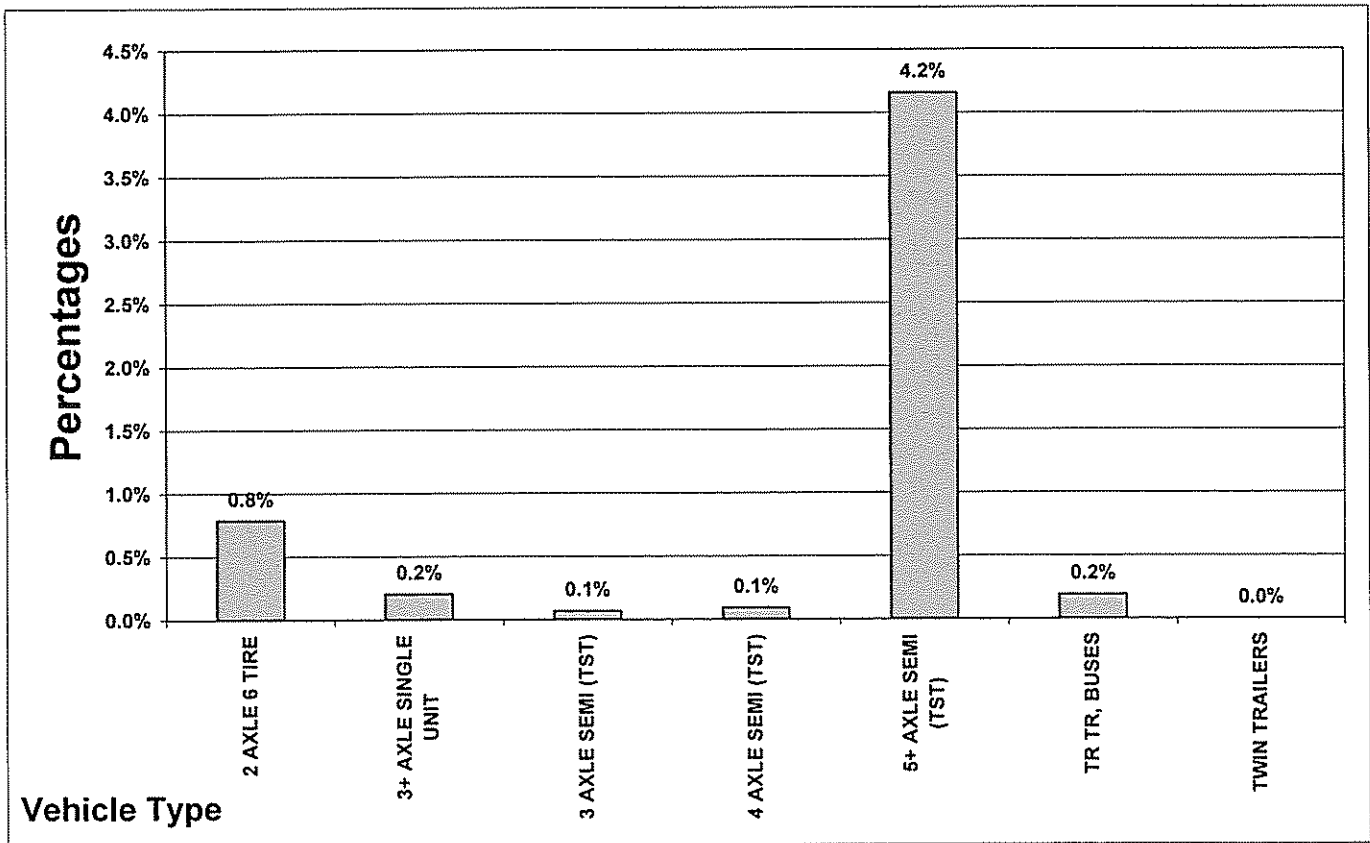

VC 8106 TUBE COUNT
1992

Cars	31942	94.50%
2ASU	266	0.79%
3+ASU	69	0.20%
3ASEMI	23	0.07%
4ASEMI	31	0.09%
5+ASEMI	1405	4.16%
TT/BUS	64	0.19%
TWINS	0	0.00%

HC 5.5% AX CORR 0.94

AADT 33,800

16 HR. OR 24 HR. VEHICLE CLASS COUNT EXPANSION WORKSHEET 4

SITE NUMBER: 8106
 SITE DESCRIPTION: On I-94 S. of Jct TH 25
 PROJECT SP#: 8680-142
 MONTH NUMBER OF COUNT: 24
 16 or 24 HR

COUNTY: Wright
 YEAR OF COUNT ->: 1986
 CONSTRAIN AADT ->: 23250

VEHICLE TYPE	RAW COUNT	AADT ADJ FACTOR	ADJUSTED RAW	VEH. TYPE PERCENTS	A.C.F.
CARS AND PICKUPS	20208	#N/A	20208		0.86
2 AXLE 6 TIRE	348	1.00	348	1.5%	
3+ AXLE SINGLE UNIT	206	1.00	206	0.9%	
3 AXLE SEMI (TST)	20	1.00	20	0.1%	
4 AXLE SEMI (TST)	93	1.00	93	0.4%	
5+ AXLE SEMI (TST)	2249	1.00	2249	9.7%	
TR TR, BUSES	63	1.00	63	0.3%	
TWIN TRAILERS	63	1.00	63	0.3%	
TOTALS ----->	23250 ----->	1.0	23250	13.1%	(%HC)

8106
 On I-94 S. of Jct TH 25

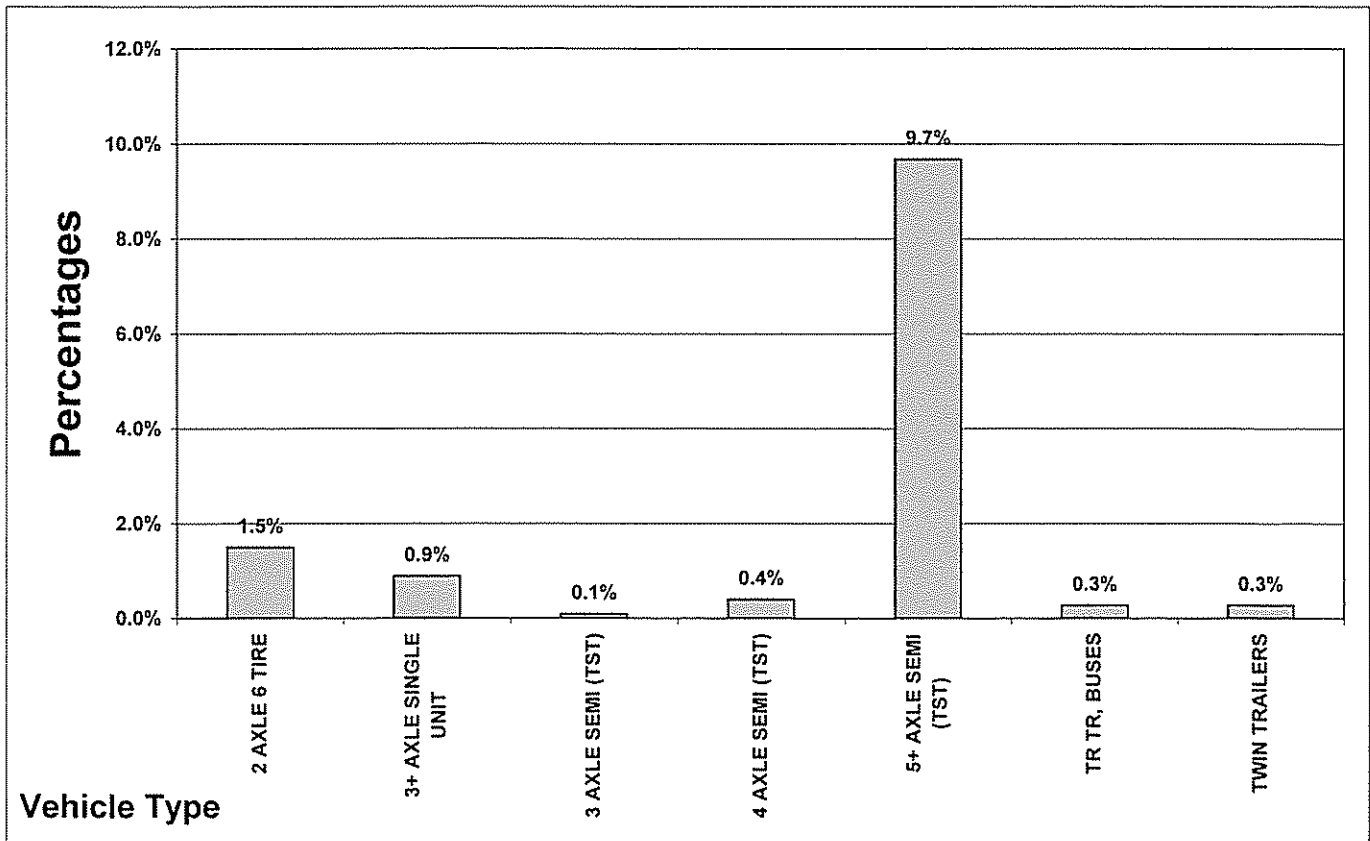

392 24-hr
 For Project of 2

DATE: 1986
 TYP
 E: UP
 DATE

STUDY: 8 LOC: 101
 TYPE: ADT
 DIR: BOTH
 TH12 & TH22 E. OF JCT
 TH12
 MEERER CO

STUDY: 8 LOC: 102
 TYPE: ADT
 DIR: BOTH
 TH12 W OF JCT. TH22
 TH22 H OF JCT. TH112
 MEERER CO

STUDY: 8 LOC: 103
 TYPE: ADT
 DIR: BOTH
 TH21 W OF JCT. TH1169
 SHERBURNE CO

STUDY: 8 LOC: 104
 TYPE: ADT
 DIR: BOTH
 TH55 S OF JCT. TH25
 WRIGHT CO

STUDY: 8 LOC: 106
 TYPE: ADT
 DIR: BOTH
 I-94 S OF JCT. TH25
 WRIGHT CO

STUDY: 8 LOC: 107
 TYPE: ADT
 DIR: BOTH
 TH107 S OF JCT TH70
 KANABEC CO

3042
 23250
 793
 13.1%

3042
 3042
 793
 3.0%

2500
 2600
 96.2%

1892
 2000
 94.6%

1892
 2000
 94.6%

108
 2000
 5.4%

TOT	5850	10.1%
TRKS	590	10.1%
STUDY: 8 LOC: 107		
TYPE: ADT		
DIR: BOTH		
TH10 & TH52 W. OF JCT		
TH169		
SHERBURNE CO		

TOT	4400	10.7%
TRKS	472	10.7%
STUDY: 8 LOC: 108		
TYPE: ADT		
DIR: BOTH		
TH169 S OF JCT TH201		
SHERBURNE CO		

TOT	1400	10.0%
TRKS	140	10.0%
STUDY: 8 LOC: 109		
TYPE: ADT		
DIR: BOTH		
TH201 W OF JCT TH169		
SHERBURNE CO		

TOT	12000	5.2%
TRKS	625	5.2%
STUDY: 8 LOC: 110		
TYPE: ADT		
DIR: BOTH		
TH169 N OF JCT TH201		
SHERBURNE CO		

TOT	3042	13.1%
TRKS	3042	13.1%
STUDY: 8 LOC: 111		
TYPE: ADT		
DIR: BOTH		
TH47 N OF ISANTI-		
OKA CD LINE		
ISANTI CO		

TOT	11000	4.8%
TRKS	525	4.8%
STUDY: 8 LOC: 112		
TYPE: ADT		
DIR: BOTH		
TH65 N OF ISANTI-		
OKA CD LINE		
ISANTI CO		

TOT	11600	5.9%
TRKS	685	5.9%
STUDY: 8 LOC: 114		
TYPE: ADT		
DIR: BOTH		
TH107 E OF JCT TH65		
ISANTI CO		

TOT	1650	6.1%
TRKS	100	6.1%
STUDY: 8 LOC: 115		
TYPE: ADT		
DIR: BOTH		
TH65 H OF JCT. TH1107		
ISANTI CO		

TOT	1156	8.7%
TRKS	100	8.7%
STUDY: 8 LOC: 116		
TYPE: ADT		
DIR: BOTH		
TH65 S OF JCT. TH107		
ISANTI CO		

TOT	100	3.8%
TRKS	100	3.8%
STUDY: 8 LOC: 117		
TYPE: ADT		
DIR: BOTH		
TH107 S OF JCT TH70		
KANABEC CO		

TOT	9600	4.4%
TRKS	421	4.4%
STUDY: 8 LOC: 101		
TYPE: ADT		
DIR: BOTH		
TH12 & TH22 E. OF JCT		
TH12		
MEERER CO		

TOT	2950	5.7%
TRKS	169	5.7%
STUDY: 8 LOC: 108		
TYPE: ADT		
DIR: BOTH		
TH169 S OF JCT TH201		
SHERBURNE CO		

TOT	3850	6.5%
TRKS	250	6.5%
STUDY: 8 LOC: 109		
TYPE: ADT		
DIR: BOTH		
TH201 W OF JCT TH169		
SHERBURNE CO		

TOT	6150	5.7%
TRKS	350	5.7%
STUDY: 8 LOC: 110		
TYPE: ADT		
DIR: BOTH		
TH169 N OF JCT TH201		
SHERBURNE CO		

TOT	2000	5.4%
TRKS	108	5.4%
STUDY: 8 LOC: 111		
TYPE: ADT		
DIR: BOTH		
TH47 N OF ISANTI-		
OKA CD LINE		
ISANTI CO		

TOT	9600	4.4%
TRKS	421	4.4%
STUDY: 8 LOC: 101		
TYPE: ADT		
DIR: BOTH		
TH12 & TH22 E. OF JCT		
TH12		
MEERER CO		

TOT	2950	5.7%
TRKS	169	5.7%
STUDY: 8 LOC: 108		
TYPE: ADT		
DIR: BOTH		
TH169 S OF JCT TH201		
SHERBURNE CO		

TOT	3850	6.5%
TRKS	250	6.5%
STUDY: 8 LOC: 109		
TYPE: ADT		
DIR: BOTH		
TH201 W OF JCT TH169		
SHERBURNE CO		

TOT	6150	5.7%
TRKS	350	5.7%
STUDY: 8 LOC: 110		
TYPE: ADT		
DIR: BOTH		
TH169 N OF JCT TH201		
SHERBURNE CO		

TOT	2000	5.4%
TRKS	108	5.4%
STUDY: 8 LOC: 111		
TYPE: ADT		
DIR: BOTH		
TH47 N OF ISANTI-		
OKA CD LINE		
ISANTI CO		

*Revised to show
2009 1st DATE*

LEAST SQUARES WORKSHEET

ROUTE: I-94

SP#: 8680-142

DATE 05/30/08

LOCATION: CSAH 75 to CSAH 19

BASE YEAR 2009

FORECAST YEAR: 2029

YEAR	FLOW MAP AADT (SEG A)	SEG A HCADT	SEG A 5AX TST	FLOW MAP AADT (SEG B)	SEG A AXLE COOR. FACT. USED	SEG B AXLE COOR. FACT. USED	CORRECTED AADT-A	CORRECTED AADT-A
1986	23250				1.00	1	23250	0
1988	23270				0.89	1	26212	0
1990					0.89	1	0	0
1992					0.89	1	0	0
1994					0.89	1	0	0
1996	38000				0.89	1	42805	0
1998	44000				0.89	1	49564	0
2000	50000				0.89	1	56322	0
2002					0.89	1	0	0
2004					0.89	1	0	0
2006	62000				0.89	1	69840	0
							0	0
							0	0
							0	0
							0	0
							0	0

LEAST SQUARES BASED FORECASTS:

PROJECTED

Year	AADT (Seg. A)	HCADT	5AX TXT	AADT (Seg. B)	Axle Corr. Factors - A	Axle Corr. Factors - B	Calc	ADT Calc
<u>2006</u>	61340	#N/A	#N/A	#DIV/0!	0.88774697	1	660	62000
<u>2009</u>	67640	#N/A	#N/A	0	0.88774697	1		68300
<u>2029</u>	109620	#N/A	#N/A	0	0.88774697	1		110280

Statistics	AADT (Seg. A)	HCADT	5AX TST	AADT (Seg. B)
R 2	0.99	#N/A	#N/A	#DIV/0!
SLOPE	2099.11	#N/A	#N/A	#DIV/0!
INTERCEPT	-4149466	#N/A	#N/A	#DIV/0!
N	6	0	0	0

USE THIS

YEAR	AADT
2006	62000
2009	68300
2029	110300

(AADT'S AND STATISTICS INCLUDE AXLE-CORRECTION.)

PER YEAR GROWTH RATE OVER BASE YR - 2009
 3.1% #N/A #N/A #DIV/0!

revised to show
2009 1st DATE

LEAST SQUARES WORKSHEET

ROUTE: I-94

SP#: 8680-142

DATE 05/30/08

LOCATION: TH 25 to CSAH 75

BASE YEAR 2009

FORECAST YEAR: 2029

YEAR	FLOW MAP AADT (SEG A)	SEG A HCADT	SEG A 5AX TST	FLOW MAP AADT (SEG B)	SEG A AXLE COOR. FACT. USED	SEG B AXLE COOR. FACT. USED	CORRECTED AADT-A	CORRECTED AADT-A
1986	20900				1.00	1	20900	0
1988					0.89	1	0	0
1990					0.89	1	0	0
1992	29700				0.89	1	33455	0
1994					0.89	1	0	0
1996	36900				0.89	1	41566	0
1998	40400				0.89	1	45508	0
2000	48000				0.89	1	54069	0
2002					0.89	1	0	0
2004					0.89	1	0	0
2006	56000				0.89	1	63081	0
							0	0
							0	0
							0	0
							0	0
							0	0

LEAST SQUARES BASED FORECASTS:

PROJECTED

Year	AADT (Seg. A)	HCADT	5AX TXT	AADT (Seg. B)	Axle Corr. Factors - A	Axle Corr. Factors - B	Calc	ADT Calc	
<u>2006</u>	56820	#N/A	#N/A	#DIV/0!	0.88774697		1	-820	56000
<u>2009</u>	62580	#N/A	#N/A	0	0.88774697		1		61760
<u>2029</u>	100990	#N/A	#N/A	0	0.88774697		1		100170

Statistics	AADI (Seg. A)	HCADT	5AX TST	AADI (Seg. B)
R 2	0.99	#N/A	#N/A	#DIV/0!
SLOPE	1920.43	#N/A	#N/A	#DIV/0!
INTERCEPT	-3795568	#N/A	#N/A	#DIV/0!
N	6	0	0	0

USE THIS

YEAR	AADT
2006	56000
2009	61800
2029	100200

(AADT'S AND STATISTICS INCLUDE AXLE-CORRECTION.)

PER YEAR GROWTH RATE OVER BASE YR - 2009
 3.1% #N/A #N/A #DIV/0!

ISTH	94	178+00.121	EB	EXIT RAMP TO MNTH-24	178.798	3	3B	7380	2630	029	15
ISTH	4	178+00.173	STEARNs-WRIGHT	CO LINE	178.850	3	3B	8680	2610	004	3-95
ISTH	94	178+00.276	JCT MNTH-24/BR#86807	UNDER TH 24	178.953	3	3B	8680	2610	004	41205
ISTH	94	178+00.430	WB	EXIT RAMP TO MNTH-24	179.107	3	3B	8680	2610	004	41205
ISTH	94	178+00.444	EB	ENT RAMP FROM MNTH-24	179.121	3	3B	8680	2610	004	41205
ISTH	94	181+00.418	BR#86808	UNDER TWP RD	182.083	3	3B	8680	2610	004	41205
ISTH	94	183+00.324	WB	ENT RAMP FROM CSAH-8	183.964	3	3B	8680	2610	004	41205
ISTH	94	183+00.326	EB	EXIT RAMP TO CSAH-8	183.966	3	3B	8680	2610	004	41205
ISTH	94	183+00.491	BR#86809	UNDER CSAH 8	184.131	3	3B	8680	2610	016	47235
ISTH	94	183+00.648	EB	ENT RAMP FROM CSAH-8	184.288	3	3B	8680	2610	016	47235
ISTH	94	183+00.669	WB	EXIT RAMP TO CSAH-8	184.309	3	3B	8680	2610	016	47235
ISTH	94	184+00.321	BR#91089	SILVER CREEK	184.992	3	3B	8680	2610	016	47235
ISTH	94	186+00.448	BR#86810	UNDER CR 111	187.104	3	3B	8680	2610	016	47235
ISTH	94	186+00.774	EB	EXIT RAMP TO REST AREA	187.430	3	3B	8680	2610	016	47235
ISTH	94	190+00.367	BR#86815	UNDER TWP RD	191.010	3	3B	8680	2610	016	47235
ISTH	94	192+00.243	BR#86802	UNDER CSAH 39	192.888	3	3B	8680	2610	013	47235
ISTH	94	193+00.069	W	LIM MONTICELLO,W URB BDRY	193.733	3	3B	8680	2610	2635	000
ISTH	94	193+00.243	WB	ENT RAMP FROM MNTH-25	193.907	3	3B	8680	2610	2635	000
ISTH	94	193+00.251	EB	EXIT RAMP TO MNTH-25	193.915	3	3B	8680	2610	2635	000
ISTH	94	193+00.411	JCT MNTH-25/BR#86803	UNDER TH 25	194.075	3	3B	8680	2670	2635	000
ISTH	94	193+00.595	WB	EXIT RAMP TO & EB ENT RAMP FROM MNTH-25	194.259	3	3B	8680	2670	2635	000
ISTH	94	194+00.921	BR#86804	UNDER CR 118	195.577	3	3B	8680	2670	2635	000
ISTH	94	194+00.923	E	LIM MONTICELLO,E URB BDRY	195.579	3	3B	8680	2670	013	51255
ISTH	94	194+00.932	BR#86526	TH 94	195.588	3	3B	8680	2670	013	51255
ISTH	94	195+00.316	NW	END BR#86813	195.972	3	3B	8680	2670	013	51255
ISTH	94	195+00.333	NW	END BR#86814	195.989	3	3B	8680	2670	013	51255
ISTH	94	195+00.406	SE	END BR#86813	196.062	3	3B	8680	2670	013	51255
ISTH	94	195+00.427	SE	END BR#86814	196.083	3	3B	8680	2670	013	51255
ISTH	94	195+00.592	WB	EXIT RAMP TO CSAH-75	196.248	3	3B	8680	2670	013	51255
ISTH	94	196+00.036	EB	ENT RAMP FROM CSAH-75	196.727	3	3B	8680	2670	013	57285
ISTH	94	196+00.937	WB	ENT FROM MN/ROAD RESEARCH PROJECT	197.628	3	3B	8680	2670	013	57285
ISTH	94	199+00.123	W	LIM OTSEGO	199.800	3	3B	8680	2670	2972	000
ISTH	94	199+00.680	WB	EXIT TO MN/ROAD RESEARCH PROJECT	200.357	3	3B	8680	2670	2972	000
ISTH	94	200+00.133	E	LIM OTSEGO,W LIM ALBERTVILLE	200.809	3	3B	8680	2670	0050	000
ISTH	94	200+00.996	WB	ENT RAMP FROM CSAH-19	201.672	3	3B	8680	2670	0050	000
ISTH	94	201+00.050	EB	EXIT RAMP TO CSAH-19	201.727	3	3B	8680	2670	0050	000
ISTH	94	201+00.233	NW	END BR#86817	201.910	3	3B	8680	2670	0050	000
ISTH	94	201+00.242	NW	END BR#86818	201.919	3	3B	8680	2670	0050	000
ISTH	94	201+00.273	SE	END BR#86817	201.950	3	3B	8680	2670	0050	000
ISTH	94	201+00.282	SE	END BR#86818	201.959	3	3B	8680	2670	0050	000
ISTH	94	201+00.823	EB	EXIT RAMP TO CSAH-37	202.500	3	3B	8680	2670	0050	000
ISTH	94	201+00.867	WB	ENT RAMP FROM CSAH-37	202.544	3	3B	8680	2670	0050	000
ISTH	94	202+00.021	BR#86811	UNDER CSAH 37	202.693	3	3B	8680	2670	0050	000
ISTH	94	202+00.202	EB	ENT RAMP FROM CSAH-37	202.874	3	3B	8680	2670	0050	000
ISTH	94	202+00.211	WB	EXIT RAMP TO CSAH-37	202.883	3	3B	8680	2670	0050	000
ISTH	94	202+00.933	E	LIM ALBERTVILLE,E LIM ST MICHAEL	203.605	3	3B	8680	2670	3420	000
ISTH	94	204+00.785	WB	ENT RAMP FROM MNTH-241	205.426	3	3B	8680	2670	0050	000
ISTH	94	204+00.850	EB	EXIT RAMP TO MNTH-241	205.491	3	3B	8680	2670	0050	000
ISTH	94	205+00.038	JCT MNTH-241/BR#86812	UNDER TH 241	205.679	5	5A	8680	2670	014	73365

Tony Hughes - Soil Engineer

SP: 8680-142 Proj Seq: 18691 Hwy: 94 Top of 3 District List

SP: 8680-142 HWY: 94 CMTY: Wright STATUS: Programmed ORG.LET: 7-22-05 CUR.LET: 3-27-09
 DESCRIPTION: **EILA** Replace BR-#86813 & #86814 with new bridges # 86819 and 86820

East of Monticello

PROGRAM: BR WRK TYPE: Bridge Replace or Construction
 MI: .486 BEG.RF.PNT: 195+00.263 COST EST CHANGE: 01-03-08 ORG.COST: \$6,000,000
 FY: 09 END RF.PNT: 195+00.649 AUTH DATE: CUR.COST: \$6,500,000
 AREA ENG: PARCELS: 2 RELOCS: 0 R/W COST: \$100,000

PREL. PROJ. MGR: Humbert, Terry FIN. DES. PROJ. MGR: Highum, Tom RES. ENG:
 DESIGN ENG: FUND DESIGNATORS: SF,IM,SM,NH PLANS READY DATE:

SECONDARY WRK TYPES: GRADE & SURFACE, BRIDGE APPROACHES, BRIDGE REMOVAL, TEMPORARY BRIDGE

JOB NUMBERS: 8680-(86819): BP=T32441, 8680-(86820): BP=T32442, 8680-(99196): BP=T32476,
 8680-142: P=T38678, R=T39075
 ASSOCIATED SPS: 8680-(86819), 8680-(86820), 8680-(99196)

ACT NUM	DESCRIPTION	DUR	% COM	REM DUR	EARLY START	EARLY FINISH	LATE START	LATE FINISH	TOTAL FLOAT	ACTUAL START	ACTUAL FINISH
1001	PROJECT INITIATION	0	100	0		7-1-01			0	7-1-01	7-1-
1002	STRUCTURE SCOPING	7	100	0		5-2-06			0	4-30-04	5-2-
1003	PROJECT SCOPING	62	100	0		8-14-06			0	8-18-03	8-14-
1012	AERIAL PHOTOGRAPHY	120	100	0		2-20-06			0	11-9-05	2-20-
1018	PHOTOGRAMMETRIC BASE	250	100	0		2-20-06			0	6-16-05	2-20-
1020	PRELIM DESIGN MAPPIN	180	100	0		2-20-06			0	8-25-05	2-20-
1021	PRELIM DESIGN SURVEY	59	100	0		2-20-06			0	12-24-05	2-20-
1030	CONTROL SURVEYS	23	100	0		8-21-06			0	2-26-06	8-21-
1032	DISTRICT LAND SURVEY	47	100	0		7-11-07			0	2-25-06	7-11-
1040	FINAL DESIGN SURVEYS	41	100	0		7-11-07			0	2-27-06	7-11-
1041	BRIDGE SURVEYS	120	100	0		4-12-07			0	1-12-07	4-12-
1054M	SCOPING COMPLETE	0	100	0		8-15-06			0	8-15-06	8-15-
1070	PROJECT MEMORANDUM	60	100	0		5-11-07			0	3-13-07	5-11-
1075	STRUCTURE RECOMMENDA	90	100	0		6-7-07			0	1-20-06	6-7-
1080	PRELIM GEOMETRIC LAY	95	100	0		2-20-06			0	11-18-05	2-20-
1085	SHPO CONCURRENCE	60	100	0		12-1-03			0	10-3-03	12-1-
1135M	ENVIRONMENTAL DOCUME	0	100	0		5-12-07			0	5-12-07	5-12-
1140	FINAL GEOMETRIC LAYO	60	100	0		10-24-06			0	12-25-05	10-24-
1141	PRELIM HYDRAULICS DE	30	50	15	12-21-07	1-4-08	4-4-08	4-18-08	105	8-22-06	
1180	MATERIALS DESIGN REC	30	0	30	2-19-08	3-19-08	8-8-08	9-6-08	171		
1182	MATERIALS SURVEY AND	60	0	60	12-21-07	2-18-08	4-4-08	6-2-08	105		
1190	FOUNDATION RECOMMEND	90	80	18	12-21-07	1-7-08	4-4-08	4-21-08	105	6-1-06	
1194	UTILITY IDENTIFICATI	158	100	0		3-1-07			0	12-26-06	3-1-
1195	UTILITY COORDINATION	60	0	60	1-5-08	3-4-08	9-9-08	11-7-08	248		

1196	UTILITY VERIFICATION	30	0	30	3-5-08	4-3-08	11-20-08	12-19-08	260		
1200	CONSTRUCTION LIMITS	180	100	0		6-1-06			0	12-4-05	6-1-
1200M	CONSTR LIMITS COMPLETE	0	100	0		6-2-06			0	6-2-06	6-2-
1210	TITLE ORDER	41	100	0		6-7-06			0	4-28-06	6-7-
Orders only - railroad permit to construct											
1220	R/W PACKAGE	60	100	0		6-21-07			0	4-20-06	6-21-
1225	PLATS AND DISTRICT S	95	0	95	1-5-08	4-8-08	11-25-08	2-27-09	325		
1230	RIGHT OF WAY PREACQU	120	85	18	3-22-08	4-8-08	2-10-09	2-27-09	325	6-2-07	
1240	Real Estate Purchase	240	0	240	12-21-07	8-16-08	7-3-08	2-27-09	195		
1249	FINAL HYDRAULICS DES	30	0	30	1-5-08	2-3-08	8-8-08	9-6-08	216		
1250	ROAD PLANS	90	0	90	3-20-08	6-17-08	9-7-08	12-5-08	171		
Denny Hansen											
1252	LIGHTING PLANS	20	0	20	12-21-07	1-9-08	11-16-08	12-5-08	331		
1254	TRAFFIC CONTROL PLAN	18	0	18	3-20-08	4-6-08	12-2-08	12-19-08	257		
1260	PRELIMINARY BRIDGE P	120	10	108	1-8-08	4-24-08	4-22-08	8-7-08	105	5-26-07	
1270	FINAL BRIDGE PLANS	120	0	120	4-25-08	8-22-08	8-8-08	12-5-08	105		
1275	PROJECT TURN IN	14	0	14	8-23-08	9-5-08	12-6-08	12-19-08	105		
1280	PERMITS	60	0	60	2-4-08	4-3-08	9-7-08	11-5-08	216		
1291	AGREEMENTS-RAILROADS	60	0	60	8-9-08	10-7-08	12-30-08	2-27-09	143		
1292	AGREEMENTS- UTILITY	60	0	60	8-23-08	10-21-08	12-30-08	2-27-09	129		
1295	AGREEMENTS-LIGHTING	60	0	60	12-21-07	2-18-08	12-30-08	2-27-09	375		
1296	AGREEMENTS-DETOUR :	60	0	60	8-23-08	10-21-08	12-30-08	2-27-09	129		
1298M	R/W SPECIAL PROVISIO	0	0	0	10-11-08	10-11-08	1-24-09	1-24-09	105		
1300	PS&E	70	0	70	9-6-08	11-14-08	12-20-08	2-27-09	105		
1301	STRUCTURES PS&E	14	0	14	8-23-08	9-5-08	1-24-09	2-6-09	154		
1310	LETTING	28	0	28	2-28-09	3-27-09	2-28-09	3-27-09	0		
1310M	LETTING HELD	0	0	0	3-28-09	3-28-09	3-28-09	3-28-09	0		
1311	AWARD OF CONTRACT	45	0	45	3-28-09	5-11-09	3-28-09	5-13-09	0		
1320M	R/W ACQUISITION COMP	0	0	0	11-24-09	11-24-09	12-22-09	12-22-09	0		

END OF 8680-142

TH I-94
 SP 8680-142
 CTY Wright
 PROB BR

PROJ MGR TERRY HUMBERT
 SOILS ENG. TOMY HUGHES
 RP 195,263 - 195,649 (3.86 MI)

OB = 59,800
 RB = 98,100
 RZ = .99
 GR = 3.2%

REPLACE BR # 8613 & 8614 with
 New Bridges # 8619 and 8620

B SEG

A SEG

VCC 8106
 Counted
 074) 0811
 92(2) 85(2)

OB = 66,200
 RB = 108,100
 RZ = .99
 GR = 3.2%

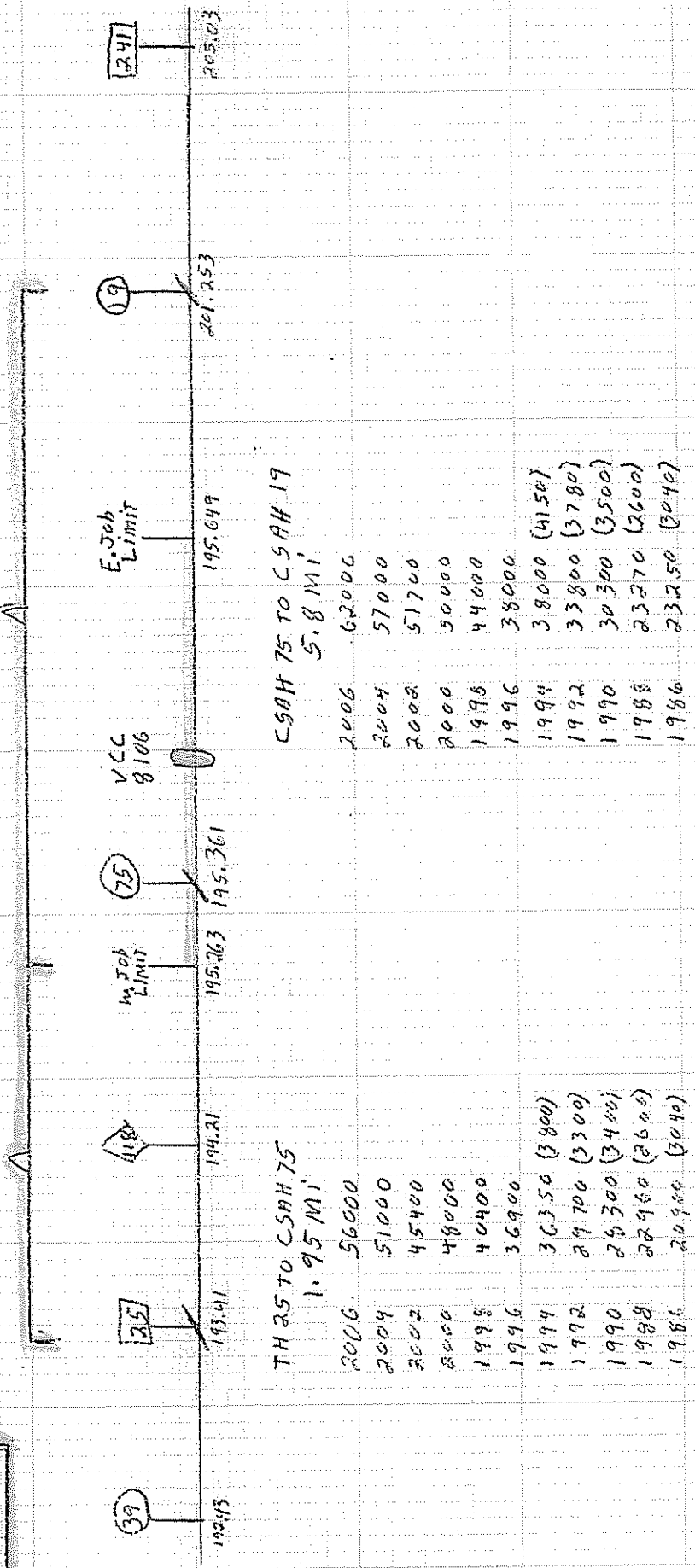

TH 25 TO CSAH 75
 1.95 MI

CSAH 75 TO CSAH 19
 5.8 MI

2006	56000
2004	51000
2002	45400
2000	48000
1998	40400
1996	36900
1994	36350 (3800)
1992	29700 (3300)
1990	26300 (3400)
1988	28900 (2600)
1986	20900 (3040)

2006	62000
2004	57000
2002	51700
2000	50000
1998	44000
1996	38000
1994	38000 (4150)
1992	33800 (3780)
1990	30300 (3500)
1988	23270 (2600)
1986	23250 (3040)



ST. CLOUD AREA INSET

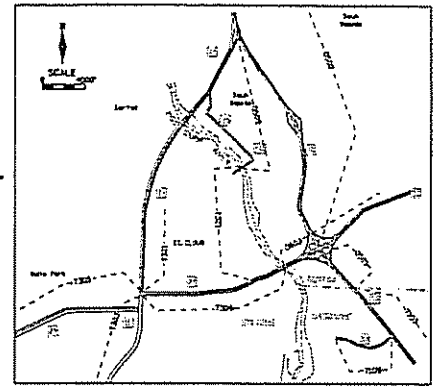

BRAINERD AREA INSET

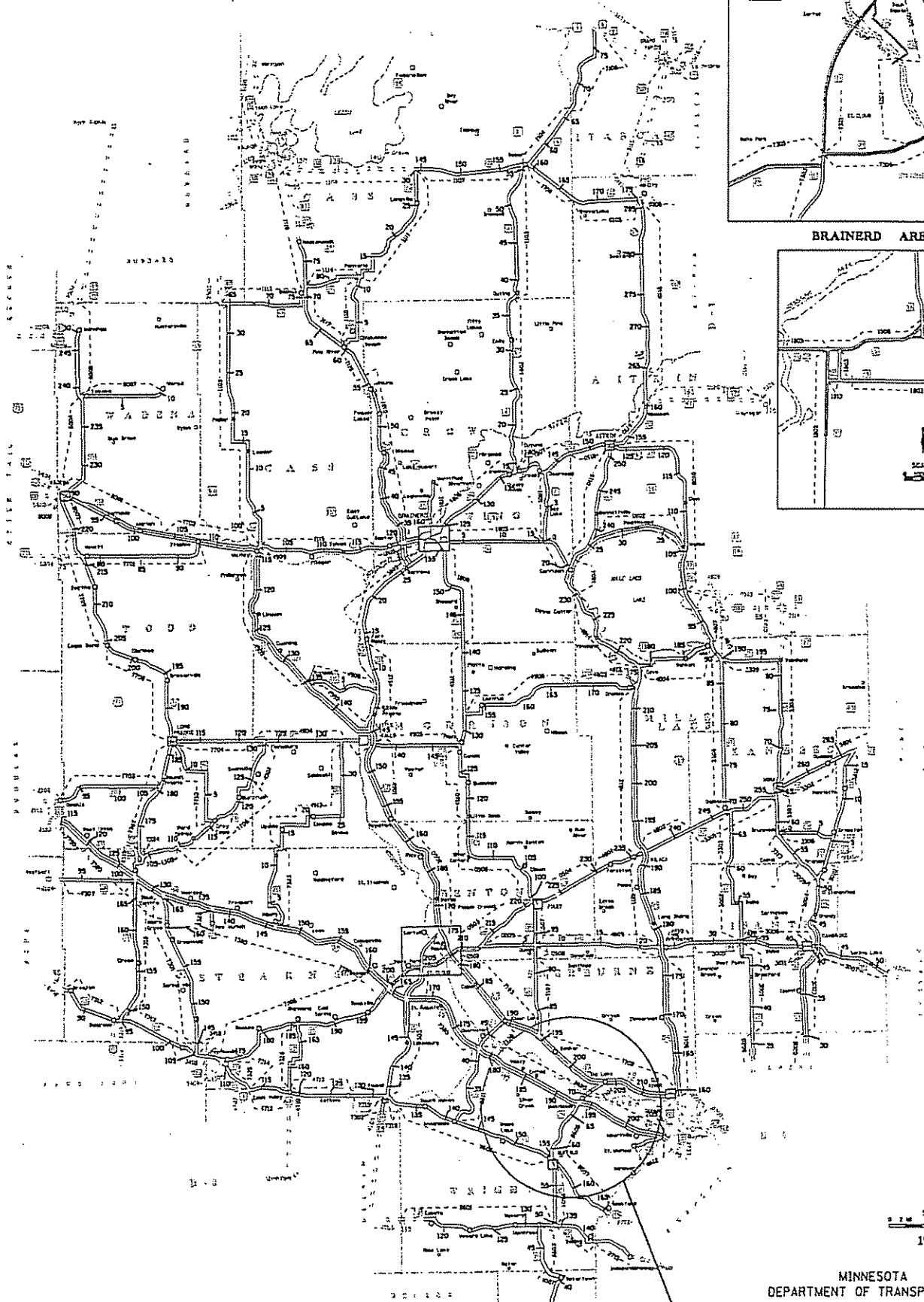
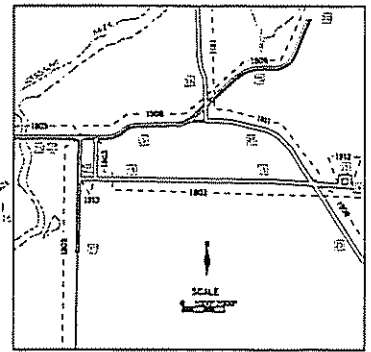

SCALE 1:250,000
1989

MINNESOTA
DEPARTMENT OF TRANSPORTATION
DISTRICT 3

- == PROPOSED ROUTE
- == INTERSTATE ROUTE
- == UNITED STATES NUMBERED HIGHWAY
- == STATE HIGHWAY SYSTEM
- == ROUTE SECTIONS IN ADJACENT DISTRICTS
- COUNTY SEATS
- MUNICIPALITIES
- CITIES
- - - - - COUNTY BOUNDARIES

DISTRICT 3

SP 8680-142
F3-0805
RP195.263-RP195.649

8106

WRIGHT
County

