

REVISION DATE 01/06/17

Sample Plan

FENCING PLANS ----- NARRATIVE

References:

Design Scene: Chapter 15 - Fencing

Standard Plates Manual: 9320, 9321, 9322, 9323, and 9324

Spec Book: 2557, 2572

General Information:

The primary reason to erect fences along highways is control of access and safety. Consider corridor needs when determining whether or not to provide permanent fencing. Fence should typically be placed one foot inside the Right of Way.

Fencing plans may be shown separately or included on the Construction Plan sheets. If so, title as such.

Include specific items such as electrical grounds, brace assemblies, gates, and metal post extensions.

Consider incorporating temporary fencing near areas of bridge and roadway construction, open excavation holes, tree protection, schools, residential areas, etc.

Retaining walls or noise walls within a reasonable distance from the R/W line may serve as a fence.

Fences should be considered on retaining walls with or without parapets (for pedestrian and maintenance personnel safety considerations).

Fencing requirements at ponding areas, R/W, residential areas, etc. should be coordinated with the Municipalities, adjacent property owners, and Maintenance.

Typically, a fence height is 60". Alternative heights may be necessary in public use areas such as rest areas, scenic overlooks, and on bridges with pedestrian traffic.

Fencing coating color needs to be coordinated with the Site Development Unit or may have been addressed in the project's Visualization Manual.

Gates should be considered for such things as maintenance, utility access, and drainage structure access.

Provide a minimum of 10' (preferred 15'-30') from the face of curb to the fence to prevent damage from snow plowing.

If desired, temporary fencing may be shown on the Inplace Removal sheets.

Potential conflicts with underground utilities should be taken into consideration.

Consult Maintenance Office when deciding whether or not to replace existing fence.

If any existing chain link fence on the Project within the clear zone has a top bar, it will need to have the bar removed and replaced with a wire and shall be paid for as Salvage Chain Link Fence.

26-JAN-2017 09:12

Sample Plan

FENCING PLANS ----- CHECKLIST

- ___ 1. Alignments shown and labeled
- ___ 2. Stationing shown (normally at 500' increments)
- ___ 3. North Arrow
- ___ 4. Bar Scale
- ___ 5. Roadways Labeled
- ___ 6. Legend
- ___ 7. Electrical Grounds, Gates, and Post Extensions
- ___ 8. General Note Stating Dimensions from R/W to Fence Locations
- ___ 9. Cross references to other sheets (as applicable)
- ___ 10. Drawn by: and Checked by: Initials and Engineer's signature

REVISION DATE 010617
PLOTTED/REVISED: 26-JAN-2017 09:42

DISTRICT #: METRO
PLOT NAME: spfencing
FILENAME: Projects\DM_R0S\Non_Project\Design\SamplePlan\Eng\Ish\ fencing.dgn

NOTE: FOR ADDITIONAL TEMPORARY FENCE LOCATIONS,
SEE DRAINAGE SHEET DETAILS OF OFFTAKE
DITCHES ON SHEET NO. 196.

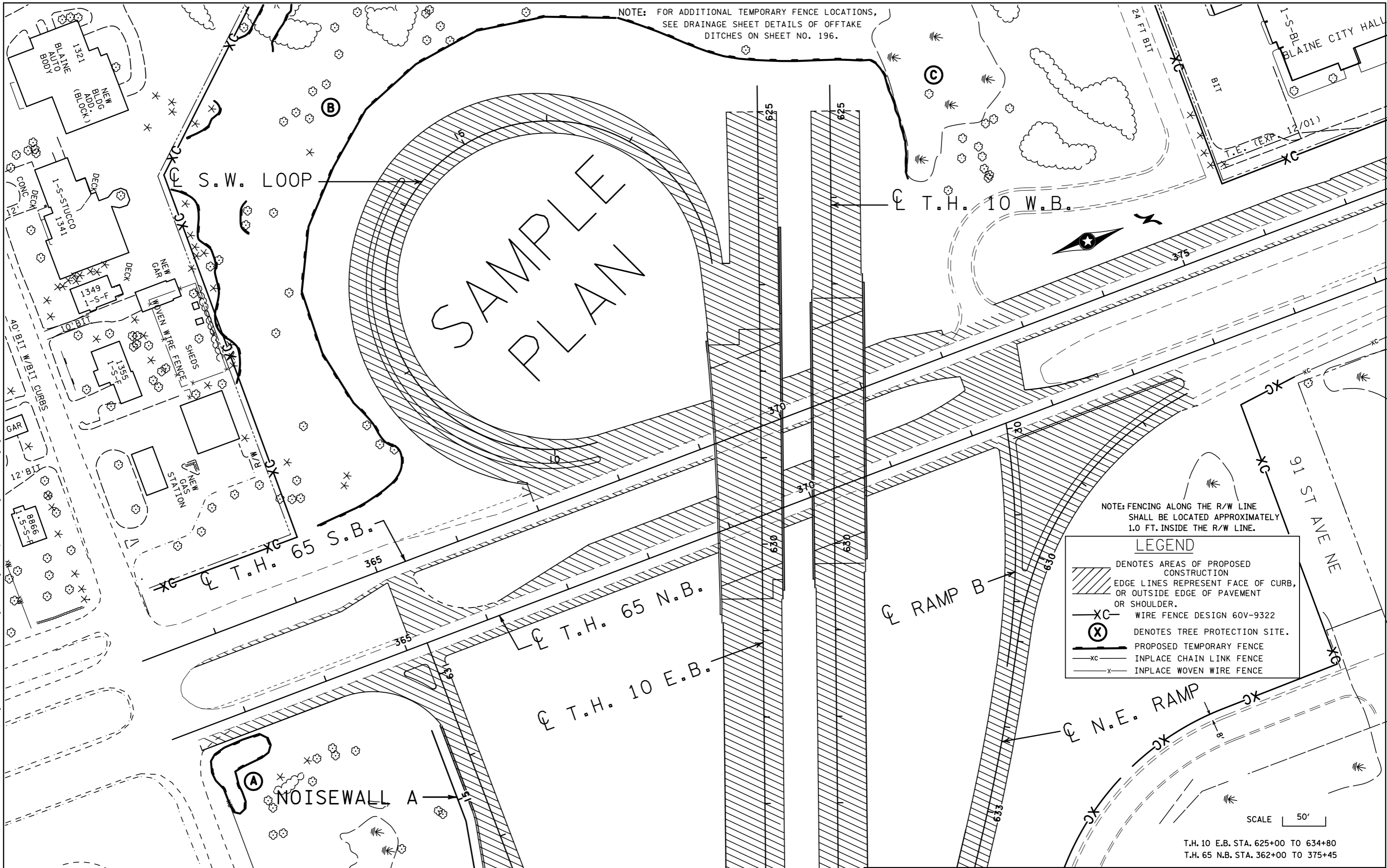

NOTE: FENCING ALONG THE R/W LINE
SHALL BE LOCATED APPROXIMATELY
1.0 FT. INSIDE THE R/W LINE.

LEGEND

- DENOTES AREAS OF PROPOSED CONSTRUCTION
- EDGE LINES REPRESENT FACE OF CURB, OR OUTSIDE EDGE OF PAVEMENT OR SHOULDER.
- WIRE FENCE DESIGN 60V-9322
- DENOTES TREE PROTECTION SITE.
- PROPOSED TEMPORARY FENCE
- INPLACE CHAIN LINK FENCE
- INPLACE WOVEN WIRE FENCE

SCALE 50'

T.H. 10 E.B. STA. 625+00 TO 634+80
T.H. 65 N.B. STA. 362+00 TO 375+45

FENCING PLAN