

TOWNSHIP OF MARYSLAND

PREPARED BY THE
MINNESOTA DEPARTMENT OF TRANSPORTATION
OFFICE OF TRANSPORTATION SYSTEM MANAGEMENT

IN COOPERATION WITH
U.S. DEPARTMENT OF TRANSPORTATION
FEDERAL HIGHWAY ADMINISTRATION

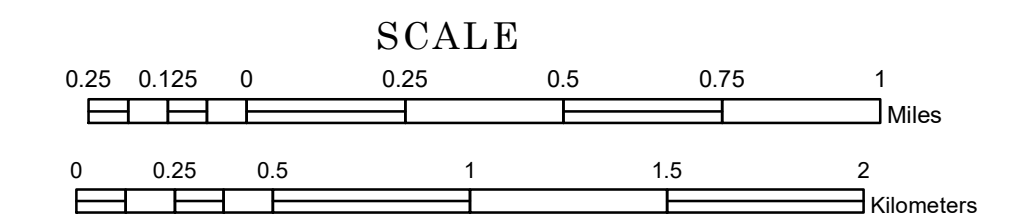

1 in = 1,600 ft

2024

Projection:
Transverse Mercator
NAD 1986
UTM Zone 15

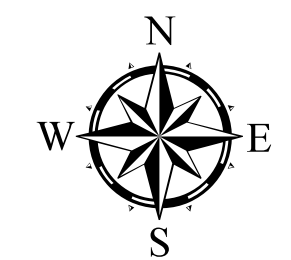

North American Datum
of 1986

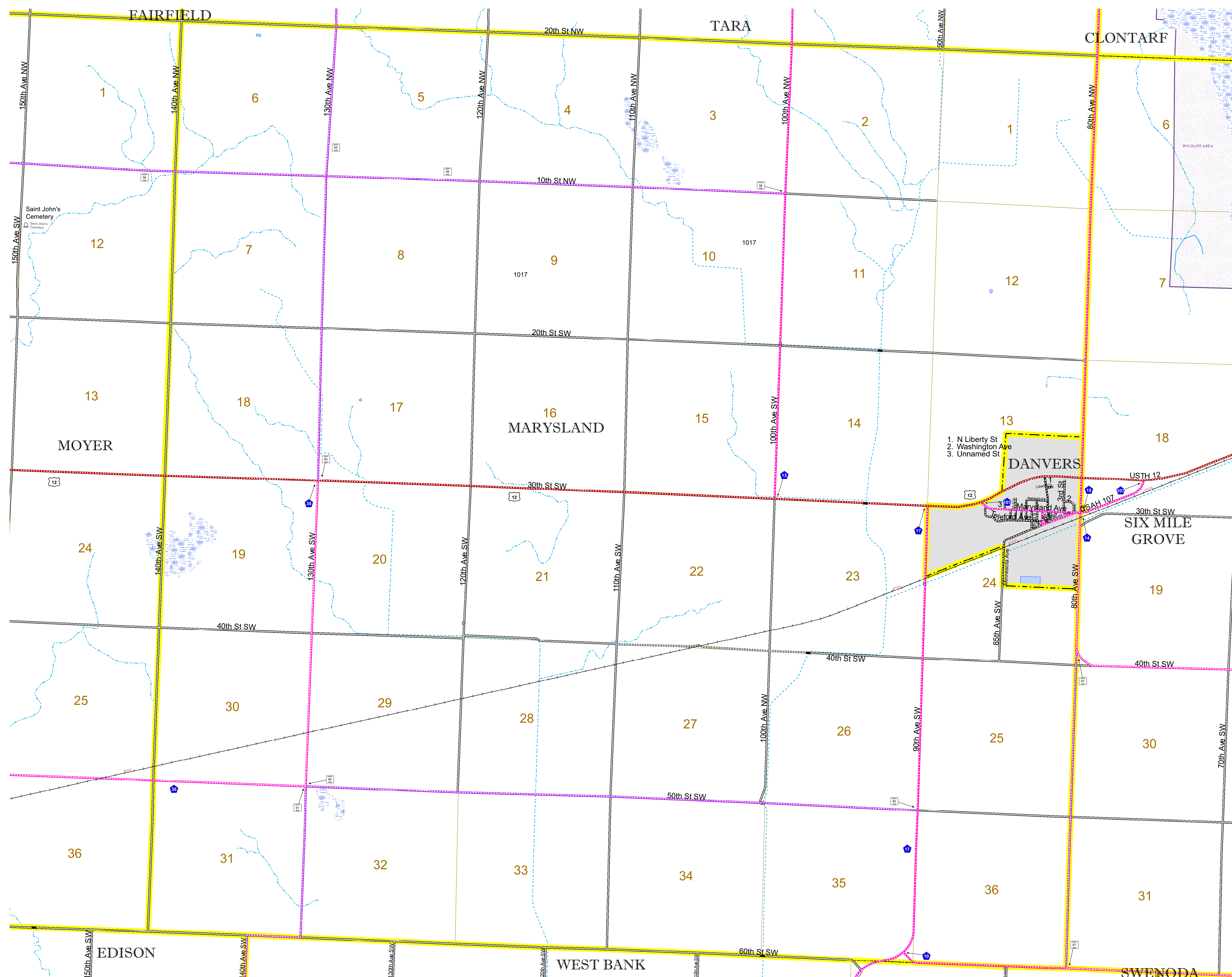

ROAD AND ROADWAY FEATURES		AVIATION FEATURES	
INTERSTATE	CONCRETE	COMMERCIAL AIRPORT	GENERAL AIRPORT
US HIGHWAY	BITUMINOUS	NORTHSTAR AIRSTRIP	AIRSTRIP
MN HIGHWAY	GRAVEL	SEAPLANE	AIRPORT RUNWAY
COUNTY STATE AID HIGHWAY	DIRT/UNIMPROVED	OTHER	UNKNOWN
COUNTY ROAD	UNKNOWN	UNORGANIZED TERRITORY ROAD	UNKNOWN
TOWNSHIP ROAD	UNKNOWN	UNORGANIZED TERRITORY ROAD	UNKNOWN
UNORGANIZED TERRITORY ROAD	UNKNOWN	UNORGANIZED TERRITORY ROAD	UNKNOWN
OTHER ROADS	RAMP OR CONNECTOR	INTERSTATE EXIT	INTERSTATE EXIT
MUNICIPAL	PRIVATE	NATIONAL MONUMENT	STATE FOREST
NATIVE SERVICE	NATIONAL PARK	NATIONAL WILDLIFE	STATE GAME
MILITARY	NATIONAL FOREST	STATE PARK	PRESERVE
RAILROAD AND RAILWAY FEATURES		BOUNDARY FEATURES	
EMPIRE BUILDER STATION (AMTRAK)	STATE OF MINNESOTA	COUNTY	MUNICIPALITY
NORTHSTAR STATION (COMPUTER)	COUNTY	MUNICIPALITY	UNORGANIZED TERRITORY
LIGHT RAIL	STATE OF MINNESOTA	COUNTY	MUNICIPALITY
BLUE LINE	STATE OF MINNESOTA	COUNTY	MUNICIPALITY
GREEN LINE	STATE OF MINNESOTA	COUNTY	MUNICIPALITY
INFRASTRUCTURE FEATURES		BOUNDARY FEATURES	
LONG BRIDGE (200' OR GREATER SPAN)	STATE OF MINNESOTA	COUNTY	MUNICIPALITY
MAJOR BRIDGE (20' TO 200' SPAN)	STATE OF MINNESOTA	COUNTY	MUNICIPALITY
MINOR BRIDGE (5' TO 20' SPAN)	STATE OF MINNESOTA	COUNTY	MUNICIPALITY
DAM	STATE OF MINNESOTA	COUNTY	MUNICIPALITY
LOCK-AND-DAM	STATE OF MINNESOTA	COUNTY	MUNICIPALITY
CITY CENTERS		BOUNDARY FEATURES	
STATE CAPITAL	STATE OF MINNESOTA	COUNTY	MUNICIPALITY
COUNTY SEAT	STATE OF MINNESOTA	COUNTY	MUNICIPALITY
CITY CENTER	STATE OF MINNESOTA	COUNTY	MUNICIPALITY
UNINCORPORATED COMMUNITY	STATE OF MINNESOTA	COUNTY	MUNICIPALITY
PUBLIC SERVICE FEATURES		BOUNDARY FEATURES	
MNDOT OFFICE	STATE OF MINNESOTA	COUNTY	MUNICIPALITY
MNDOT TRUCK STATION	STATE OF MINNESOTA	COUNTY	MUNICIPALITY
HIGHWAY PATROL DISTRICT OFFICE	STATE OF MINNESOTA	COUNTY	MUNICIPALITY
STATE TRAVEL INFORMATION CENTER	STATE OF MINNESOTA	COUNTY	MUNICIPALITY
REST AREA (FULL SERVICE)	STATE OF MINNESOTA	COUNTY	MUNICIPALITY
REST AREA (VAULT TOILET)	STATE OF MINNESOTA	COUNTY	MUNICIPALITY
WAYSIDE (VAULT OR PITY TOILET)	STATE OF MINNESOTA	COUNTY	MUNICIPALITY
PARK AND RIDE LOT	STATE OF MINNESOTA	COUNTY	MUNICIPALITY
PORT OF ENTRY	STATE OF MINNESOTA	COUNTY	MUNICIPALITY
PUBLIC ACCESS POINT	STATE OF MINNESOTA	COUNTY	MUNICIPALITY
MN STATE COLLEGE AND UNIVERSITY SYSTEM (MNSCU)	STATE OF MINNESOTA	COUNTY	MUNICIPALITY
UNIVERSITY OF MN SYSTEM	STATE OF MINNESOTA	COUNTY	MUNICIPALITY
FAIRGROUNDS	STATE OF MINNESOTA	COUNTY	MUNICIPALITY
CULTURAL FEATURES		BOUNDARY FEATURES	
STATE HISTORICAL MARKER	STATE OF MINNESOTA	COUNTY	MUNICIPALITY
HISTORIC DISTRICT	STATE OF MINNESOTA	COUNTY	MUNICIPALITY
HISTORIC SITE	STATE OF MINNESOTA	COUNTY	MUNICIPALITY
MONUMENT	STATE OF MINNESOTA	COUNTY	MUNICIPALITY
HYDROLOGIC FEATURES		BOUNDARY FEATURES	
RIVER OR STREAM (PERMANENT)	STATE OF MINNESOTA	COUNTY	MUNICIPALITY
LAKE, POND OR RESERVOIR	STATE OF MINNESOTA	COUNTY	MUNICIPALITY
STREAM (INTERMITTENT)	STATE OF MINNESOTA	COUNTY	MUNICIPALITY
DRAINAGE DITCH	STATE OF MINNESOTA	COUNTY	MUNICIPALITY
WETLAND	STATE OF MINNESOTA	COUNTY	MUNICIPALITY
ISLAND OR LAND	STATE OF MINNESOTA	COUNTY	MUNICIPALITY
REGIONAL WATERSHED	STATE OF MINNESOTA	COUNTY	MUNICIPALITY

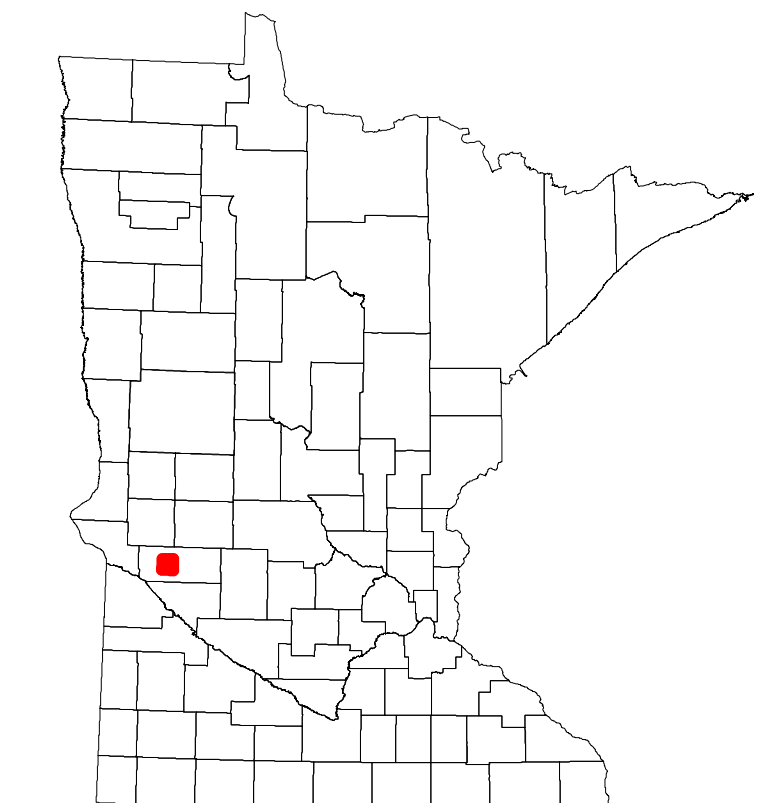

Population (U.S. Census 2010): 96

To request information from this document in an alternative format, call 651-366-4718 or 1-800-657-3774 (Greater Minnesota); 711 or 1-800-627-3529 (Minnesota Relay). You may also send an e-mail to ADAREquest.dot@state.mn.us. (Please request at least one week in advance.)