

TOWNSHIP OF BANDON

PREPARED BY THE
MINNESOTA DEPARTMENT OF TRANSPORTATION
OFFICE OF TRANSPORTATION SYSTEM MANAGEMENT

IN COOPERATION WITH
U.S. DEPARTMENT OF TRANSPORTATION
FEDERAL HIGHWAY ADMINISTRATION



2023

Projection:
Transverse Mercator
NAD 1986
UTM Zone 15



North American Datum
of 1986

ROAD AND ROADWAY FEATURES		AVIATION FEATURES	
INTERSTATE	CONCRETE	COMMERCIAL AIRPORT	GENERAL AIRPORT
US HIGHWAY	BITUMINOUS	AIRSTRIP	SEAPLANE
MN HIGHWAY	GRAVEL	AIRPORT RUNWAY	BOUNDARY FEATURES
COUNTY STATE AID HIGHWAY	DIRT/UNIMPROVED	TRIAL LAND	STATE OF MINNESOTA
COUNTY ROAD	OTHER	COUNTY	MUNICIPALITY
TOWNSHIP ROAD	UNKNOWN	UNINCORPORATED	CIVIL TOWNSHIP
UNORGANIZED TERRITORY ROAD		FEDERAL ADJUSTED URBAN AREA (2014)	CONGRESSIONAL TOWNSHIP
OTHER ROADS		CITY TOWNSHIP	SECTION
Municipal	RAMP OR CONNECTOR	MILITARY	VOYAGEURS NATIONAL PARK
Private	INTERSTATE EXIT	VOYAGEURS NATIONAL PARK	BOUNDARY WATERS CANOE AREA WILDERNESS
Nature Service	GREAT RIVER ROAD	STATE PARK	REGIONAL PARK
National Park		NATIONAL FOREST	NATIONAL AND STATE FOREST
National Wildlife Refuge		STATE FOREST	NATIONAL TRAIL
State Park		WILDLIFE REFUGE AREA	WILDLIFE REFUGE AREA
Preserve		WILDLIFE MANAGEMENT AREA	HYDROLOGIC FEATURES
		RIVER OR STREAM (PERENNIAL)	RIVER OR STREAM (PERENNIAL)
		LAKE, POND OR RESERVOIR	LAKE, POND OR RESERVOIR
		STREAM (INTERMITTENT)	STREAM (INTERMITTENT)
		DRAINAGE DITCH	DRAINAGE DITCH
		WETLAND	WETLAND
		ISLAND OR LAND	ISLAND OR LAND
		REGIONAL WATERSHED	REGIONAL WATERSHED

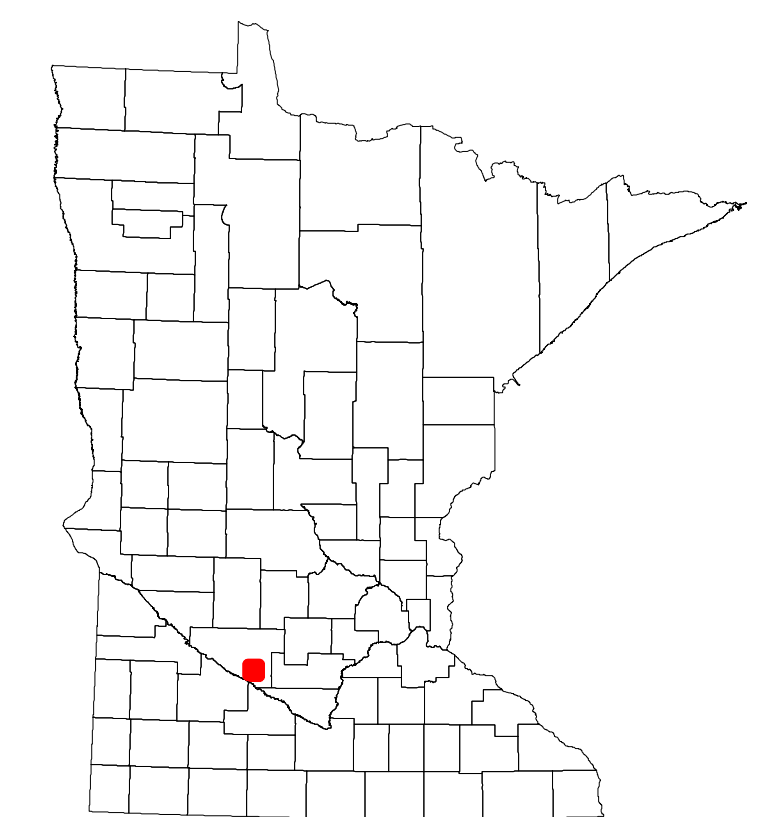

Population (U.S. Census 2010): 175

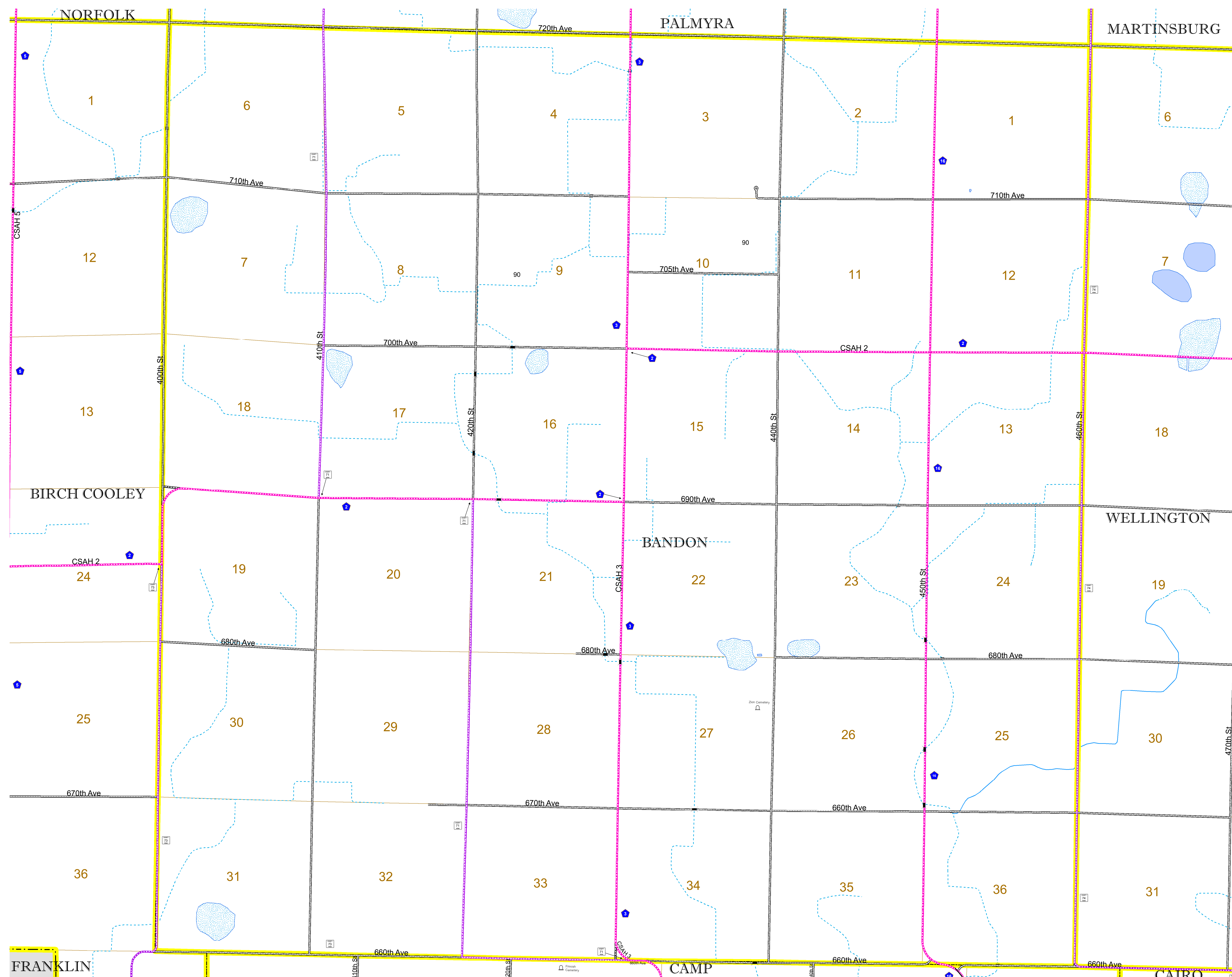

To request information from this document in an alternative format, call 651-366-4718 or 1-800-657-3774 (Greater Minnesota); 711 or 1-800-627-3529 (Minnesota Relay). You may also send an e-mail to ADAREquest.dot@state.mn.us. (Please request at least one week in advance.)