

CEDAR MILLS  
Meeker Renville Line Rd

ACOMA

HUTCHINSON

# TOWNSHIP OF LYNN

PREPARED BY THE  
MINNESOTA DEPARTMENT OF TRANSPORTATION  
OFFICE OF TRANSPORTATION SYSTEM MANAGEMENT

IN COOPERATION WITH  
U.S. DEPARTMENT OF TRANSPORTATION  
FEDERAL HIGHWAY ADMINISTRATION

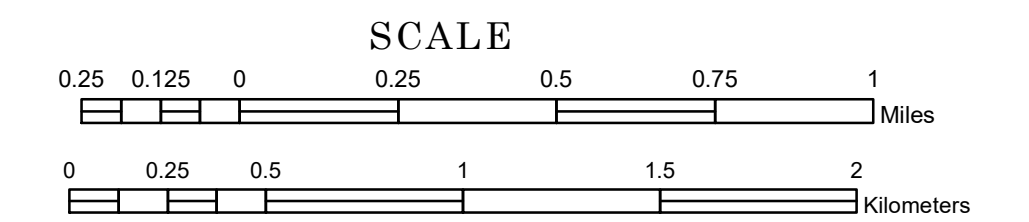

1 in = 1,600 ft

2024

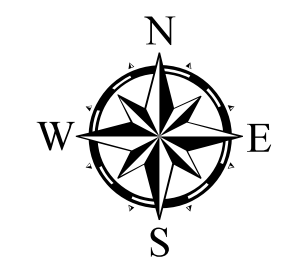

Projection:  
Transverse Mercator  
NAD 1986  
UTM Zone 15

North American Datum  
of 1986

| ROAD AND ROADWAY FEATURES       |          | AVIATION FEATURES                     |          |
|---------------------------------|----------|---------------------------------------|----------|
| INTERSTATE                      | [Symbol] | COMMERCIAL AIRPORT                    | [Symbol] |
| US HIGHWAY                      | [Symbol] | GENERAL AIRPORT                       | [Symbol] |
| MN HIGHWAY                      | [Symbol] | AIRSTRIP                              | [Symbol] |
| COUNTY STATE AID HIGHWAY        | [Symbol] | SEAPLANE                              | [Symbol] |
| COUNTY ROAD                     | [Symbol] | AIRPORT RUNWAY                        | [Symbol] |
| TOWNSHIP ROAD                   | [Symbol] |                                       |          |
| UNORGANIZED TERRITORY ROAD      | [Symbol] |                                       |          |
| OTHER ROADS                     | [Symbol] |                                       |          |
| Municipal                       | [Symbol] |                                       |          |
| Private                         | [Symbol] |                                       |          |
| National Monument               | [Symbol] |                                       |          |
| State Forest                    | [Symbol] |                                       |          |
| Nature Service                  | [Symbol] |                                       |          |
| National Park                   | [Symbol] |                                       |          |
| National Wildlife               | [Symbol] |                                       |          |
| State Game                      | [Symbol] |                                       |          |
| Museum                          | [Symbol] |                                       |          |
| National Forest                 | [Symbol] |                                       |          |
| State Park                      | [Symbol] |                                       |          |
| Preserve                        | [Symbol] |                                       |          |
| RAILROAD AND RAILWAY FEATURES   |          | BOUNDARY FEATURES                     |          |
| EMPIRE BUILDER STATION (AMTRAK) | [Symbol] | TRIBAL LAND                           | [Symbol] |
| NORTHSTAR STATION (COMMUTER)    | [Symbol] | STATE OF MINNESOTA                    | [Symbol] |
| LIGHT RAIL                      | [Symbol] | COUNTY                                | [Symbol] |
| BLUE LINE                       | [Symbol] | MUNICIPALITY                          | [Symbol] |
| GREEN LINE                      | [Symbol] | UNORGANIZED TERRITORY                 | [Symbol] |
|                                 |          | FEDERAL ADJUSTED URBAN AREA (2014)    | [Symbol] |
|                                 |          | CIVIL TOWNSHIP                        | [Symbol] |
|                                 |          | CONGRESSIONAL TOWNSHIP                | [Symbol] |
|                                 |          | SECTION                               | [Symbol] |
|                                 |          | MILITARY                              | [Symbol] |
|                                 |          | VOYAGEURS NATIONAL PARK               | [Symbol] |
|                                 |          | BOUNDARY WATERS CANOE AREA WILDERNESS | [Symbol] |
|                                 |          | STATE PARK                            | [Symbol] |
|                                 |          | REGIONAL PARK                         | [Symbol] |
|                                 |          | NATIONAL FOREST                       | [Symbol] |
|                                 |          | NATIONAL AND STATE FOREST             | [Symbol] |
|                                 |          | STATE FOREST                          | [Symbol] |
|                                 |          | NATIONAL TRAIL                        | [Symbol] |
|                                 |          | WILDLIFE REFUGUE AREA                 | [Symbol] |
|                                 |          | WILDLIFE MANAGEMENT AREA              | [Symbol] |
|                                 |          | HYDROLOGIC FEATURES                   |          |
|                                 |          | RIVER OR STREAM (PERENNIAL)           | [Symbol] |
|                                 |          | LAKE, POND OR RESERVOIR               | [Symbol] |
|                                 |          | STREAM (INTERMITTENT)                 | [Symbol] |
|                                 |          | DRAINAGE DITCH                        | [Symbol] |
|                                 |          | WETLAND                               | [Symbol] |
|                                 |          | ISLAND OR LAND                        | [Symbol] |
|                                 |          | REGIONAL WATERSHED                    | [Symbol] |

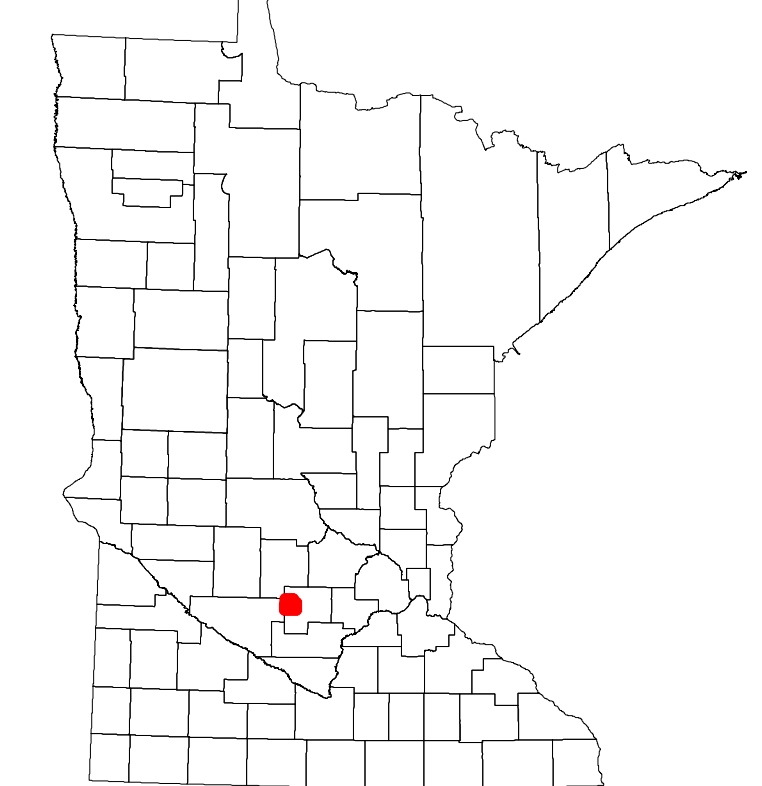

Population (U.S. Census 2010): 550

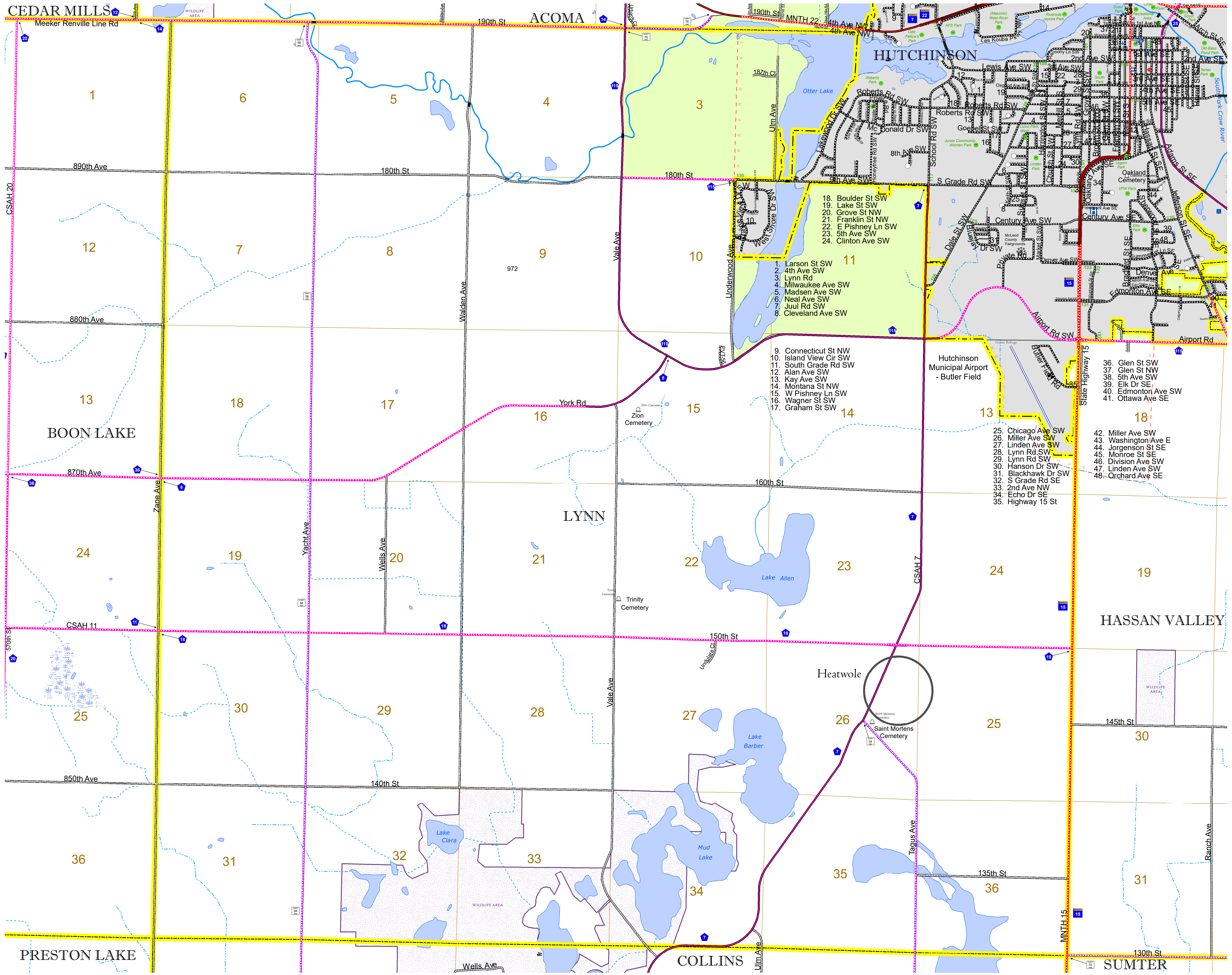

To request information from this document in an alternative format, call 651-366-4718 or 1-800-657-3774 (Greater Minnesota); 711 or 1-800-627-3529 (Minnesota Relay). You may also send an e-mail to ADARrequest.dot@state.mn.us. (Please request at least one week in advance.)