

TOWNSHIP OF CAMBRIDGE

PREPARED BY THE
MINNESOTA DEPARTMENT OF TRANSPORTATION
OFFICE OF TRANSPORTATION SYSTEM MANAGEMENT

IN COOPERATION WITH
U.S. DEPARTMENT OF TRANSPORTATION
FEDERAL HIGHWAY ADMINISTRATION

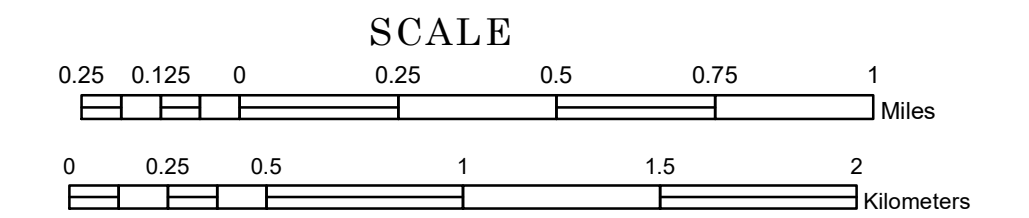

1 in = 1,600 ft
2024

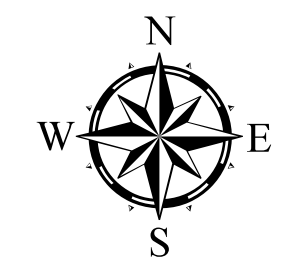

Projection:
Transverse Mercator
NAD 1986
UTM Zone 15

North American Datum
of 1986

ROAD AND ROADWAY FEATURES		RAILROAD AND RAILWAY FEATURES		BOUNDARY FEATURES	
INTERSTATE		CONCRETE		STATE OF MINNESOTA	
US HIGHWAY		BITUMINOUS		COUNTY	
MN HIGHWAY		GRAVEL		MUNICIPALITY	
COUNTY STATE AID HIGHWAY		DIRT/UNIMPROVED		UNORGANIZED TERRITORY	
COUNTY ROAD		OTHER		FEDERAL ADJUSTED URBAN AREA (2014)	
TOWNSHIP ROAD		UNKNOWN		CIVIL TOWNSHIP	
UNORGANIZED TERRITORY ROAD				CONGRESSIONAL TOWNSHIP	
OTHER ROADS				SECTION	
Municipal		RAMP OR CONNECTOR		MILITARY	
Private		INTERSTATE EXIT		VOYAGEURS NATIONAL PARK	
National Monument		GENERAL AIRPORT		BOUNDARY WATERS CANOE AREA WILDERNESS	
State Forest		AIRSTRIP		STATE PARK	
State Game		SEAPLANE		REGIONAL PARK	
State Park		AIRPORT RUNWAY		NATIONAL FOREST	
Preserve				NATIONAL AND STATE FOREST	
				STATE FOREST	
				WILDLIFE REFUGUE AREA	
				WILDLIFE MANAGEMENT AREA	
				HYDROLOGIC FEATURES	
				RIVER OR STREAM (PERMANENT)	
				LAKE, POND OR RESERVOIR	
				STREAM (INTERMITTENT)	
				DRAINAGE DITCH	
				WETLAND	
				ISLAND OR LAND	
				REGIONAL WATERSHED	

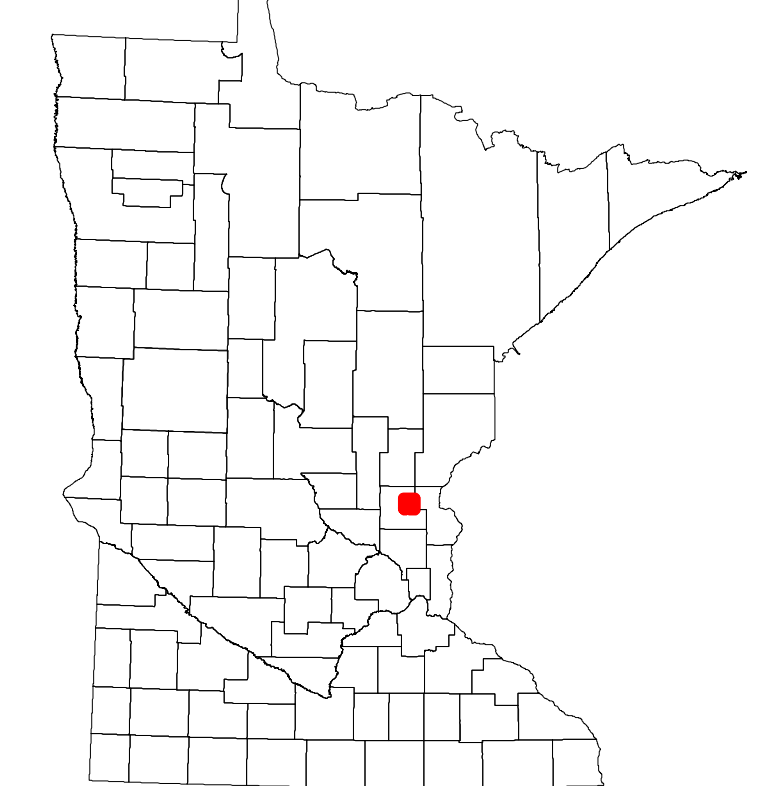

Population (U.S. Census 2010): 2379

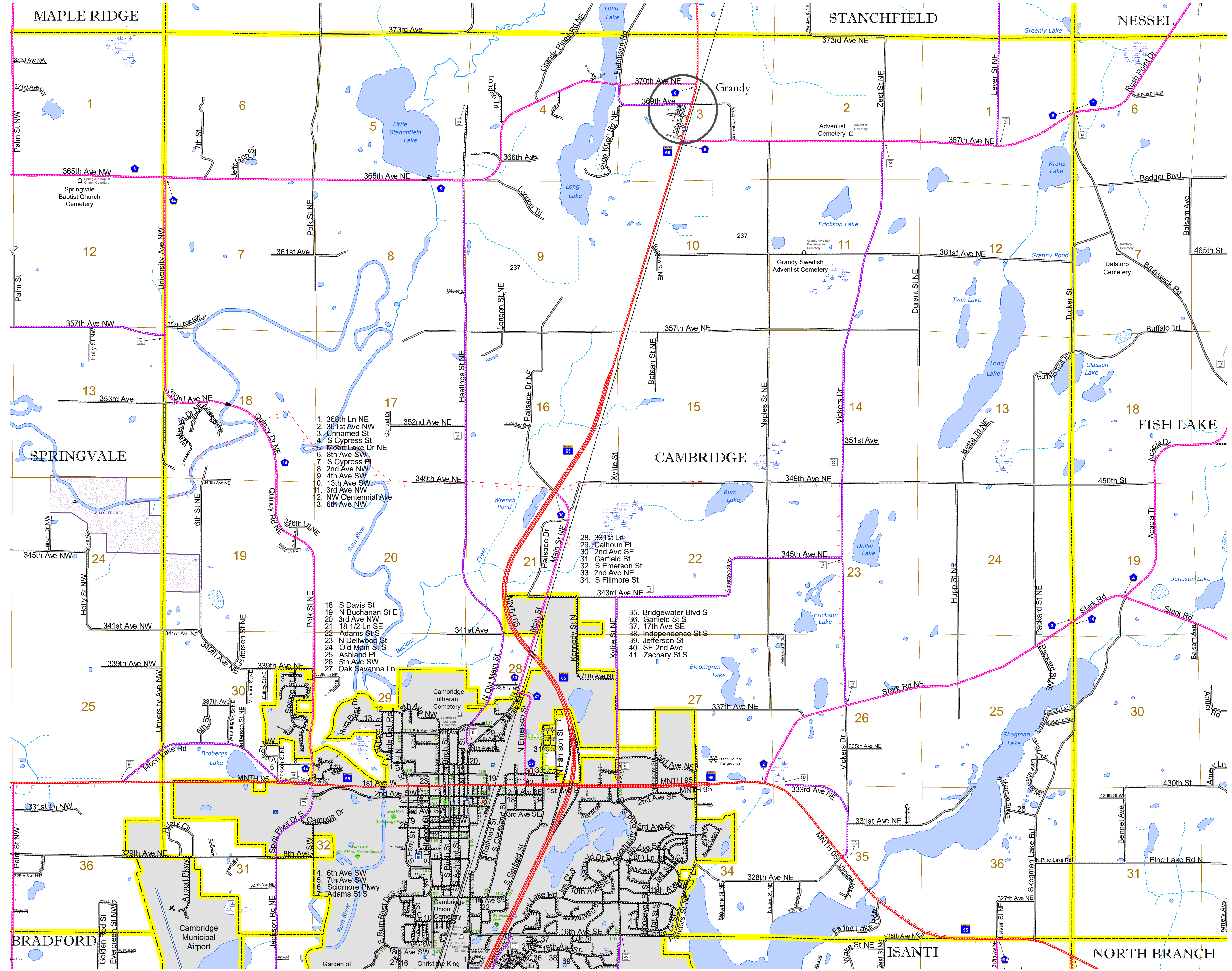

To request information from this document in an alternative format, call 651-366-4718 or 1-800-657-3774 (Greater Minnesota); 711 or 1-800-627-3529 (Minnesota Relay). You may also send an e-mail to ADARquest.dot@state.mn.us. (Please request at least one week in advance.)