

TOWNSHIP OF JO DAVIESS

PREPARED BY THE
MINNESOTA DEPARTMENT OF TRANSPORTATION
OFFICE OF TRANSPORTATION SYSTEM MANAGEMENT

IN COOPERATION WITH
U.S. DEPARTMENT OF TRANSPORTATION
FEDERAL HIGHWAY ADMINISTRATION

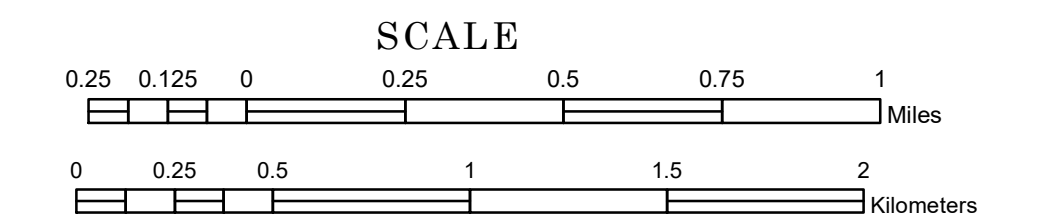

1 in = 1,600 ft

2023

Projection:
Transverse Mercator
NAD 1986
UTM Zone 15

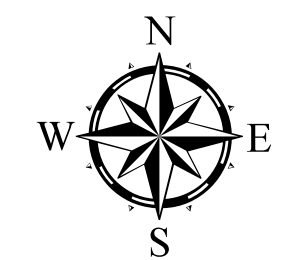

North American Datum
of 1986

ROAD AND ROADWAY FEATURES		BOUNDARY FEATURES	
INTERSTATE		TRIAL LAND	
US HIGHWAY		STATE OF MINNESOTA	
MN HIGHWAY		COUNTY	
COUNTY STATE AID HIGHWAY		MUNICIPALITY	
COUNTY ROAD		UNORGANIZED TERRITORY	
TOWNSHIP ROAD		FEDERAL ADJUSTED URBAN AREA (2014)	
UNORGANIZED TERRITORY ROAD		CIVIL TOWNSHIP	
OTHER ROADS		CONGRESSIONAL TOWNSHIP	
Municipal		SECTION	
Private		MILITARY	
National Monument		VOYAGEURS NATIONAL PARK	
State Forest		BOUNDARY WATERS CANOE AREA WILDERNESS	
Nature Service		STATE PARK	
National Wildlife		REGIONAL PARK	
State Park		NATIONAL FOREST	
Preserve		NATIONAL AND STATE FOREST	
RAILROAD AND RAILWAY FEATURES		STATE FOREST	
EMPIRE BUILDER STATION (AMTRAK)		NATIONAL TRAIL	
NORTHSTAR STATION (COMMUTER)		WILDLIFE REFUGUE AREA	
LIGHT RAIL		WILDLIFE MANAGEMENT AREA	
BLUE LINE		HYDROLOGIC FEATURES	
GREEN LINE		RIVER OR STREAM (PERMANENT)	
INFRASTRUCTURE FEATURES		LAKE, POND OR RESERVOIR	
LONG BRIDGE (200' OR GREATER SPAN)		STREAM (INTERMITTENT)	
MAJOR BRIDGE (20' TO 200' SPAN)		DRAINAGE DITCH	
MINOR BRIDGE (5' TO 20' SPAN)		WETLAND	
DAM		ISLAND OR LAND	
LOCK AND DAM		REGIONAL WATERSHED	
CITY CENTERS			
STATE CAPITAL			
COUNTY SEAT			
CITY CENTER			
UNINCORPORATED COMMUNITY			
PUBLIC SERVICE FEATURES			
MNDOT OFFICE			
MNDOT TRUCK STATION			
HIGHWAY PATROL DISTRICT OFFICE			
STATE TRAVEL INFORMATION CENTER			
REST AREA (Full Service)			
REST AREA (Vault Toilet)			
WAYSIDE (Vault or Potty Toilet)			
PARK AND RIDE LOT			
PORT OF ENTRY			
PUBLIC ACCESS POINT			
MN STATE COLLEGE AND UNIVERSITY SYSTEM (MNSCU)			
UNIVERSITY OF MN SYSTEM			
FAIRGROUNDS			
CULTURAL FEATURES			
STATE HISTORICAL MARKER			
HISTORIC DISTRICT			
HISTORIC SITE			
MONUMENT			

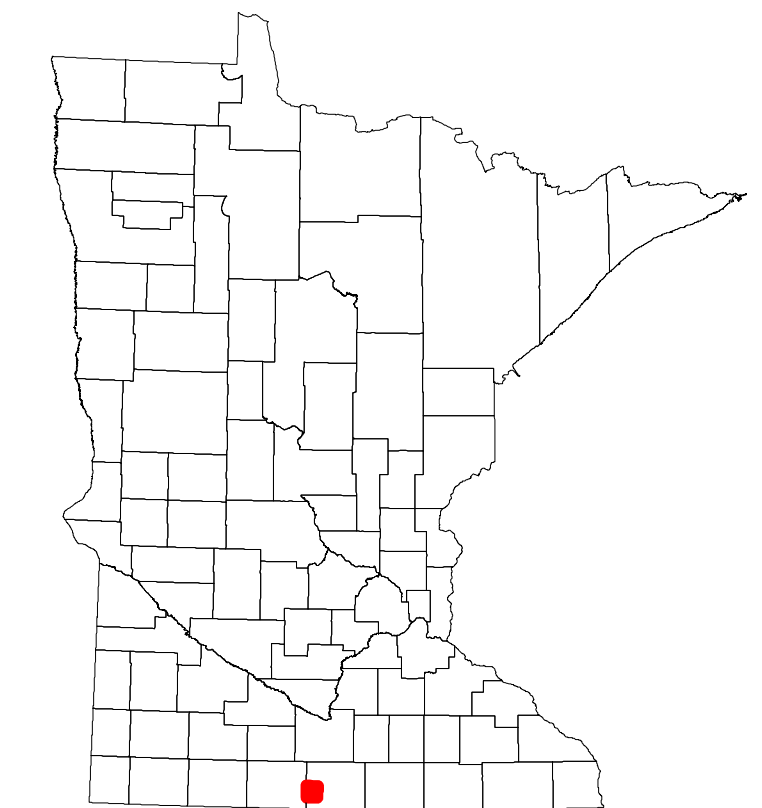

Population (U.S. Census 2010): 245

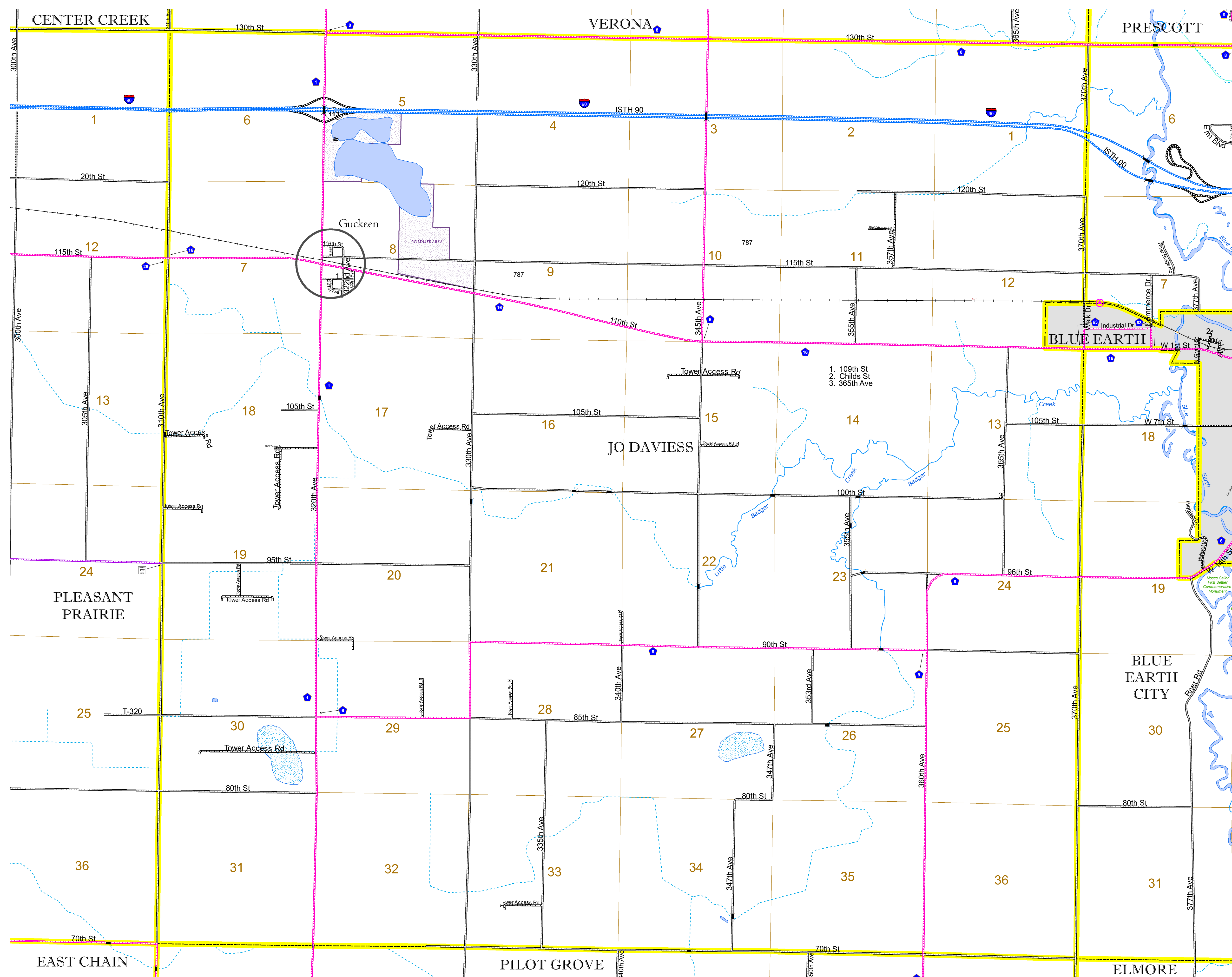

To request information from this document in an alternative format, call 651-366-4718 or 1-800-657-3774 (Greater Minnesota); 711 or 1-800-627-3529 (Minnesota Relay). You may also send an e-mail to ADarequest.dot@state.mn.us. (Please request at least one week in advance.)