

# TOWNSHIP OF SPLIT ROCK

PREPARED BY THE  
MINNESOTA DEPARTMENT OF TRANSPORTATION  
OFFICE OF TRANSPORTATION SYSTEM MANAGEMENT

IN COOPERATION WITH  
U.S. DEPARTMENT OF TRANSPORTATION  
FEDERAL HIGHWAY ADMINISTRATION

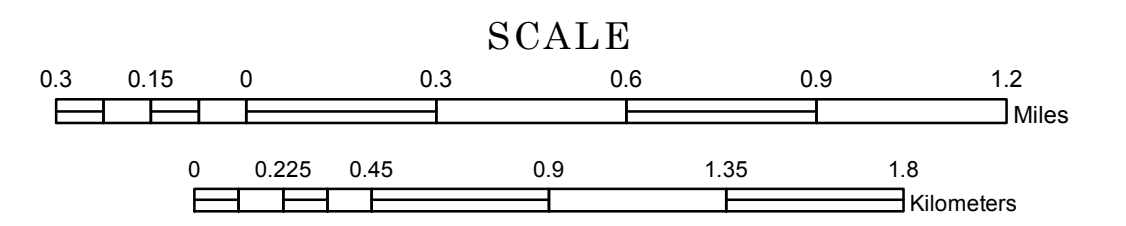

1 in = 1,600 ft

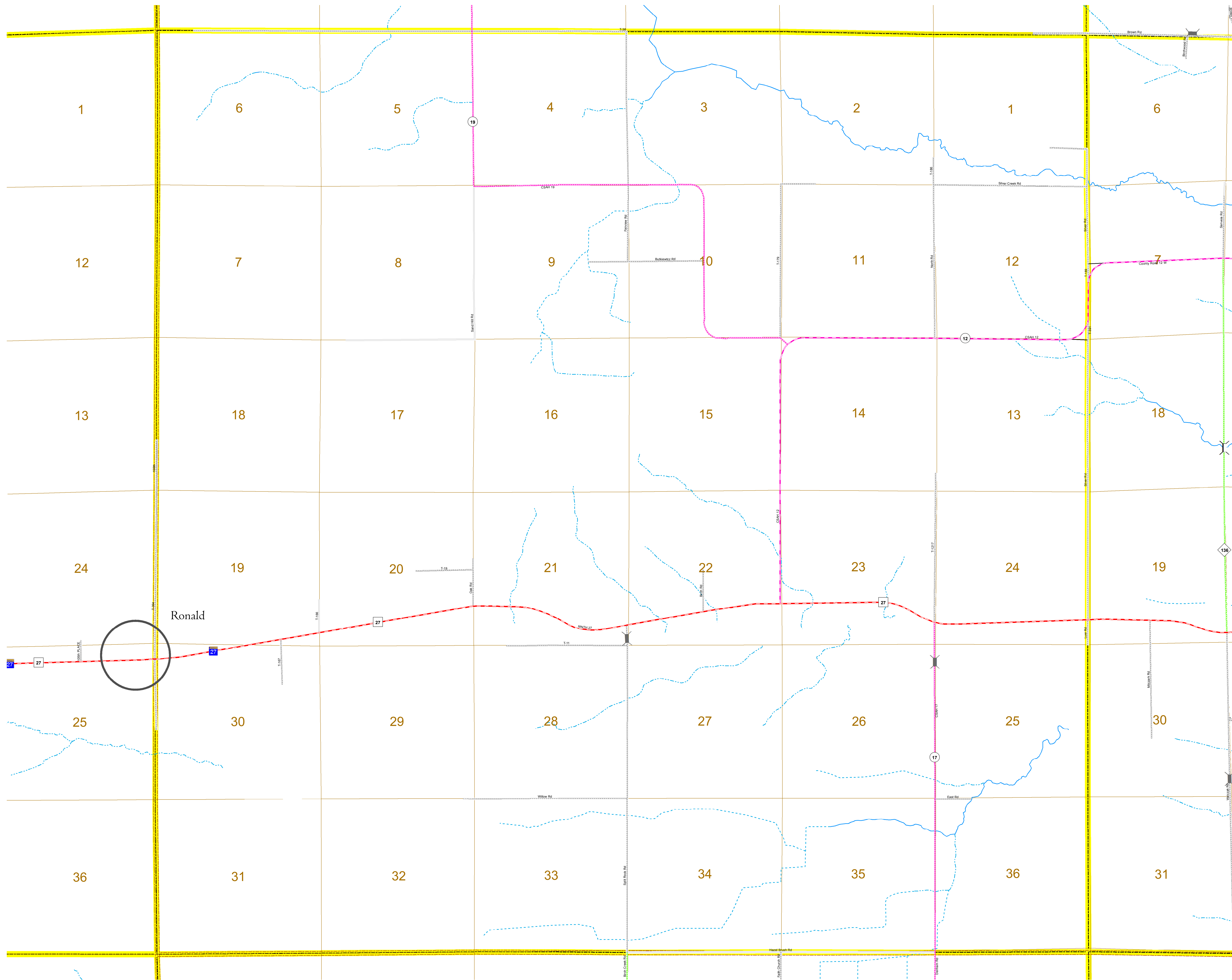

ROAD AND ROADWAY FEATURES		PUBLIC SERVICE FEATURES	
INTERSTATE		MNDOT OFFICE	
UNITED STATES HIGHWAY		MNDOT TRUCK STATION	
MINNESOTA TRUNK HIGHWAY		HIGHWAY PATROL DISTRICT OFFICE	
COUNTY STATE AID HIGHWAY		STATE TRAVEL INFORMATION CENTER	
COUNTY ROAD		REST AREA (Full Service)	
MUNICIPAL STATE AID STREET		REST AREA (Fast Lane)	
MUNICIPAL STREET		WAYSIDE (Walk or Pr. Toll)	
PRIVATE STREET/ROAD		LOCAL PARK	
TOWNSHIP ROAD		PUBLIC ACCESS POINT	
UNORGANIZED TERRITORY ROAD		FAIRGROUNDS	
INDIAN SERVICE ROAD		PORT OF ENTRY	
RAMP OR CONNECTOR		PARK AND RIDE LOT	
INTERSTATE EXIT		PUBLIC UNIVERSITY OR COLLEGE	
GREAT RIVER ROAD		TOWN HALL	
OTHER ROADS		ARMORY	
National Park		STATE HISTORICAL MARKER	
Arroyo		HISTORIC SITE	
Other Road		MONUMENT	
Concrete		TRIBAL LAND	
Gravel		COUNTY	
Dirt/Unimproved		MUNICIPALITY	
Other		ADJACENT MUNICIPALITY	
UNKNOWN		FEDERAL ADJUSTED URBAN AREA (2014)	
COMMERCIAL AIRPORT		MILITARY	
GENERAL AIRPORT		VOYAGEUR'S NATIONAL PARK	
ARSTRIP		BOUNDARY WATERS CANOE AREA WILDERNESS	
SEAPLANE		STATE PARK	
AIRPORT RUNWAY		REGIONAL PARK	
RAILROAD AND RAILWAY FEATURES		NATIONAL FOREST	
RAILWAY		NATIONAL AND STATE FOREST	
PASSENGER TRAIN STATION		STATE FOREST	
LIGHT RAIL		NATIONAL TRAIL	
LIGHT RAIL STATION		WILDLIFE REFUGUE AREA	
INFRASTRUCTURE FEATURES		WILDLIFE MANAGEMENT AREA	
LONG BRIDGE (600' or Greater Span)		RIVER OR STREAM (Perennial)	
MAJOR BRIDGE (20' to 300' Span)		LAKE, POND OR RESERVOIR	
MINOR BRIDGE (5' to 20' Span)		STREAM (Intermittent)	
DAM		DRAINAGE DITCH	
LOCK AND DAM		WETLAND	
CITY CENTERS		ISLAND OR LAND	
TRIBAL GOVERNMENT CENTER		REGIONAL WATERSHED	
CITY CENTER			
LOCALLY KNOWN PLACE			
UNINCORPORATED COMMUNITY			

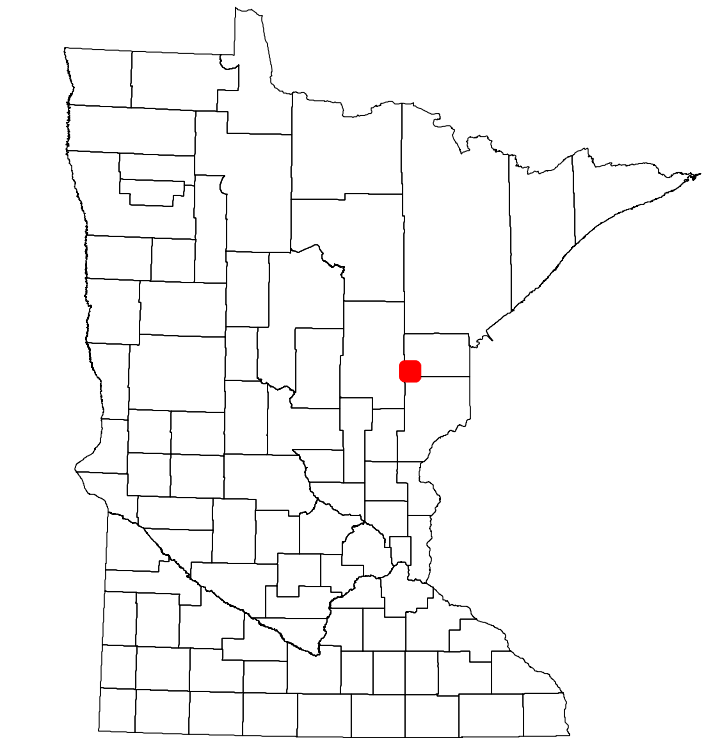

Population (U.S. Census 2010): 166

To request information from this document in an alternative format, call 651-366-4718 or 1-800-657-3774 (Greater Minnesota); 711 or 1-800-627-3529 (Minnesota Relay). You may also send an e-mail to ADAREquest.dot@state.mn.us. (Please request at least one week in advance.)