

# GENERAL HIGHWAY MAP RENVILLE COUNTY MINNESOTA

PREPARED BY THE  
MINNESOTA DEPARTMENT OF TRANSPORTATION  
OFFICE OF TRANSPORTATION SYSTEM MANAGEMENT  
IN COOPERATION WITH  
U.S. DEPARTMENT OF TRANSPORTATION  
FEDERAL HIGHWAY ADMINISTRATION

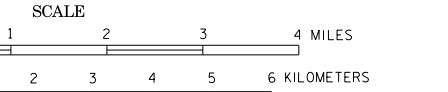

2015  
BASIC DATA - 2013

Projection  
Minnesota Coordinate System  
South Zone  
Lambert Conformal Conic

North American Datum  
of 1983



## LEGEND

ROAD AND ROADWAY FEATURES	NAVIGATION
PROJECTED ROAD	BASE LINES ON NEARLY STRAIGHT
PRIMITIVE ROAD	SHIP LINES ON INLAND LAKES
UNIMPROVED ROAD	DOCK, PIER OR LEADING
GRAVEL OR GRAVEL ROAD	UNAVAILABLE STREAM
SOIL SURFACE ROAD	LANDMARK LIGHT BEACON
GRAVEL OR STONE ROAD	LIGHTHOUSE
BITUMEN ROAD	
PAVED ROAD	
GRAVEL ROAD	
TRUCK HIGHWAY UNDER CONSTRUCTION	
ROADS IN DISCONTINUOUS CONTACT	
EXTENSION OF LOCAL ROADS NOT PAVED WITH MUNICIPALITY AND	
PRIVATE ROADS	
POINTS BETWEEN WHICH DISTANCES ARE MEASURED INDICATED THIS WAY	
GRADE SEPARATION	
FULL TRAFFIC INTERCHANGE	
PARTIAL TRAFFIC INTERCHANGES INDICATING TRAFFIC MOVEMENT	
ROAD SYSTEM DESIGNATIONS	
INTERSTATE TRUNK HIGHWAY	
U.S. NUMBERED TRUNK HIGHWAY	
STATE NUMBERED TRUNK HIGHWAY	
COUNTY STATE AID HIGHWAY	
COUNTY STATE AID BY INCORPORATING COUNTY	
TERMINATION OF DESIGNATED ROUTE	
INTERSTATE EXIT	
GREAT RIVER ROAD	
FEDERAL AID INTERSTATE SYSTEM	
NATIONAL FOREST DEVELOPMENT	
INDIAN SERVICE ROAD	
STATE PARK ROAD	
RAILROADS	
RAILROAD ANY NUMBER OF TRACKS BY A SINGLE OPERATING COMPANY OR BY TRACKS OF ANOTHER COMPANY UNDER LICENSE RIGHTS	
RAILROADS IN AUTHORITY OF TWO OR MORE TRACKS OR SEPARATELY OPERATED COMPANIES	
RAILROAD STATION	
GRADE CROSSING	
CROSSING THROUGH BELLEVILLE	
CROSSING HIGHWAY BRIDGE	
AIRWAYS	
MILITARY FIELD	
COMMERCIAL OR MUNICIPAL FIELD	
COMPLETE FACILITIES	
LIMITED FACILITIES	
LANDING AREA OR STRIP	
SEALED RAMP	
AIRWAY LIGHT BEACON - GENERAL	
RAMP LIGHT BEACON	
STRUCTURES	
General Symbols lower 20' span	
HOLLOW BRIDGE	
SMALL BRIDGES CLOSELY SPACED	
DRAMBRIDGE	
GENERAL	
DRAMBRIDGE	
ARCH	
TRUSS	
THE ABOVE FALL IS APPLICABLE	
Other Structures	
PEDERSTAL BRIDGE	
DAM WITH ROAD LARGE SCALE	
DAM WITHOUT ROAD LARGE SCALE	
DAM WITHOUT ROAD SMALL SCALE	
LEVEE OR DUNE	
LEVEE OR DUNE WITH ROAD	
WOOD STRUCTURES 10' TO 20' SPAN	
CONCRETE FORD OR SIP	
FORD - ROAD ESTABLISHED	
BOUNDARIES	
NATIONAL OR STATE	
CITY, TOWNSHIP	
CONGRESSIONAL TOWNSHIP	
CORPORATE LINE	
SECTION LINE	
CONGESTED AREA	
NATIONAL OR STATE PARK	
NATIONAL OR STATE FOREST	
INDIAN RESERVATION	
JANNEY	
WILDLIFE MANAGEMENT AREA STATES OR	
WATERING AREA FEDERAL	
WATCH LINE BETWEEN ADJOINING SHEETS OF THE SAME COUNTY	
DRAINAGE	
INTERMITTENT STREAM	
NARROW STREAM	
WIDE STREAM	
MUD OR SANDY SAND TRANSPORTATION	
DRAINAGE STATION	
WETLANDS	
LAKE OR POND	
NAVIGATION	
BASE LINES ON NEARLY STRAIGHT	
SHIP LINES ON INLAND LAKES	
DOCK, PIER OR LEADING	
UNAVAILABLE STREAM	
LANDMARK LIGHT BEACON	
LIGHTHOUSE	
CONSERVATION	
FOREST RANGER STATION	
GUARD OR BARRIER STATION	
NOT PERMANENTLY OCCUPIED	
FISH HATCHERY	
CAMP PRESERVE	
SEPARATION OF LANDS UNDER FEDERAL CONTROL	
PROMINENT ELEVATION	
MINIMUM ELEVATION	
MP - MUNICIPAL, RP - RAILSIDE, PS - PUBLIC ACCESS POINT	
RECREATION	
GOLF COURSE OR COUNTRY CLUB	
GOLF LINK	
ATHLETIC FIELD	
RECREATION PARK	
PICNIC GROUND	
PLAYGROUND, BALLFIELD, ETC.	
BATHING BEACH OR SWIMMING POOL	
SCENE SITE	
CAMP OR LODGE	
FARM AND DWELLING UNITS	
FARM UNIT	
BARNS OR OTHER THAN FARM	
BARNS OR DWELLINGS FOR STUDENTS, WORKERS, HOLIDAYERS, ETC.	
SEASONAL DWELLING	
ROOM OR GROUP OF BUILDINGS CLOSELY SPACED	
NUMBER ADJACENT TO SHEDS	
INDICATE NUMBER OF ACRES UNIT	
SET AND MARK THE SITE TO INDICATE LOCATION OF ANY CULTURAL FEATURE	
SHOWN OUT OF POSITION	
INDUSTRIAL	
FACTORY OR INDUSTRIAL PLANT	
STORAGE TANKS, OIL OR GAS	
STEEL MILL	
BEET DUMP	
STOCK FEEDLOT	
QUARTY, BREWERY OR CHEESE FACTORY	
WAREHOUSE	
COMMERCIAL	
STORE OR SMALL BUSINESS ESTABLISHMENT	
HOTEL	
TRAVEL COURT	
RESTAURANT	
BARBER	
GREENHOUSE	
PUBLIC SERVICE FACILITIES	
POST OFFICE	
FIRE STATION	
PUBLIC LIBRARY	
SCHOOL	
PAVED POINT OF ENTRY	
ROAD STATION	
BEANS, SPICERY, PLANT	
NURSING HOME	
HOSPITAL	
TOWN HALL	
CORRECTIONAL INSTITUTION	
CITY CENTERS	
STATE CAPITAL	
COUNTY SEAT	
CITY CENTER	
INCORPORATED CITY (GENERALIZED)	
UNINCORPORATED COMMUNITY	
MISCELLANEOUS MAP FEATURES	
CHAPEL, OTHER RELIGIOUS INSTITUTIONS	
CHURCH WITH GARDEN ADJACENT	
LANDSCAPE ARCHITECTURE	
MONUMENT	
GRAVEL PIT	
LANDFILL	
AUTO JUMPWAY	
SOON TO BE ABANDONED	
STATE PATROL SUBSTATION	
DEPARTMENT OF TRANSPORTATION DISTRICT OFFICE	
TOLL HOUSE, STATE POST OF ENTRY OR	
WEISS STATION	
VALVE HOUSE	
NATURAL GAS PETROLEUM PRODUCTS	
CRUDE OIL OR WATER	
CRUDE OIL OR WATER	
NATURAL GAS PETROLEUM PRODUCTS	
PIPELINE, NATURAL GAS	
PIPELINE, PETROLEUM PRODUCTS	
PIPELINE, CRUDE OIL	
TRANSMISSION LINE, OVER OR UNDER	
POWER PLANT	
TRANSFORMER STATION	
TRANSMISSION TOWER	
LONGITUDE AND LATITUDE INTERSECTION	
WETLANDS ON NATIONAL	
OPEN TO THE PUBLIC	

Outline Map of Minnesota showing location of the County within the State.

Outline Map of the County. Shows portion of grid contained on this sheet.  
Area of this County 987 Sq. Miles  
Land Area 984 Sq. Miles  
2010 Total County Population 18,710

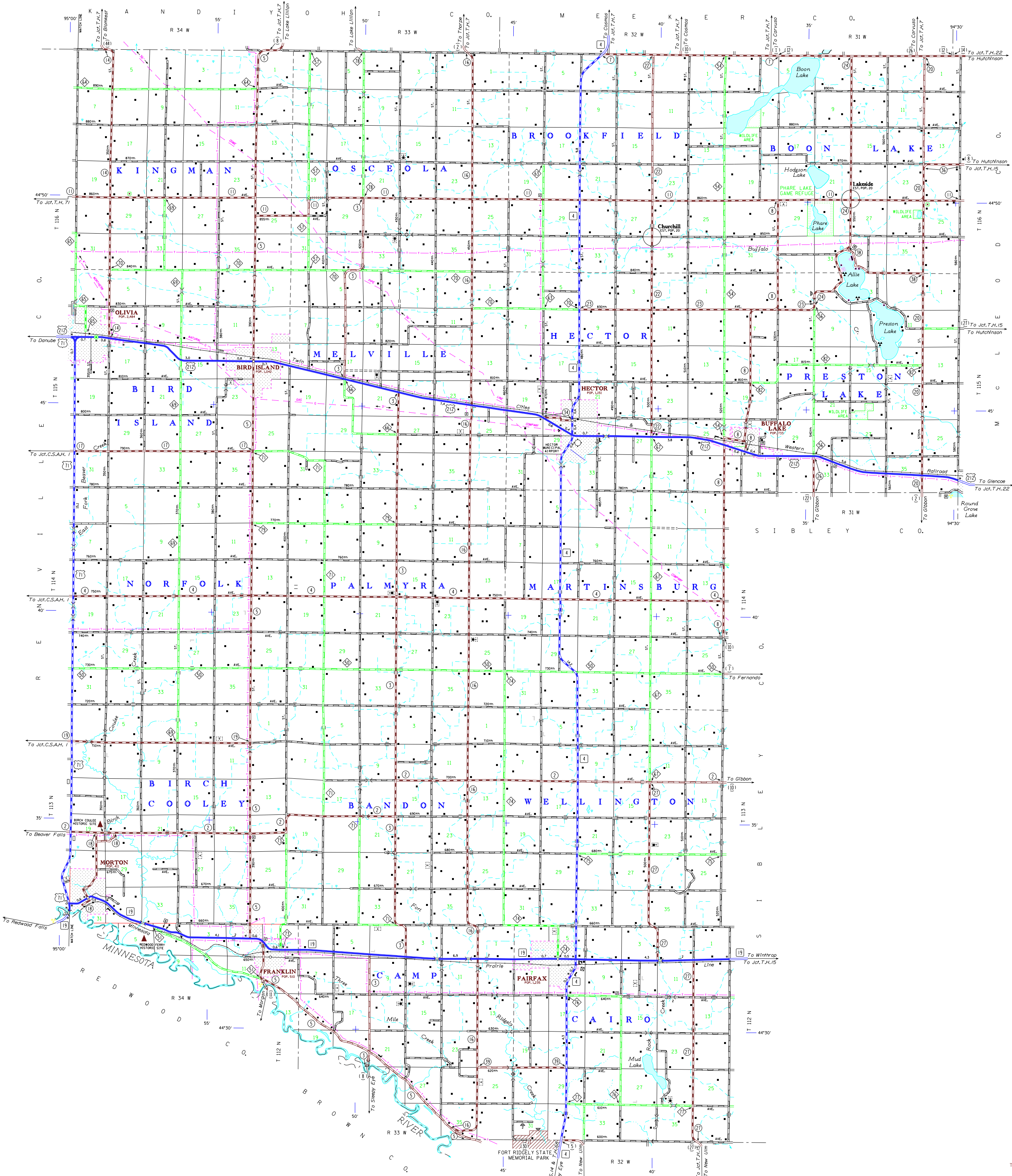
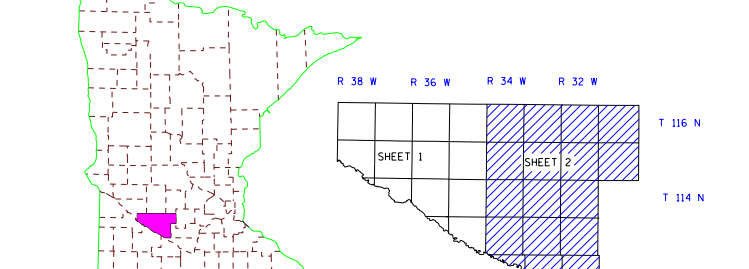

To request information from this document in an alternative format, call 651-366-4718 or 1-800-657-3774 (Greater Minnesota); TDD 1-800-657-3774 (Minnesota Relay). You may also send an e-mail to AD4request.don@state.mn.us. (Please request at least one week in advance).

NOTE: FOR DETAIL OF COUNTY STATE AID HIGHWAYS AND COUNTY ROADS IN INCORPORATED PLACES, SEE MAPS OF MUNICIPALITIES.