

Old Pelican Valley Cemetery

MUNICIPALITY OF  
PELICAN RAPIDS

PREPARED BY THE  
MINNESOTA DEPARTMENT OF TRANSPORTATION  
OFFICE OF TRANSPORTATION SYSTEM MANAGEMENT

IN COOPERATION WITH  
U.S. DEPARTMENT OF TRANSPORTATION  
FEDERAL HIGHWAY ADMINISTRATION

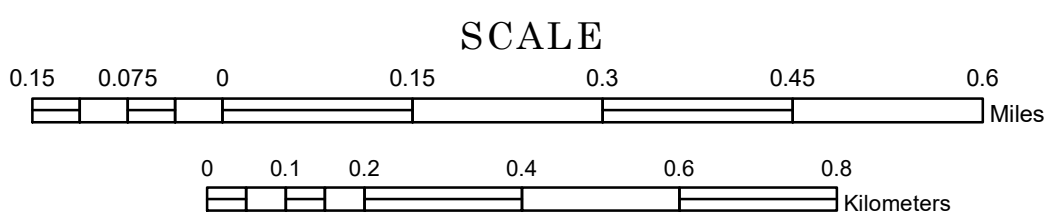

1 in = 800 ft

2024

Projection:  
Transverse Mercator  
NAD 1986  
UTM Zone 15



North American Datum  
of 1986

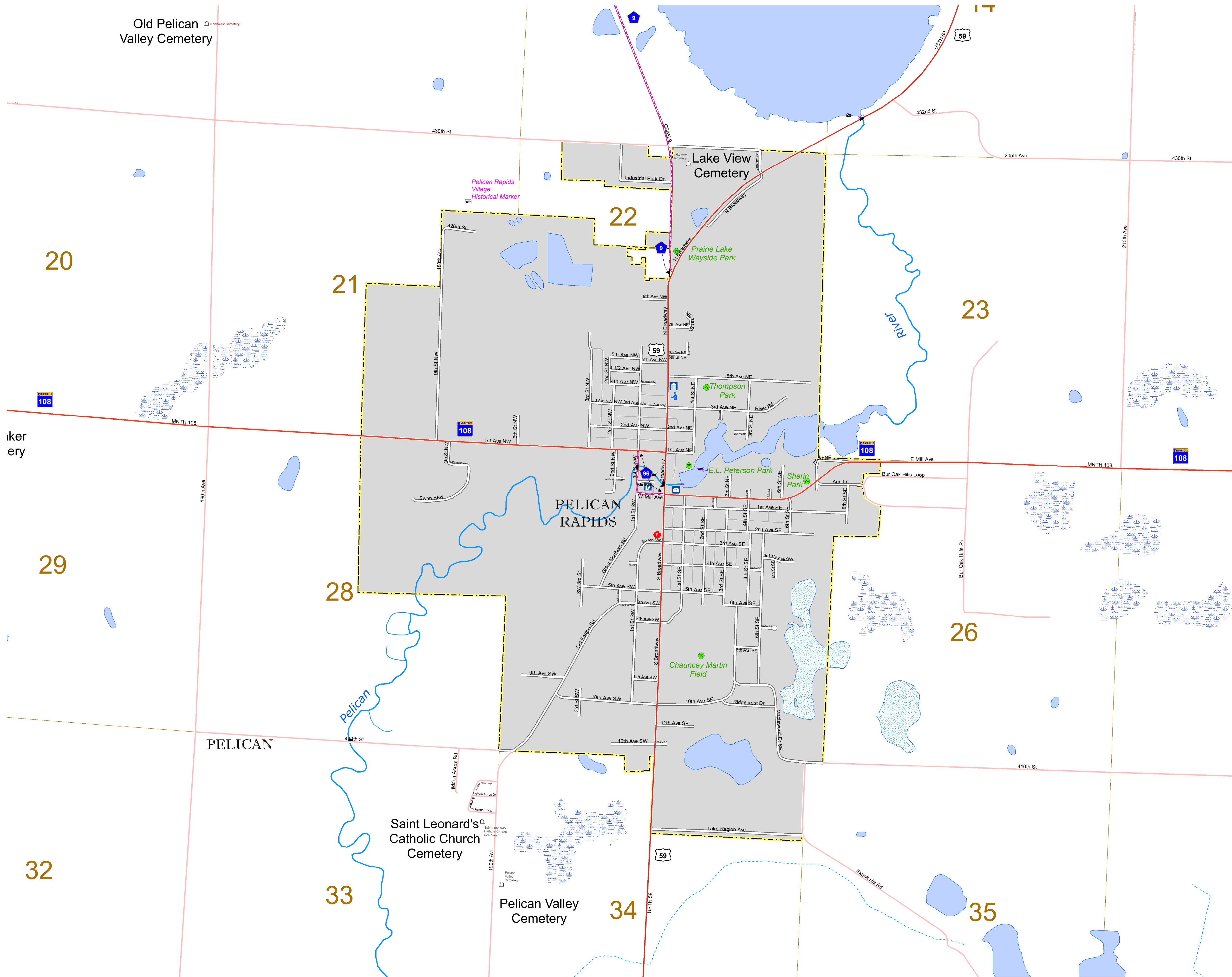

ROAD AND ROADWAY FEATURES		PUBLIC SERVICE FEATURES	
INTERSTATE		MINOT OFFICE	
US HIGHWAY		MINOT TRUCK STATION	
MIN HIGHWAY		HIGHWAY PATROL DISTRICT OFFICE	
COUNTY STATE AID HIGHWAY		STATE TRAVEL INFORMATION CENTER	
COUNTY ROAD		REST AREA (FULL SERVICE)	
MUNICIPAL STREET		REST AREA (NIGHT TRUCK STOP)	
MUNICIPAL STATE AID STREET		WAYSIDE (NIGHT OR PM TRUCK STOP)	
PRIVATE STREET/ROAD		PUBLIC ACCESS POINT	
TOWNSHIP ROAD		LOCAL PARK	
UNORGANIZED TERRITORY ROAD		FARSGROUNDS	
RAMP OR CONNECTOR		PORT OF ENTRY	
INTERSTATE EXIT		PARK AND RIDE LOT	
GREAT RIVER ROAD		PUBLIC UNIVERSITY/COLLEGE	
OTHER ROADS		PRIVATE UNIVERSITY/COLLEGE	
RAILROAD		ELEMENTARY SCHOOL	
RAILROAD BRIDGE (100' OR GREATER SPAN)		MIDDLE SCHOOL	
RAILROAD BRIDGE (UNDER 100' SPAN)		HIGH SCHOOL	
RAILROAD TUNNEL		AVIATION FEATURES	
SKYWAY		COMMERCIAL AIRPORT	
PEDESTRIAN BRIDGE		GENERAL AIRPORT	
PEDESTRIAN TUNNEL		AIRSTRIP	
LOCK AND DAM		SEAPLANE	
STATE CAPITOL		AIRPORT RUNWAY	
FEDERAL COURTHOUSE		CULTURAL FEATURES	
COUNTY COURTHOUSE		STATE HISTORICAL MARKER	
ARMORY		HISTORIC DISTRICT	
CITY HALL		HISTORIC SITE	
TOWN HALL		MONUMENT	
COMMUNITY CENTER		CEMETERY	
ARENA		BOUNDARY FEATURES	
STADIUM		TRIBAL LAND	
POST OFFICE		COUNTY	
POLICE STATION		MUNICIPALITY	
FIRE STATION		ADJACENT MUNICIPALITY	
PUBLIC LIBRARY		FEDERAL ADJUSTED URBAN AREA (2014)	
PUBLIC MUSEUM		MILITARY	
EVENT CENTER		STATE PARK	
		REGIONAL PARK	
		NATIONAL FOREST	
		NATIONAL AND STATE FOREST	
		STATE FOREST	
		NATIONAL TRAIL	
		WILDLIFE REFUGUE AREA	
		WILDLIFE MANAGEMENT AREA	
		HYDROLOGIC FEATURES	
		RIVER OR STREAM (PERMANENT)	
		LAKE, POND OR RESERVOIR	
		STREAM (INTERMITTENT)	
		DRAINAGE DITCH	
		WETLAND	
		ISLAND OR LAND	
		REGIONAL WATERSHED	

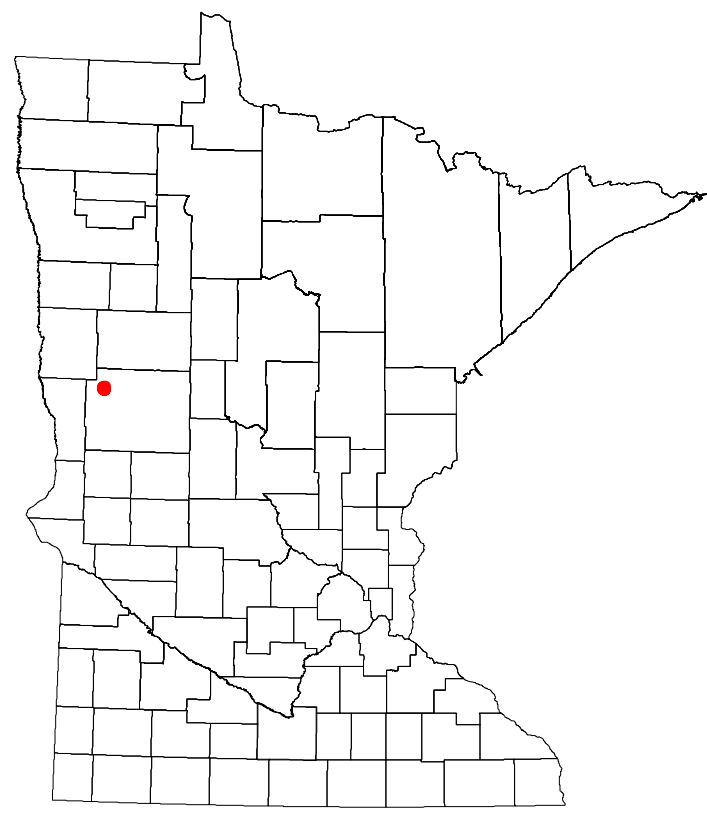

Population (U.S. Census 2020): 2577

To request information from this document in an alternative format, call 651-366-4718 or 1-800-657-3774 (Greater Minnesota); 711 or 1-800-627-3529 (Minnesota Relay). You may also send an e-mail to [ADArequest.dot@state.mn.us](mailto:ADArequest.dot@state.mn.us). (Please request at least one week in advance.)

LAST EDITED ON 11-19-2024