

MUNICIPALITY OF MAPLEVIEW

PREPARED BY THE
MINNESOTA DEPARTMENT OF TRANSPORTATION
OFFICE OF TRANSPORTATION SYSTEM MANAGEMENT

IN COOPERATION WITH
U.S. DEPARTMENT OF TRANSPORTATION
FEDERAL HIGHWAY ADMINISTRATION

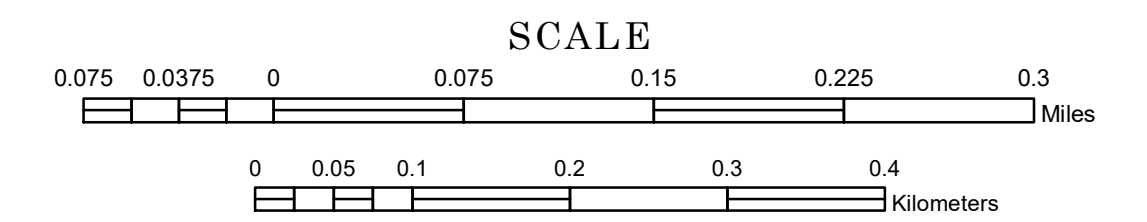

1 in = 400 ft
2024

Projection:
Transverse Mercator
NAD 1986
UTM Zone 15

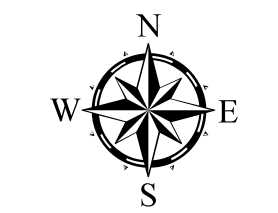

North American Datum
of 1986

ROAD AND ROADWAY FEATURES	PUBLIC SERVICE FEATURES
INTERSTATE	MINOT OFFICE
US HIGHWAY	MINOT TRUCK STATION
STATE AID HIGHWAY	HIGHWAY PATROL DISTRICT OFFICE
COUNTY ROAD	STATE TRAVEL INFORMATION CENTER
MUNICIPAL STREET	REST AREA (Full Service)
MUNICIPAL STATE AID ROAD	REST AREA (Quick Turn)
TOWNSHIP ROAD	WAYSIDE (Only on Pk Trk + V)
UNORGANIZED TERRITORY ROAD	PUBLIC ACCESS POINT
RAINF OR CONNECTOR	LOCAL PARK
INTERSTATE EXIT	FARGROUNDS
GREAT RIVER ROAD	PORT OF ENTRY
OTHER ROAD	PARK AND RIDE LOT
RAILROAD AND RAILWAY FEATURES	PUBLIC UNIVERSITY COLLEGE
EMPIRE BUILDER STATION (AMTRAK)	PRIVATE UNIVERSITY COLLEGE
NORTHWEST STATION (COMMUTER)	ELEMENTARY SCHOOL
LIGHT RAIL	MIDDLE SCHOOL
BLUE LINE STATION	HIGH SCHOOL
GREEN LINE STATION	AVIATION FEATURES
LONG BRIDGE (100' OR GREATER SPAN)	COMMERCIAL AIRPORT
MAJOR BRIDGE (20' TO 100' SPAN)	GENERAL AIRPORT
MINOR BRIDGE (2' TO 20' SPAN)	ARSTRIP
ROAD TUNNEL (100' OR GREATER SPAN)	SEAPLANE
RAILROAD BRIDGE (100' OR GREATER SPAN)	AIRPORT RUNWAY
RAILROAD BRIDGE (LESSER 100' SPAN)	CULTURAL FEATURES
SKYWAY	STATE HISTORIC MARKER
PEDESTRIAN BRIDGE	HISTORIC DISTRICT
PEDESTRIAN TUNNEL	HISTORIC SITE
DAM	MONUMENT
LOCK AND DAM	CEMETERY
PUBLIC FACILITIES	BOUNDARY FEATURES
STATE CAPITOL	TRIBAL LAND
FEDERAL COURTHOUSE	COUNTY
COUNTY COURTHOUSE	MUNICIPALITY
ARMORY	ADJACENT MUNICIPALITY
CITY HALL	FEDERAL ADJUSTED URBAN AREA (2014)
COMMUNITY CENTER	MILITARY
ARENA	STATE PARK
STADIUM	REGIONAL PARK
POST OFFICE	NATIONAL FOREST
POLICE STATION	NATIONAL AND STATE FOREST
FIRE STATION	STATE FOREST
PUBLIC LIBRARY	NATIONAL TRAIL
PUBLIC MUSEUM	WILDLIFE REFUGE AREA
EVENT CENTER	WILDLIFE MANAGEMENT AREA
CITY CENTERS	HYDROLOGIC FEATURES
TRIBAL GOVERNMENT CENTER	RIVER OR STREAM (PERENNIAL)
CITY CENTER	LAKE, POND OR RESERVOIR
LOCALLY KNOWN PLACE	STREAM (PERENNIAL)
UNINCORPORATED COMMUNITY	DRAINAGE DITCH
	WETLAND
	ISLAND OR LAND
	REGIONAL WATERSHED

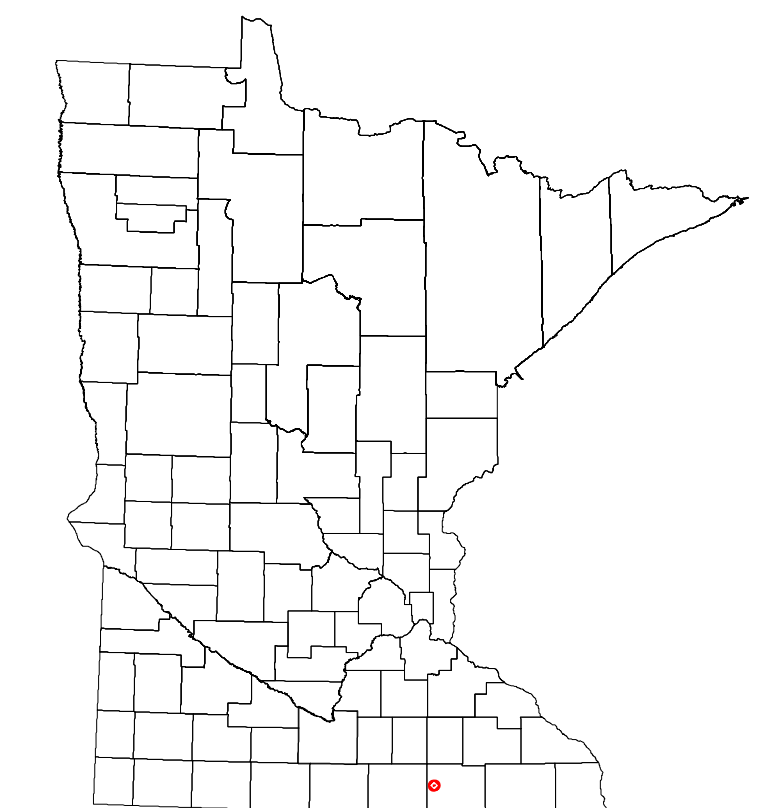

Population (U.S. Census 2020): 144

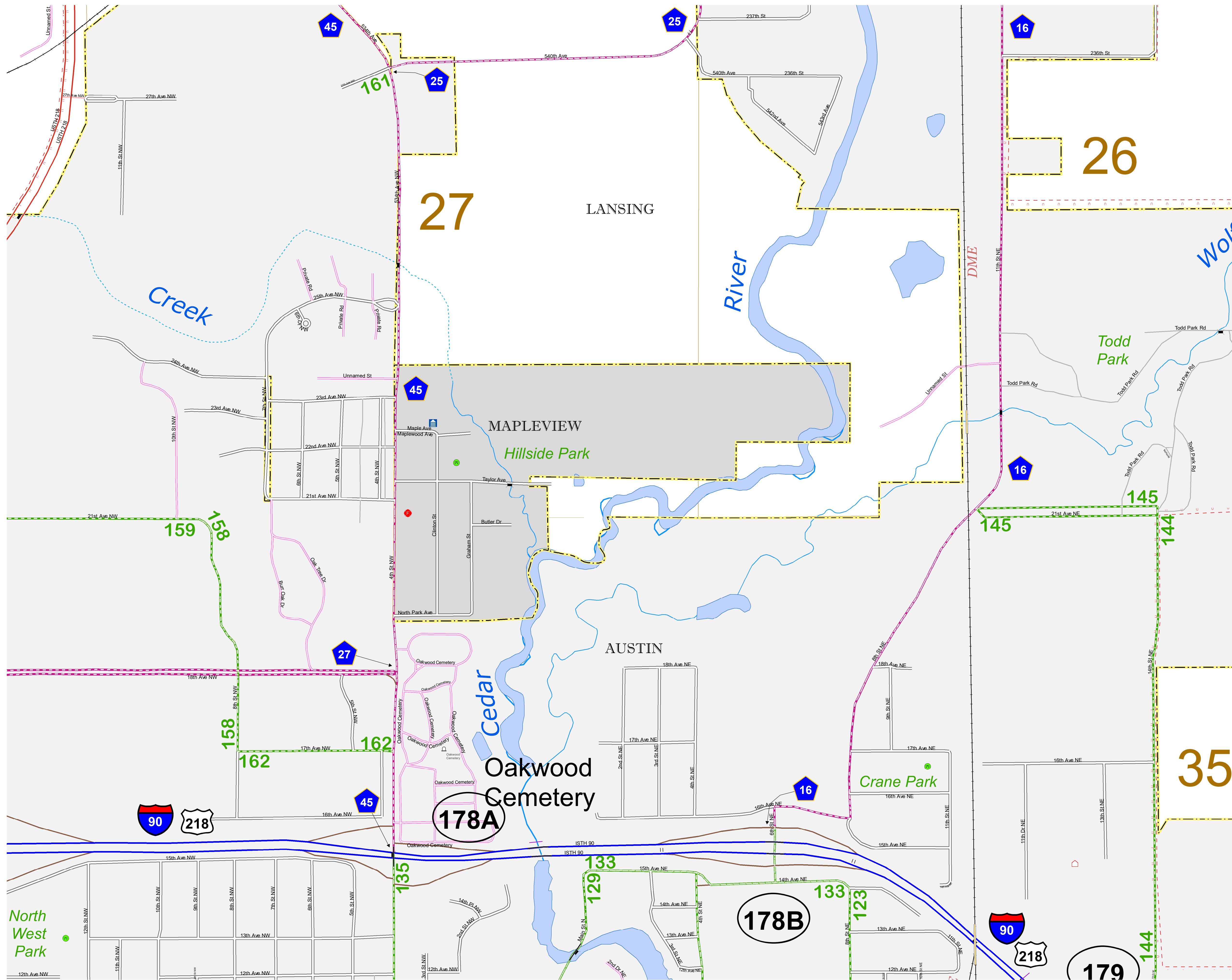

To request information from this document in an alternative format, call 651-366-4718 or 1-800-657-3774 (Greater Minnesota); 711 or 1-800-627-3529 (Minnesota Relay). You may also send an e-mail to ADarequest.dot@state.mn.us. (Please request at least one week in advance.)

LAST EDITED ON 11-19-2024