

MUNICIPALITY OF BRAHAM

PREPARED BY THE
MINNESOTA DEPARTMENT OF TRANSPORTATION
OFFICE OF TRANSPORTATION SYSTEM MANAGEMENT

IN COOPERATION WITH
U.S. DEPARTMENT OF TRANSPORTATION
FEDERAL HIGHWAY ADMINISTRATION

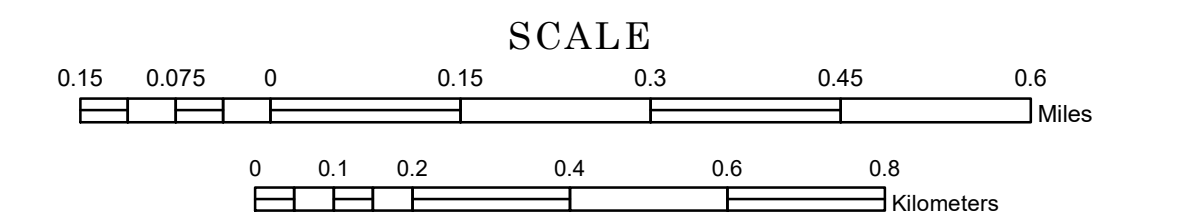

2024

Projection:
Transverse Mercator
NAD 1986
UTM Zone 15



North American Datum
of 1986

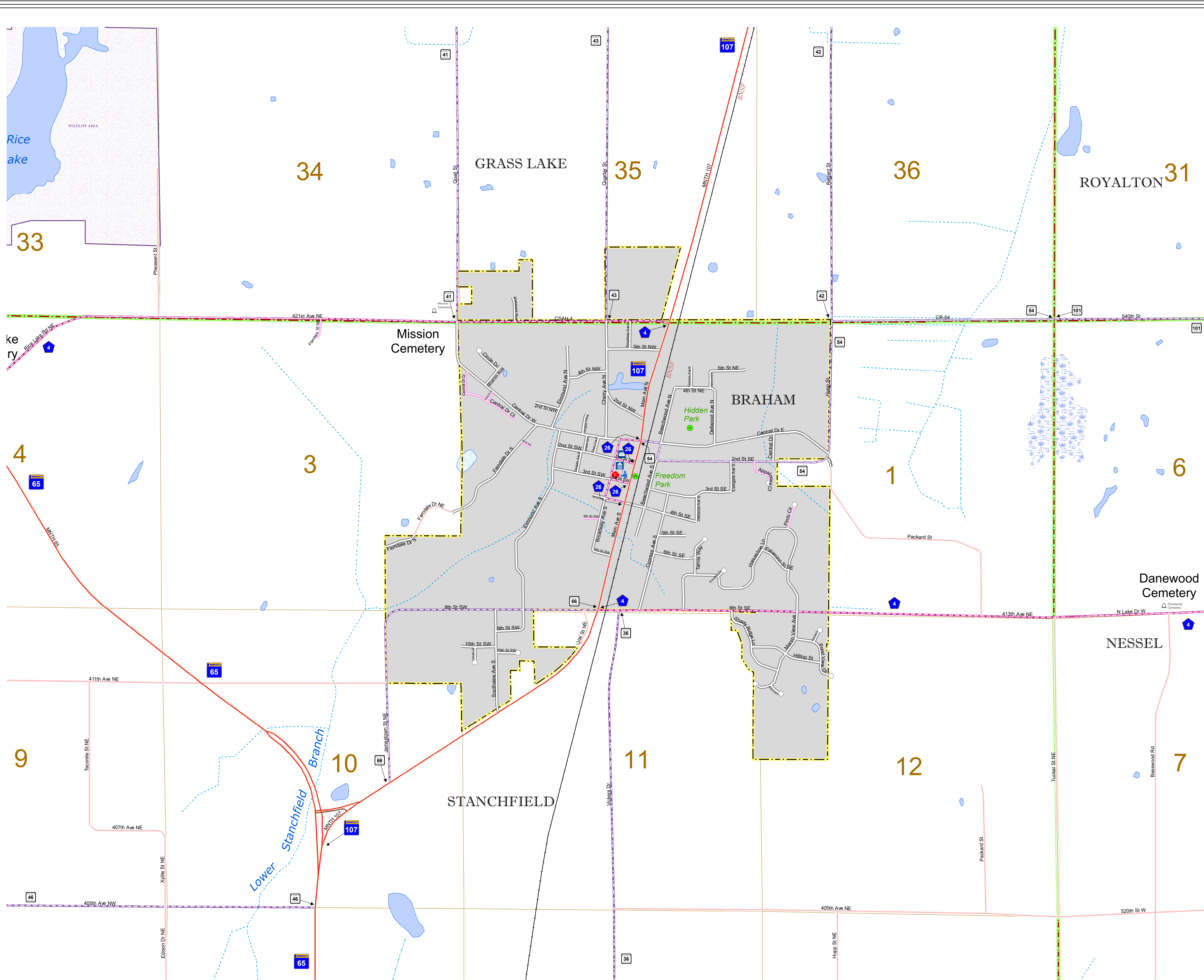

ROAD AND ROADWAY FEATURES	PUBLIC SERVICE FEATURES
INTERSTATE	MINOT TRUCK STATION
US HIGHWAY	HIGHWAY PATROL DISTRICT OFFICE
STATE AID HIGHWAY	STATE TRAVEL INFORMATION CENTER
COUNTY ROAD	REST AREA (Full Service)
MUNICIPAL STREET	REST AREA (Quick Turn)
MUNICIPAL STATE AID STREET	WAYSIDE (Only on Pkwy/Trunk)
PRIVATE STREET/ROAD	PUBLIC ACCESS POINT
TOWNSHIP ROAD	LOCAL PARK
UNORGANIZED TERRITORY ROAD	FARMS/BOUNDS
RAMP OR CONNECTOR	PORT OF ENTRY
INTERSTATE EXIT	PARK AND RIDE LOT
GREAT RIVER ROAD	PUBLIC UNIVERSITY/COLLEGE
OTHER ROADS	PRIVATE UNIVERSITY/COLLEGE
FARMROAD	ELEMENTARY SCHOOL
STATE PARK	MIDDLE SCHOOL
NATIONAL PARK	HIGH SCHOOL
NATIONAL FOREST	AVIATION FEATURES
STATE FOREST	COMMERCIAL AIRPORT
STATE GAME	GENERAL AIRPORT
	AIRSTRIP
	SEAPLANE
	AIRPORT RUNWAY
RAILROAD AND RAILWAY FEATURES	CULTURAL FEATURES
EMPIRE BUILDER STATION (AMTRAK)	STATE HISTORIC MARKER
NORTHWEST STATION (COMMUTER)	HISTORIC DISTRICT
LIGHT RAIL	HISTORIC SITE
BLUE LINE STATION	MONUMENT
GREEN LINE STATION	CEMETERY
	TRIBAL LAND
	COUNTY
	MUNICIPALITY
	ADJACENT MUNICIPALITY
	FEDERAL ADJUSTED URBAN AREA (2014)
	PUBLIC FACILITIES
	STATE CAPITOL
	FEDERAL COURTHOUSE
	COUNTY COURTHOUSE
	ARMORY
	CITY HALL
	TOWN HALL
	COMMUNITY CENTER
	ARENA
	STADIUM
	POST OFFICE
	POLICE STATION
	FIRE STATION
	PUBLIC LIBRARY
	PUBLIC MUSEUM
	EVENT CENTER
	CITY CENTERS
	TRIBAL GOVERNMENT CENTER
	CITY CENTER
	LOCALLY INCORPORATED PLACE
	UNINCORPORATED COMMUNITY
	HYDROLOGIC FEATURES
	RIVER OR STREAM (PERENNIAL)
	LAKE, POND OR RESERVOIR
	STREAM (PERENNIAL)
	WILDLIFE REFUGE AREA
	WILDLIFE MANAGEMENT AREA
	WETLAND
	ISLAND OR LAND
	REGIONAL WATERSHED

Danewood Cemetery

NESSSEL

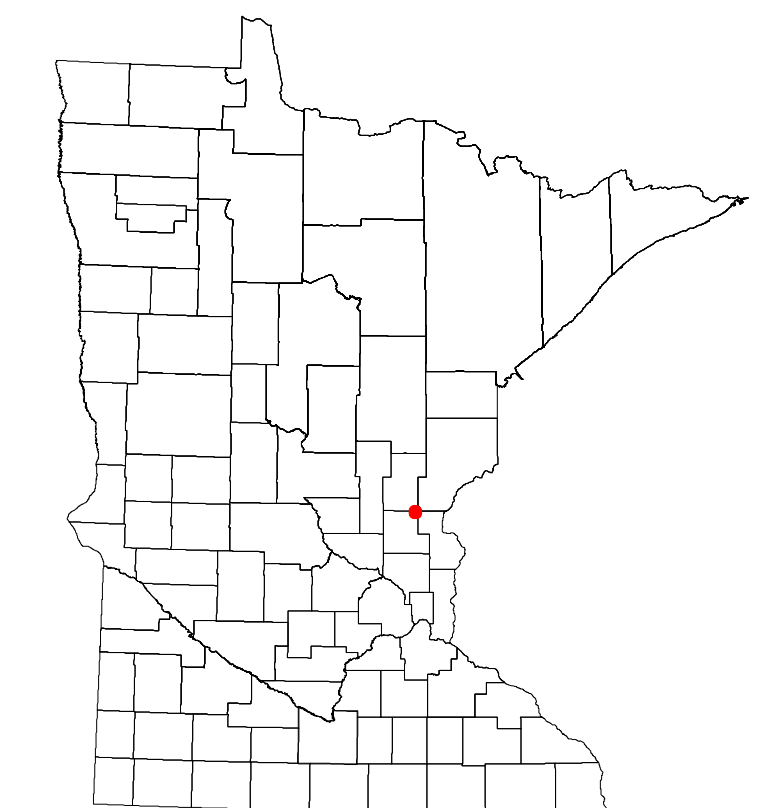

Population (U.S. Census 2020): 1769

To request information from this document in an alternative format, call 651-366-4718 or 1-800-657-3774 (Greater Minnesota); 711 or 1-800-627-3529 (Minnesota Relay). You may also send an e-mail to ADARquest.dot@state.mn.us. (Please request at least one week in advance.)

LAST EDITED ON 11-19-2024