

MUNICIPALITY OF GILMAN

PREPARED BY THE
MINNESOTA DEPARTMENT OF TRANSPORTATION
OFFICE OF TRANSPORTATION SYSTEM MANAGEMENT

IN COOPERATION WITH
U.S. DEPARTMENT OF TRANSPORTATION
FEDERAL HIGHWAY ADMINISTRATION



1 in = 400 ft
2024

Projection:
Transverse Mercator
NAD 1986
UTM Zone 15

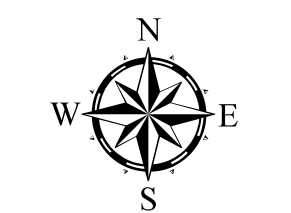

North American Datum
of 1986

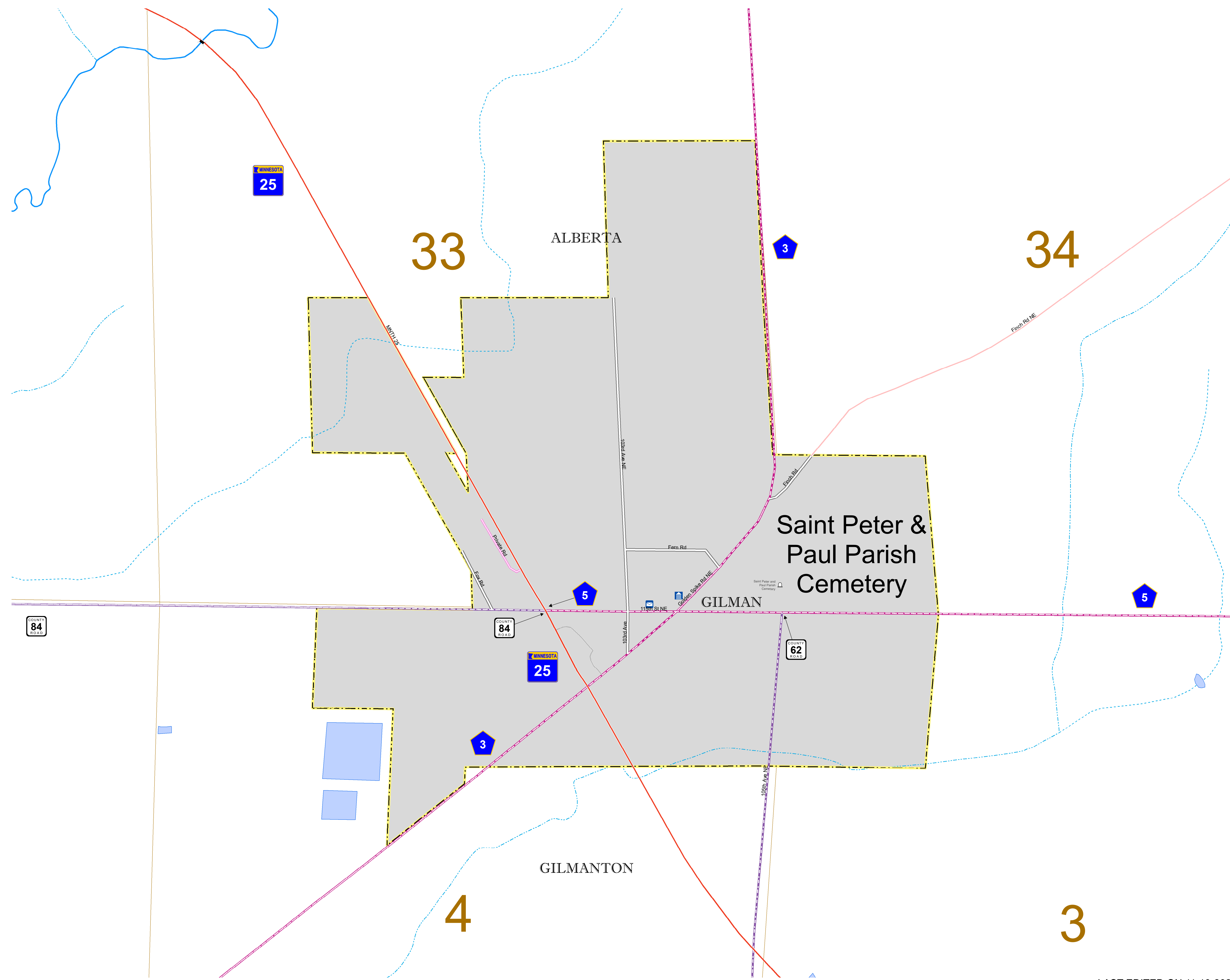

ROAD AND ROADWAY FEATURES	PUBLIC SERVICE FEATURES
INTERSTATE	MNDOT OFFICE
US HIGHWAY	MNDOT TRUCK STATION
MIN HIGHWAY	HIGHWAY PATROL DISTRICT OFFICE
COUNTY STATE AID HIGHWAY	STATE TRAVEL INFORMATION CENTER
COUNTY ROAD	REST AREA (Full Service)
MUNICIPAL STREET	REST AREA (Quick Turn)
MUNICIPAL STATE AID STREET	WAYSIDE (Only or Pick Up/Drop Off)
PRIVATE STREET/ROAD	PUBLIC ACCESS POINT
TOWNSHIP ROAD	LOCAL PARK
UNORGANIZED TERRITORY ROAD	FARMS/GRASSLANDS
RAMP OR CONNECTOR	PORT OF ENTRY
INTERSTATE EXIT	PARK AND RIDE LOT
GREAT RIVER ROAD	PUBLIC UNIVERSITY/COLLEGE
OTHER ROADS	PRIVATE UNIVERSITY/COLLEGE
Farm Road	Elementary School
State Park	Model School
National Park	High School
Monument	
State Forest	
National Forest	
National Wildlife	
State Game	
RAILROAD AND RAILWAY FEATURES	AVIATION FEATURES
RAILROAD	COMMERCIAL AIRPORT
EMPIRE BUILDER STATION (Amtrak)	GENERAL AIRPORT
NORTHSTAR STATION (Commuter)	AIRSTRIP
LIGHT RAIL	SEAPLANE
BLUE LINE STATION	AIRPORT RUNWAY
GREEN LINE STATION	
INFRASTRUCTURE FEATURES	CULTURAL FEATURES
LONG BRIDGE (100' or Greater Span)	STATE HISTORIC MARKER
MAJOR BRIDGE (20' to 100' Span)	HISTORIC DISTRICT
MINOR BRIDGE (0' to 20' Span)	HISTORIC SITE
ROAD TUNNEL (100' or Greater Span)	MONUMENT
RAILROAD BRIDGE (100' or Greater Span)	CEMETERY
RAILROAD BRIDGE (Lesser 100' Span)	
SKYWAY	BOUNDARY FEATURES
PEDESTRIAN BRIDGE	TRIBAL LAND
PEDESTRIAN TUNNEL	COUNTY
LOCK AND DAM	MUNICIPALITY
PUBLIC FACILITIES	ADJACENT MUNICIPALITY
STATE CAPITOL	FEDERAL ADJUSTED URBAN AREA (2014)
FEDERAL COURTHOUSE	MILITARY
COUNTY COURTHOUSE	STATE PARK
ARMORY	REGIONAL PARK
CITY HALL	NATIONAL FOREST
TOWN HALL	NATIONAL AND STATE FOREST
COMMUNITY CENTER	STATE FOREST
ARENA	NATIONAL TRAIL
STADIUM	WILDLIFE REFUGE AREA
POST OFFICE	WILDLIFE MANAGEMENT AREA
POLICE STATION	
FIRE STATION	HYDROLOGIC FEATURES
PUBLIC LIBRARY	RIVER OR STREAM (Perennial)
PUBLIC MUSEUM	LAKE, POND OR RESERVOIR
EVENT CENTER	STREAM (Intermittent)
CITY CENTERS	DRAINAGE DITCH
TRIBAL GOVERNMENT CENTER	WETLAND
CITY CENTER	ISLAND OR LAND
LOCALLY KNOWN PLACE	REGIONAL WATERSHED
UNINCORPORATED COMMUNITY	

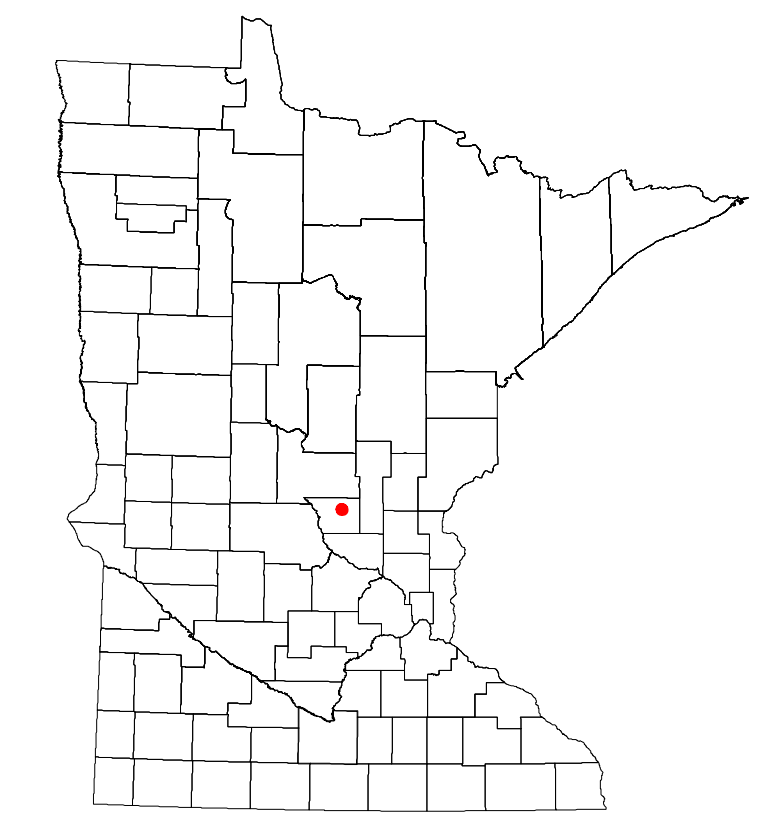

To request information from this document in an alternative format, call 651-366-4718 or 1-800-657-3774 (Greater Minnesota); 711 or 1-800-627-3529 (Minnesota Relay). You may also send an e-mail to ADarequest.dot@state.mn.us. (Please request at least one week in advance.)

LAST EDITED ON 11-19-2024

Population (U.S. Census 2020): 226