

MUNICIPALITY OF ROCHESTER

PREPARED BY THE
MINNESOTA DEPARTMENT OF TRANSPORTATION
 OFFICE OF TRANSPORTATION SYSTEM MANAGEMENT
 IN COOPERATION WITH
U.S. DEPARTMENT OF TRANSPORTATION
 FEDERAL HIGHWAY ADMINISTRATION

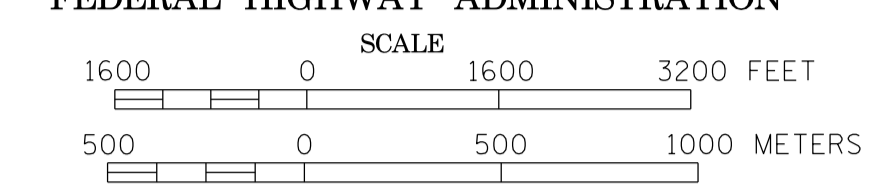

2015
 BASIC DATA - 2014

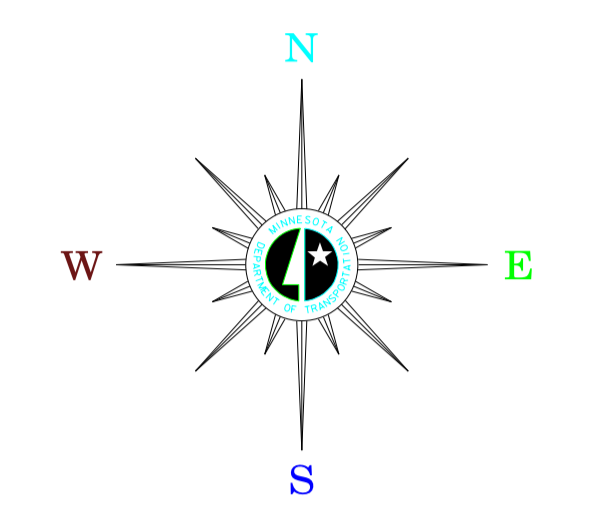

LEGEND

- INTERSTATE TRUNK HIGHWAY..... 35
- U.S. TRUNK HIGHWAY..... 105
- STATE TRUNK HIGHWAY..... 55
- COUNTY STATE AID HIGHWAY..... 21
- COUNTY ROAD..... 45
- CORPORATE LIMITS.....
- PUBLIC ROAD.....
- PRIVATE ROAD.....

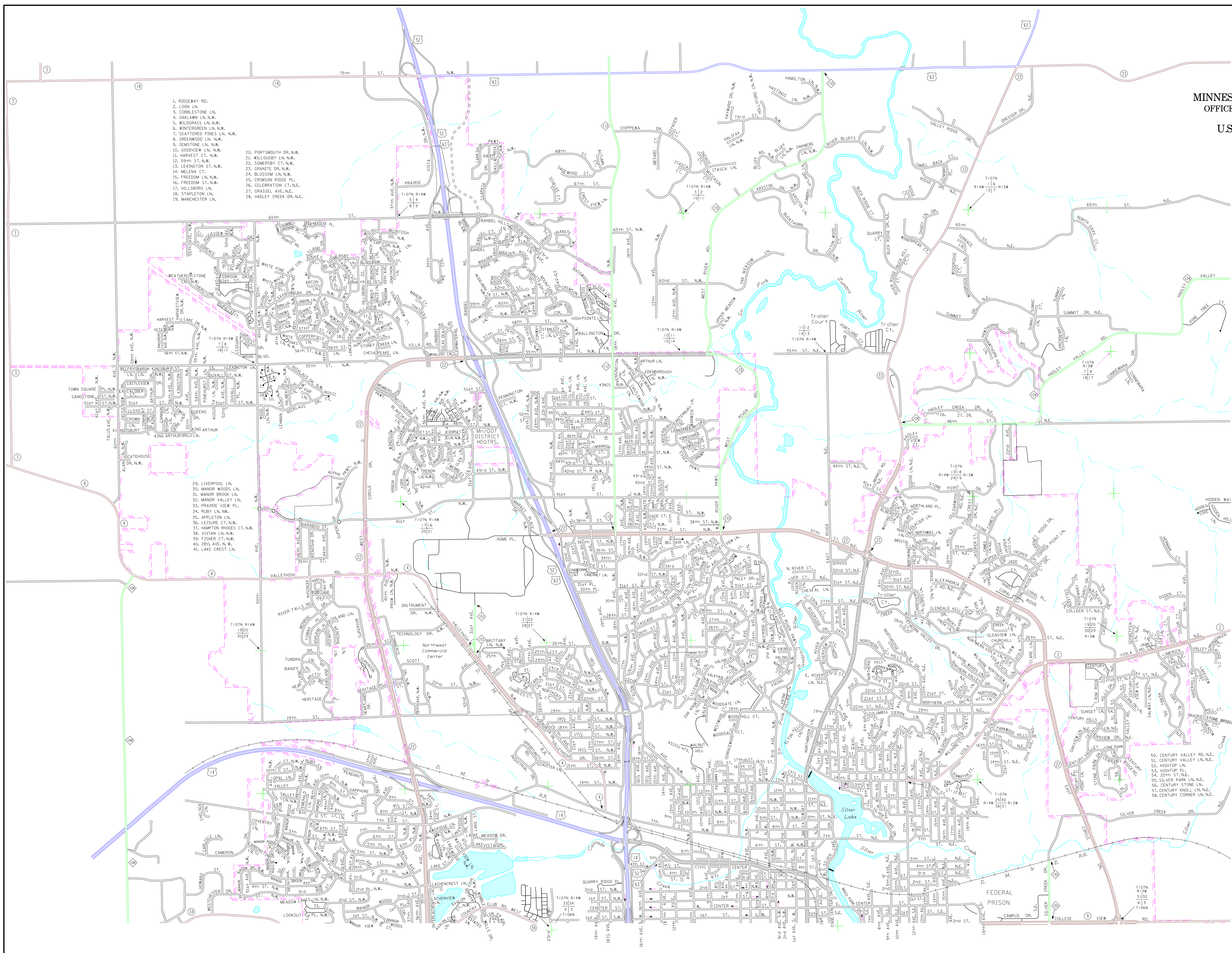

1. RIDGEWAY RD.
2. LOON LN.
3. COBBLESTONE LN.
4. DAKLAWN LN. N.W.
5. WILDGRASS LN. N.W.
6. WINTERGREEN LN. N.W.
7. SCATTERED PINES LN. N.W.
8. GREENWOOD LN. N.W.
9. GEMSTONE LN. N.W.
10. GOODVIEW LN. N.W.
11. HARVEST CT. N.W.
12. 59th ST. N.W.
13. LEXINGTON ST. N.W.
14. MELBA CT.
15. FREEDOM LN. N.W.
16. FREEDOM ST. N.W.
17. HILLSBROOK LN.
18. STAPLETON LN.
19. MANCHESTER LN.
20. PORTSMOUTH DR. N.W.
21. WILLOUGHBY LN. N.W.
22. SOMERSET CT. N.W.
23. GRANITE DR. N.W.
24. BLOSSOM LN. N.W.
25. CRIMSON RIDGE PL.
26. CELEBRATION CT. N.E.
27. CRASSEL AVE. N.E.
28. HADLEY CREEK DR. N.E.

29. LIVERPOOL LN.
30. MANOR WOODS LN.
31. MANOR BROOK LN.
32. MANOR VALLEY LN.
33. PRAIRIE VIEW PL.
34. RUBY LN. N.W.
35. APPLETON LN.
36. LEISURE CT. N.W.
37. HAMPTON RHODES CT. N.W.
38. VIVIAN LN. N.W.
39. FISHER CT. N.W.
40. 28th AVE. N.W.
41. LAKE CREST LN.

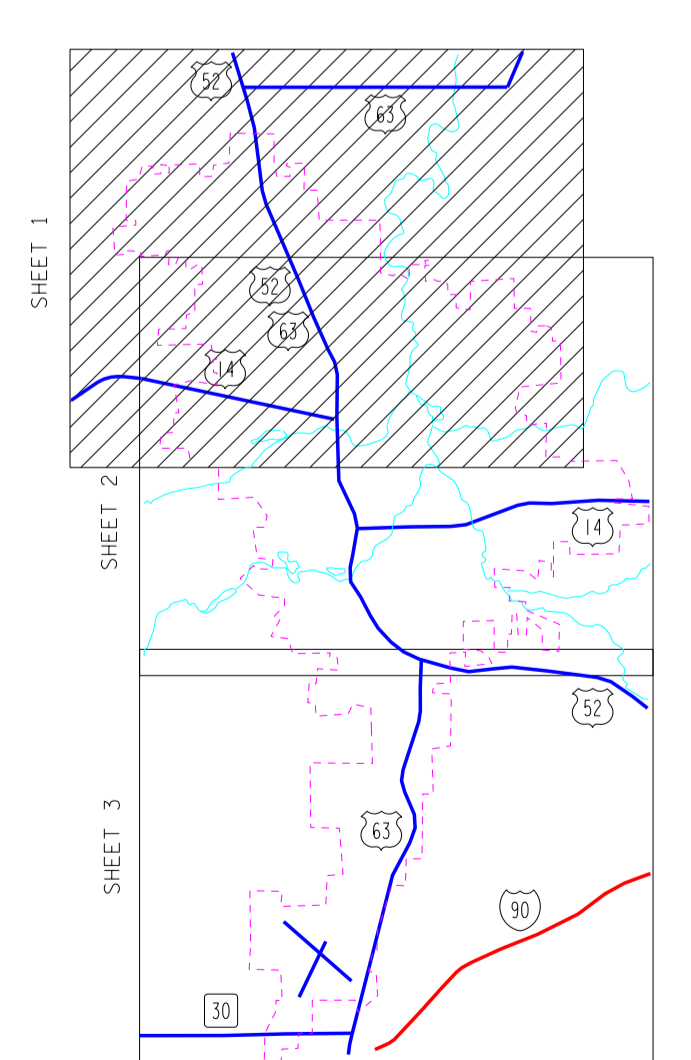

To request information from this document in an alternative format, call 651-366-4718 or 1-800-657-3774 (Greater Minnesota), 711 or 1-800-627-3529 (Minnesota Relay). You may also send an e-mail to ADArequest@dot.state.mn.us. (Please request at least one week in advance).