

MUNICIPALITY OF ALBERTVILLE

PREPARED BY THE
 MINNESOTA DEPARTMENT OF TRANSPORTATION
 OFFICE OF TRANSPORTATION SYSTEM MANAGEMENT
 IN COOPERATION WITH
 U.S. DEPARTMENT OF TRANSPORTATION
 FEDERAL HIGHWAY ADMINISTRATION

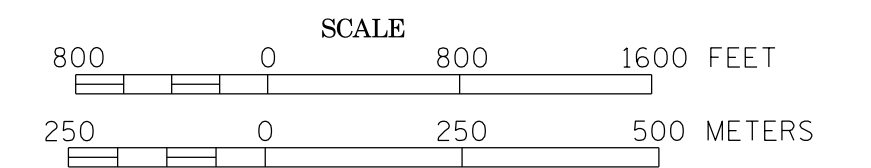

2015
 BASIC DATA - 2010

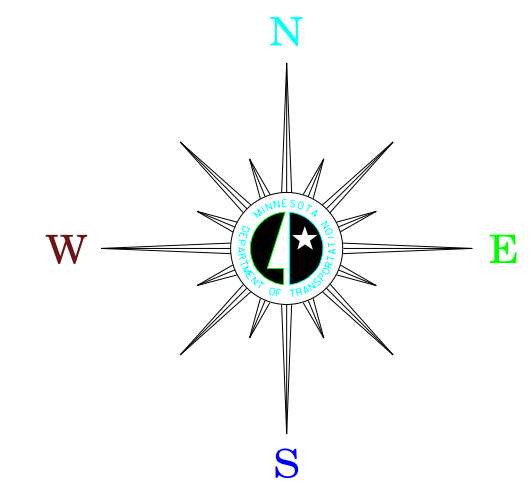

LEGEND

- INTERSTATE TRUNK HIGHWAY..... (I-94)
- U.S. TRUNK HIGHWAY..... (US-52)
- STATE TRUNK HIGHWAY..... (ST-37)
- COUNTY STATE AID HIGHWAY..... (CSA-18)
- COUNTY ROAD..... (CR-106, 108, 112, 113, 114, 115, 116, 117, 118, 119, 120, 121, 122, 123, 124)
- CORPORATE LIMITS.....
- PUBLIC ROAD.....
- PRIVATE ROAD.....

MUNICIPAL STATE AID STREET SYSTEM

LEGEND

- MUNICIPAL COUNTY STATE AID STREET.....
- MUNICIPAL STATE AID STREET.....
- COUNTY STATE AID HIGHWAY.....
- COUNTY ROAD.....
- TRUNK HIGHWAY.....

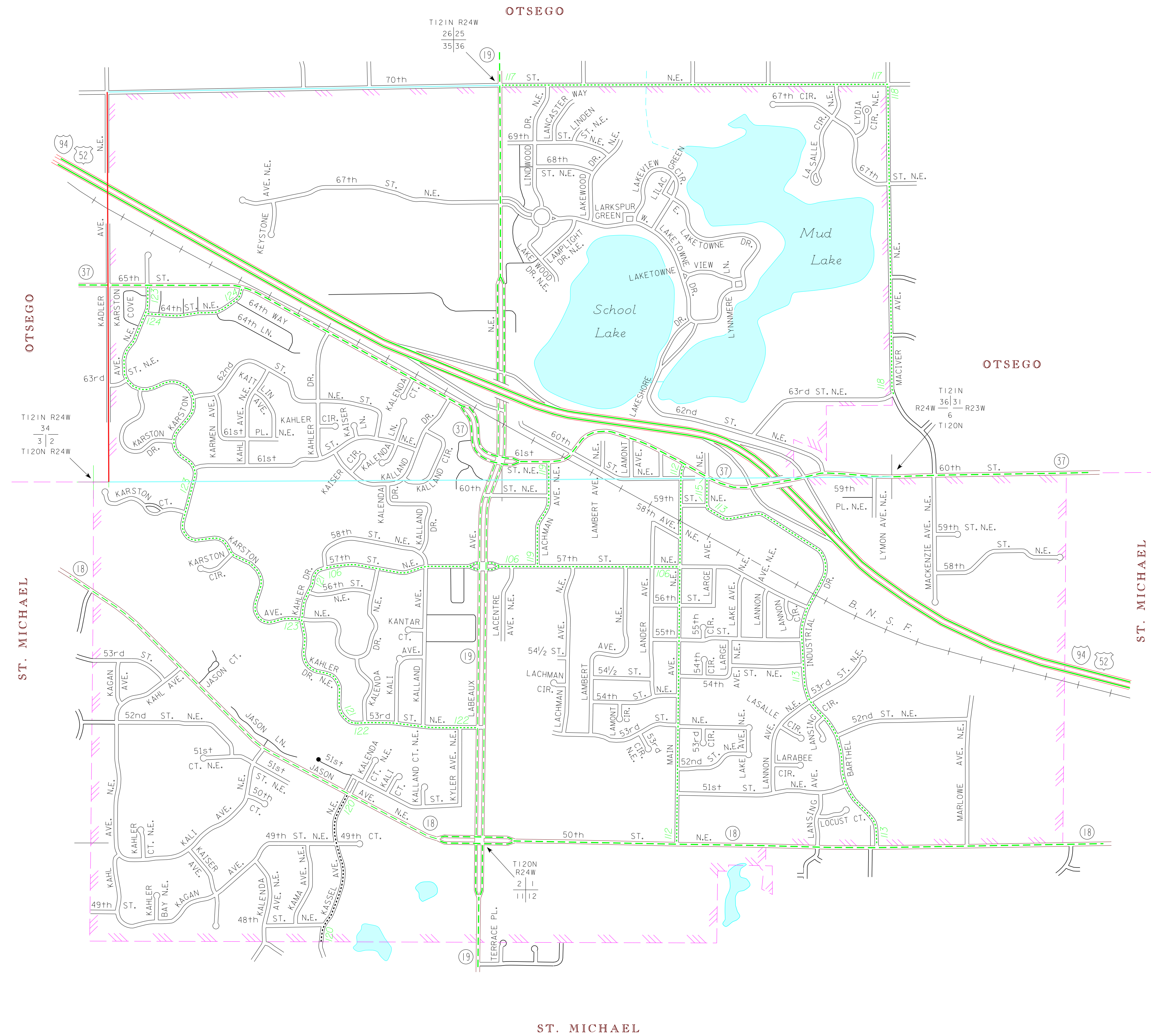

To request information from this document in an alternative format, call 651-366-4718 or 1-800-657-3774 (Greater Minnesota); 711 or 1-800-627-3529 (Minnesota Relay). You may also send an e-mail to ADRequest.dot@state.mn.us. (Please request at least one week in advance).