

MUNICIPALITY OF SAINT PAUL

PREPARED BY THE
MINNESOTA DEPARTMENT OF TRANSPORTATION
 OFFICE OF TRANSPORTATION SYSTEM MANAGEMENT
 IN COOPERATION WITH
U.S. DEPARTMENT OF TRANSPORTATION
 FEDERAL HIGHWAY ADMINISTRATION

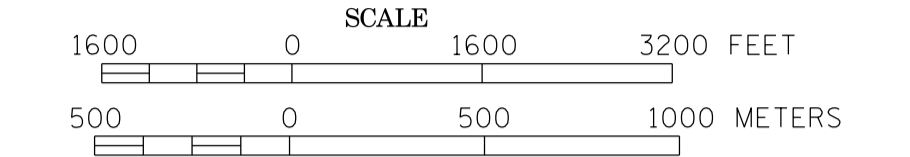

2014
 BASIC DATA - 2013

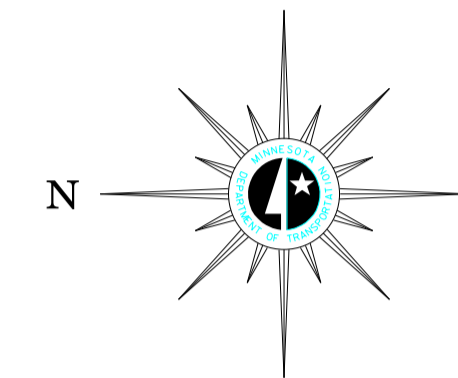

LEGEND

- INTERSTATE TRUNK HIGHWAY..... (35)
- U.S. TRUNK HIGHWAY..... (10)
- STATE TRUNK HIGHWAY..... (55)
- COUNTY STATE AID HIGHWAY..... (23)
- COUNTY ROAD..... (15)
- CORPORATE LIMITS.....
- PUBLIC ROAD.....
- PRIVATE ROAD.....
- BUS ROUTE ONLY.....

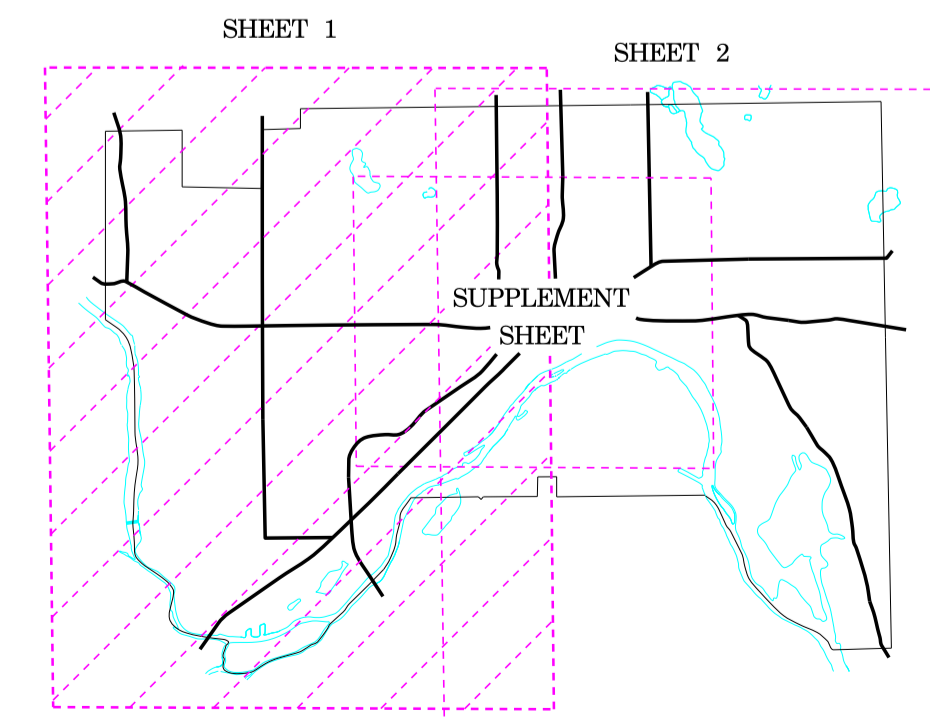
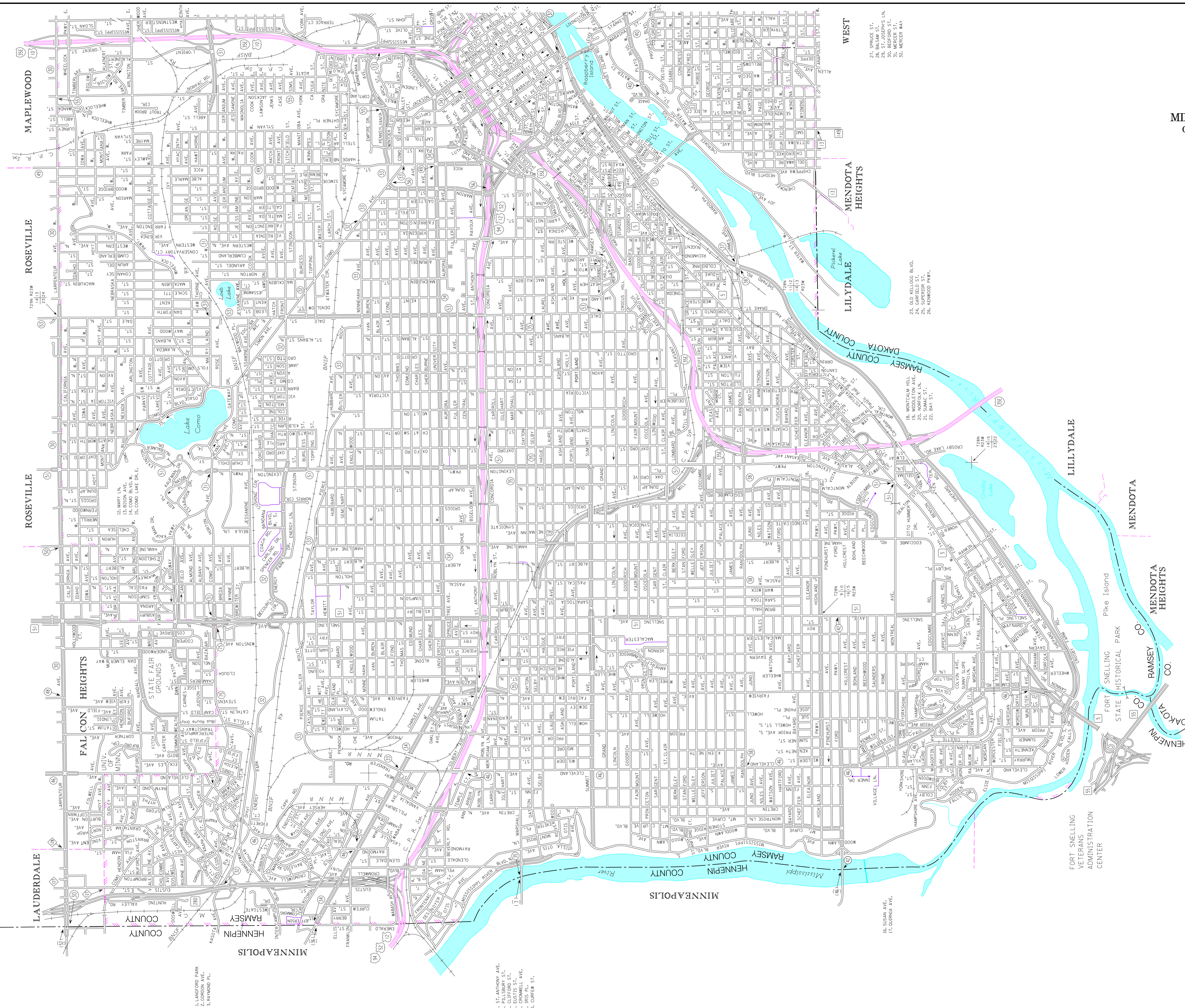

- 4. ST. ANTHONY AVE.
- 5. ST. ANTHONY AVE.
- 6. CLIFFORD ST.
- 7. DUSTY ST.
- 8. BIRCH AVE.
- 9. BIRCH AVE.
- 10. CURBER ST.

- 1. LANGFORD PARK
- 2. GORDON AVE.
- 3. RAYMOND PL.

- 16. SUSAN AVE.
- 17. GURPINA AVE.

- 23. OLD FELLOWS BLVD.
- 24. GARFIELD ST.
- 25. SHAMAK ST.
- 26. KENNEDY PKY.

FORT SNELLING
 VETERANS
 ADMINISTRATION
 CENTER

FORT SNELLING
 STATE HISTORICAL PARK

Pike Island

LILLYDALE

MENDOTA HEIGHTS

WEST

To request information from this document in an alternative format, call 651-366-4718 or 1-800-657-3774 (Greater Minnesota); 711 or 1-800-627-8229 (Minnesota Relay). You may also send an e-mail to ADRequest.do@state.mn.us. (Please request at least one week in advance.)