

# MUNICIPALITY OF ROCHESTER

PREPARED BY THE  
**MINNESOTA DEPARTMENT OF TRANSPORTATION**  
 OFFICE OF TRANSPORTATION SYSTEM MANAGEMENT  
 IN COOPERATION WITH  
**U.S. DEPARTMENT OF TRANSPORTATION**  
 FEDERAL HIGHWAY ADMINISTRATION

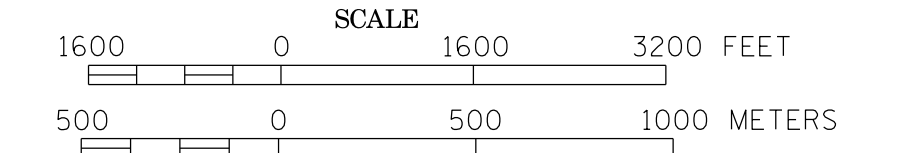

**2014**  
 BASIC DATA - 2013

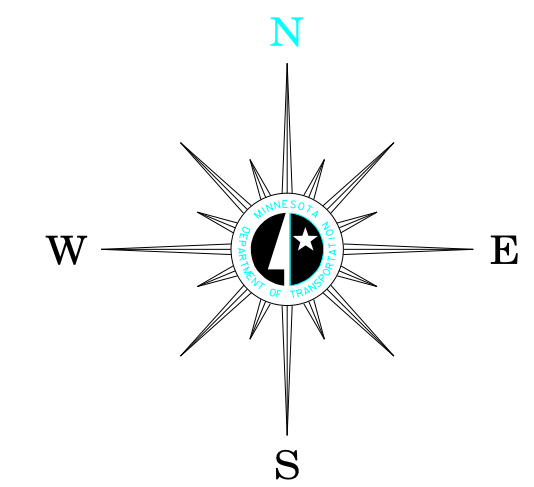

## LEGEND

- INTERSTATE TRUNK HIGHWAY..... (I-95)
- U.S. TRUNK HIGHWAY..... (16)
- STATE TRUNK HIGHWAY..... (55)
- COUNTY STATE AID HIGHWAY..... (23)
- CORPORATE LIMITS..... (Dashed line)
- PUBLIC ROAD..... (Solid line)
- PRIVATE ROAD..... (Dotted line)

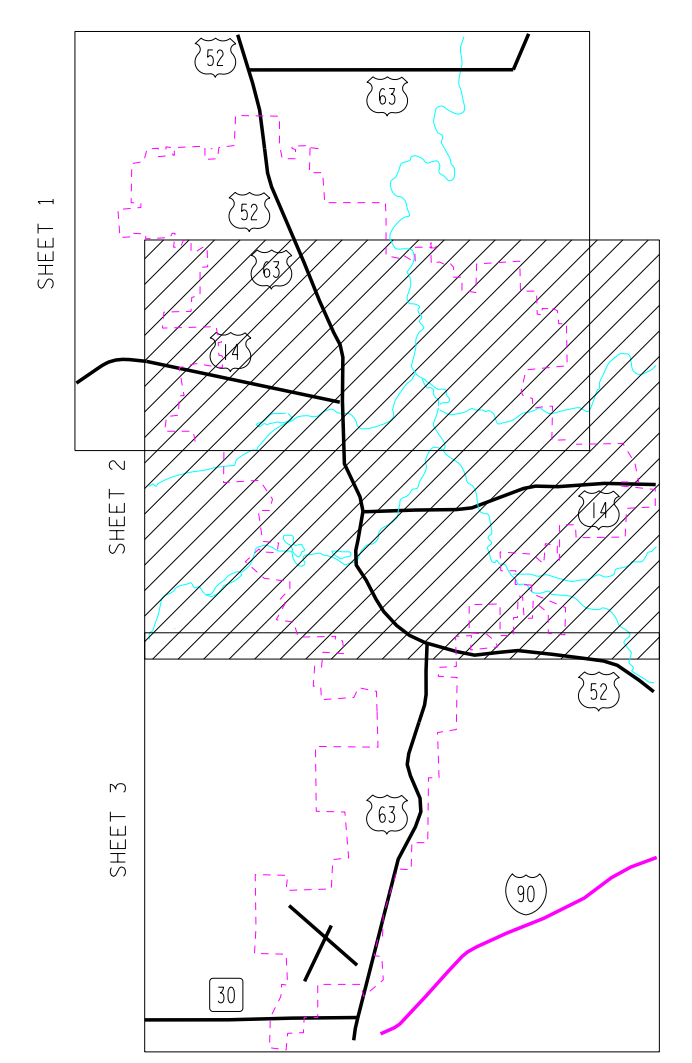
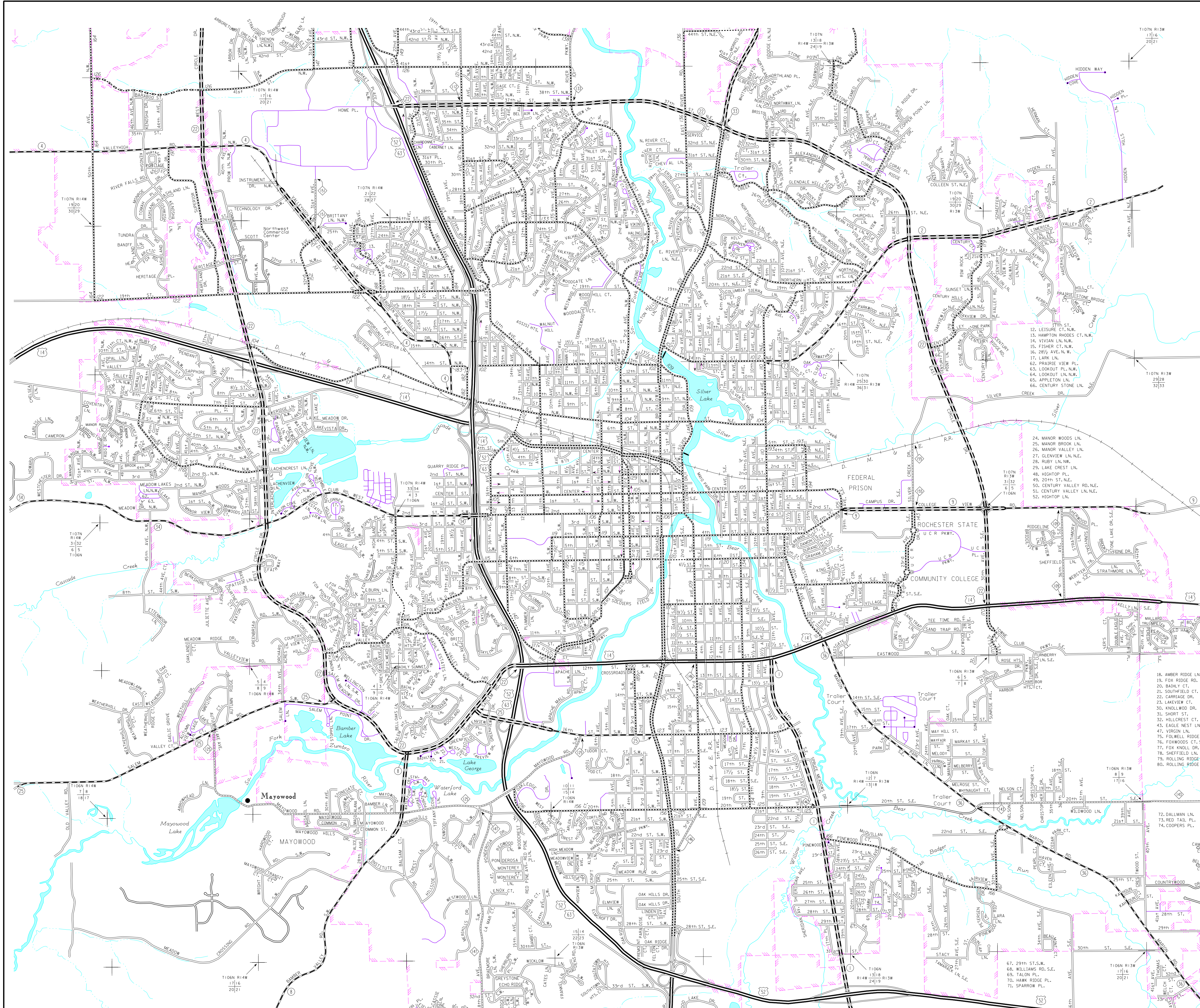

To request information from this document in an alternative format, call 651-366-7718 or 1-800-627-3774 (Greater Minnesota); 771 or 1-800-627-3529 (Minnesota Relay). You may also send an e-mail to [ADRequester@state.mn.us](mailto:ADRequester@state.mn.us). (Please request at least one week in advance).