

# MUNICIPALITY OF ROCHESTER

PREPARED BY THE  
**MINNESOTA DEPARTMENT OF TRANSPORTATION**  
 OFFICE OF TRANSPORTATION SYSTEM MANAGEMENT  
 IN COOPERATION WITH  
**U.S. DEPARTMENT OF TRANSPORTATION**  
 FEDERAL HIGHWAY ADMINISTRATION

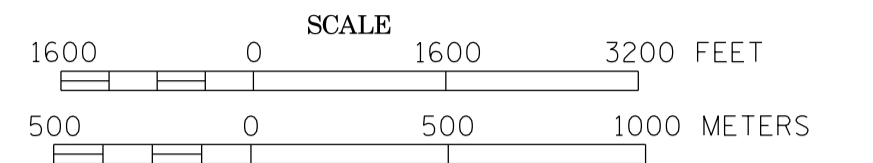

**2014**  
 BASIC DATA - 2013

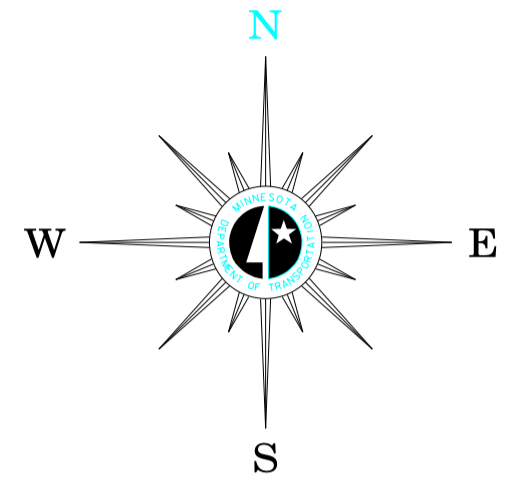

## LEGEND

- INTERSTATE TRUNK HIGHWAY..... 35
- U.S. TRUNK HIGHWAY..... 10
- STATE TRUNK HIGHWAY..... 55
- COUNTY STATE AID HIGHWAY..... 21
- COUNTY ROAD..... 14
- CORPORATE LIMITS.....
- PUBLIC ROAD.....
- PRIVATE ROAD.....

## MUNICIPAL STATE AID STREET SYSTEM

### LEGEND

- MUNICIPAL COUNTY STATE AID STREET.....
- MUNICIPAL STATE AID STREET.....
- COUNTY STATE AID HIGHWAY.....
- COUNTY ROAD.....
- TRUNK HIGHWAY.....

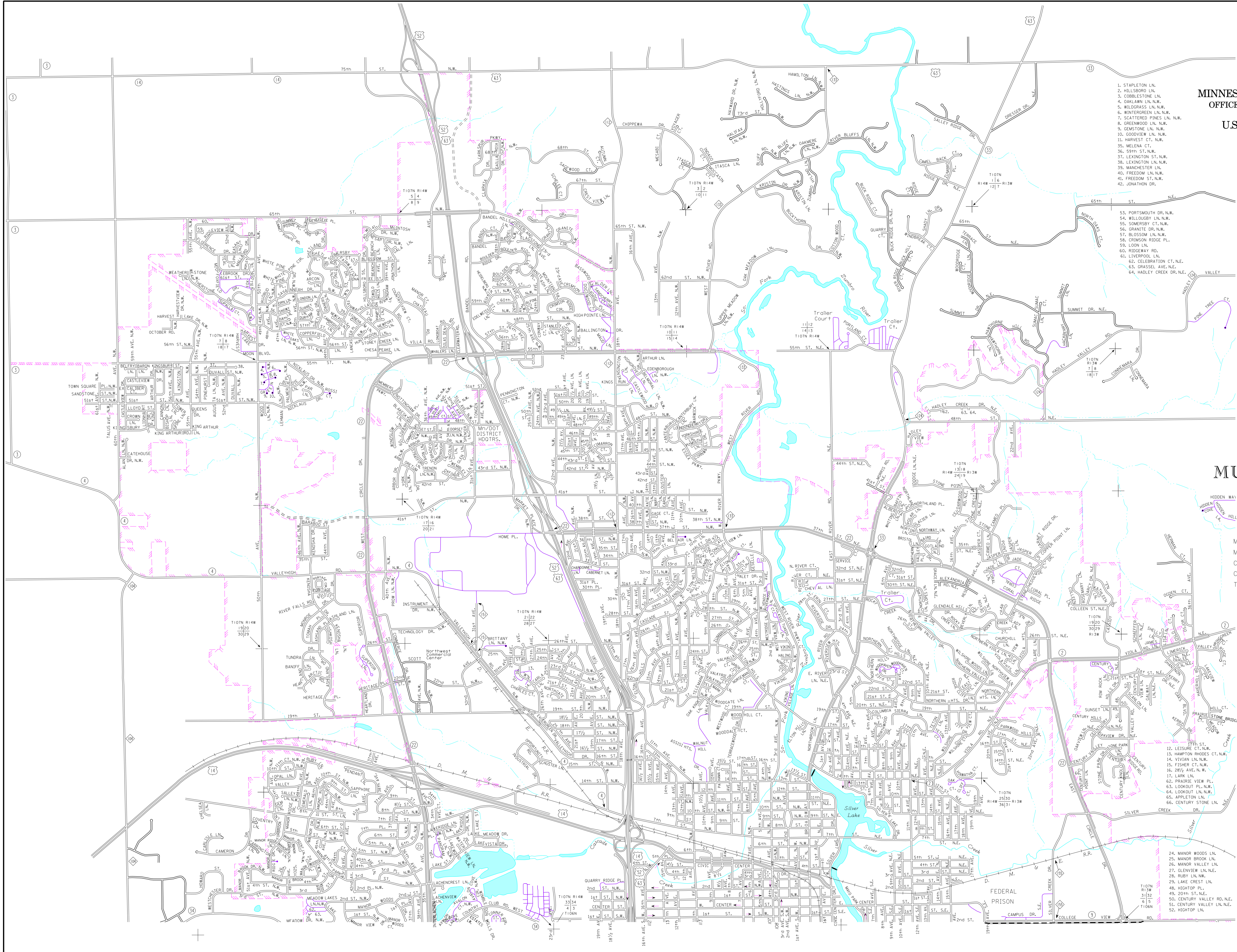
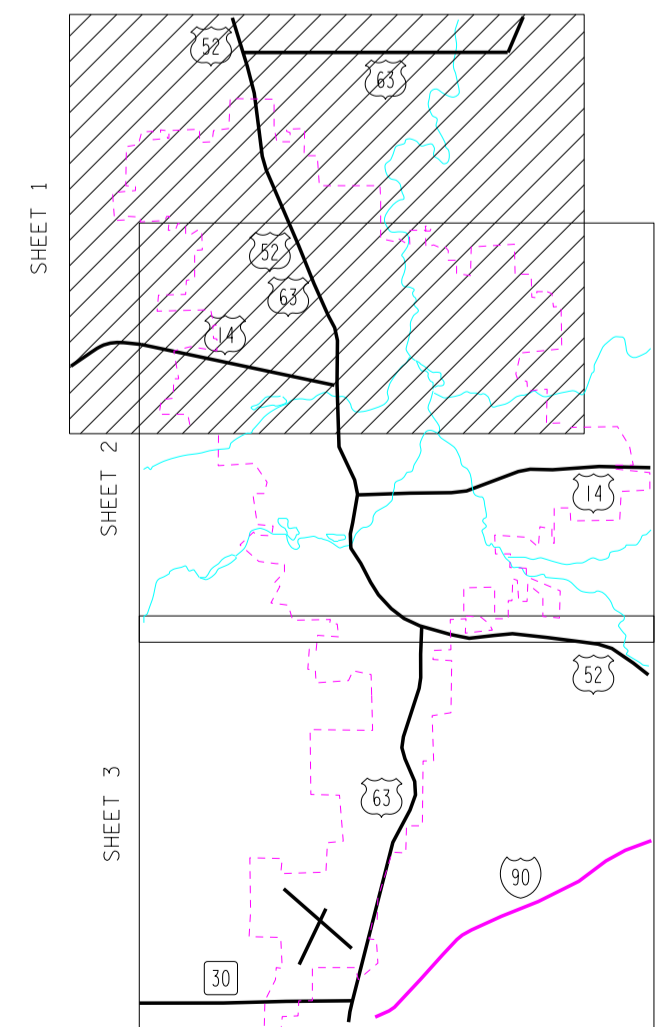

1. STAPLETON LN.
2. HILLSBORO LN.
3. CORBLETONE LN.
4. OAKLAND LN.
5. WILDOGRASS LN.
6. WINTERGREEN LN.
7. SCATTERED PINES LN.
8. GREENWOOD LN.
9. GEMSTONE LN.
10. GOODVIEW LN.
11. HARVEST CT.
12. MELENA CT.
13. 59TH ST. N.W.
14. LEXINGTON ST. N.W.
15. LEXINGTON LN. N.W.
16. MANCHESTER LN.
17. FREEDOM LN. N.W.
18. JONATHAN DR.
19. PORTSMOUTH DR. N.W.
20. WILLOUGHBY LN. N.W.
21. SOMERSET CT. N.W.
22. GRANITE DR. N.W.
23. BLOSSOM LN. N.W.
24. CRIMSON RIDGE PL.
25. LOON LN.
26. RIDGEWAY RD.
27. LIVERPOOL LN.
28. CELEBRATION CT. N.E.
29. GRASSEL AVE. N.E.
30. HADLEY CREEK DR. N.E.
31. HADLEY CREEK DR. N.E.
32. HADLEY CREEK DR. N.E.
33. HADLEY CREEK DR. N.E.
34. HADLEY CREEK DR. N.E.
35. HADLEY CREEK DR. N.E.
36. HADLEY CREEK DR. N.E.
37. HADLEY CREEK DR. N.E.
38. HADLEY CREEK DR. N.E.
39. HADLEY CREEK DR. N.E.
40. HADLEY CREEK DR. N.E.
41. HADLEY CREEK DR. N.E.
42. HADLEY CREEK DR. N.E.
43. HADLEY CREEK DR. N.E.
44. HADLEY CREEK DR. N.E.
45. HADLEY CREEK DR. N.E.
46. HADLEY CREEK DR. N.E.
47. HADLEY CREEK DR. N.E.
48. HADLEY CREEK DR. N.E.
49. HADLEY CREEK DR. N.E.
50. HADLEY CREEK DR. N.E.
51. HADLEY CREEK DR. N.E.
52. HADLEY CREEK DR. N.E.
53. HADLEY CREEK DR. N.E.
54. HADLEY CREEK DR. N.E.
55. HADLEY CREEK DR. N.E.
56. HADLEY CREEK DR. N.E.
57. HADLEY CREEK DR. N.E.
58. HADLEY CREEK DR. N.E.
59. HADLEY CREEK DR. N.E.
60. HADLEY CREEK DR. N.E.
61. HADLEY CREEK DR. N.E.
62. HADLEY CREEK DR. N.E.
63. HADLEY CREEK DR. N.E.
64. HADLEY CREEK DR. N.E.

To request information from this document in an alternative format, call 651-366-4718 or 1-800-657-3774 (Greater Minnesota); 711 or 1-800-627-3529 (Minnesota Relay). You may also send an e-mail to [ADRequest@dot.state.mn.us](mailto:ADRequest@dot.state.mn.us). (Please request at least one week in advance).