

MUNICIPALITY OF OWATONNA

PREPARED BY THE
MINNESOTA DEPARTMENT OF TRANSPORTATION
OFFICE OF TRANSPORTATION SYSTEM MANAGEMENT
IN COOPERATION WITH
U.S. DEPARTMENT OF TRANSPORTATION
FEDERAL HIGHWAY ADMINISTRATION

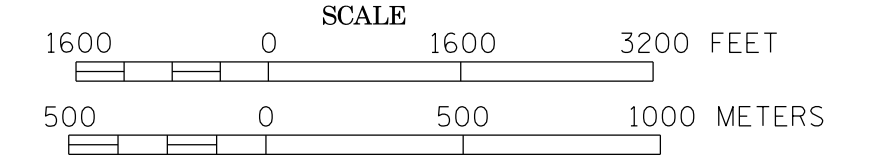

2014
BASIC DATA - 2013

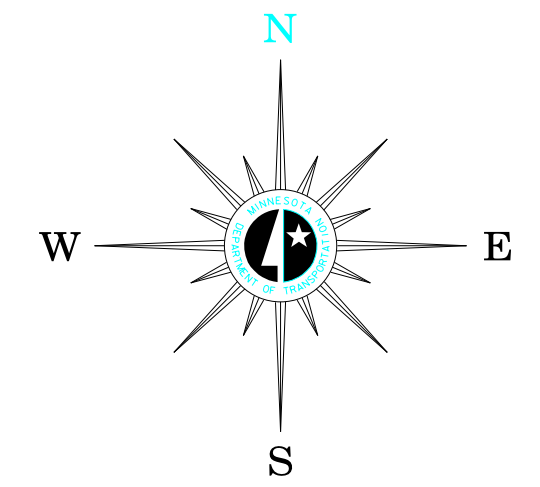

LEGEND

- INTERSTATE TRUNK HIGHWAY..... 35
- U.S. TRUNK HIGHWAY..... 10
- STATE TRUNK HIGHWAY..... 55
- COUNTY STATE AID HIGHWAY..... 23
- COUNTY ROAD..... 15
- CORPORATE LIMITS.....
- PUBLIC ROAD.....
- PRIVATE ROAD.....

MUNICIPAL STATE AID STREET SYSTEM

LEGEND

- MUNICIPAL STATE AID STREET.....
- COUNTY STATE AID HIGHWAY.....
- COUNTY ROAD.....
- TRUNK HIGHWAY.....

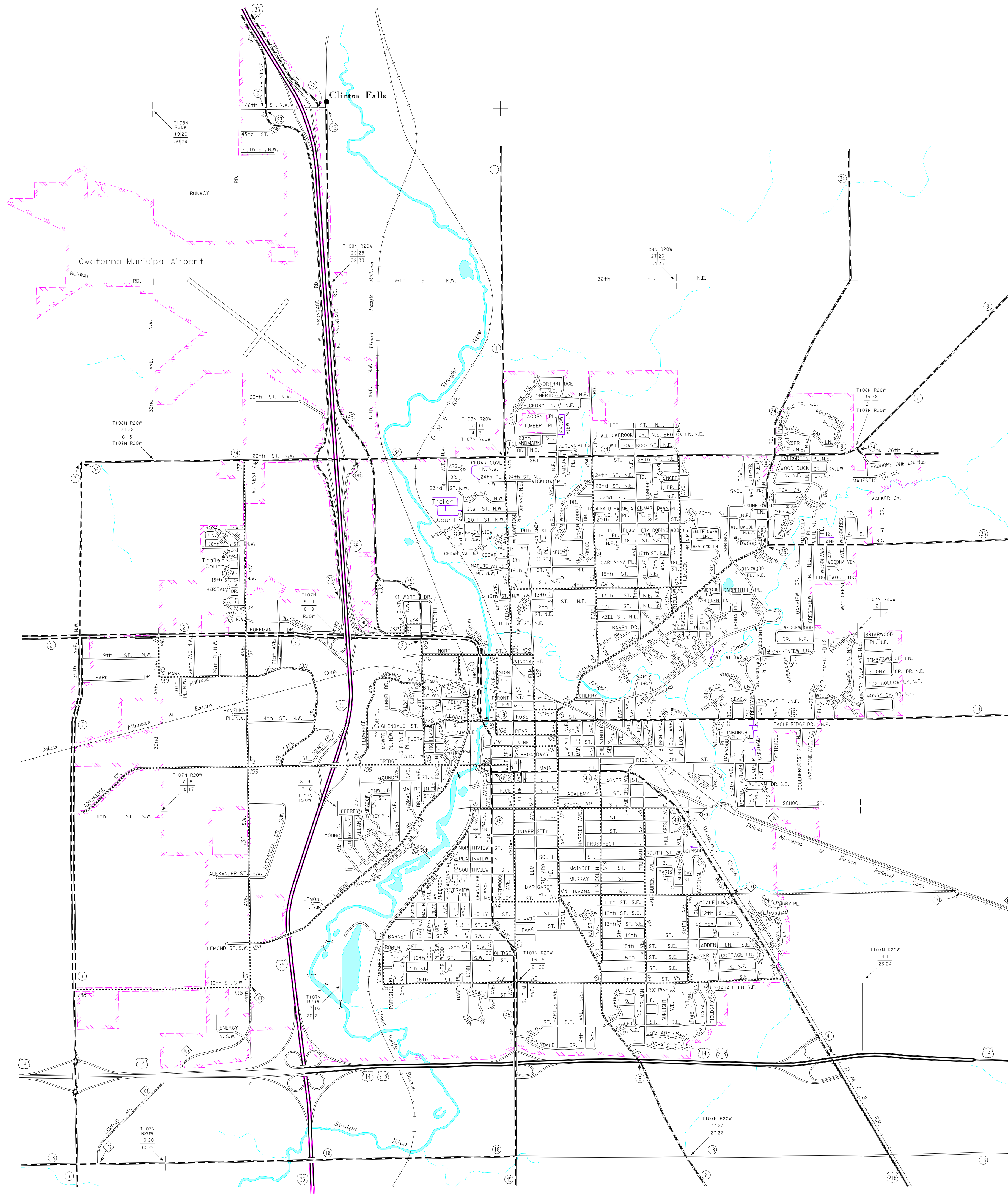

1. PLEASANT AVE.
2. INTERLACHEN
3. ROLLING GREEN DR.
4. MAPLELEAF LN.
5. MAPLELEAF LN. N.E.
6. WATER TOMER PL. N.E.
7. GREENLEAF PL. S.E.
8. CHURCHILL DR.
9. BIRCHWOOD LN. S.E.
10. LINDHAVEN LN. N.E.
11. LINDHAVEN PL. N.E.
12. RASPBERRY RIDGE PL. N.E.

To request information from this document in an alternative format, call 651-366-4718 or 1-800-657-3774 (Greater Minnesota); 711 or 1-800-627-3529 (Minnesota Relay). You may also send an e-mail to ADRequest.dco@state.mn.us. (Please request at least one week in advance).