

MUNICIPALITY OF
NEW HOPE

PREPARED BY THE
MINNESOTA DEPARTMENT OF TRANSPORTATION
OFFICE OF TRANSPORTATION SYSTEM MANAGEMENT
IN COOPERATION WITH
U.S. DEPARTMENT OF TRANSPORTATION
FEDERAL HIGHWAY ADMINISTRATION

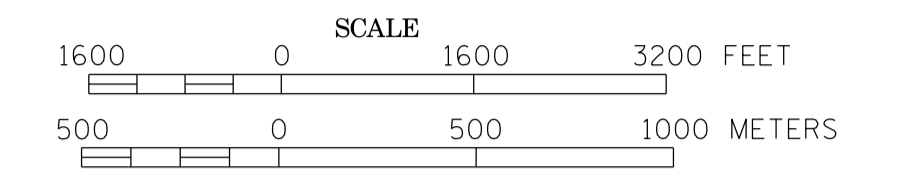

2014
BASIC DATA - 2013

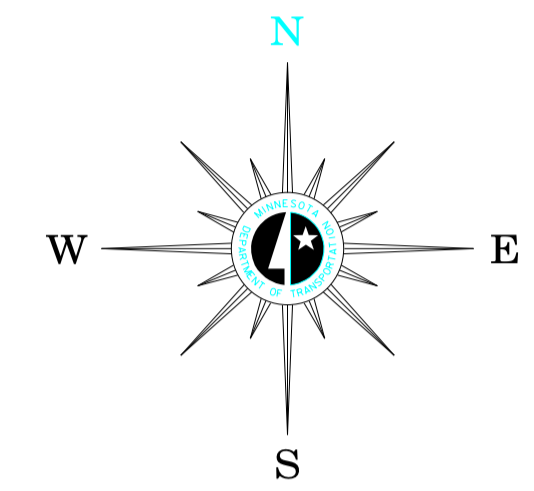

LEGEND

- INTERSTATE TRUNK HIGHWAY..... (35)
- U.S. TRUNK HIGHWAY..... (10)
- STATE TRUNK HIGHWAY..... (55)
- COUNTY STATE AID HIGHWAY..... (23)
- COUNTY ROAD..... (15)
- CORPORATE LIMITS.....
- PUBLIC ROAD.....
- PRIVATE ROAD.....

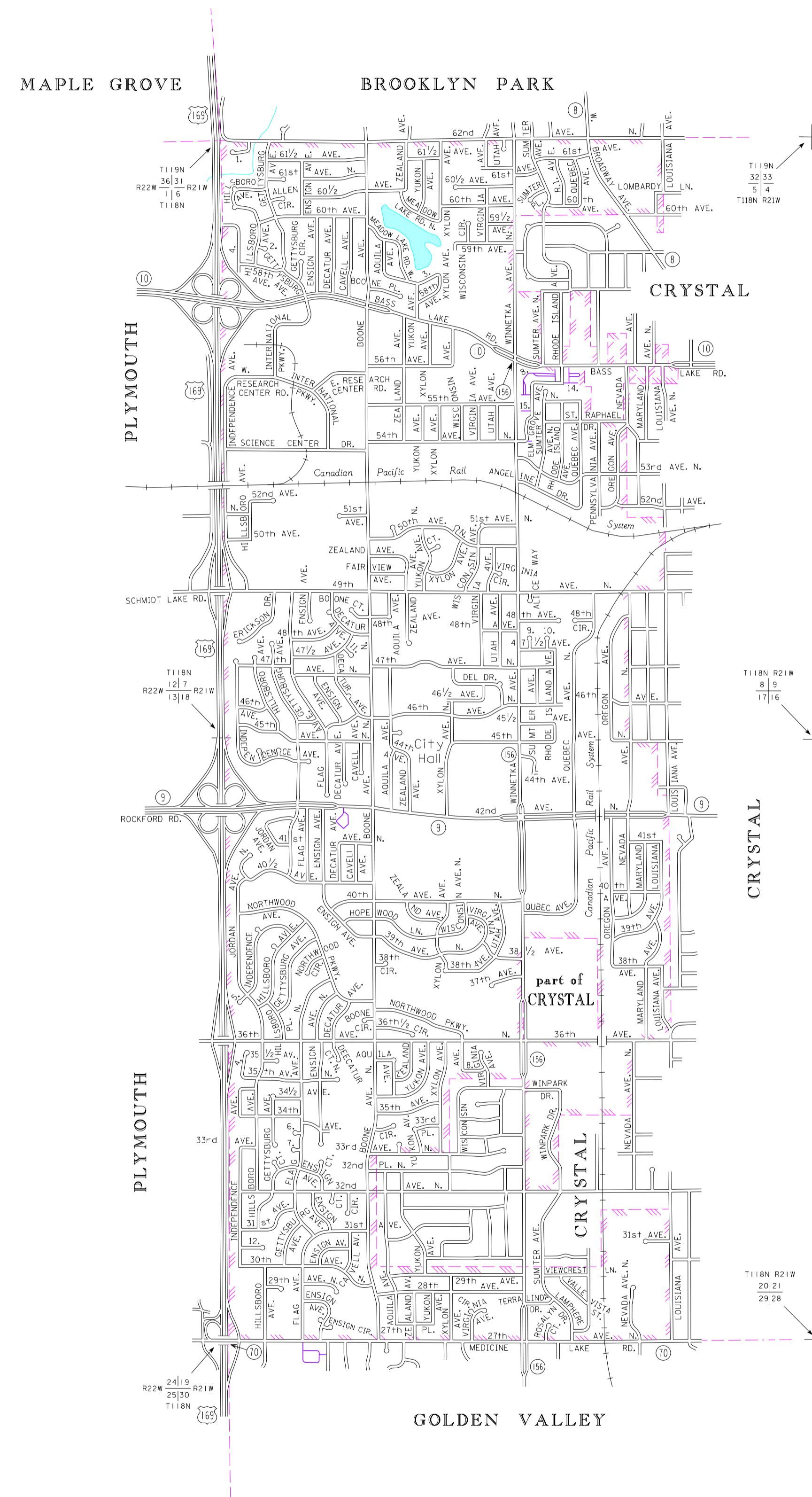

1. BASS CREEK CIR.
2. HILLSBORO CIR.
3. MEADOW LAKE RD. E.
4. INDEPENDENCE AVE.
5. JORDAN CIR.
6. FLAG CIR.
7. FLAG CT.
8. ELM GROVE CT.
9. 47 1/2 CIR.
10. 47 1/2 PL.
11. DECATUR PL.
12. INDEPENDENCE CIR.
13. E. MEADOW RD.
14. ELM GROVE CIR.
15. ELM GROVE LN.

To request information from this document in an alternative format, call 651-336-8718 or 1-800-657-3774 (Greater Minnesota); 711 or 1-800-627-3529 (Minnesota Relay). You may also send an e-mail to ADRequest.dot@state.mn.us. (Please request at least one week in advance).