

# MUNICIPALITY OF MOORHEAD

PREPARED BY THE  
**MINNESOTA DEPARTMENT OF TRANSPORTATION**  
 OFFICE OF TRANSPORTATION SYSTEM MANAGEMENT  
 IN COOPERATION WITH  
**U.S. DEPARTMENT OF TRANSPORTATION**  
 FEDERAL HIGHWAY ADMINISTRATION

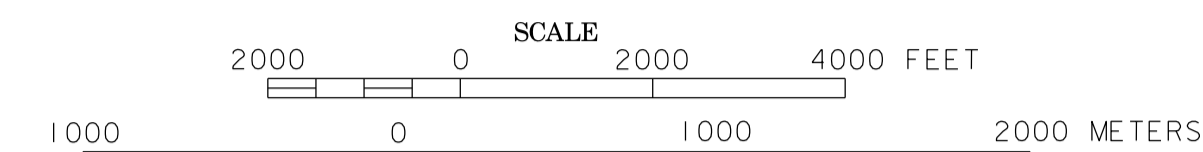

**2014**  
 BASIC DATA - 2013

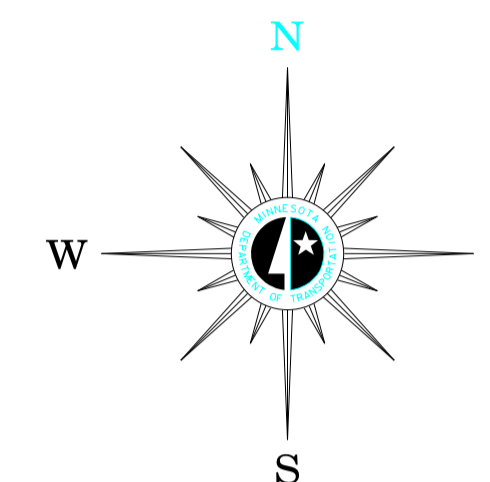

## LEGEND

- INTERSTATE TRUNK HIGHWAY..... (35)
- U.S. TRUNK HIGHWAY..... (10)
- STATE TRUNK HIGHWAY..... (55)
- COUNTY STATE AID HIGHWAY..... (23)
- CORPORATE LIMITS..... (5)
- PUBLIC ROAD.....
- PRIVATE ROAD.....

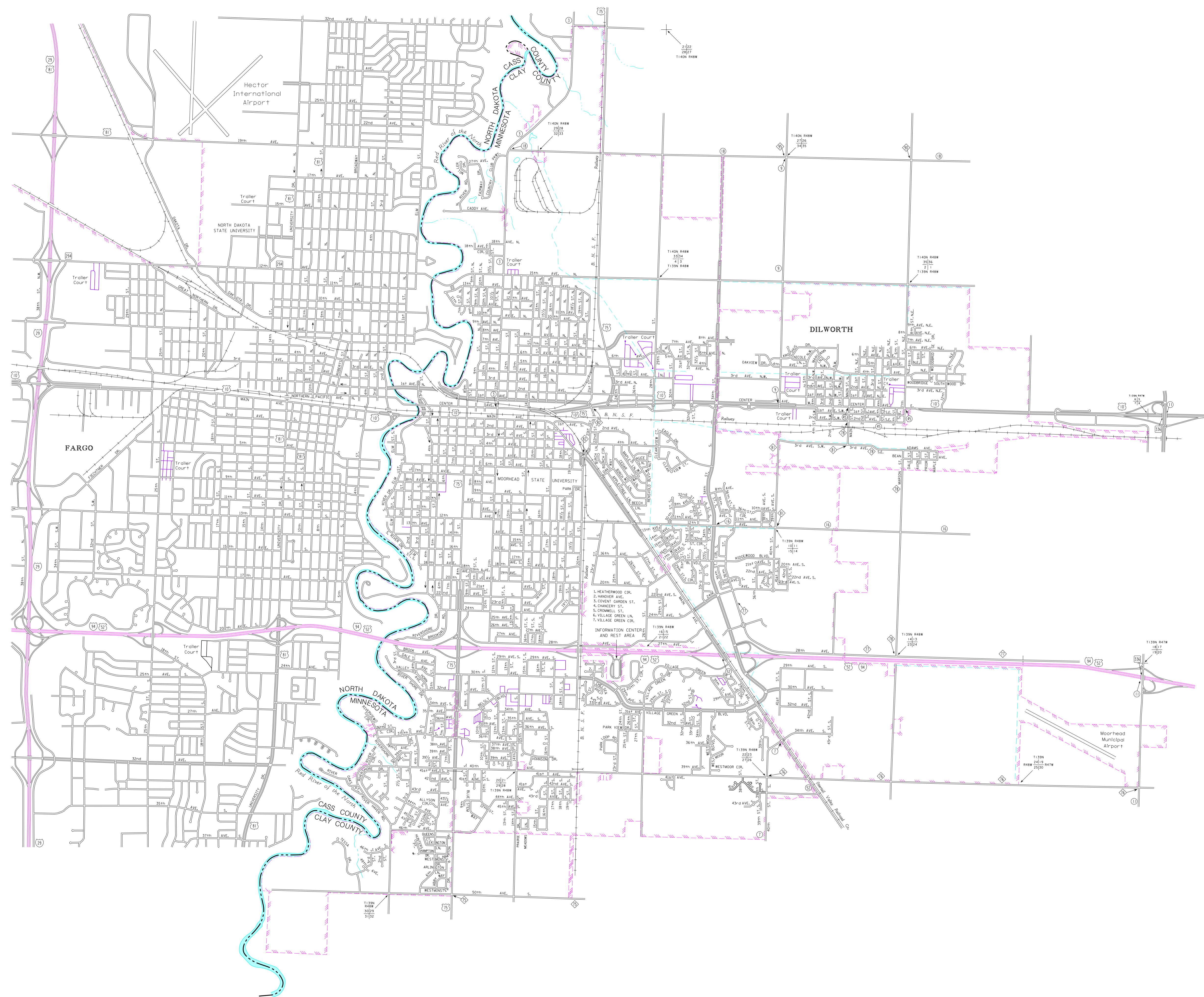

1. HEATHERWOOD CBL.
  2. HANOVER AVE.
  3. COVENT GARDEN ST.
  4. CHAMBERLAIN ST.
  5. CROWWELL ST.
  6. VILLAGE GREEN CBL.
  7. VILLAGE GREEN CBL.
- INFORMATION CENTER AND REST AREA

To request information from this document in an alternative format, call 651-366-4718 or 1-800-657-3774 (Greater Minnesota); 711 or 1-800-627-3529 (Minnesota Relay). You may also send an e-mail to [ADRequest.cdot@state.mn.us](mailto:ADRequest.cdot@state.mn.us). (Please request at least one week in advance).