

MUNICIPALITY OF MARSHALL

PREPARED BY THE
MINNESOTA DEPARTMENT OF TRANSPORTATION
OFFICE OF TRANSPORTATION SYSTEM MANAGEMENT
IN COOPERATION WITH
U.S. DEPARTMENT OF TRANSPORTATION
FEDERAL HIGHWAY ADMINISTRATION

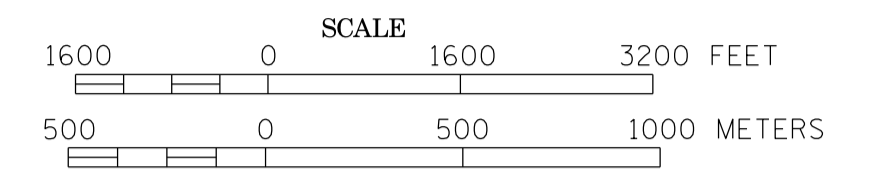

2014
BASIC DATA - 2009

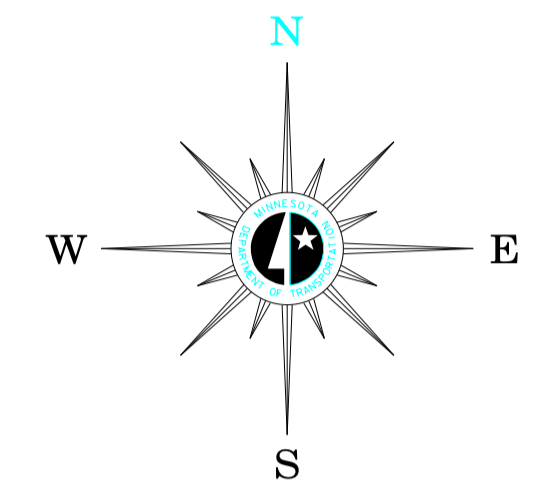

LEGEND

- INTERSTATE TRUNK HIGHWAY..... (35)
- U.S. TRUNK HIGHWAY..... (10)
- STATE TRUNK HIGHWAY..... (55)
- COUNTY STATE AID HIGHWAY..... (23)
- CORPORATE LIMITS..... (5)
- PUBLIC ROAD.....
- PRIVATE ROAD.....

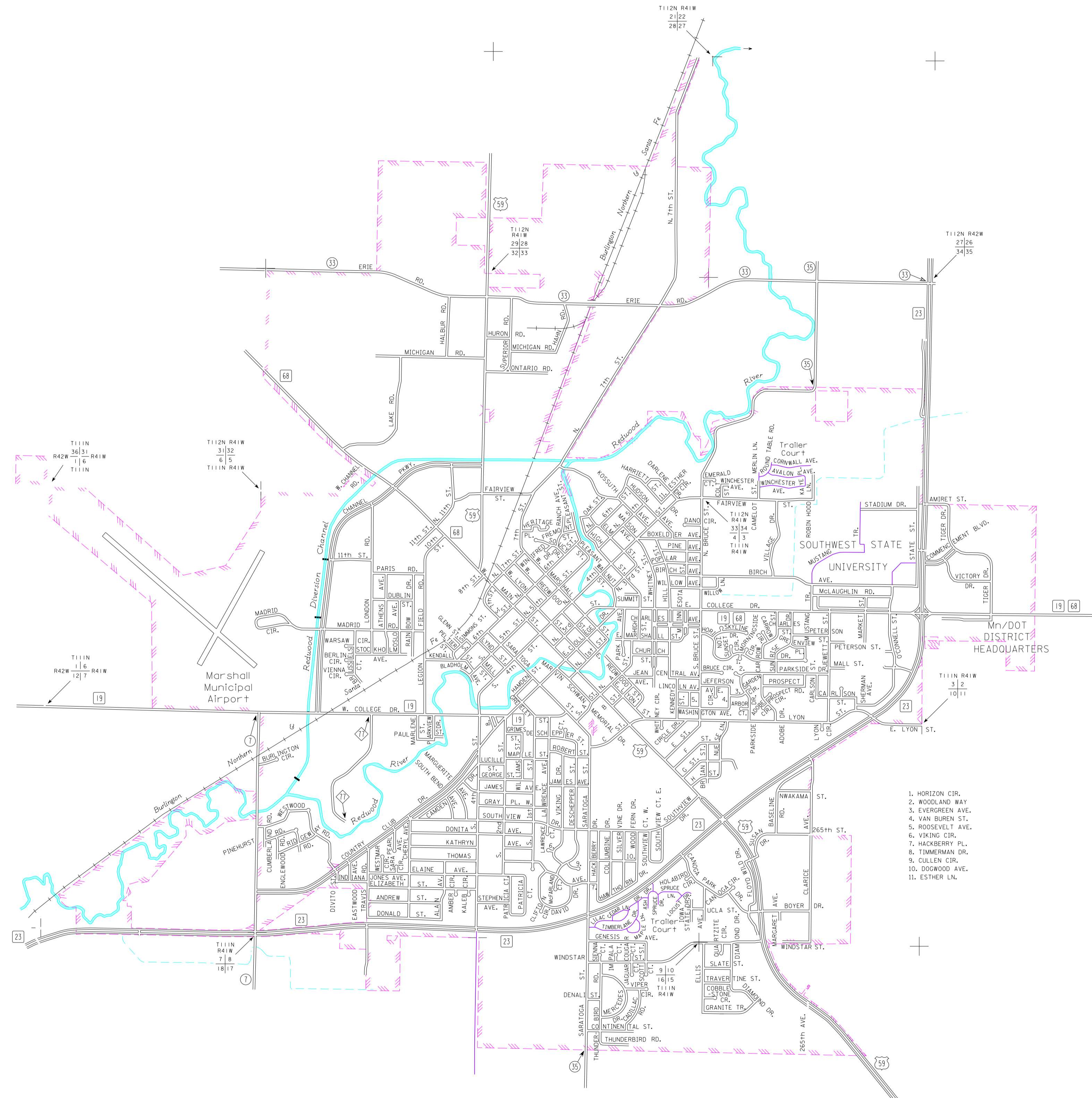

1. HORIZON CIR.
2. WOODLAND WAY.
3. EVERGREEN AVE.
4. VAN BUREN ST.
5. ROOSEVELT AVE.
6. VIKING CIR.
7. HACKBERRY PL.
8. TIMMERMAN DR.
9. CULLEN CIR.
10. DOORWOOD AVE.
11. ESTHER LN.

To request information from this document in an alternative format, call 651-366-4718 or 1-800-657-3774 (Greater Minnesota); 711 or 1-800-627-3529 (Minnesota Relay). You may also send an e-mail to ADRequest.dtd@state.mn.us. (Please request at least one week in advance).