

GENERAL HIGHWAY MAP GOODHUE COUNTY MINNESOTA

PREPARED BY THE
MINNESOTA DEPARTMENT OF TRANSPORTATION
OFFICE OF TRANSPORTATION DATA & ANALYSIS
IN COOPERATION WITH
U.S. DEPARTMENT OF TRANSPORTATION
FEDERAL HIGHWAY ADMINISTRATION

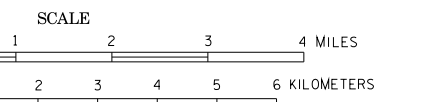

2011
BASIC DATA - 1977*

Projections
Minnesota Coordinate System
South Zone
Lambert Conformal Conic
North American Datum
of 1983



LEGEND

| ROAD AND ROADWAY FEATURES | NAVIGATION |
|---|-------------------------------|
| PROJECTED ROAD | BASE LINES ON NATURAL STREAMS |
| UNIMPROVED ROAD | SHIP LINES ON INLAND LAKES |
| GRADED AND GRADED ROAD | DOCK, PIER OR LEAVING |
| SOIL SURFACE ROAD | DOCK WITH LOCK |
| GRAVEL OR STONE ROAD | NAVIGABLE STREAM |
| BITUMEN ROAD | LOCK WITH LIGHT BEACON |
| PAVED ROAD | LIGHTHOUSE |
| ROAD UNDER CONSTRUCTION | |
| ROADS IN UNINCORPORATED PLACES | |
| ROADS WITHIN MUNICIPALITIES AND PROVINCIAL BOUNDARIES | |
| POINTS BETWEEN WHICH DISTANCES ARE MEASURED INDICATED | |
| GRADE SEPARATION | |
| FULL TRAFFIC INTERCHANGE | |
| PARTIAL TRAFFIC INTERCHANGES INDICATING TRAFFIC MOVEMENT | |
| ROAD SYSTEM DESIGNATIONS | |
| INTERSTATE TRUNK HIGHWAY | |
| UNNUMBERED TRUNK HIGHWAY | |
| STATE NUMBERED TRUNK HIGHWAY | |
| COUNTY STATE AID HIGHWAY | |
| COUNTY STATE AID IN COUNTING COUNTY | |
| TERMINATION OF DESIGNATED ROUTE | |
| INTERSTATE EXIT | |
| GREAT RIVER ROAD | |
| FEDERAL AID INTERSTATE SYSTEM | |
| NATIONAL FOREST HIGHWAY | |
| NATIONAL FOREST DEVELOPMENT | |
| INDIAN SERVICE ROAD | |
| STATE STREET ROAD | |
| STATE PARK ROAD | |
| RAILROADS | |
| RAILROAD ANY NUMBER OF TRACKS BY A SINGLE OPERATING COMPANY OR BY TRAINS OF ANOTHER OPERATING COMPANY | |
| RAILROADS IN AUTOMATION TRIPS OR MORE TRACKS OR SEPARATELY OPERATED COMPANIES ON ADJACENT PORTIONS OF WAY | |
| RAILROAD STATION | |
| GRADE CROSSING | |
| UNGRADED HIGHWAY RAILROAD | |
| OVERPASS HIGHWAY ABOVE | |
| UNDERPASS HIGHWAY BELOW | |
| AVIATION | |
| MILITARY FIELD | |
| COMMERCIAL OR MANAGERIAL FIELD | |
| COMPLETE FACILITIES | |
| LANDING AREA OR STRIP | |
| SEAPLANE BASE | |
| AIRWAY LIGHT BEACON-GENERAL | |
| RADIO RANGE STATION | |
| STRUCTURES | |
| GENERAL SYMBOLS LOWER 20' SPAN | |
| ROCKY BRIDGE | |
| SMALL BRIDGES CLOSELY SPACED | |
| CHIMNEY | |
| GENERAL SYMBOLS 20' TO 50' SPAN | |
| GENERAL | |
| CHIMNEY | |
| ARCH | |
| FRIS | |
| RECTANGULAR BRIDGE | |
| DAY WITH ROAD LARGE SCALE | |
| DAY WITH ROAD SMALL SCALE | |
| DAY WITHOUT ROAD LARGE SCALE | |
| DAY WITHOUT ROAD SMALL SCALE | |
| LEVEE OR DUNE WITH ROAD | |
| MOOR STRUCTURES 10 TO 20' SPAN | |
| CONCRETE FORD OR BIP | |
| FORD - ROAD ESTABLISHED | |
| BOUNDARIES | |
| NATIONAL OR STATE | |
| CITY TOWNSHIP | |
| CORPORATE LINE | |
| SECTION LINE | |
| CORPORATE AREA | |
| NATIONAL OR STATE PARK | |
| NATIONAL OR STATE FOREST | |
| INDIAN RESERVATION | |
| GRASS REFUGE | |
| AIRPORT | |
| BULFIFE MANAGEMENT AREA STATION | |
| BULFIFE AREA FEDERAL | |
| MATCH LINE BETWEEN ADJOINING SHEETS OF THE SAME COUNTY | |
| DRAINAGE | |
| INTERMITTENT STREAM | |
| MINOR STREAM | |
| WIDE STREAM | |
| WASH OR BRAMP LAND | |
| DRAINAGE STATION | |
| LAKE OR POND | |
| NAVIGATION | |
| BASE LINES ON NATURAL STREAMS | |
| SHIP LINES ON INLAND LAKES | |
| DOCK, PIER OR LEAVING | |
| DOCK WITH LOCK | |
| NAVIGABLE STREAM | |
| LOCK WITH LIGHT BEACON | |
| LIGHTHOUSE | |
| CONSERVATION | |
| FOREST RANGER STATION | |
| GRASS REFUGE | |
| INDIAN RESERVATION | |
| GRASS REFUGE | |
| SEPARATION OF LANDS | |
| PROMINENT ELEVATION | |
| TRAIL POINT OF STATE OR COUNTY | |
| M - MUNICIPAL, BP - BAYSIDE | |
| PUBLIC ACCESS POINT | |
| RECREATION | |
| GOLF COURSE OR COUNTRY CLUB | |
| SOCCER FIELD | |
| ATHLETIC FIELD | |
| RECREATION PARK | |
| PLAYGROUND | |
| BATHING BEACH OR SWIMMING POOL | |
| SCENIC SITE | |
| CAMP OR LODGE | |
| FARM AND DWELLING UNITS | |
| FARM UNIT | |
| SMALLER THAN FARM | |
| BARNYARD OR DONORIES FOR STUDENTS | |
| BARNYARD, BARN, ETC. | |
| SEASONAL DWELLING | |
| HOUSE OR GROUP OF BUILDINGS CLOSELY SPACED | |
| NUMBER NUMBER USED TO INDICATE INDICATE NUMBER OF EACH UNIT | |
| SHOW LOCATION OF ANY CULTURAL FEATURE SHOW LOCATION OF HISTORIC | |
| INDUSTRIAL | |
| FACTORY OR INDUSTRIAL PLANT | |
| MINES | |
| STORAGE TANKS, OIL OR GAS | |
| WATER TOWER | |
| WET DAM | |
| STOCKYARD FEEDLOT | |
| QUARRY | |
| INDUSTRIAL WAREHOUSE | |
| COMMERCIAL | |
| STORE OR SMALL BUSINESS ESTABLISHMENT | |
| HOTEL | |
| RESTAURANT | |
| THEATER OR THEATRE | |
| MURDER | |
| GREENHOUSE | |
| PUBLIC SERVICE FACILITIES | |
| POST OFFICE | |
| FIRE STATION | |
| MUSEUM | |
| PUBLIC LIBRARY | |
| SCHOOL | |
| ALL-ROUNDER POINT OF ENTRY | |
| RADIO STATION | |
| SEMI-INDUSTRIAL PLANT | |
| NURSING HOME | |
| HOSPITAL | |
| TOBACCO | |
| CORRECTIONAL INSTITUTION | |
| CITY CENTERS | |
| STATE CAPITAL | |
| COUNTY SEAT | |
| CITY CENTER | |
| UNINCORPORATED CITY (GENERALIZED) | |
| UNINCORPORATED CANTONMENT | |
| MISCELLANEOUS MAP FEATURES | |
| CHAPEL OR OTHER RELIGIOUS INSTITUTION | |
| COURT | |
| CHURCH WITH CEMETERY ADJACENT | |
| PARISH OR CONGREGATION | |
| MONUMENT - GENERAL | |
| GRAND PILE | |
| GRAVEYARD | |
| WATER TOWER | |
| SEAPLANE BASE | |
| STATE PARK SUBSTATION | |
| DEPARTMENT OF TRANSPORTATION STATION OFFICE | |
| RAILROAD STATION | |
| WATER TOWER | |
| NATURAL GAS PETROLEUM PRODUCTS | |
| CRUDE OIL OR WATER | |
| CRUDE OIL OR WATER PRODUCTS | |
| NATURAL GAS PETROLEUM PRODUCTS | |
| CRUDE OIL OR WATER | |
| CRUDE OIL OR WATER PRODUCTS | |
| PIPELINE NATURAL GAS | |
| PIPELINE PETROLEUM PRODUCTS | |
| PIPELINE CRUDE OIL | |
| PIPELINE WATER | |
| TRANSMISSION LINE OVER OR UNDER | |
| TRAIL POINT OF ENTRY | |
| TRANSMISSION LINE THROUGH TOWNSHIP | |
| LONGITUDE AND LATITUDE INTERSECTION | |
| HISTORIC STATE OR NATIONAL | |
| OPEN TO THE PUBLIC | |

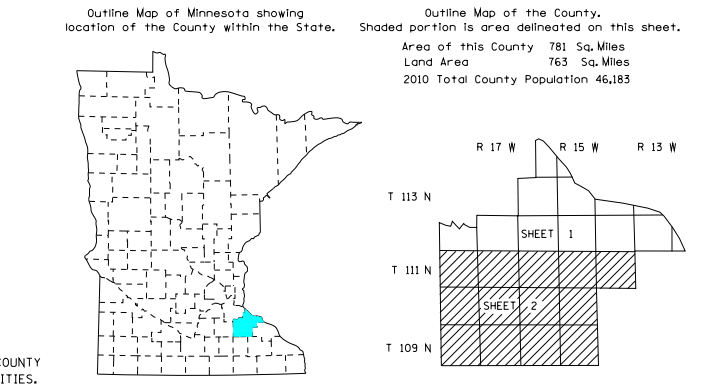
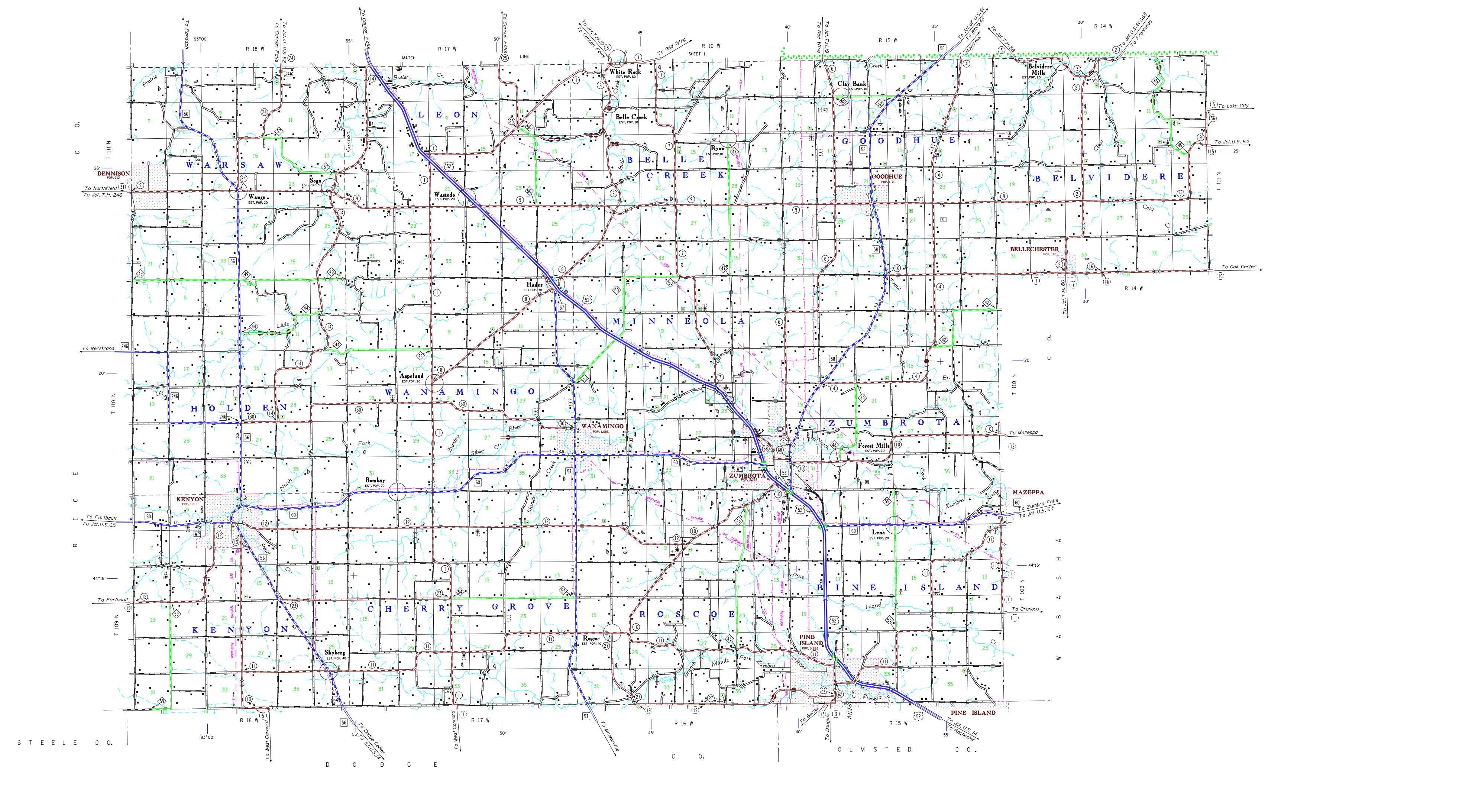

*NOTE: ALL FEATURES EXCEPT TOWNSHIP ROADS AND CULTURE ARE CURRENT AS OF JANUARY 1, 2011.
NOTE: FOR DETAIL OF COUNTY STATE AID HIGHWAYS AND COUNTY ROADS IN INCORPORATED PLACES, SEE MAPS OF MUNICIPALITIES.