

MELROSE
STEARNS COUNTY
POP. 3,598

BELGRADE
STEARNS COUNTY
POP. 740

MUNICIPALITIES OF
STEARNS CO.

PREPARED BY THE
MINNESOTA DEPARTMENT OF TRANSPORTATION
OFFICE OF TRANSPORTATION DATA & ANALYSIS
IN COOPERATION WITH
U.S. DEPARTMENT OF TRANSPORTATION
FEDERAL HIGHWAY ADMINISTRATION

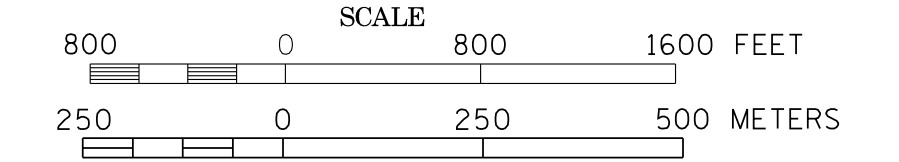

2011
BASIC DATA - 2009

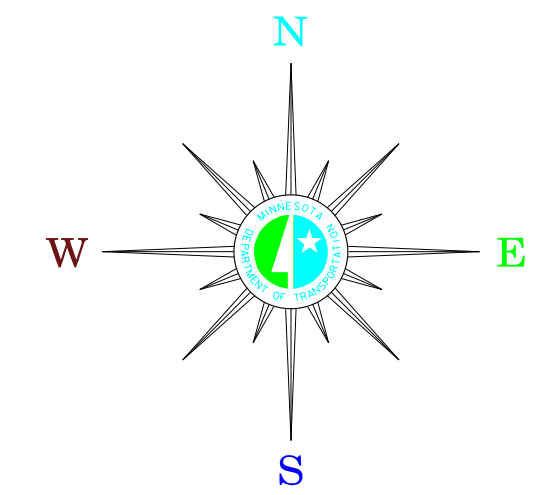

LEGEND

- INTERSTATE TRUNK HIGHWAY..... 35
- U.S. TRUNK HIGHWAY..... 70
- STATE TRUNK HIGHWAY..... 55
- COUNTY STATE AID HIGHWAY..... 23
- COUNTY ROAD..... 15
- PUBLIC ROAD
- PRIVATE ROAD
- CORPORATE LIMITS.....

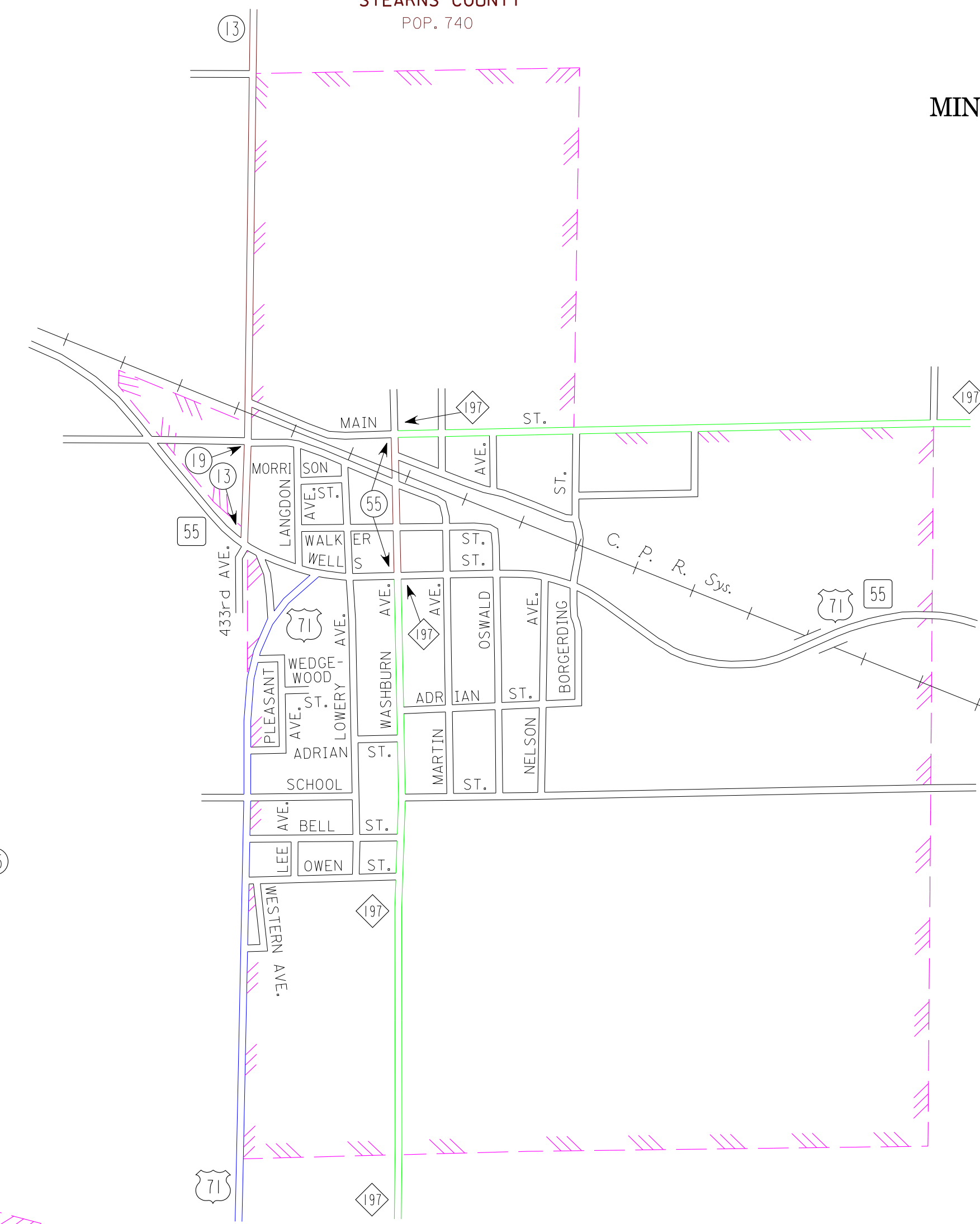
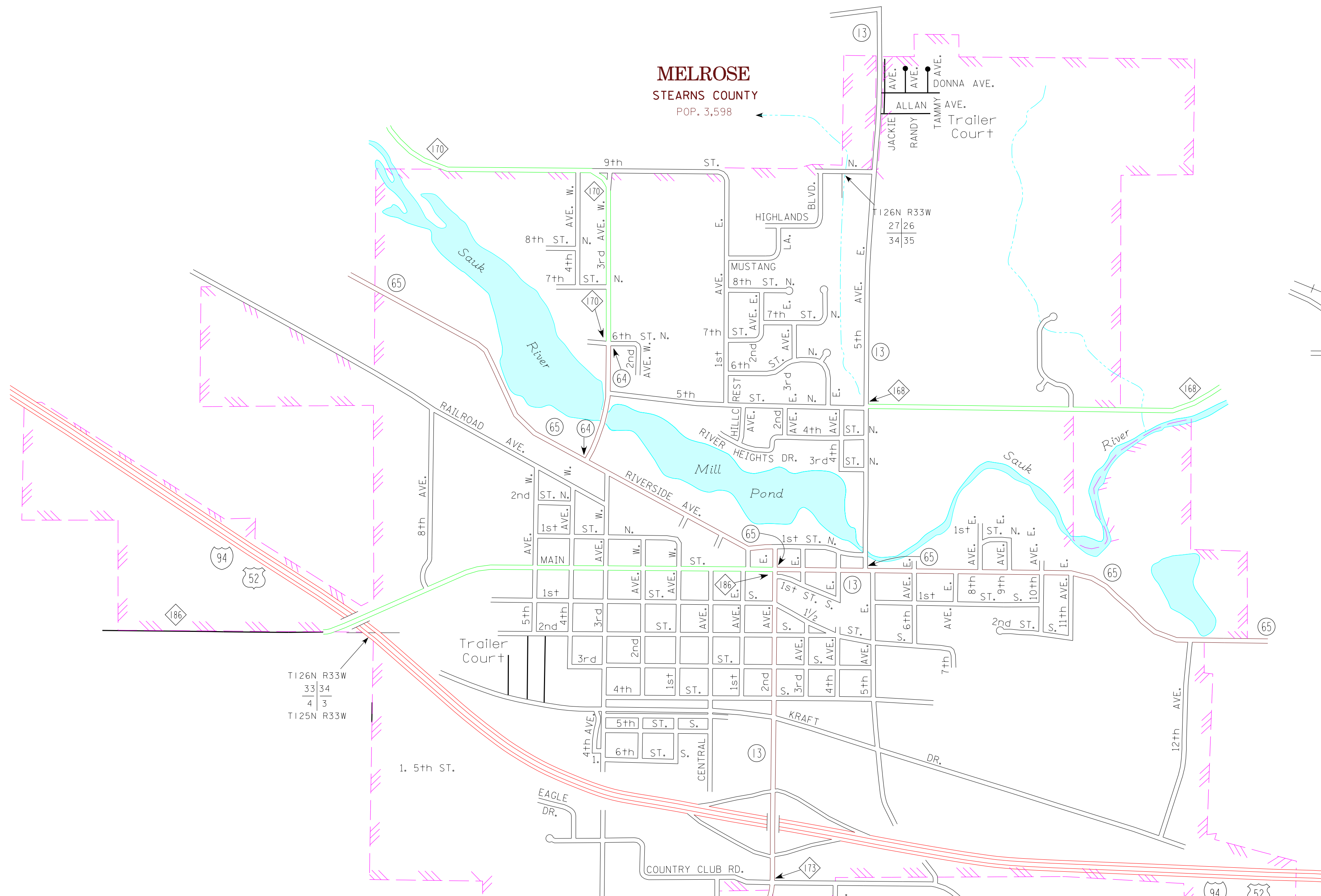

NEW MUNICH
STEARNS COUNTY
POP. 320

KIMBALL
STEARNS COUNTY
POP. 762

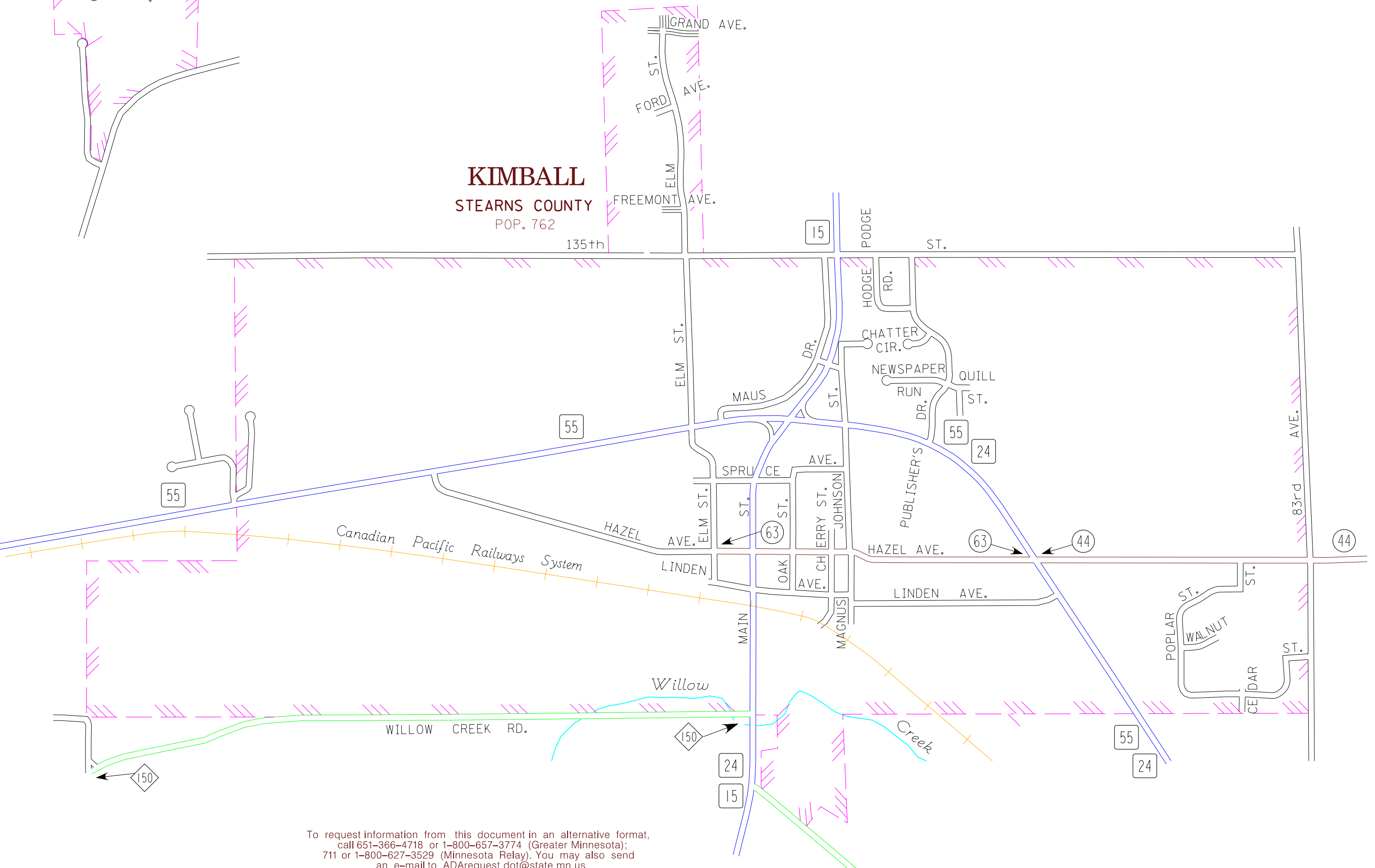
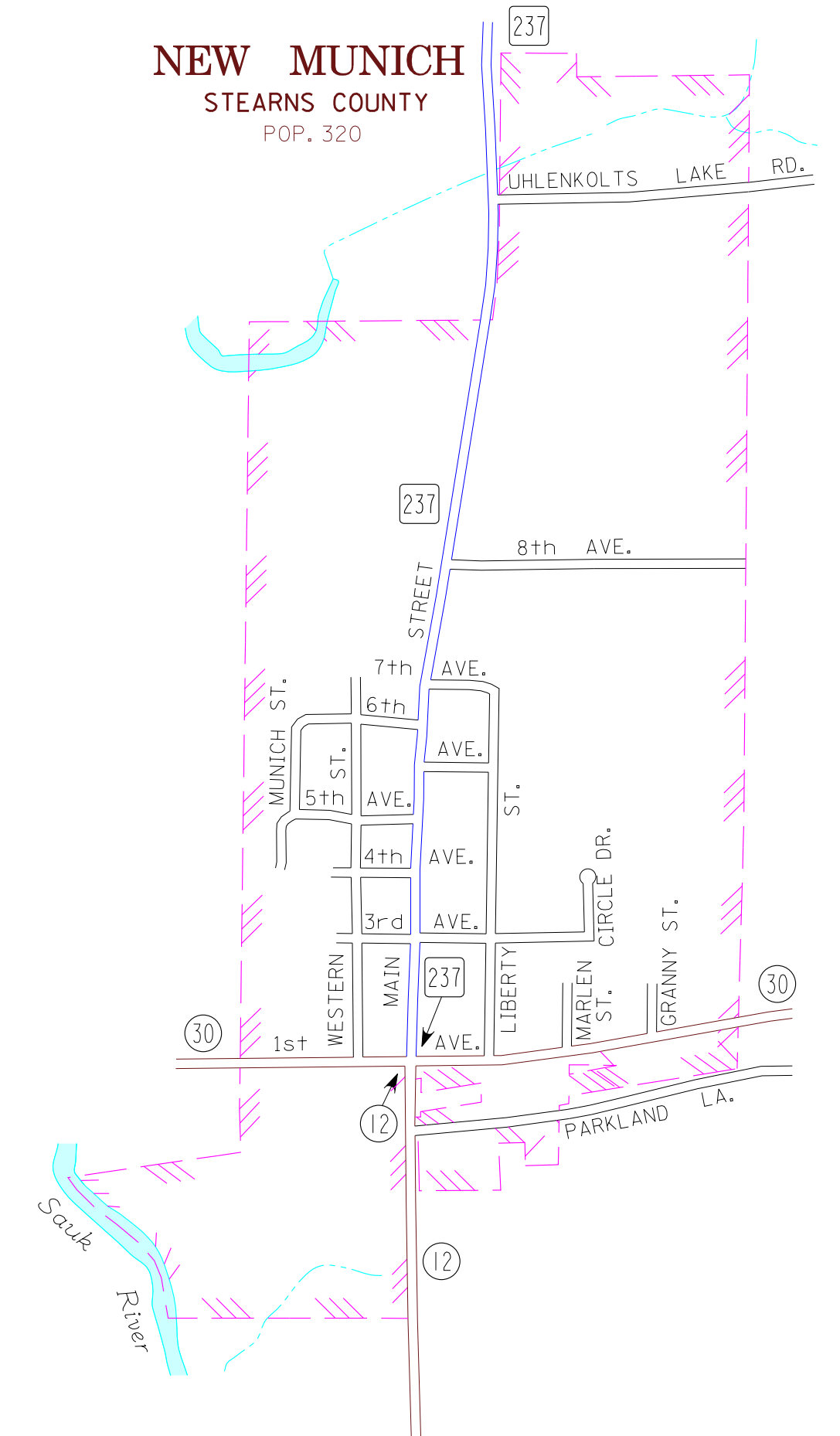

To request information from this document in an alternative format, call 651-296-4718 or 1-800-657-3774 (Greater Minnesota); 711 or 1-800-421-3529 (Minnesota Relay). You may also send an e-mail to ADARrequest.dot@state.mn.us. (Please request at least one week in advance).

NOTE: 2010 U.S. CENSUS FIGURES SHOWN FOR ALL MUNICIPALITIES UNLESS OTHERWISE STATED.

MUNICIPALITIES SHOWN ON THIS SHEET
BELGRADE
KIMBALL
MELROSE
NEW MUNICH