

MUNICIPALITIES OF  
**MOWER CO.**

PREPARED BY THE  
MINNESOTA DEPARTMENT OF TRANSPORTATION  
OFFICE OF TRANSPORTATION DATA & ANALYSIS  
IN COOPERATION WITH  
U.S. DEPARTMENT OF TRANSPORTATION  
FEDERAL HIGHWAY ADMINISTRATION

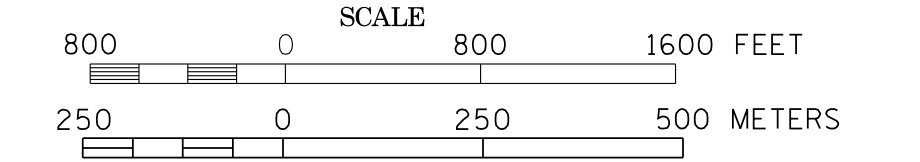

2011  
BASIC DATA - 2009

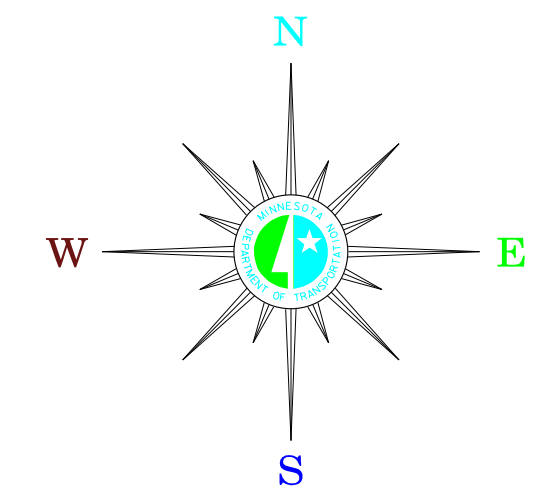

**LEGEND**

- INTERSTATE TRUNK HIGHWAY..... (I-90)
- U.S. TRUNK HIGHWAY..... (US-16)
- STATE TRUNK HIGHWAY..... (ST-56)
- COUNTY STATE AID HIGHWAY..... (CSA-12)
- COUNTY ROAD..... (C-10)
- PUBLIC ROAD..... (P-10)
- PRIVATE ROAD..... (PR-10)
- CORPORATE LIMITS..... (dashed line)

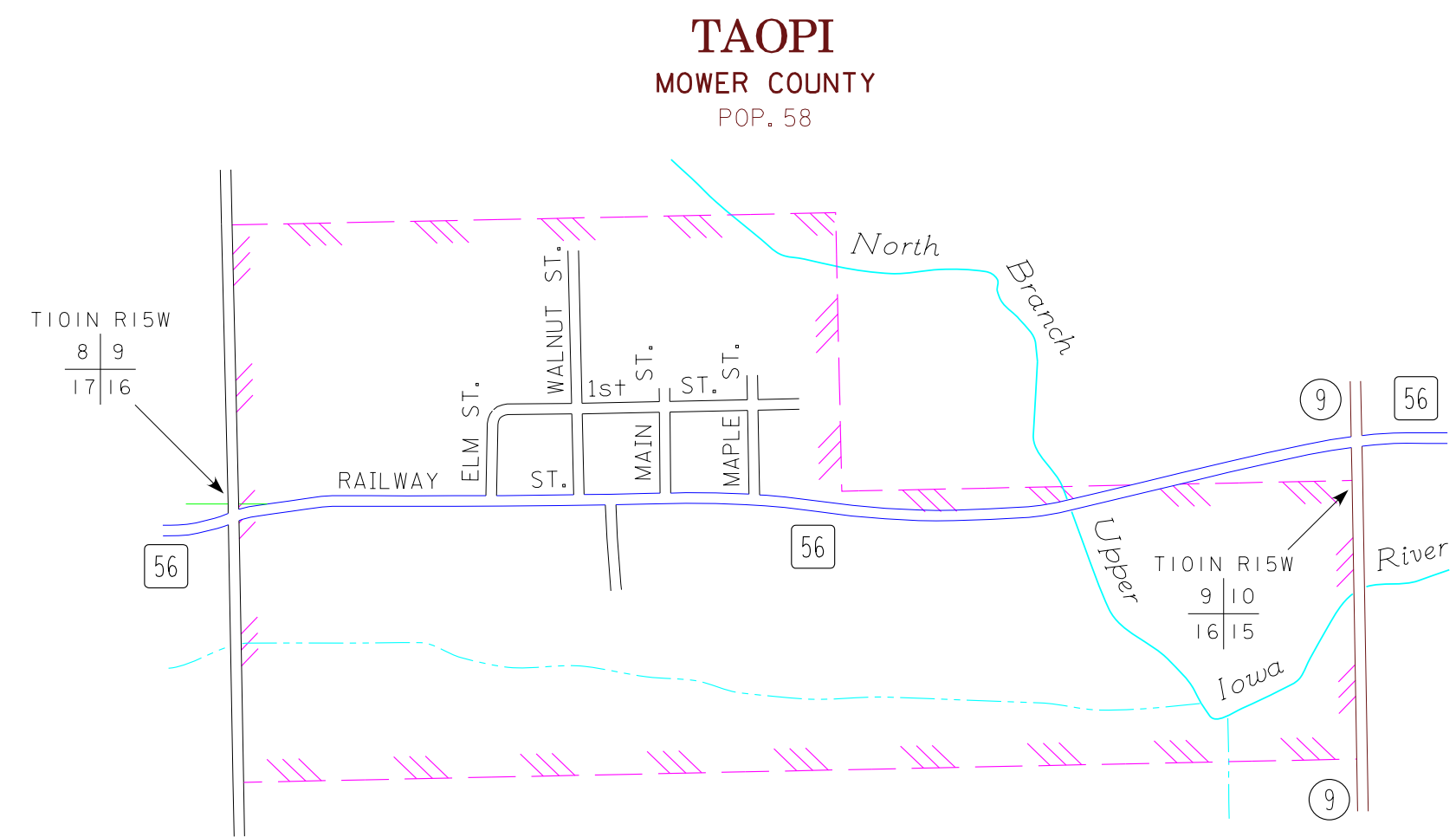
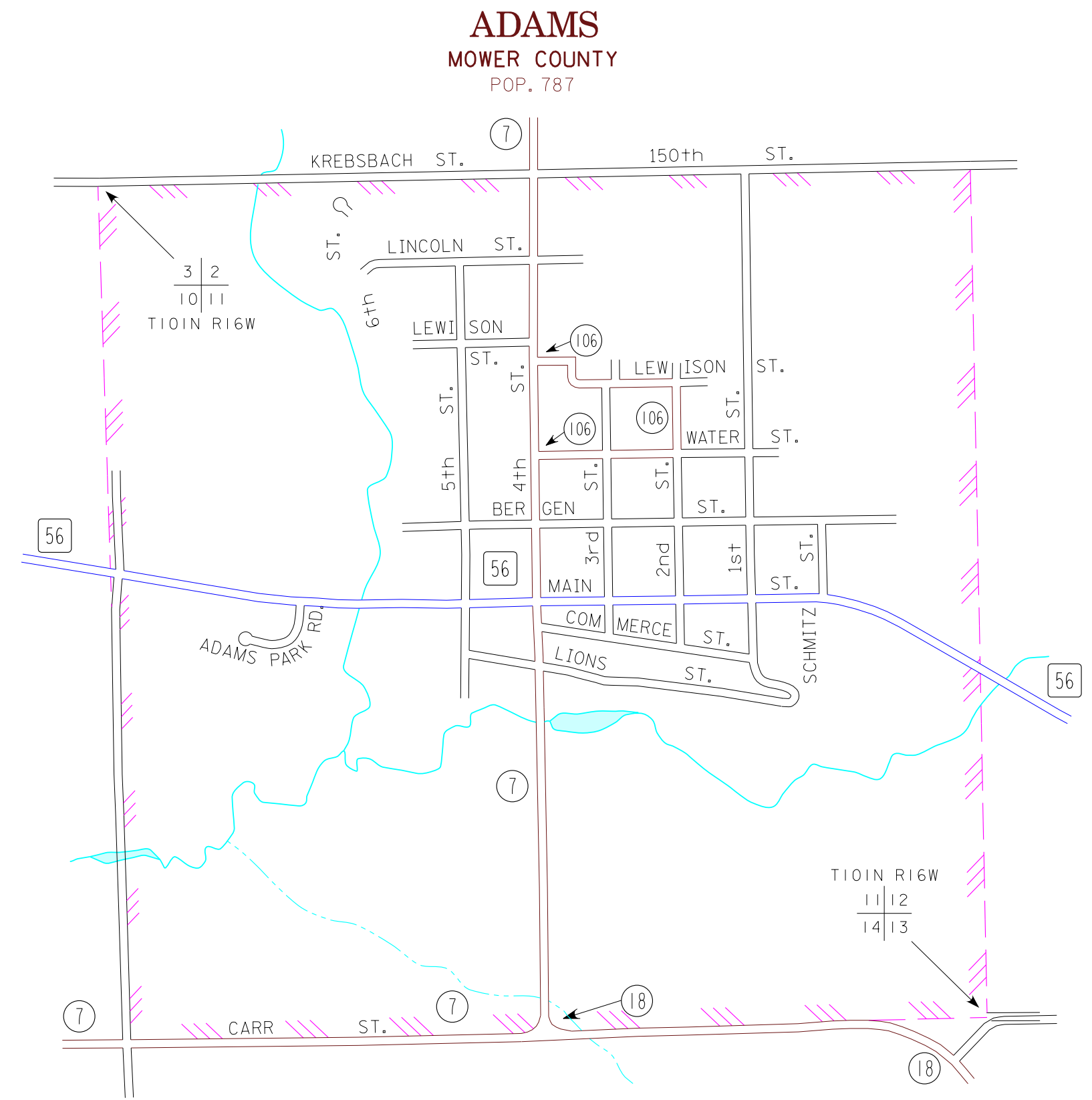
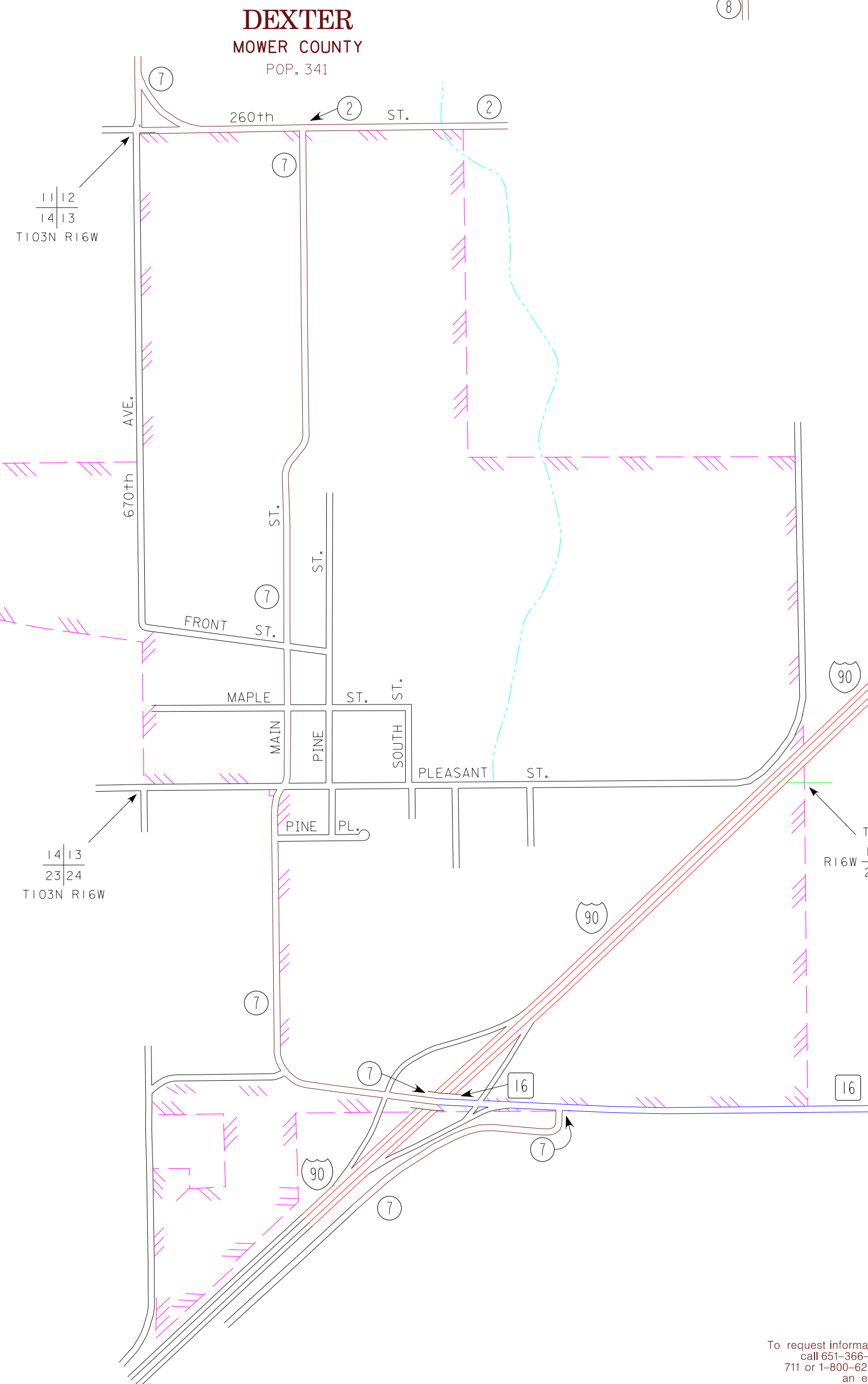
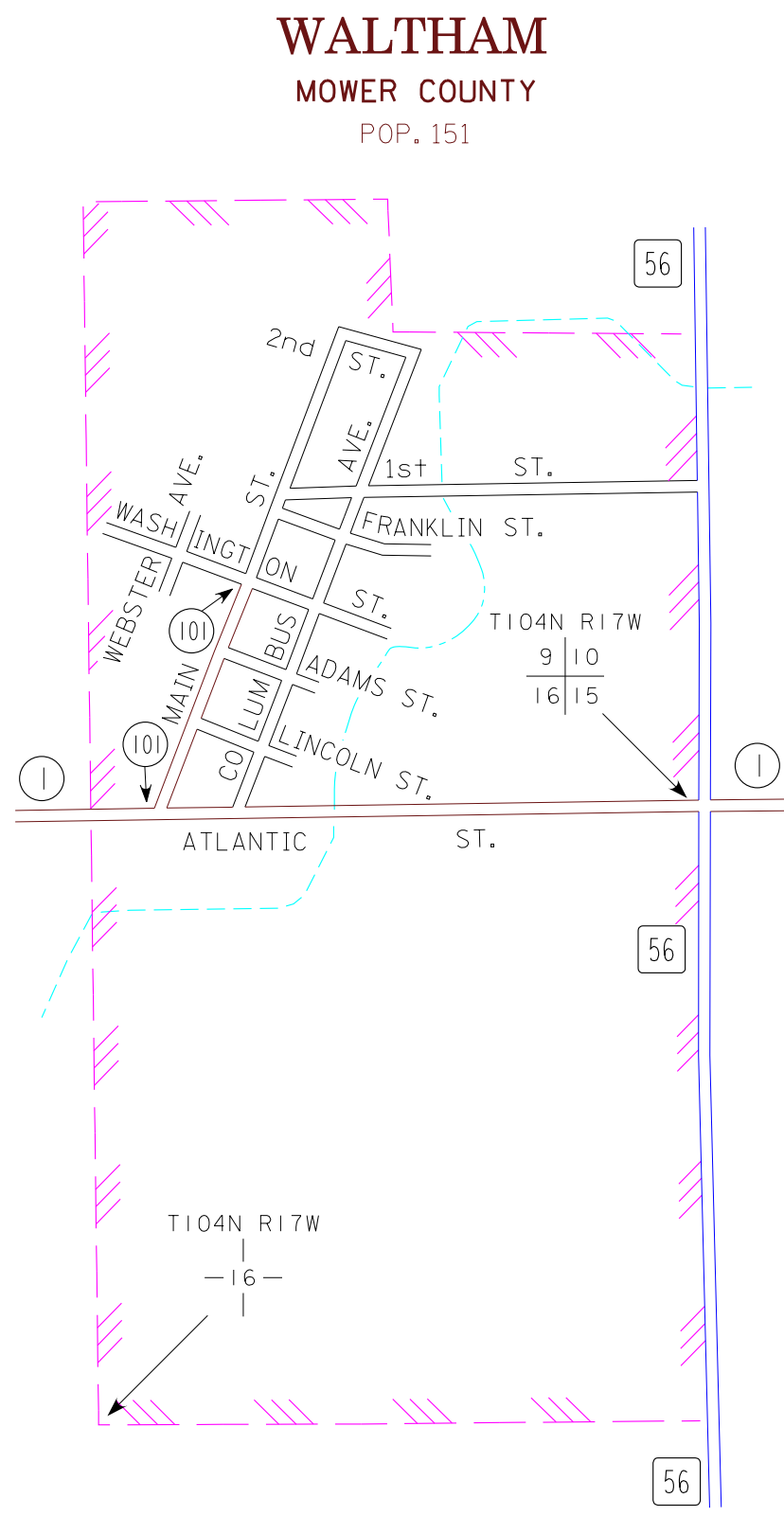
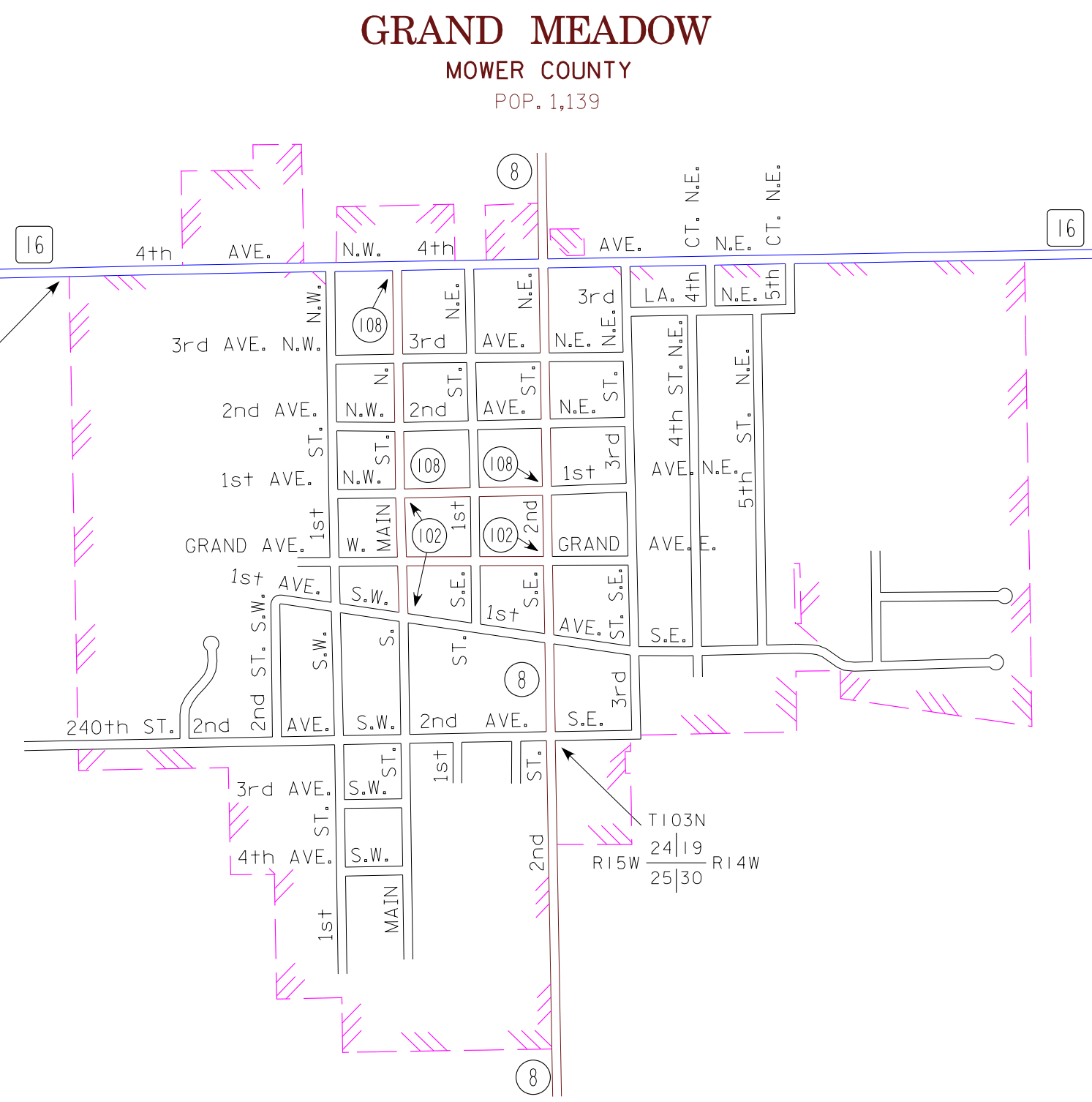
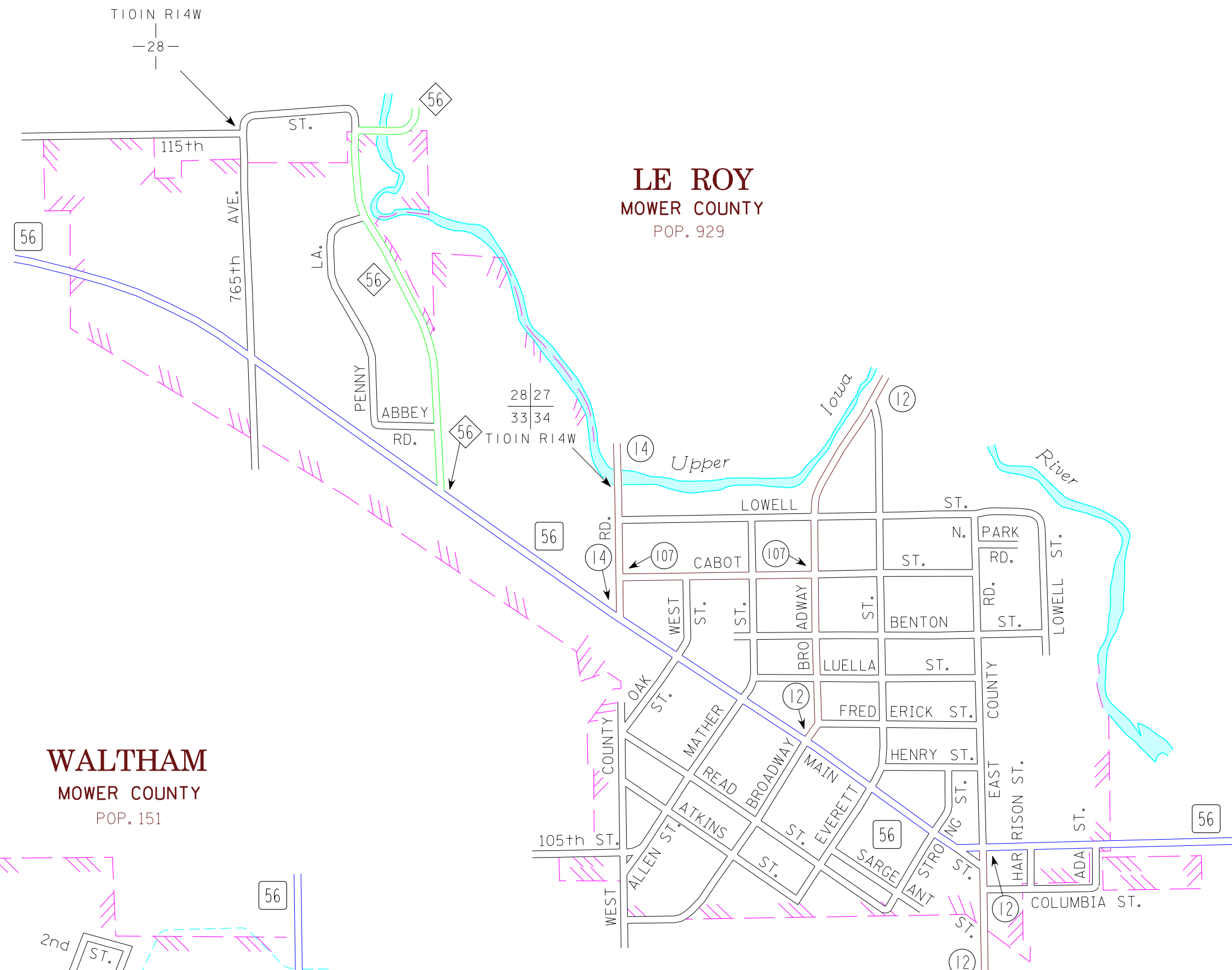

- MUNICIPALITIES SHOWN  
ON THIS SHEET
- ADAMS
  - DEXTER
  - GRAND MEADOW
  - LE ROY
  - TAOPI
  - WALTHAM

To request information from this document in an alternative format, call 651-366-4718 or 1-800-657-3774 (Greater Minnesota); 711 or 1-800-627-3529 (Minnesota Relay). You may also send an e-mail to ADRequest.dor@state.mn.us. (Please request at least one week in advance.)

NOTE: 2010 U.S. CENSUS FIGURES SHOWN FOR ALL MUNICIPALITIES UNLESS OTHERWISE STATED.