

MUNICIPALITY OF  
**SAINT JOSEPH**

PREPARED BY THE  
 MINNESOTA DEPARTMENT OF TRANSPORTATION  
 ENGINEERING SERVICES DIVISION  
 IN COOPERATION WITH  
 U.S. DEPARTMENT OF TRANSPORTATION  
 FEDERAL HIGHWAY ADMINISTRATION

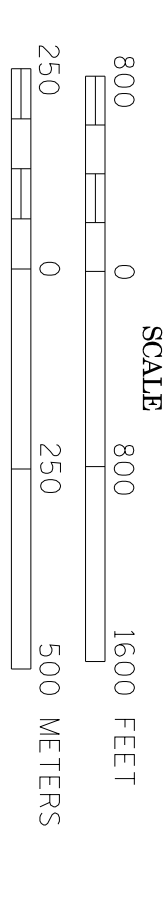

2011  
 BASIC DATA - 2008

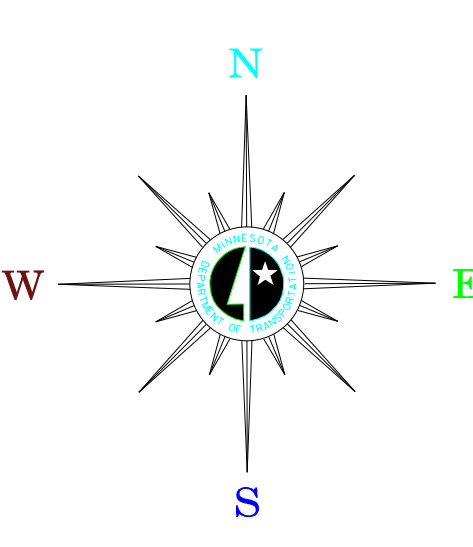

**LEGEND**

- INTERSTATE TRUNK HIGHWAY.....
- U.S. TRUNK HIGHWAY.....
- STATE TRUNK HIGHWAY.....
- COUNTY STATE AID HIGHWAY.....
- COUNTY ROAD.....
- CORPORATE LIMITS.....
- PUBLIC ROAD.....
- PRIVATE ROAD.....

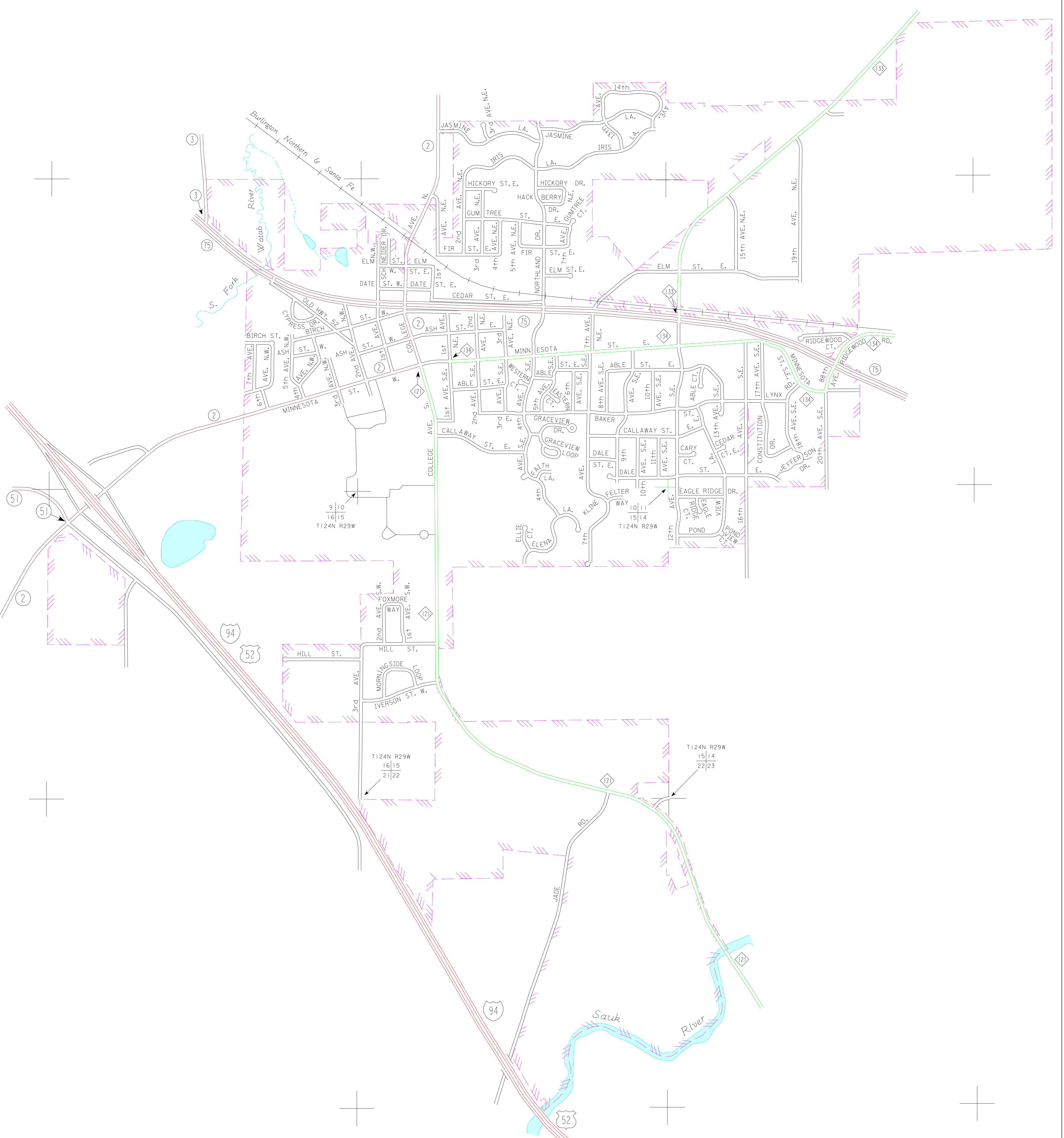

To request information from this document in an alternative format, call 800-552-7773 or 1-800-657-8774 (Outside Minnesota) 771-535-7773. If you are unable to reach us by phone, please request it from our web site (www.mn.gov).