

MUNICIPALITY OF NORTHFIELD

PREPARED BY THE
MINNESOTA DEPARTMENT OF TRANSPORTATION
OFFICE OF TRANSPORTATION DATA & ANALYSIS
IN COOPERATION WITH
U.S. DEPARTMENT OF TRANSPORTATION
FEDERAL HIGHWAY ADMINISTRATION

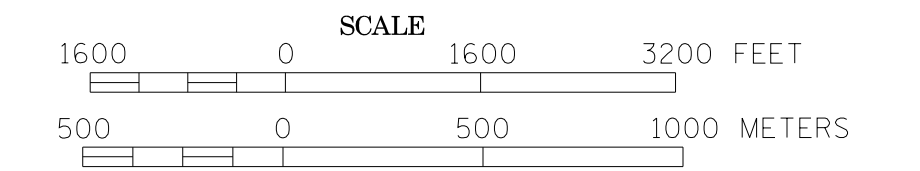

2011
BASIC DATA - 2008

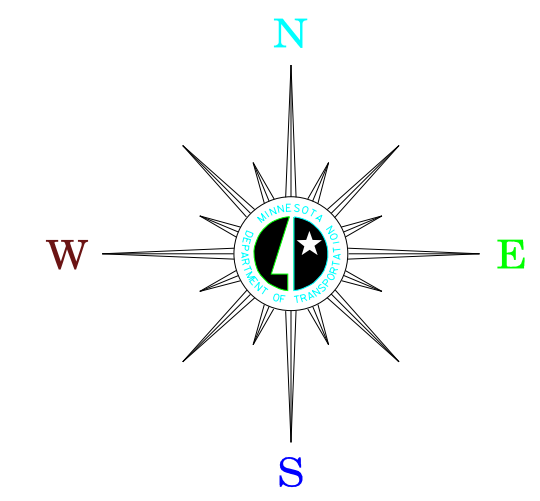

LEGEND

- INTERSTATE TRUNK HIGHWAY..... (35)
- U.S. TRUNK HIGHWAY..... (18)
- STATE TRUNK HIGHWAY..... (55)
- COUNTY STATE AID HIGHWAY..... (23)
- COUNTY ROAD..... (19)
- CORPORATE LIMITS.....
- PUBLIC ROAD.....
- PRIVATE ROAD.....

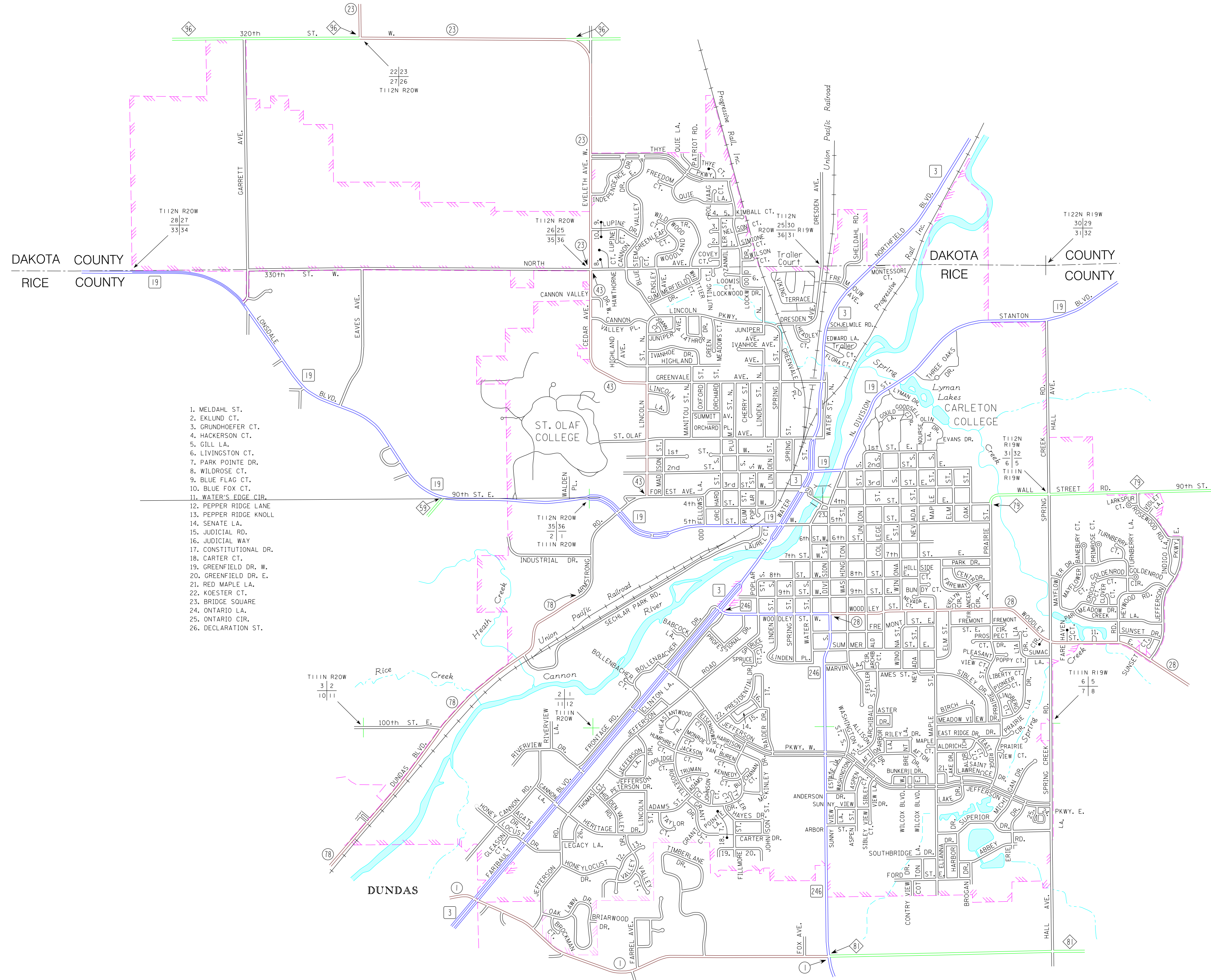

1. MELDAHL ST.
2. EKLUND CT.
3. GRUNDHOEFER CT.
4. HACKERSON CT.
5. OLLI LA.
6. LIVINGSTON CT.
7. PARK POINTE DR.
8. WILDOUSE CT.
9. BLUE FLAG CT.
10. BLUE FOX CT.
11. WATER'S EDGE CIR.
12. PEPPER RIDGE LANE
13. PEPPER RIDGE KNOLL
14. SENATE LA.
15. JUDICIAL RD.
16. JUDICIAL WAY
17. CONSTITUTIONAL DR.
18. CARTER CT.
19. GREENFIELD DR. W.
20. GREENFIELD DR. E.
21. RED MAPLE LA.
22. KOESTER CT.
23. BRIDGE SQUARE
24. ONTARIO LA.
25. ONTARIO CIR.
26. DECLARATION ST.

To request information from this document in an alternative format, call 651-366-4718 or 1-800-657-3774 (Greater Minnesota); 711 or 1-800-627-3529 (Minnesota Relay). You may also send an e-mail to ADArequest.dot@state.mn.us. (Please request at least one week in advance).