

# MUNICIPALITY OF MARSHALL

PREPARED BY THE  
MINNESOTA DEPARTMENT OF TRANSPORTATION  
OFFICE OF TRANSPORTATION DATA & ANALYSIS  
IN COOPERATION WITH  
U.S. DEPARTMENT OF TRANSPORTATION  
FEDERAL HIGHWAY ADMINISTRATION

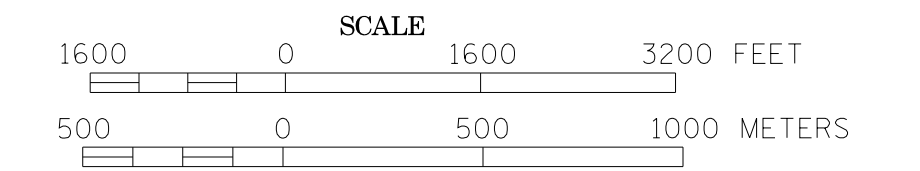

2011  
BASIC DATA - 2009

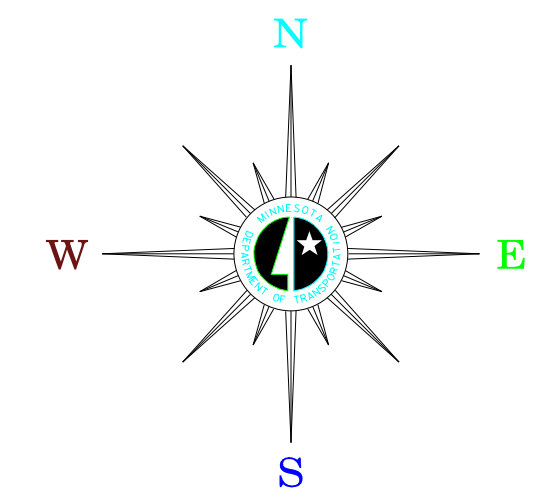

## LEGEND

- INTERSTATE TRUNK HIGHWAY..... (I-35)
- U.S. TRUNK HIGHWAY..... (US-55)
- STATE TRUNK HIGHWAY..... (ST-19)
- COUNTY STATE AID HIGHWAY..... (CSA-23)
- CORPORATE LIMITS..... (Dashed line)
- PUBLIC ROAD..... (Double line)
- PRIVATE ROAD..... (Single line)

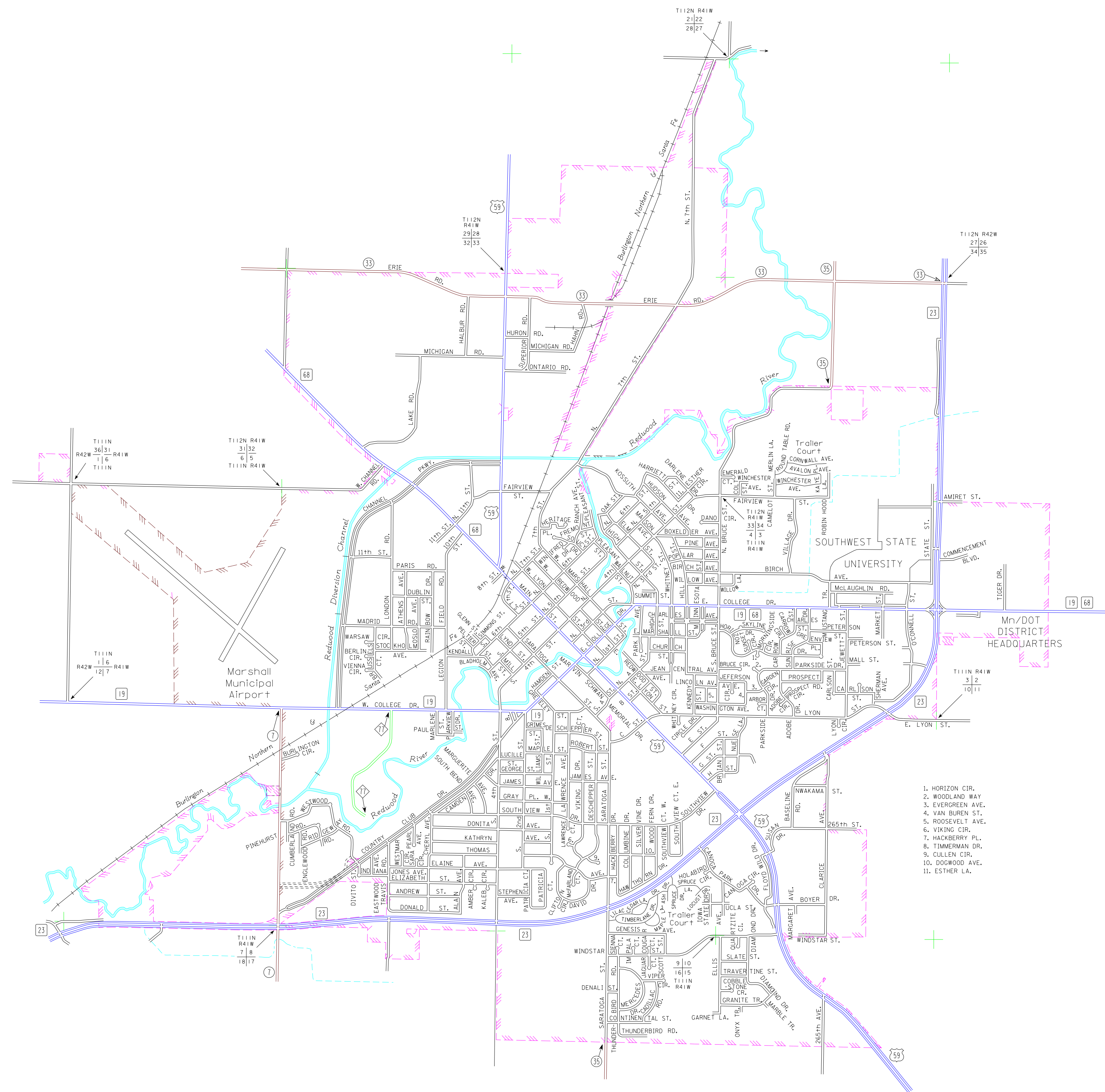

1. HORIZON CIR.
2. WOODLAND WAY.
3. EVERGREEN AVE.
4. VAN BUREN ST.
5. ROOSEVELT AVE.
6. VIKING CIR.
7. HACKBERRY PL.
8. TIMMERMAN DR.
9. CULLEN CIR.
10. DORWOOD AVE.
11. ESTHER LA.

To request information from this document in an alternative format, call 651-366-4718 or 1-800-657-3774 (Greater Minnesota); 711 or 1-800-627-3529 (Minnesota Relay). You may also send an e-mail to: ADRequest@state.mn.us (Please request at least one week in advance).