

MUNICIPALITY OF FERGUS FALLS

PREPARED BY THE
MINNESOTA DEPARTMENT OF TRANSPORTATION
OFFICE OF TRANSPORTATION DATA & ANALYSIS
IN COOPERATION WITH
U.S. DEPARTMENT OF TRANSPORTATION
FEDERAL HIGHWAY ADMINISTRATION

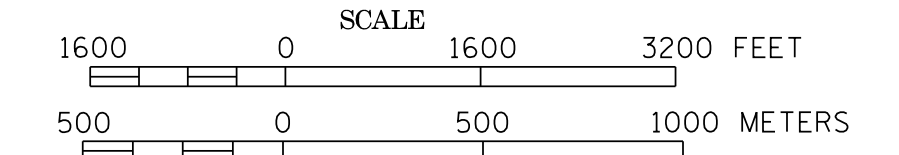

2011
BASIC DATA - 2010

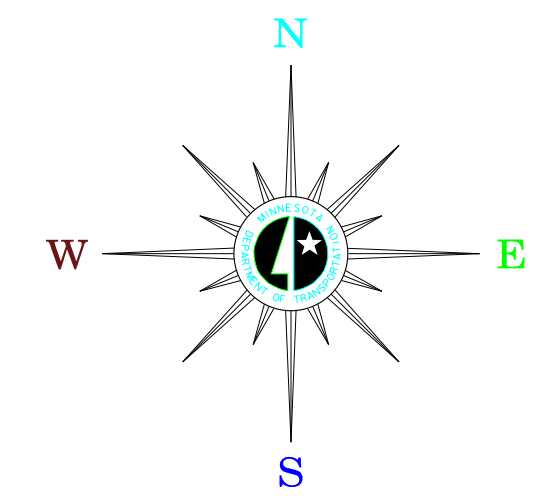

LEGEND

- INTERSTATE TRUNK HIGHWAY..... (35)
- U.S. TRUNK HIGHWAY..... (10)
- STATE TRUNK HIGHWAY..... (55)
- COUNTY STATE AID HIGHWAY..... (23)
- COUNTY ROAD..... (5)
- CORPORATE LIMITS.....
- PUBLIC ROAD.....
- PRIVATE ROAD.....

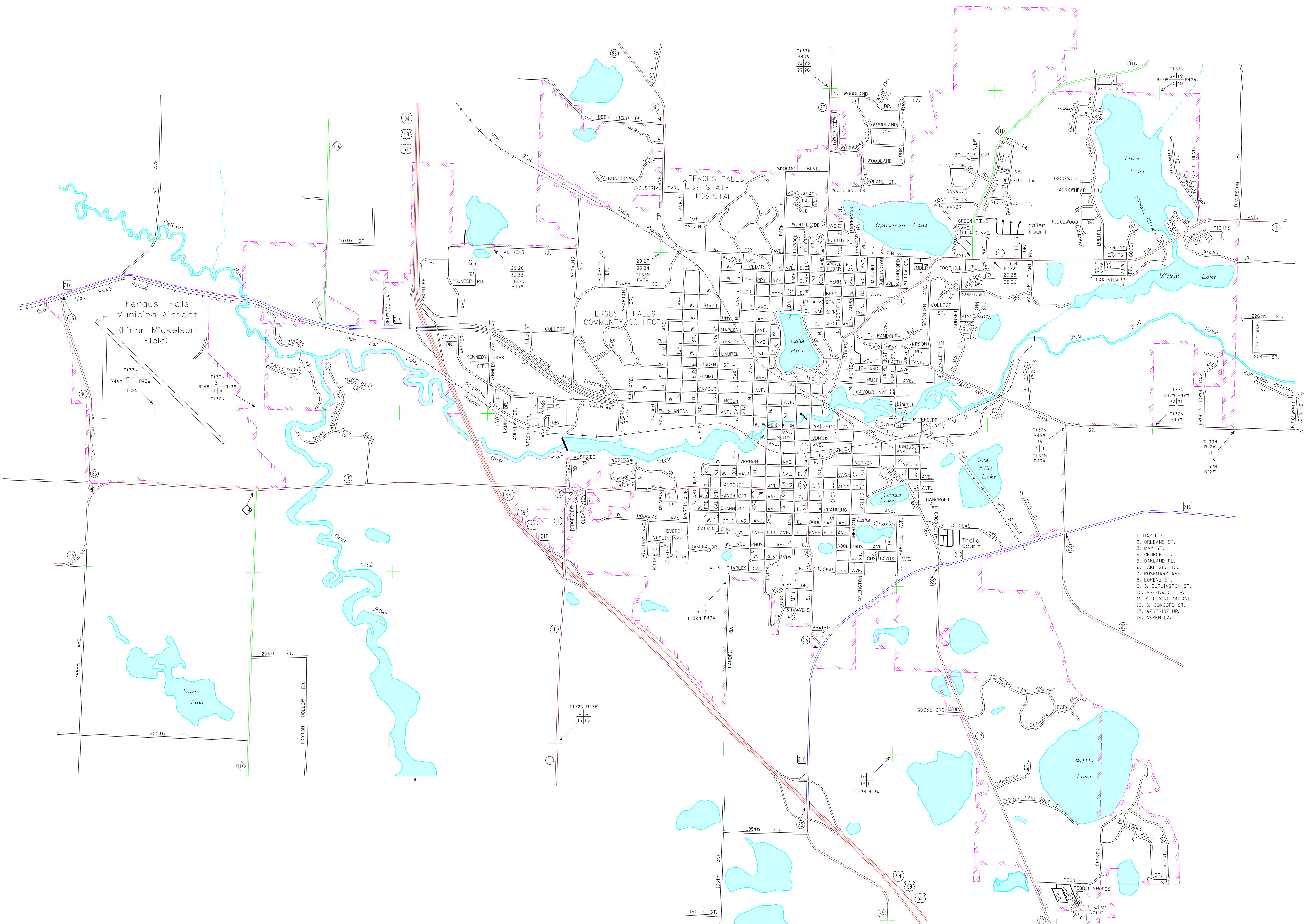

1. HAZEL ST.
2. ORLEANS ST.
3. MAY ST.
4. CHURCH ST.
5. OAKLAND PL.
6. LAKE SIDE DR.
7. ROSEMARY AVE.
8. LORENZ ST.
9. S. BURLINGTON TR.
10. ASPENWOOD TR.
11. S. LEXINGTON AVE.
12. S. CONCORD ST.
13. WESTSIDE DR.
14. ASPEN LA.

To request information from this document in an alternative format, call 651-366-4718 or 1-800-657-3774 (Greater Minnesota); 711 or 1-800-627-3529 (Minnesota Relay). You may also send an e-mail to ADRequest.dot@state.mn.us. (Please request at least one week in advance.)