

LAYOUT HISTORY

THIS LAYOUT IS BASED ON A PRELIMINARY LAYOUT CONCEPT DEVELOPED BY MNDOT TO CONVERT A BYPASS LANE TO A LOCAL LEFT TURN LANE. THE LAYOUT IS BASED ON A LAYOUT DEVELOPED BY MNDOT FOR THE TH 60 AT THE INTERSECTION OF CSAH 48.

ALL COMMENTS ON THIS LAYOUT, BASED ON A LAYOUT SUBMITTED ON 08-29-2018, HAVE ALSO BEEN INCORPORATED.

S.P. 4006-35
**T.H. 60 LAKE CONNECTION PROJECT
 PRELIMINARY LAYOUT**
 CSAH 48 / ORIOLE ROAD
 EAST OF MADISON LAKE, MN



01/15/2019


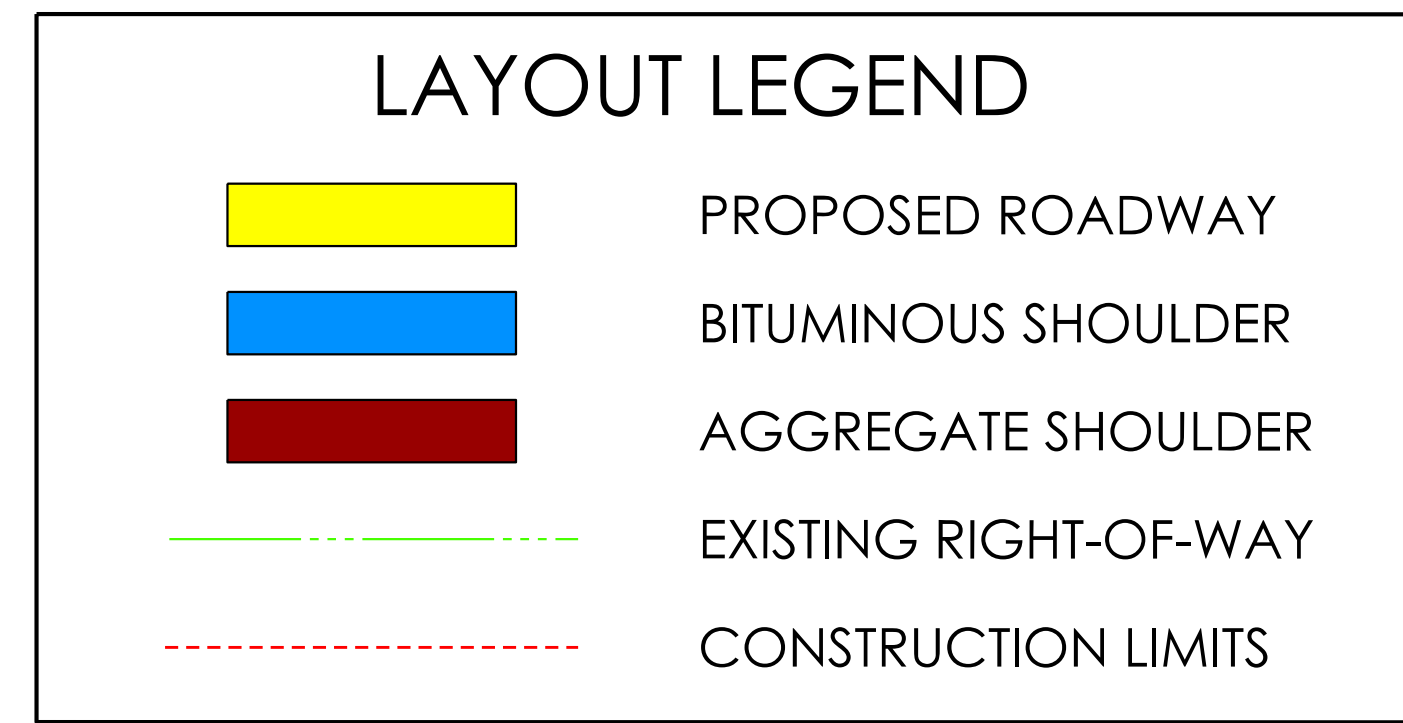
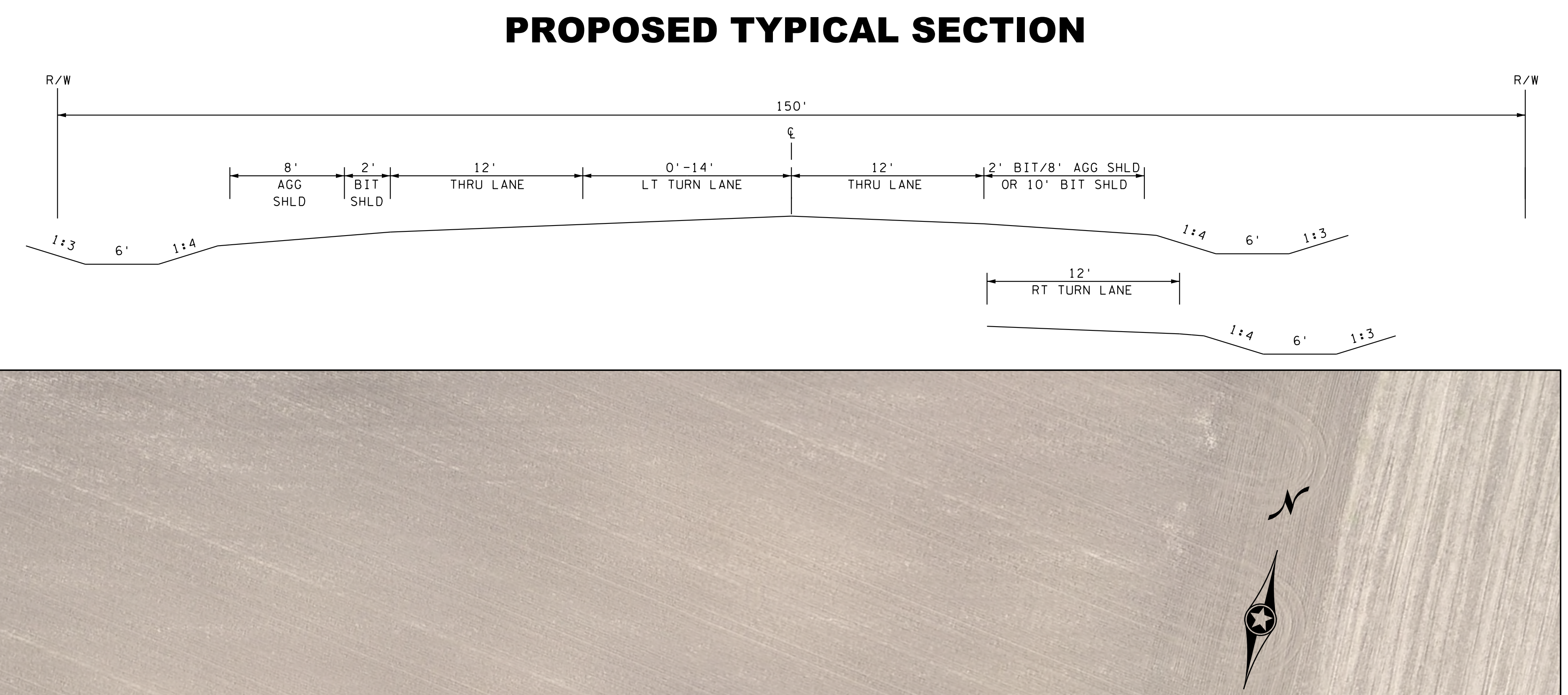
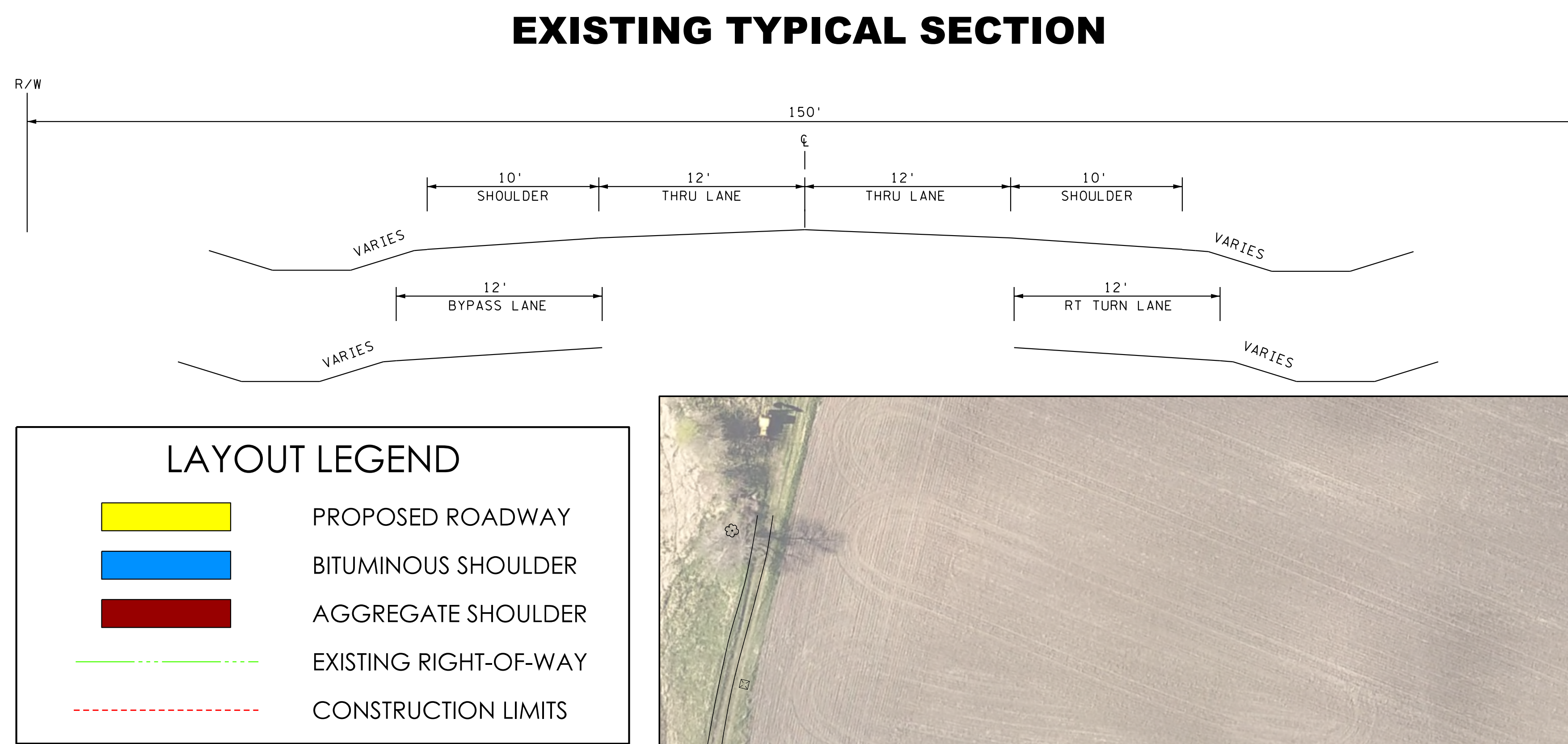
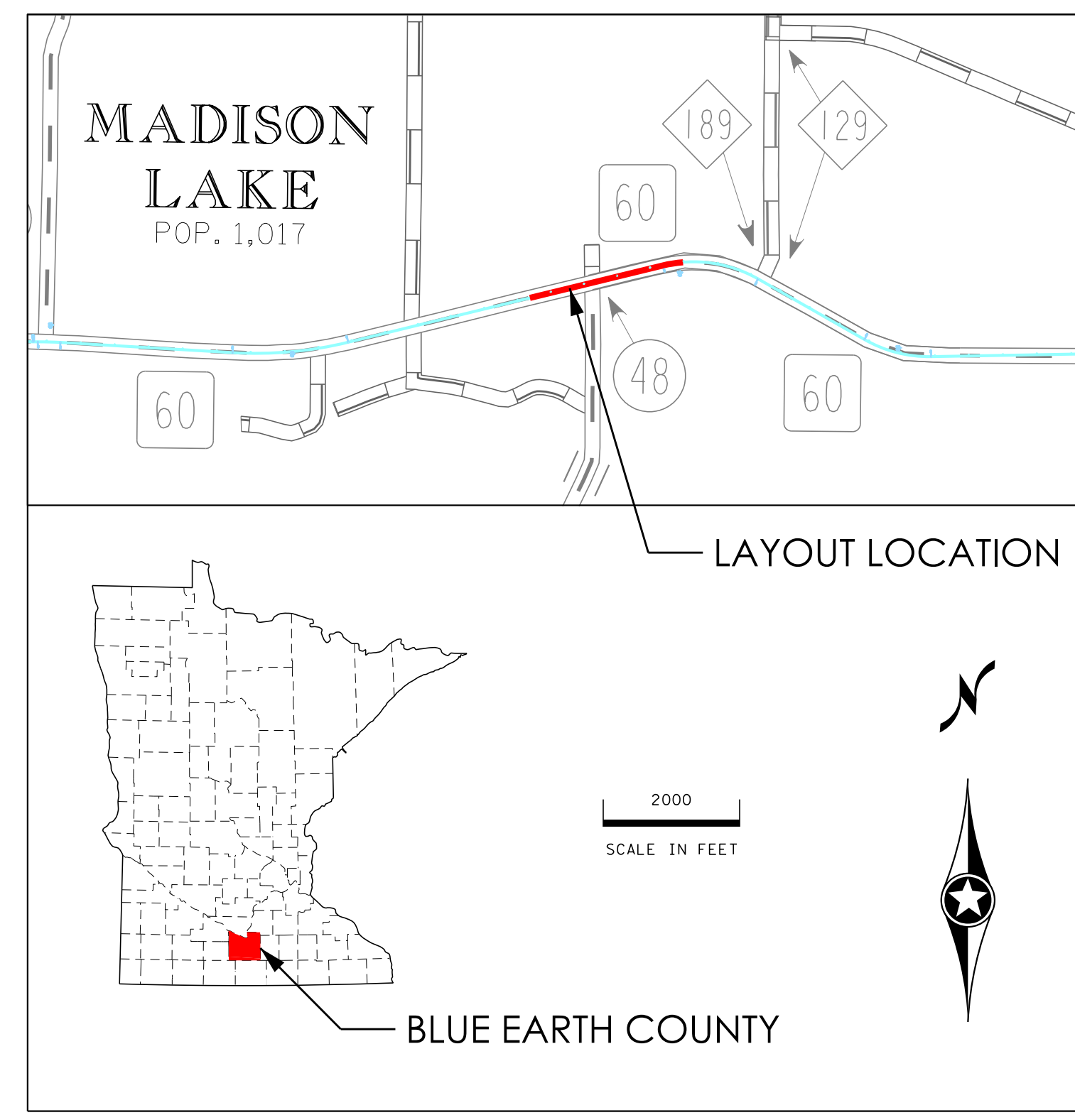

Level 2 LAYOUT APPROVAL

Programmed Letting Date: December 18, 2020
 Prepared By: [Signature] RL/A
 Reviewed By: [Signature] Z/A
 Reviewed By: [Signature] RL/L
 Approved By: [Signature] RL/L

I HEREBY CERTIFY THAT THIS LAYOUT WAS PREPARED BY ME OR UNDER MY DIRECT SUPERVISION AND THAT I AM A LICENSED PROFESSIONAL ENGINEER UNDER THE LAWS OF THE STATE OF MINNESOTA.
 NAME: [Signature] LIC. NO. 57867 DATE: 01/15/2019

LAYOUT No. 1 COPY No. 1
 T.H. 60 VICINITY OF MADISON LAKE
 FROM 900' WEST OF CSAH 48 TO 1400' EAST
 OF CSAH 48
 Prepared January 15, 2019 Scale: Hor. 1 inch = 50 ft.
 By: [Signature] This traffic volume shown on this map is tentative and subject to change without notice.
 S.P. 4006-35 T.H. 60 A.U. PMS ACTIVITY
 S.P. T.H. A.U. PMS ACTIVITY
 S.P. T.H. A.U. PMS ACTIVITY
 Copy To: For:

