

STAGE 3B DETOUR

STAGE 3B TRAFFIC

- 1. THE TEMPORARY SIGNAL SYSTEMS AT THE INTERSECTION OF T.H. 75 AND 24TH AVENUE SOUTH AND THE INTERSECTION OF 20TH STREET AND 24TH AVENUE SOUTH SHALL BE REVISED TO ACCOMMODATE STAGE 3B TRAFFIC.
- 2. A SINGLE LANE OF TRAFFIC WILL BE OPEN FROM T.H. 94 E.B. TO T.H. 75 S.B., UTILIZING THE NEW CONSTRUCTION COMPLETED IN STAGE 3A.
- 3. T.H. 75 S.B. WILL BE CLOSED FROM 24TH AVENUE SOUTH TO THE SOUTH CROSSOVER, INCLUDING THE N.W. RAMP.
- 4. A SINGLE LANE OF TRAFFIC WILL BE OPEN ON T.H. 75 N.B. FROM 30TH AVENUE SOUTH TO THE ON RAMP FOR T.H. 94 E.B., USING THE EASTERN MOST LANE OF THE NEW CONSTRUCTION FROM STAGE 2.
- 5. THE T.H. 94 W.B. OFF RAMP TO T.H. 75 N.B. WILL BE OPEN. T.H. 75 N.B. WILL BE IN FULL OPERATION FROM THE NORTH CROSSOVER TO 24TH AVENUE SOUTH UTILIZING NEW CONSTRUCTION COMPLETED IN STAGE 2.
- 6. THE T.H. 94 E.B. OFF RAMP TO T.H. 75 S.B. WILL BE OPEN. T.H. 75 N.B. WILL BE IN FULL OPERATION FROM THE SOUTH CROSSOVER TO 30TH AVENUE SOUTH UTILIZING NEW CONSTRUCTION COMPLETED IN STAGE 3A.
- 7. TRAFFIC WILL BE REDUCED TO A SINGLE LANE ON T.H. 94 W.B. FROM T.H. 94 W.B. STA. 310+00.00 TO 322+00.00. SEE SPECIAL PROVISIONS FOR ACCEPTABLE CLOSURE TIMES.
- 8. TRAFFIC WILL NOT BE ALLOWED TO CROSS INPLACE BRIDGES 14813 AND 14814.
- 9. SEE SPECIAL PROVISIONS FOR TEMPORARY PEDESTRIAN ACCESS REQUIREMENTS.

STAGE 3B CONSTRUCTION

- 1. CONSTRUCT THE N.W. RAMP.
- 2. CONSTRUCT T.H. 75 S.B. FROM THE NORTH CROSSOVER TO 24TH AVENUE SOUTH.
- 3. CONSTRUCT THE WESTERN SPLITTER ISLAND FOR THE NORTH CROSSOVER AND THE LEFT TURN LANE FROM T.H. 75 N.B. TO T.H. 94 W.B. ON RAMP.

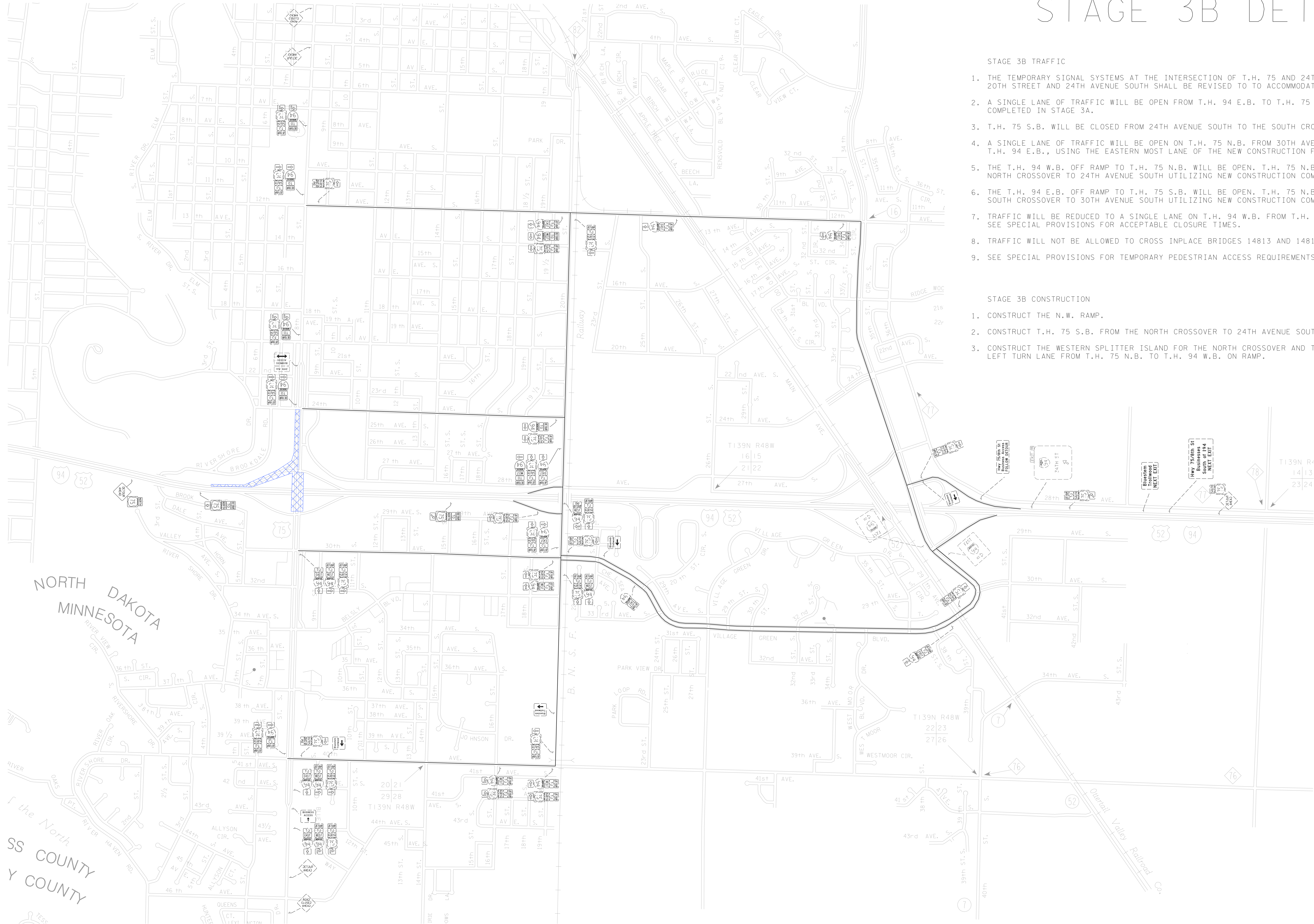

DETOUR ROUTE STAGE 3B