

BICYCLE MAP  
REDWOOD  
COUNTY  
MINNESOTA

PREPARED BY THE  
MINNESOTA DEPARTMENT OF TRANSPORTATION  
OFFICE OF TRANSPORTATION SYSTEM MANAGEMENT

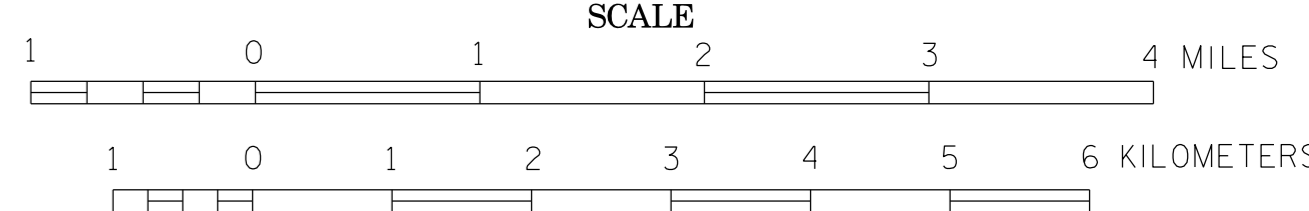

2016

BASIC DATA - 2015

Projections  
Minnesota Coordinate System  
South Zone  
Lambert Conformal Conic  
North American Datum  
of 1983

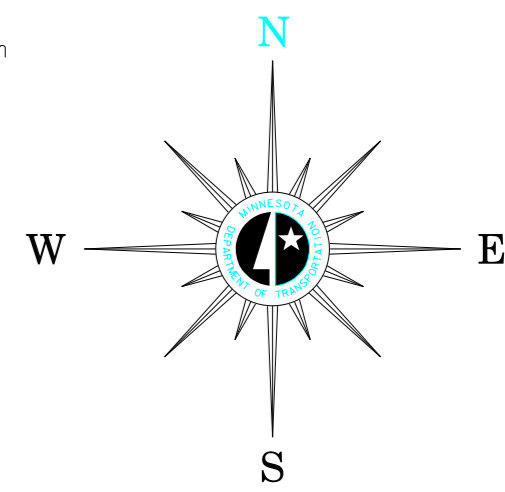

LEGEND

(Roadways with shoulders less than 4 feet)	(Roadways with shoulders greater than 4 feet)
0-750 (Fewer than 3 cars / min)	751-2500 (3 cars / min)
751-2500 (3 cars / min)	2501-10,000 (12 cars / min)
2501-10,000 (12 cars / min)	10,000+ (24+ cars / min)
Gravel Roadway	
Federal, State and Regional Bicycle Trails	
Mississippi River Trail	
Interstate / Bicycles Prohibited	
State or National Forests	

ROAD AND ROADWAY FEATURES

PROJECTED ROAD	.....
PRIMITIVE ROAD	.....
UNIMPROVED ROAD	.....
GRADED AND DRAINED ROAD	.....
SOIL SURFACE ROAD	.....
GRAVEL OR STONE ROAD	.....
BITUMINOUS ROAD	.....
PAVED ROAD	.....
DIVIDED ROAD	.....
TRUNK HIGHWAY UNDER CONSTRUCTION	.....
ROADS IN UNINCORPORATED COMPACTS, EXTENSIONS OF LOCAL ROADS (NOT F.A.S.J. WITHIN MUNICIPALITIES AND FRONTAGE ROADS)	.....
GRADE SEPARATION	.....
FULL TRAFFIC INTERCHANGES	.....
PARTIAL TRAFFIC INTERCHANGES INDICATING TRAFFIC MOVEMENT	.....

ROAD SYSTEM DESIGNATIONS

INTERSTATE TRUNK HIGHWAY	.....
U.S. NUMBERED TRUNK HIGHWAY	.....
STATE NUMBERED TRUNK HIGHWAY	.....
COUNTY STATE AID HIGHWAY	.....
COUNTY ROAD	.....
COUNTY STATE AID IN ADJOINING COUNTY	.....
TERMINATION OF DESIGNATED ROUTE	.....

BOUNDARIES

NATIONAL OR STATE	.....
COUNTY	.....
CIVIL TOWNSHIP	.....
CONGRESSIONAL TOWNSHIP (U.S. LAND)	.....
CORPORATE LINE	.....
SECTION LINE	.....
CONGESTED AREA	.....
INDIAN RESERVATION	.....

DRAINAGE

INTERMITTENT STREAM	.....
NARROW STREAM	.....
WIDE STREAMS	.....
MARSH OR SWAMP LAND	.....
DRAINAGE DITCH	.....
LAKE OR POND	.....

CITY CENTERS

STATE CAPITAL	.....
COUNTY SEAT	.....
CITY CENTER	.....
INCORPORATED CITY (GENERALIZED)	.....

Outline Map of Minnesota showing  
location of the County within the State.  
Area of this County: 881 Sq. Miles  
2010 Total County Population: 16,039

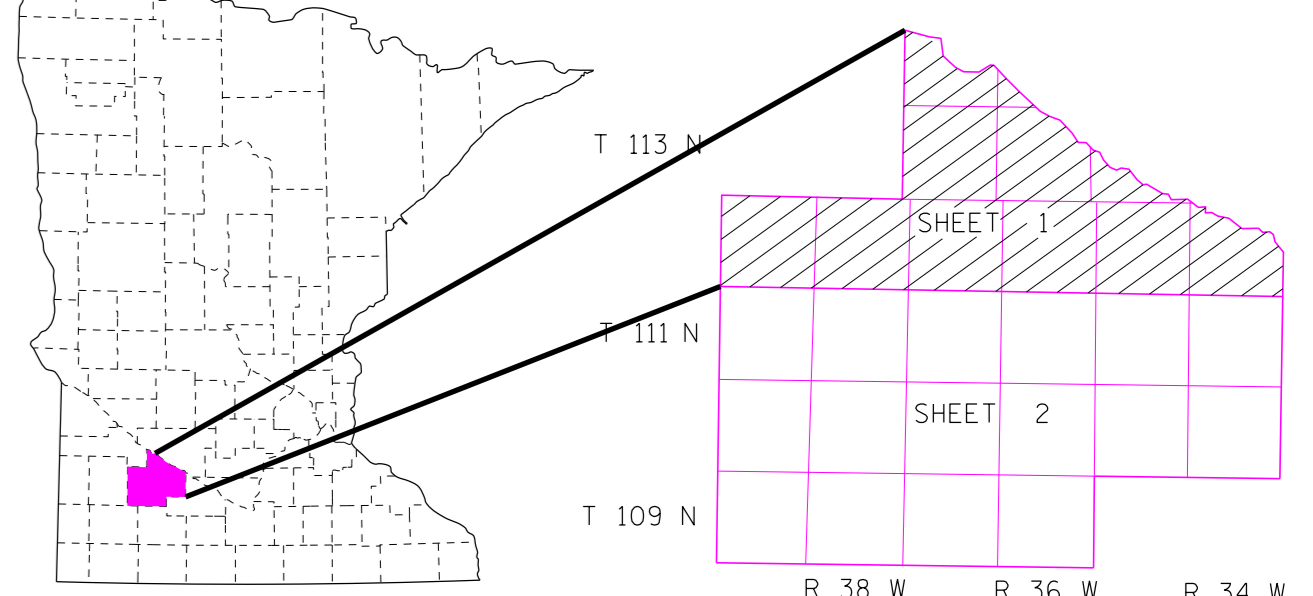

To request information from this document in an alternative format,  
call 855-368-4718 or 1-800-657-3774 (Greater Minnesota).  
711 or 1-800-627-3539 (Minnesota Relay). You may also send  
an e-mail to [ADArequest@state.mn.us](mailto:ADArequest@state.mn.us).  
(Please request at least one week in advance.)

NOTE: FOR DETAIL OF COUNTY STATE AID HIGHWAYS AND COUNTY  
ROADS IN INCORPORATED PLACES, SEE MAPS OF MUNICIPALITIES.

BICYCLE MAP  
REDWOOD  
COUNTY  
MINNESOTA

PREPARED BY THE  
MINNESOTA DEPARTMENT OF TRANSPORTATION  
OFFICE OF TRANSPORTATION SYSTEM MANAGEMENT

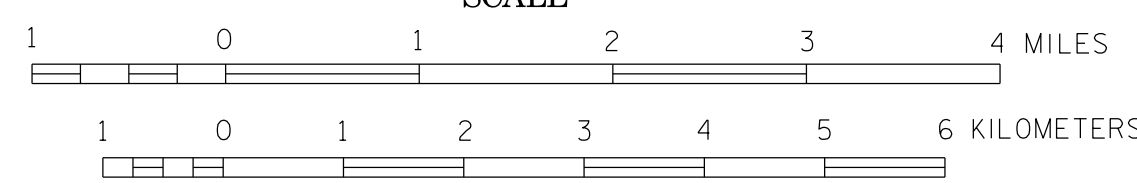

2016

BASIC DATA - 2015

Projections  
Minnesota Coordinate System  
South Zone  
Lambert Conformal Conic

N

E

W

S

LEGEND

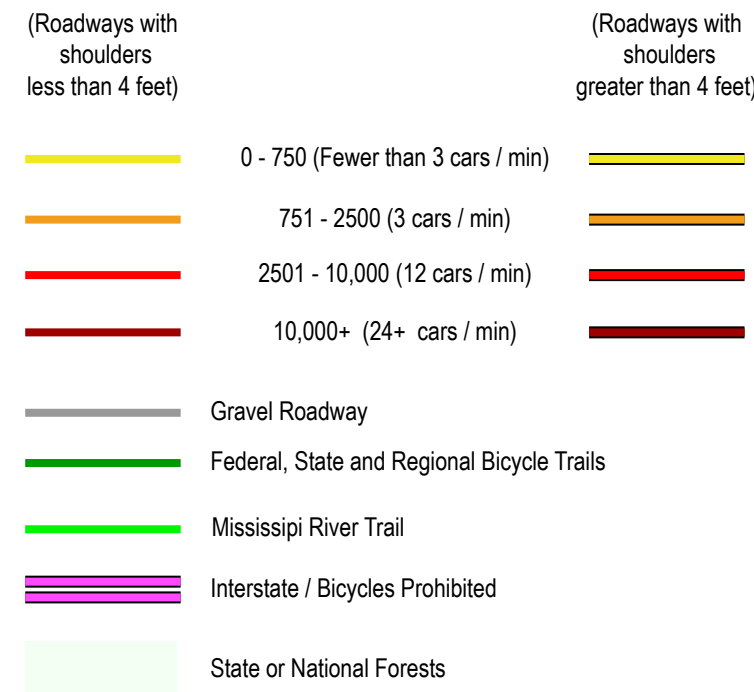

ROAD AND ROADWAY FEATURES

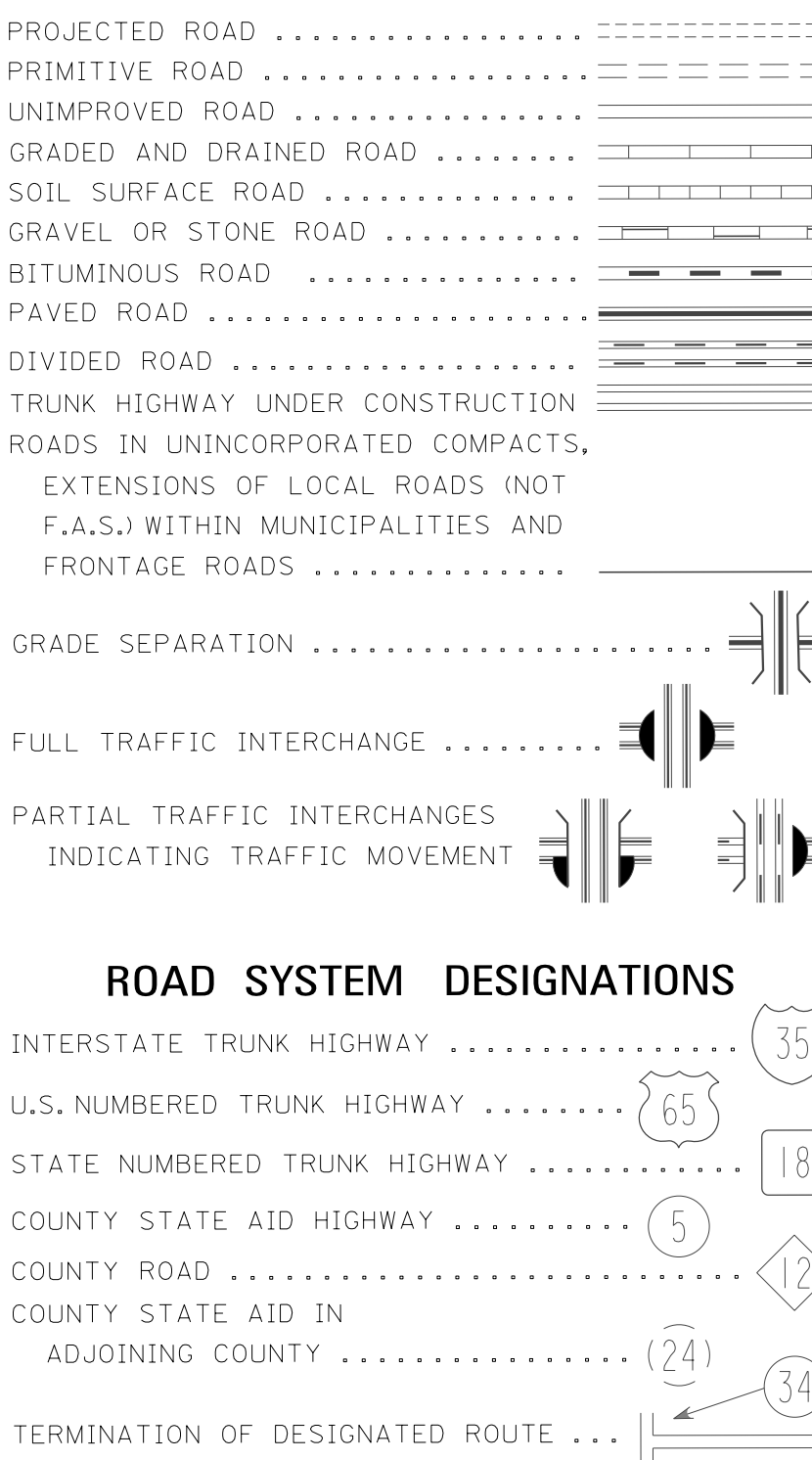

BOUNDARIES

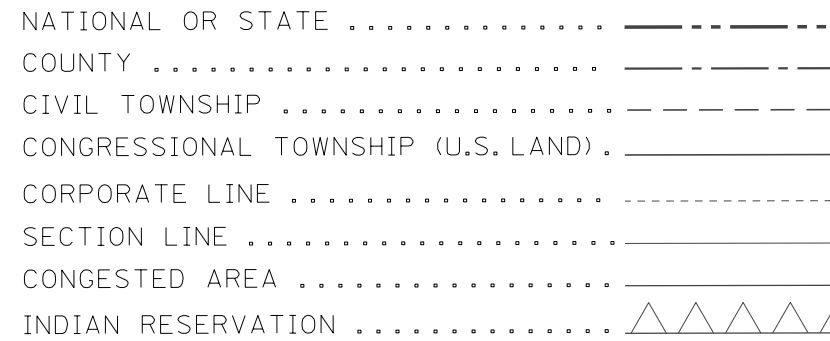

DRAINAGE

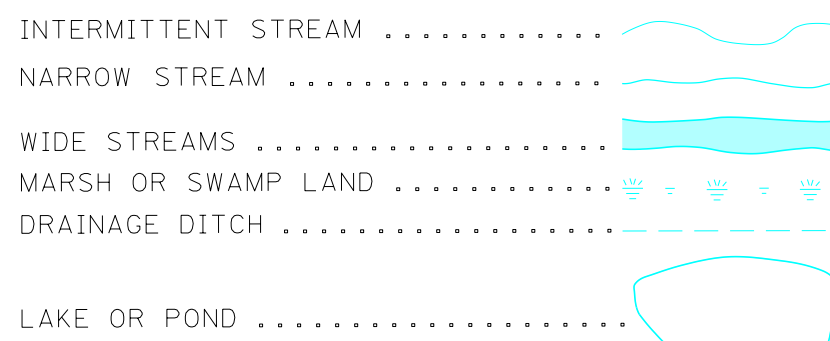

CITY CENTERS

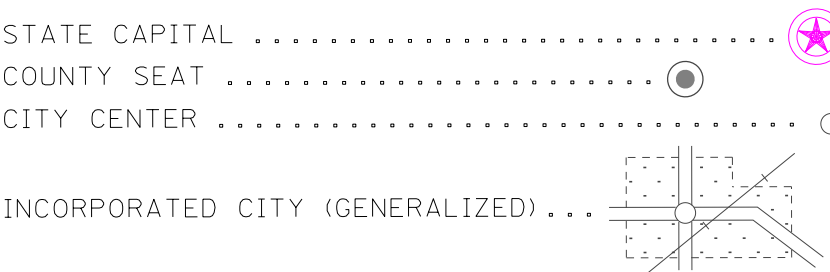

Outline Map of Minnesota showing location of the County within the State.

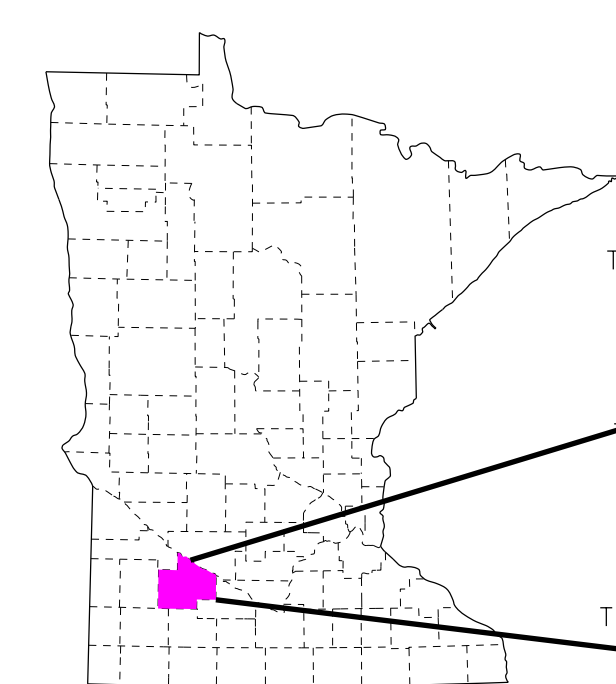

Outline Map of the County. Shaded portion is area delineated on this sheet.

Area of this County 881 Sq. Miles  
Land Area 881 Sq. Miles  
2010 Total County Population 16,099

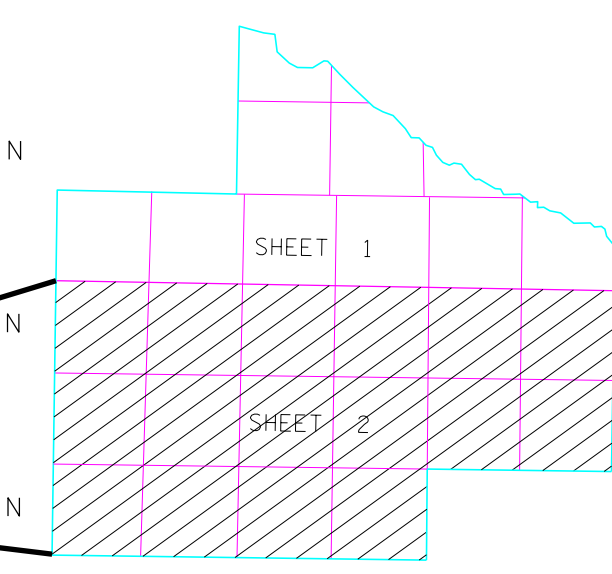

SHEET 2 OF 2

To request information from this document in an alternative format, call 651-399-4718 or 1-800-657-3176 (Greater Minnesota), 711 or 1-800-627-3529 (Minnesota Relay). You may also send an e-mail to [ADRequest@dot.state.mn.us](mailto:ADRequest@dot.state.mn.us). (Please request at least one week in advance.)

NOTE: FOR DETAIL OF COUNTY STATE AID HIGHWAYS AND COUNTY ROADS IN INCORPORATED PLACES, SEE MAPS OF MUNICIPALITIES.