

BICYCLE MAP BECKER COUNTY MINNESOTA

PREPARED BY THE
MINNESOTA DEPARTMENT OF TRANSPORTATION
OFFICE OF TRANSPORTATION SYSTEM MANAGEMENT

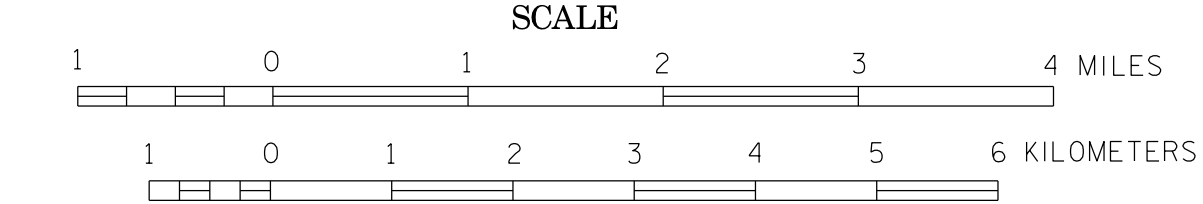

2016
BASIC DATA - 2015
Projection: Minnesota Coordinate System
Central Zone
Lambert Conformal Conic
North American Datum of 1983

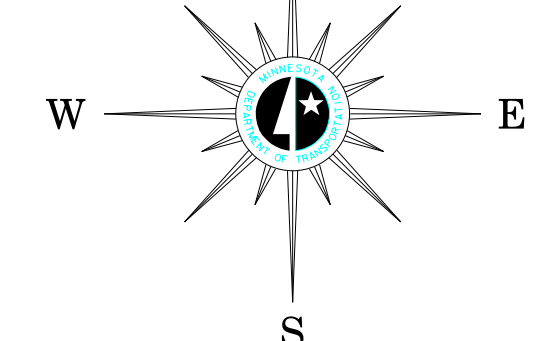

LEGEND

- | | |
|--|---|
| (Roadways with shoulders less than 4 feet) | (Roadways with shoulders greater than 4 feet) |
| 0-750 (Fewer than 3 cars / min) | 751-2500 (3 cars / min) |
| 2501-10,000 (12 cars / min) | 10,000+ (24+ cars / min) |
| Gravel Roadway | Federal, State and Regional Bicycle Trails |
| Mississippi River Trail | Interstate / Bicycles Prohibited |
| State or National Forests | |

ROAD AND ROADWAY FEATURES

- PROJECTED ROAD
- PRIMITIVE ROAD
- UNIMPROVED ROAD
- GRADED AND DRAINED ROAD
- SOIL SURFACE ROAD
- GRAVEL OR STONE ROAD
- BITUMINOUS ROAD
- PAVED ROAD
- DIVIDED ROAD
- TRUNK HIGHWAY UNDER CONSTRUCTION
- ROADS IN UNINCORPORATED COMPACTS, EXTENSIONS OF LOCAL ROADS (NOT F.A.S. WITHIN MUNICIPALITIES AND FRONTAGE ROADS)
- GRADE SEPARATION
- FULL TRAFFIC INTERCHANGE
- PARTIAL TRAFFIC INTERCHANGES INDICATING TRAFFIC MOVEMENT

ROAD SYSTEM DESIGNATIONS

- INTERSTATE TRUNK HIGHWAY
- U.S. NUMBERED TRUNK HIGHWAY
- STATE NUMBERED TRUNK HIGHWAY
- COUNTY STATE AID HIGHWAY
- COUNTY ROAD
- COUNTY STATE AID IN ADJOINING COUNTY
- TERMINATION OF DESIGNATED ROUTE

BOUNDARIES

- NATIONAL OR STATE
- COUNTY
- CIVIL TOWNSHIP
- CONGRESSIONAL TOWNSHIP (U.S. LAND)
- CORPORATE LINE
- SECTION LINE
- CONGESTED AREA
- INDIAN RESERVATION

DRAINAGE

- INTERMITTENT STREAM
- NARROW STREAM
- WIDE STREAM
- MARSH OR SWAMP LAND
- DRAINAGE DITCH
- LAKE OR POND

CITY CENTERS

- STATE CAPITAL
- COUNTY SEAT
- CITY CENTER
- INCORPORATED CITY (GENERALIZED)

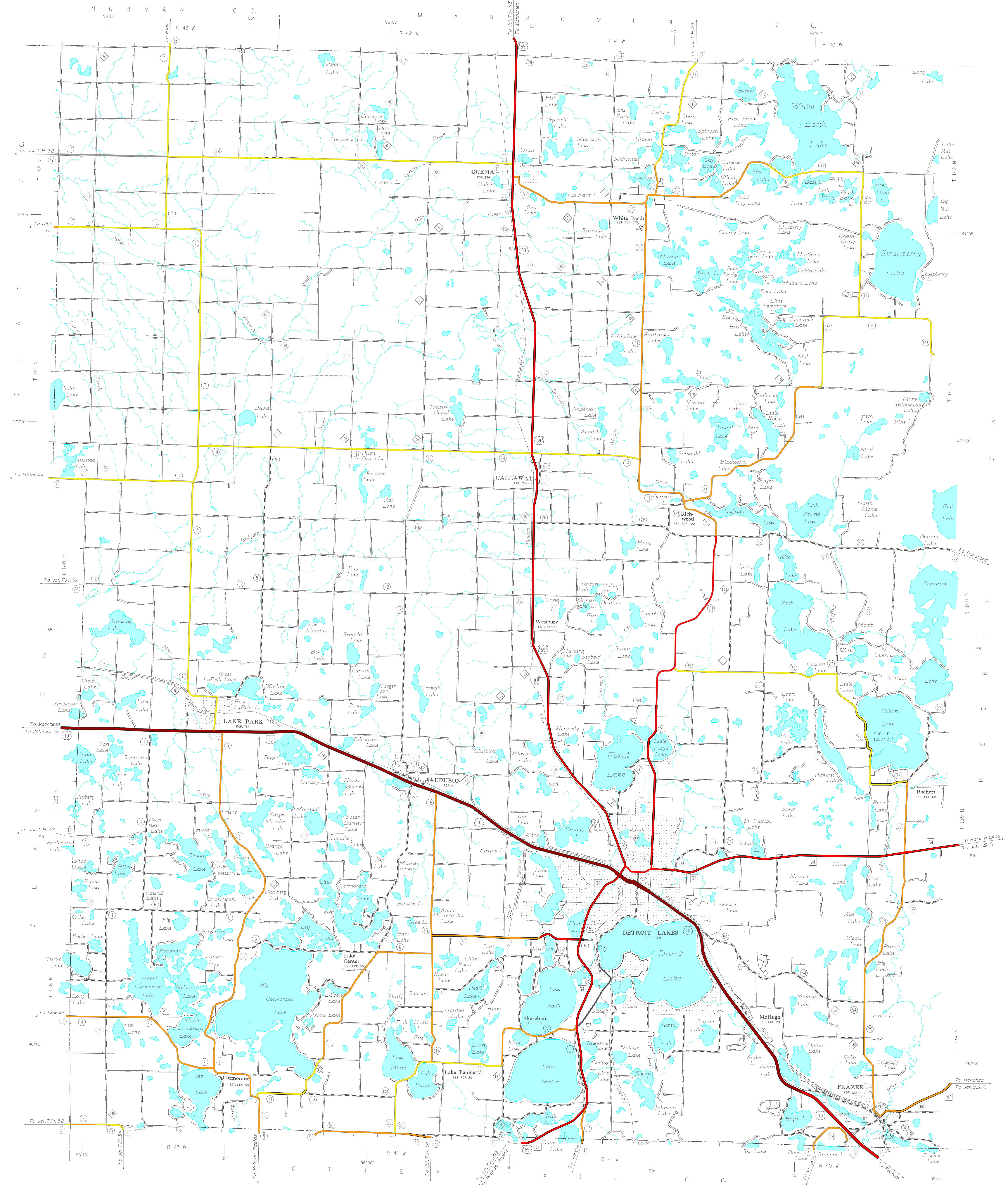
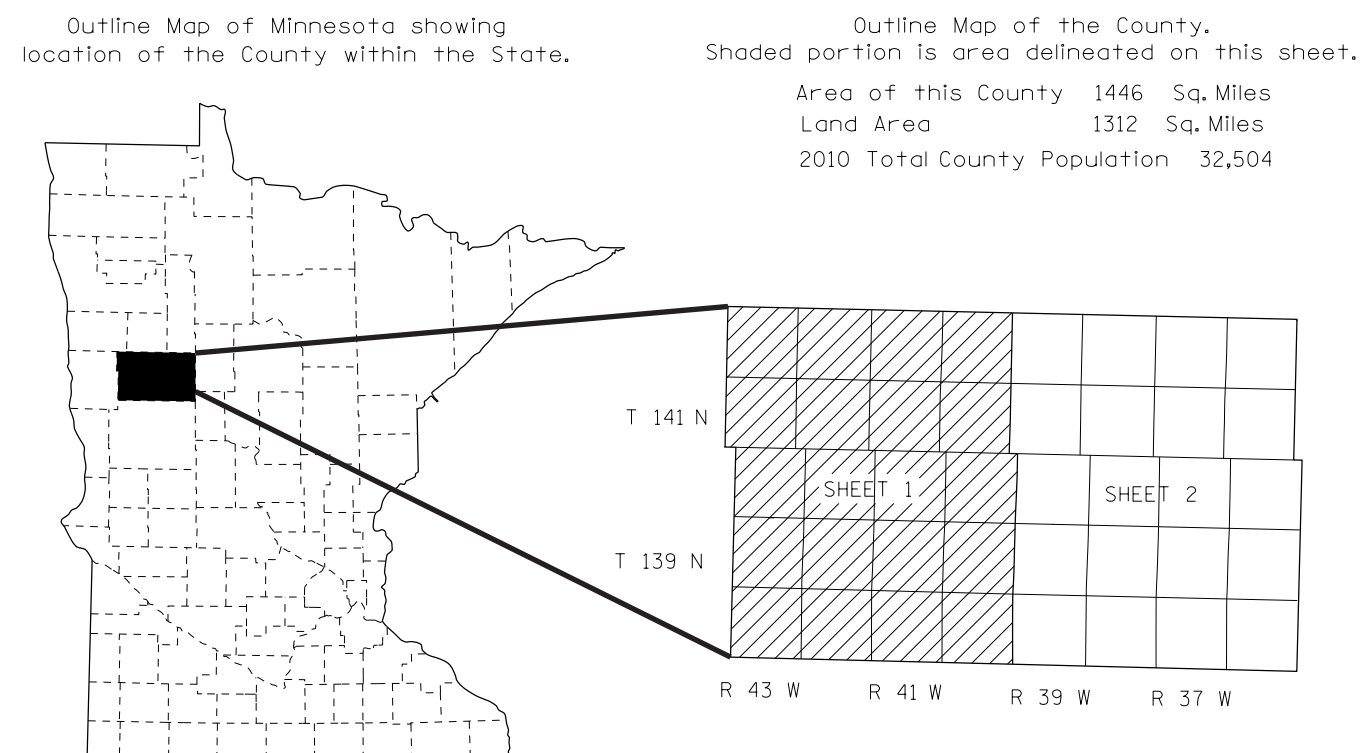

NOTE: FOR DETAIL OF COUNTY STATE AID HIGHWAYS AND COUNTY ROADS IN INCORPORATED PLACES, SEE MAPS OF MUNICIPALITIES.

BICYCLE MAP BECKER COUNTY MINNESOTA

PREPARED BY THE
MINNESOTA DEPARTMENT OF TRANSPORTATION
OFFICE OF TRANSPORTATION SYSTEM MANAGEMENT

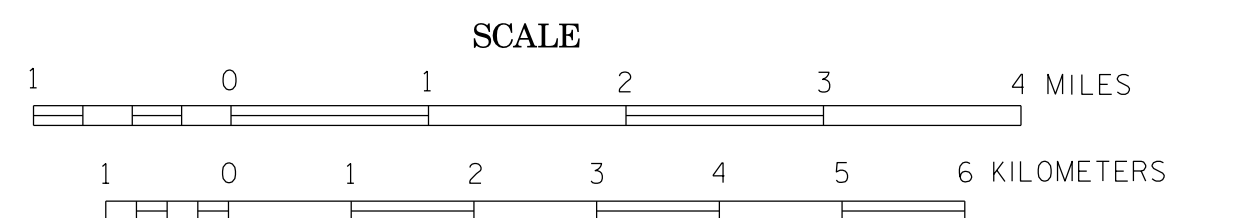

2016
BASIC DATA - 2015

Projections: Minnesota Coordinate System, Central Zone, Lambert Conformal Conic
North American Datum of 1983

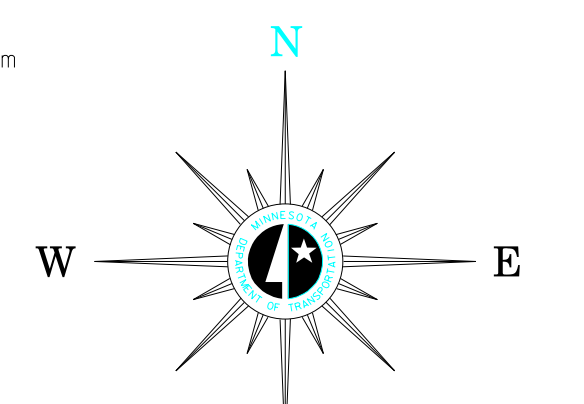

LEGEND

- (Roadways with shoulders less than 4 feet)
- (Roadways with shoulders greater than 4 feet)
- 0-750 (Fewer than 3 cars / min)
- 751-2500 (3 cars / min)
- 2501-10,000 (12 cars / min)
- 10,000+ (24+ cars / min)
- Gravel Roadway
- Federal, State and Regional Bicycle Trails
- Mississippi River Trail
- Interstate / Bicycles Prohibited
- State or National Forests

ROAD AND ROADWAY FEATURES

- PROJECTED ROAD
- PRIMITIVE ROAD
- UNIMPROVED ROAD
- GRADED AND DRAINED ROAD
- SOIL SURFACE ROAD
- GRAVEL OR STONE ROAD
- BITUMINOUS ROAD
- PAVED ROAD
- DIVIDED ROAD
- TRUNK HIGHWAY UNDER CONSTRUCTION
- ROADS IN UNINCORPORATED COMPACTS, EXTENSIONS OF LOCAL ROADS (NOT F.A.S.) WITHIN MUNICIPALITIES AND FRONTAGE ROADS

- GRADE SEPARATION
- FULL TRAFFIC INTERCHANGE
- PARTIAL TRAFFIC INTERCHANGES INDICATING TRAFFIC MOVEMENT

ROAD SYSTEM DESIGNATIONS

- INTERSTATE TRUNK HIGHWAY
- U.S. NUMBERED TRUNK HIGHWAY
- STATE NUMBERED TRUNK HIGHWAY
- COUNTY STATE AID HIGHWAY
- COUNTY STATE AID IN ADJOINING COUNTY
- TERMINATION OF DESIGNATED ROUTE

BOUNDARIES

- NATIONAL OR STATE
- COUNTY
- CIVIL TOWNSHIP
- CONGRESSIONAL TOWNSHIP (U.S. LAND)
- CORPORATE LINE
- SECTION LINE
- CONGESTED AREA
- INDIAN RESERVATION

DRAINAGE

- INTERMITTENT STREAM
- NARROW STREAM
- WIDE STREAM
- MARSH OR SWAMP LAND
- DRAINAGE DITCH
- LAKE OR POND

CITY CENTERS

- STATE CAPITAL
- COUNTY SEAT
- CITY CENTER
- INCORPORATED CITY (GENERALIZED)

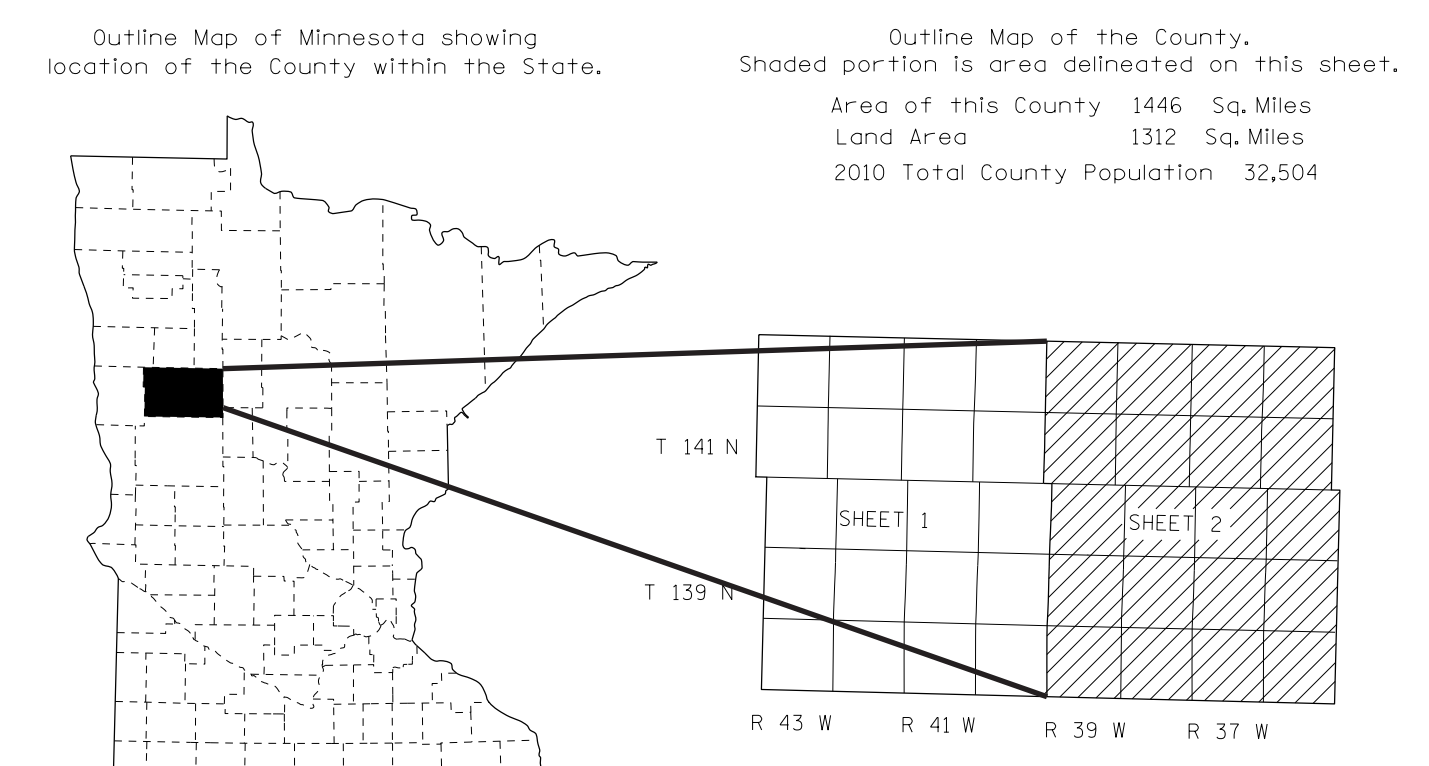

NOTE: FOR DETAIL OF COUNTY STATE AID HIGHWAYS AND COUNTY ROADS IN INCORPORATED PLACES, SEE MAPS OF MUNICIPALITIES.