

## Worthington - OTG

[www.ci.worthington.mn.us/Airport.htm](http://www.ci.worthington.mn.us/Airport.htm)

---



- Airport Manager:** Jim Laffrenzen - 507-372-8650 -  
jlaff@frontiernet.net
- Contact Person:** Cameron Johnson - 507-376-9293  
or cell 507-360-3731 -  
cameron@integrityaviation.com
- AWOS/ASOS:** 507-376-9441 - VOR 110.6
- MnWAS Loc/Hrs:** Arrival/Departure Building - 24 hours
- Attended:** All/Mon-Fri/0800-1700
- Fuel:** 100LL, Jet A - available 24 hours with credit card
- After Hrs Service:** 507-376-9293
- FBO(s):** Integrity Aviation, Inc. - 507-376-9293 - 122.8 -  
cameron@integrityaviation.com -  
www.integrityaviation.com
- Businesses:** Arnt's Aerial Spraying - 507-376-3305 -  
arntaerial@frontiernet.net
- Ground Transport:** Worthington Taxi Service - 507-372-4300  
Scholtes Auto World Rental - 507-376-3136  
Airport courtesy car
- Food Service:** Catering & kitchenette facilities  
Complimentary condiments & beverages
- Dining:** Ground Round - 1 mile  
Perkins - 507-372- 7761 - 1 mile  
Stephanie's - 507-372-4860 - 1 mile  
Many fast food restaurants - 1 mile
- Lodging:** Travel Lodge - 507-372-2991 - 1 mile  
AmericInn Motel - 507-376-4500 - 1 mile  
Holiday Inn Express - 507-372-2333 - 1 mile
- Airport Events:** None reported
- Underwing Camp:** Yes
- Campgrounds:** Olson Campgrounds - 507-329-0760
- Local Attractions:** Prairie View Golf Course - 507-372-8670 - Holes: 18  
Worthington Country Club - 507-376-5142 - Holes: 18  
Pioneer Village  
Olson Campground  
20 municipal parks  
Lake Okabena
- Comments:** Flocks of seagulls and migrating waterfowl frequently on  
airport; airport manager cell phone - 507-360-8764;  
additional after hours service phone - 507-360-3731;  
additional information phone - 507-360-3731; for all  
services contact Integrity Aviation, Inc.;  
conference/meeting room; pilot's lounge; flight planning  
facility; overnight hangar service; tiedowns; "T" hangars  
available for lease

FIELD ELEV. 1574'

(OTG)

WORTHINGTON

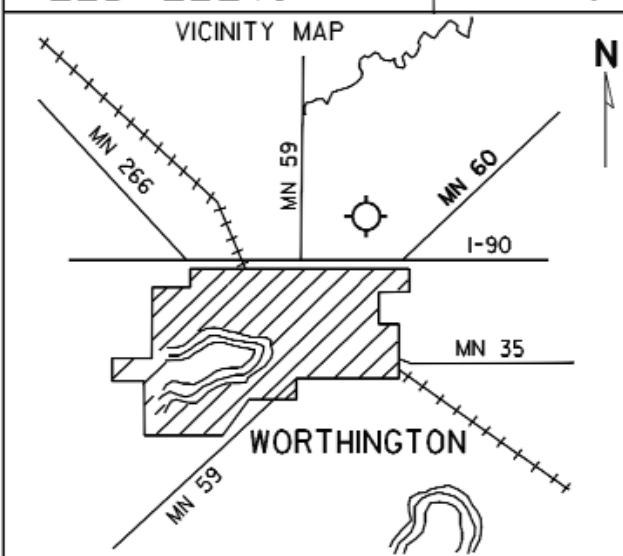

SEC. CH: OMAHA NORTH  
 LAT: 43° 39.3'  
 LONG: 95° 34.8'  
 COMM: CTAF: 122.8(L)  
 AWOS: 110.6 VOR  
 RCO FSS: 123.6R, 122.1R, 110.6T  
 MPLS CTR: 132.05  
 TPA: 2400' (826')  
 APPROACH: ILS, GPS,  
 VOR & NDB

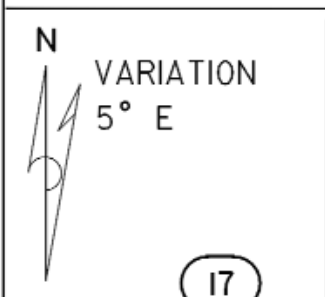

	RUNWAY 11 - 29			RUNWAY 17 - 35			
	CLICKS ON 122.8			CLICKS ON 122.8			
	3	5	7		3	5	7
LIGHTS	LOW	MED	HIGH	LIGHTS	LOW	MED	HIGH
PAPI	ON	ON	ON	PAPI	ON	ON	ON
MALSR	LOW	MED	HIGH	REIL	OFF	OFF	ON
REIL (II)	OFF	OFF	ON				

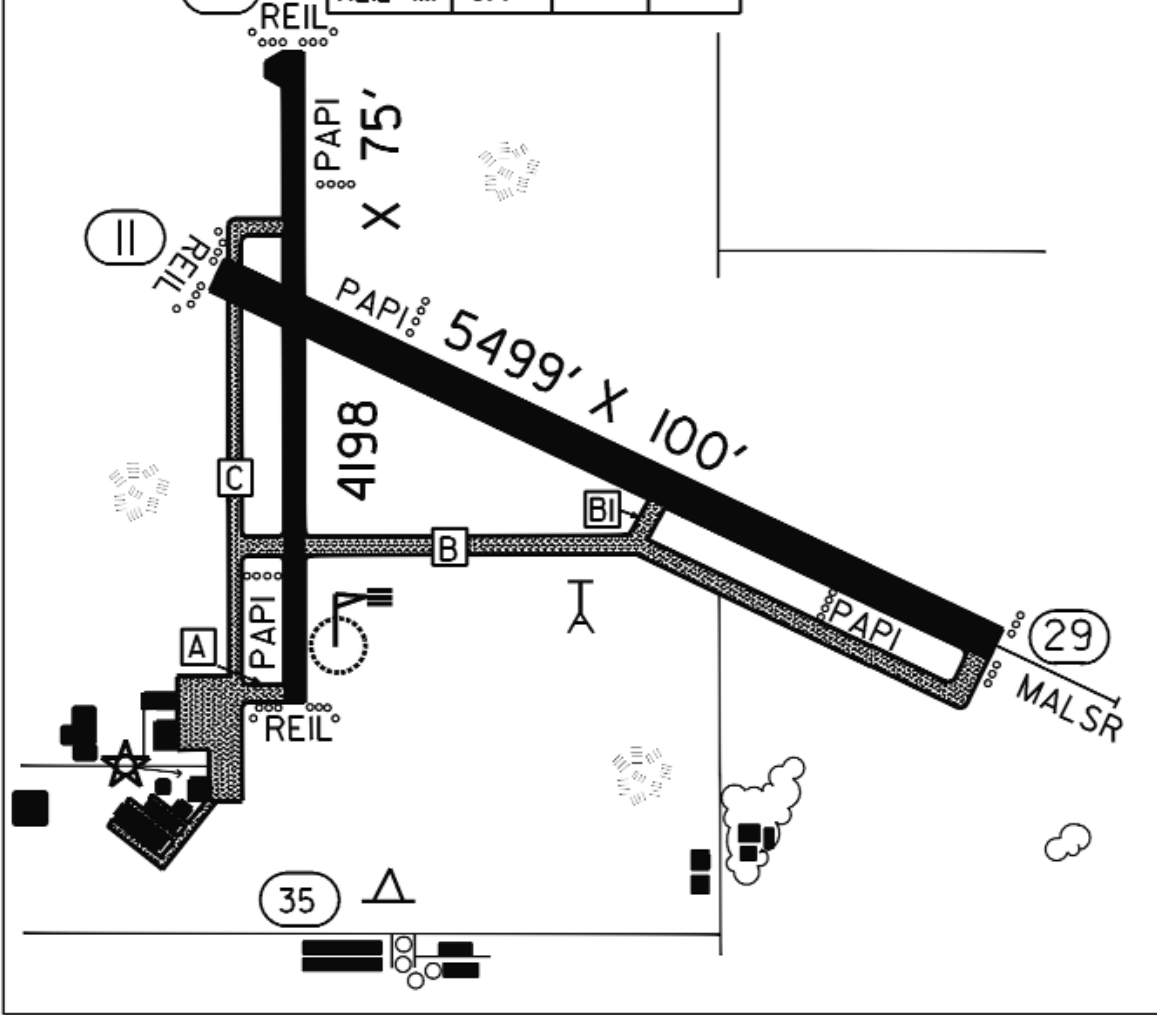

WORTHINGTON MUNICIPAL AIRPORT

WORTHINGTON