

Winsted - 1ØD



Airport Manager: Russ Paschke & David Meyer - 320-485-3720

Contact Person: David Meyer - 320-485-2201 or 320-485-2366

AWOS/ASOS: No

MnWAS Loc/Hrs: Arrival/Departure Building - 24 hours

Attended: All/All/0800-1800

Fuel: 100LL - available 24 hours with credit card

After Hrs Service: 320-485-3720

FBO(s): None

Businesses: Mason Air - 952-353-1658 - 122.900 - MasonAir@live.com - www.MasonAir.biz
Westside Skydivers - 320-485-2124 - joe@westsideskydivers.com - www.westsideskydivers.com

Ground Transport: Contact - 320-485-3891

Food Service: Convenience Stores - 1 mile

Dining: The Pantry - 320-485-9172 - 1 mile
Blue Note Bar & Ballroom - 320-485-9698 - 1 mile
Big Al's Bar & Grill - 320-485-2859 - 1 mile
Subway - 320-485-2000 - 1 mile
V's Grill - 320-485-3333 - 1 mile
Roadhouse Coffee Shop - 320-485-2217 - 1 mile
The Corner Bar & Grill - 320-485-4288 - 1 mile

Lodging: Winsted Motel - 320-485-4441 - 1 mile

Airport Events: None reported

Underwing Camp: Yes

Campgrounds: None

Local Attractions: Shadow Brook Golf Course - 3 miles; Winsted Lake
7 municipal parks
1 county park; Luce Line Trail
Winstock Country Music Festival - www.winstockfestival.com - June - adjacent to airport

Comments: Additional information phone - 320-485-2366
City web site - www.winsted.mn.us

FIELD ELEV. 1030'

(10D)

WINSTED

VICINITY MAP

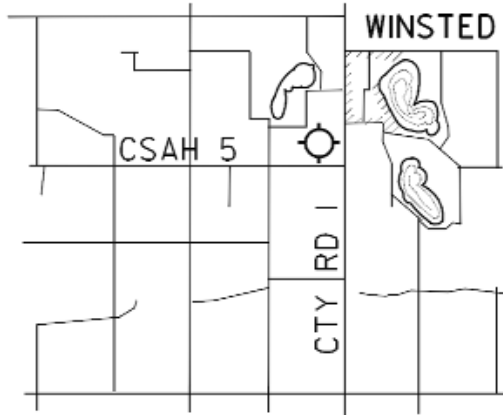

N

SEC. CH: TWIN CITIES (S)

LAT: 44° 57.0'

LONG: 94° 04.0'

COMM: CTAF: 122.9

MPLS CTR: 125.5

TPA: 1830' (800')

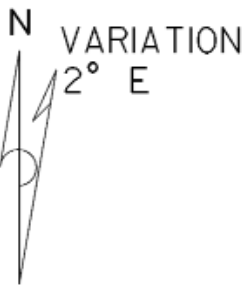

RUNWAY LIGHTED
DUSK TO DAWN

9

27

3248' X 200'

WINSTED MUNICIPAL AIRPORT

WINSTED