

## Roseau - ROX

---



**Airport Manager:** Arlen Sandland - 218-463-3906 - arlens@mncable.net

**Contact Person:** Arlen Sandland - 218-463-3906 - arlens@mncable.net

**AWOS/ASOS:** 218-463-1803 - VOR 108.8

**MnWAS Loc/Hrs:** Arrival/Departure Building - 24 hours

**Attended:** All/Mon-Fri/0800-1700

**Fuel:** 100LL, Jet A - available 24 hours with credit card

**After Hrs Service:** 218-463-3906

**FBO(s):** None

**Businesses:** Slater Spraying Service, Inc. - 218-463-1064 - 122.8 - gmslater@wiktel.com  
Roseau Ag, Inc. - 218-779-1678 - chadlofton@hotmail.com

**Ground Transport:** Car rental: Bryan Erickson - 218-463-1255  
Courtesy car

**Food Service:** None

**Dining:** Roseau Diner - 218-463-2036 - 3 miles  
Nelson's Café - 218-463-2277 - 3 miles  
Dairy Queen - 218-463-3030 - 3 miles  
Silver Dragon - 218-463-3848 - 3 miles  
Pizza Ranch - 218-463-0111 - 3 miles  
Subway - 218-463-2677 - 3 miles

**Lodging:** North Country Inn - 218-463-9444 - 3 miles  
AmericInn Motel - 218-463-1045 - 3 miles  
Roseau Inn & Diner - 218-463-2196 - 3 miles

**Airport Events:** None reported

**Underwing Camp:** Yes

**Campgrounds:** Roseau Municipal Park - 2 miles  
Hayes Lake State Park - 18 miles

**Local Attractions:** Oakcrest Golf Course - Holes: 18  
Roseau County Museum  
Polaris Industries

**Comments:** None

FIELD ELEV. 1060'

(ROX)

ROSEAU

VICINITY MAP

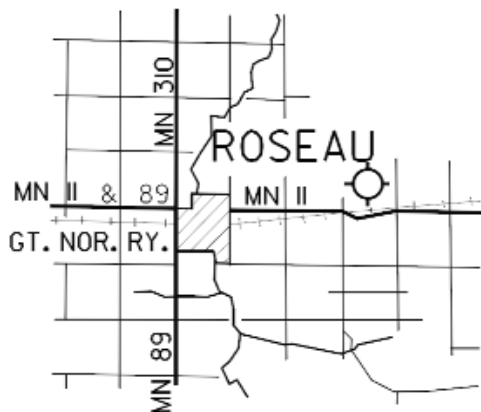

N  
 SEC. CH: TWIN CITIES (N)  
 LAT: 48° 51.4'  
 LONG: 95° 41.8'  
 COMM: CTAF: 122.8(L)  
 AWOS: 108.8 VOR  
 RCO FSS: 122.25  
 MPLS CTR: 134.75  
 TPA: 1850' (790')  
 APPROACH: RNAV, VOR, GPS

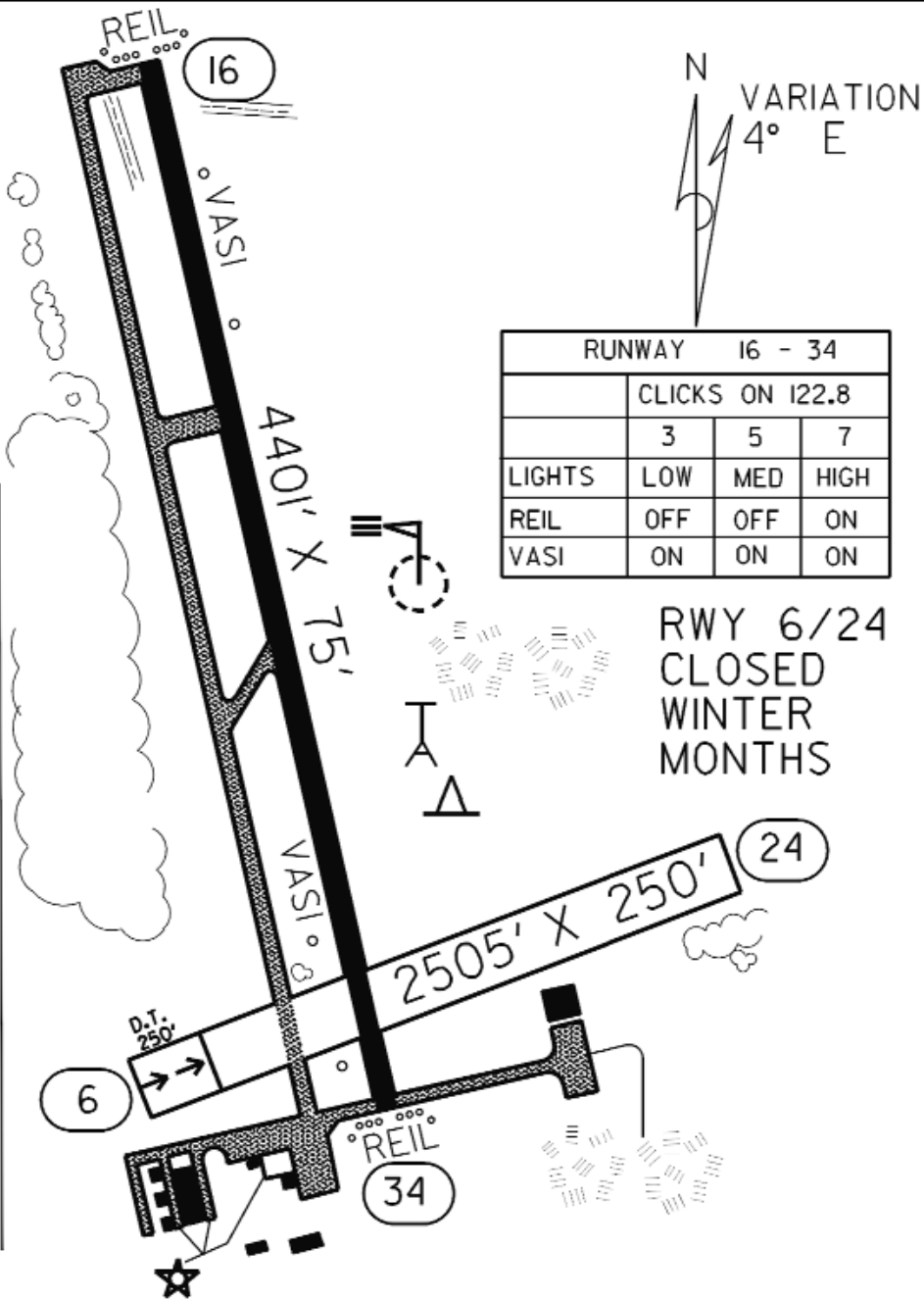

TRAILER  
 PARK

ROSEAU MUNICIPAL AIRPORT  
 (RUDY BILLBERG FIELD)

ROSEAU